

LATITUDE 39°22'30" 2,072'

LATITUDE 39°25'00"

LONGITUDE 80°55'00" 9,076' TO BOTTOM HOLE

LONGITUDE 80°55'00"

Antero Resources Corporation
Well No. Swartzmiller Unit 2H
47-085-10350

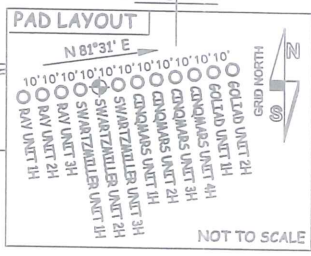

NOTES:
WELL 2H TOP HOLE INFORMATION:
N: 320,634ft E: 1,597,442ft
LAT: 39°22'17.65" LON: 80°55'26.39"
BOTTOM HOLE INFORMATION:
N: 328,005ft E: 1,596,114ft
LAT: 39°23'30.30" LON: 80°55'44.78"
WEST VIRGINIA COORDINATE SYSTEM OF 1927 NORTH ZONE. ZONE WAS DERIVED FROM MEASUREMENTS TAKEN WITH TRIMBLE GEOXT SUBMETER MAPPING GRADE GPS UNIT. PLAT ORIENTATION, CORNER, AND WELL REFERENCE TIE LINES ARE BASED ON GRID NORTH.
(NAD) 83 (UTM) ZONE 17 COORDS:
WELL 2H TOP HOLE INFORMATION:
N: 4,358,023m E: 506,561m
BOTTOM HOLE INFORMATION:
N: 4,360,262m E: 506,119m

NOTE:
1. NO OCCUPIED DWELLINGS OR BUILDINGS TWO THOUSAND FIVE HUNDRED (2,500) SQUARE FEET OR LARGER USED TO HOUSE OR SHELTER DAIRY CATTLE OR POULTRY HUSBANDRY ARE LOCATED WITHIN SIX HUNDRED TWENTY-FIVE (625) FEET OF THE CENTER OF THE WELL PAD.
2. TOP HOLE DATA SHOWN HEREON WAS PROVIDED BY ANTERO RESOURCES CORPORATION.
3. AS DRILLED DATA WAS PROVIDED BY ANTERO RESOURCES CORPORATION.
4. WLS IS NOT CERTIFYING THE DATA AND INFORMATION PROVIDED LISTED IN NOTES 2 AND 3, ONLY THE RELATIONSHIP TO THE DATA AND INFORMATION PROVIDED TO THE LEASE BOUNDARIES.
5. WLS IS BY NO MEANS RESPONSIBLE FOR ANY ERRORS OR INACCURACIES WITH THE DATA AND INFORMATION THAT HAS BEEN PROVIDED.

WV NORTH ZONE GRID NORTH

JOE-DOM INC. LEASE

KEVIN GRIM D.B. 268 PG. 66 T.M. 1 PAR. 02 83.5 AC. ±

ROBERT A. DAVIS ET UX LEASE
GARY A. BARNARD ET AL
D.B. 247 PG. 586 T.M. 11 PAR. 13 284.33 AC. ±

CLIFF WM. PERKINS ET UX LEASE

KEVIN GRIM D.B. 268 PG. 66 T.M. 1 PAR. 04 81.5 AC. ±

CLIFF PERKINS ET AL D.B. 289 PG. 1020 T.M. 1 PAR. 05 75.08 AC. ±

IRENE NUTTER HAYMOND TRUST LEASE

JESSICA HAYMOND D.B. 334 PG. 347 T.M. 3 PAR. 07 168 AC. ±

DAVID L. WEEKLEY REVOCABLE TRUST D.B. 265 PG. 204 T.M. 3 PAR. 10 203.38 AC. ±

DAVID L. WEEKLEY REVOCABLE TRUST LEASE

Clay District - Ritchie County		
PAR.	SURFACE OWNER	OIL & GAS ROYALTY OWNER
1-08	CLIFF PERKINS ET AL	CLIFF WM. PERKINS ET UX
1-09	CLIFF PERKINS ET AL	CLIFF WM. PERKINS ET UX
1-11	CLIFF PERKINS ET AL	CLIFF WM. PERKINS ET UX
1-12	CLIFF PERKINS ET AL	LAURA ULAM
1-13	CLIFF PERKINS ET AL	CLIFF WM. PERKINS ET UX
1-14	CLIFF PERKINS ET AL	CLIFF WM. PERKINS ET UX
1-15	CLIFF PERKINS ET AL	CLIFF WM. PERKINS ET UX
1-16	CLIFF PERKINS ET AL	CLIFF WM. PERKINS ET UX
1-17	CLIFF PERKINS ET AL	CLIFF WM. PERKINS ET UX
1-18	CLIFF PERKINS ET AL	CLIFF WM. PERKINS ET UX
1-19	MICHAEL DER	GARY MICHAEL DER ET UX
1-20	TONY PERKINS ET AL	TONY ADRIAN PERKINS
3-03	BRIAN JONES	BRIAN KEITH JONES
3-04	BRIAN JONES	BRIAN KEITH JONES
3-05	DENNY COWGER	DENNY COWGER ET UX
3-06	CLIFF PERKINS ET AL	TONY ADRIAN PERKINS

NOTE:
4 WATER WELLS WERE LOCATED WITHIN 2000' OF CENTER OF PAD

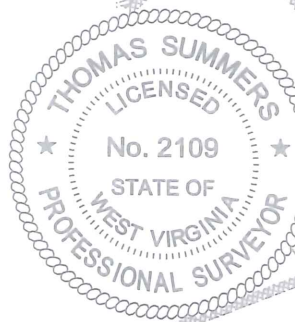
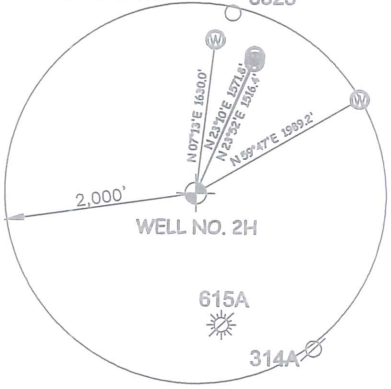

NORMAN FLEMING ET UX LEASE

JOB # 17-044WA
DRAWING # SWARTMILLER2HAD
SCALE 1" = 1000'
MINIMUM DEGREE OF ACCURACY SUBMETER
PROVEN SOURCE OF ELEV. SUBMETER MAPPING GRADE GPS
STATE OF WEST VIRGINIA DEPARTMENT OF ENERGY DIVISION OF OIL AND GAS

I THE UNDERSIGNED, HEREBY CERTIFY THAT THIS PLAT IS CORRECT TO THE BEST OF MY KNOWLEDGE AND BELIEF AND SHOWS ALL THE INFORMATION REQUIRED BY LAW AND THE RULES ISSUED AND PERSCRIBED BY THE DEPARTMENT OF ENVIRONMENTAL PROTECTION.



STATE OF WEST VIRGINIA, DIVISION OF ENVIRONMENTAL PROTECTION, OFFICE OF OIL AND GAS
WILLOW LAND SURVEYING PLLC
220 MASONIC AVE. PENNSBORO WEST VIRGINIA 26415

LEGEND
----- Surface Owner Boundary Lines +/-
----- Interior Surface Tracts +/-
--- Proposed Well Path
--- As Drilled Well Path
THOMAS SUMMERS P.S. 2109
DATE 02/10/20
OPERATOR'S WELL # SWARTZMILLER UNIT #2H

WELL TYPE: OIL GAS X LIQUID INJECTION WASTE DISPOSAL
(IF "GAS") PRODUCTION X STORAGE DEEP SHALLOW X
LOCATION: ELEVATION 1,235' AS BUILT WATERSHED NORTH FORK HUGHES RIVER
QUADRANGLE PENNSBORO 7.5' - TH MIDDLEBOURNE 7.5' - BH DISTRICT CLAY COUNTY RITCHIE
SURFACE OWNER DAVID L. WEEKLEY REVOCABLE TRUST ACREAGE 203.38 ACRES +/-
OIL & GAS ROYALTY OWNER DAVID L. WEEKLEY REVOCABLE TRUST; TONY ADRIAN PERKINS; LEASE ACREAGE 229 AC. ±; 26.11 AC. ±;
TONY ADRIAN PERKINS; CLIFF WM. PERKINS ET UX; CLIFF WM. PERKINS ET UX; CLIFF WM. PERKINS ET UX; 2 AC. ±; 16.35 AC. ±; 17 AC. ±; 18.5 AC. ±;
IRENE NUTTER HAYMOND TRUST; CLIFF WM. PERKINS ET UX; ROBERT A. DAVIS ET UX 375 AC. ±; 75.08 AC. ±; 284.33 AC. ±
PROPOSED WORK: DRILL CONVERT DRILL DEEPER REDRILL FRACTURE OR STIMULATE
PLUG OFF OLD FORMATION PERFORATE NEW FORMATION OTHER PHYSICAL CHANGE IN WELL
(SPECIFY) AS DRILLED
TARGET FORMATION MARCELLUS PLUG & ABANDON CLEAN OUT & REPLUG
WELL OPERATOR ANTERO RESOURCES CORP. ESTIMATED DEPTH 6,597' TVD 14,341' MD
ADDRESS 1615 WYNKOOP ST. DESIGNATED AGENT DIANNA STAMPER - CT CORPORATION SYSTEM
FORM WW-6 DENVER, CO 80202 ADDRESS 5400 D BIG TYLER ROAD CHARLESTON, WV 25313

COUNTY NAME PERMIT