

LATITUDE 39°15'00"

8,083'

1,859' TO BOTTOM HOLE

LATITUDE 39°17'30"

LONGITUDE 80°57'30"

14,247'

LONGITUDE 80°55'00"

Antero Resources Corporation
Well No. Riggs Unit 1H

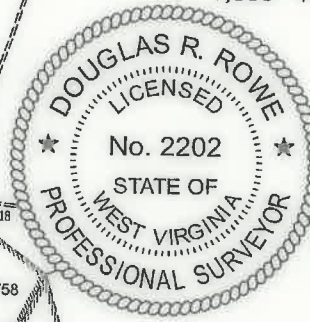

PAD LAYOUT

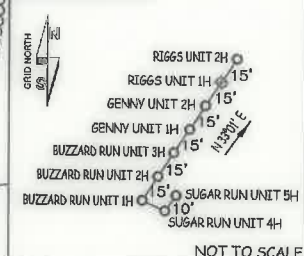

NOT TO SCALE

AS DRILLED DATA:
 WELL 1H TOP HOLE INFORMATION:
 N: 263,339ft E: 1,590,527ft
 LAT: 39°12'50.32" LON: 80°56'42.70"
 BOTTOM HOLE INFORMATION:
 N: 277,477ft E: 1,585,178ft
 LAT: 39°15'09.19" LON: 80°57'53.57"
 WEST VIRGINIA COORDINATE SYSTEM OF 1927 NORTH ZONE. ZONE WAS DERIVED FROM MEASUREMENTS TAKEN WITH TRIMBLE GEOXT SUBMETER TRAPMILE GRADE GPS UNIT. PLAT ORIENTATION, CORNER, AND WELL REFERENCE TIE LINES ARE BASED ON GRID NORTH.

(NAD) 83 (UTM) ZONE 17 COORDS:
 WELL 1H TOP HOLE INFORMATION:
 N: 4,340,533m E: 504,746m
 BOTTOM HOLE INFORMATION:
 N: 4,344,813m E: 503,045m

NOTE:
2 WATER WELLS WERE LOCATED WITHIN 2000' OF THE CENTER OF PAD

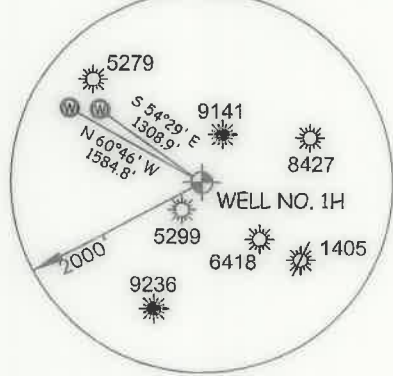

Clay District - Ritchie County	
30-15	Joseph Wilson
30-27	Joseph Wilson
30-40	Susie Perkins
30-41	Ray Taylor
30-42	Joseph Wilson
35-05	E L F LLC
35-12	E L F LLC
35-26	Donald McCraw
35-27	Kevin Headley
35-28	Brian Taylor
35-36	H. L. Jones
35-37	W. B. Houue
36-26	Merhan Clavis
36-27	James Elder
39-09	Howard Hornish
40-01	Michael Sammons
40-02	Scott Williams
40-03	Tommy Postlethwait
40-07	James Matters
1H BOTTOM HOLE	
40-71	Terry Lee Richards
40-09	Terry Lee Richards
40-13	Tommy Postlethwait
40-14	Duane Riggs
40-18	Duane Riggs

I THE UNDERSIGNED, HEREBY CERTIFY THAT THIS PLAT IS CORRECT TO THE BEST OF MY KNOWLEDGE AND BELIEF AND SHOWS ALL THE INFORMATION REQUIRED BY LAW AND THE RULES ISSUED AND PRESCRIBED BY THE DEPARTMENT OF ENVIRONMENTAL PROTECTION.



STATE OF WEST VIRGINIA, DIVISION OF ENVIRONMENTAL PROTECTION, OFFICE OF OIL AND GAS

WILLOW LAND SURVEYING PLLC
220 MASONIC AVE. PENNSBORO WEST VIRGINIA 26415

JOB # 18-024WA
 DRAWING # RIGGS1HAD
 SCALE 1" = 2000'
 MINIMUM DEGREE OF ACCURACY SUBMETER
 PROVEN SOURCE OF ELEV. SUBMETER MAPPING GRADE GPS
 STATE OF WEST VIRGINIA DEPARTMENT OF ENERGY DIVISION OF OIL AND GAS

LEGEND
 - - - - - Surface Owner Boundary Lines +/-
 - - - - - Interior Surface Tracts +/-
 - - - - - Proposed Well Path
 (Symbol) Drilled Well Path

DOUGLAS R. ROWE P.S. 2202
 DATE 06/04/20
 OPERATOR'S WELL# RIGGS UNIT #1H

NOTE
 1. NO OCCUPIED DWELLINGS OR BUILDINGS TWO THOUSAND FIVE HUNDRED (2,500) SQUARE FEET OR LARGER USED TO HOUSE OR SHELTER DAIRY CATTLE OR POULTRY HUSBANDRY ARE LOCATED WITHIN SIX HUNDRED TWENTY-FIVE (625) FEET OF THE CENTER OF THE WELL PAD.
 2. TOP HOLE DATA SHOWN HEREON WAS PROVIDED BY ANTERO RESOURCES CORPORATION.
 3. AS DRILLED DATA WAS PROVIDED BY ANTERO RESOURCES CORPORATION.
 4. WLS IS NOT CERTIFYING THE DATA AND INFORMATION PROVIDED LISTED IN NOTES 2 AND 3, ONLY THE RELATIONSHIP TO THE DATA AND INFORMATION PROVIDED TO THE LEASE BOUNDARIES.
 5. WLS IS BY NO MEANS RESPONSIBLE FOR ANY ERRORS OR INACCURACIES WITH THE DATA AND INFORMATION THAT HAS BEEN PROVIDED.

WELL TYPE: OIL GAS LIQUID INJECTION WASTE DISPOSAL 47 - 085 - 10384
 (IF "GAS") PRODUCTION STORAGE DEEP SHALLOW
 LOCATION: ELEVATION 1,149' AS BUILT WATERSHED NORTH FORK HUGHES RIVER QUADRANGLE PULLMAN 7.5' (SHL) PENNSBORO 7.5' (BHL) STATE COUNTY PERMIT
 SURFACE OWNER TERRY LEE RICHARDS ACREAGE 60 ACRES +/- DISTRICT CLAY COUNTY RITCHIE
 OIL & GAS ROYALTY OWNER LORETTA K. CLARK BARE ET AL; MILES H. LAMM ET UX; WANEMA RIGGS ET VIR LEASE ACREAGE 60 AC±; 44 AC±; 23.5 AC±
 STEPHEN LENTZ SR. ET UX; IRA J. LAMM ET AL; DUANE RIGGS; THOMAS G. BEE ET UX; ALMARINE HOUGE; HARRY J. TAYLOR 7.35 AC±; 38 AC±; 42.5 AC±; 63.19 AC±; 90 AC±; 155 AC±
 MARY HOLLAND ET VIR; GROVER C. TAYLOR ET AL; LENA R. CARR ET AL; DALE WEEKELY ET AL 220 AC±; 577 AC±; 163 AC±; 140 AC±
 PROPOSED WORK: DRILL CONVERT DRILL DEEPER REDRILL FRACTURE OR STIMULATE
 PLUG OFF OLD FORMATION PERFORATE NEW FORMATION OTHER PHYSICAL CHANGE IN WELL (SPECIFY) AS DRILLED PLUG & ABANDON CLEAN OUT & REPLUG
 TARGET FORMATION MARCELLUS ESTIMATED DEPTH 6,437' TVD 21,669' MD
 WELL OPERATOR ANTERO RESOURCES CORP. DESIGNATED AGENT DIANNA STAMPER - CT CORPORATION SYSTEM
 ADDRESS 1615 WYNKOOP ST. ADDRESS 5400 D BIG TYLER ROAD
 FORM WW-6 DENVER, CO 80202 CHARLESTON, WV 25313

COUNTY NAME PERMIT

LATITUDE 39°15'00"

8,083'

1,859' TO BOTTOM HOLE

LATITUDE 39°17'30"

Antero Resources Corporation
Well No. Riggs Unit 1H

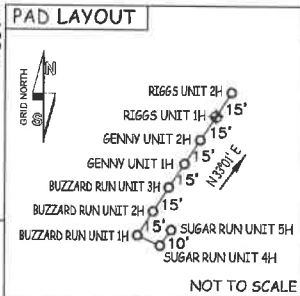
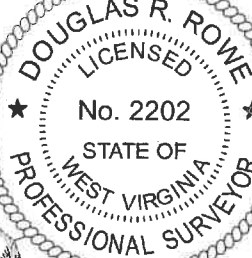

AS DRILLED DATA:
WELL 1H TOP HOLE INFORMATION:
N: 263,339ft E: 1,590,527ft
LAT: 39°12'50.32" LON: 80°56'42.70"
BOTTOM HOLE INFORMATION:
N: 277,477ft E: 1,585,178ft
LAT: 39°15'09.19" LON: 80°57'53.57"
WEST VIRGINIA COORDINATE SYSTEM OF 1927 NORTH ZONE. ZONE WAS DERIVED FROM MEASUREMENTS TAKEN WITH TRIMBLE GEOXT SUBMETER MAPPING GRADE GPS UNIT. PLAT ORIENTATION, CORNER, AND WELL REFERENCE TIE LINES ARE BASED ON GRID NORTH.

(NAD) 83 (UTM) ZONE 17 COORDS:
WELL 1H TOP HOLE INFORMATION:
N: 4,340,533m E: 504,746m
BOTTOM HOLE INFORMATION:
N: 4,344,813m E: 503,045m

NOTE:
2 WATER WELLS WERE LOCATED WITHIN 2000' OF THE CENTER OF PAD

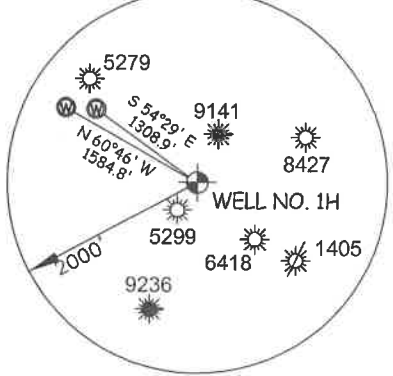

Clay District - Ritchie County

30-15	Joseph Wilson
30-27	Joseph Wilson
30-40	Susie Perkins
30-41	Ray Taylor
30-42	Joseph Wilson
35-05	E L F LLC
35-12	E L F LLC
35-26	Donald McCray
35-27	Kevin Headley
35-28	Brian Taylor
35-36	H. L. Jones
35-37	W. B. House
36-26	Meghan Clovis
36-27	James Elder
39-09	Howard Hornish
40-01	Michael Sammons
40-02	Scott Williams
40-03	Tommy Postlethwait
40-07	James Maters
1H BOTTOM HOLE	
40-7.1	Terry Lee Richards
40-09	Terry Lee Richards
40-13	Tommy Postlethwait
40-14	Duane Riggs
40-18	Duane Riggs

I THE UNDERSIGNED, HEREBY CERTIFY THAT THIS PLAT IS CORRECT TO THE BEST OF MY KNOWLEDGE AND BELIEF AND SHOWS ALL THE INFORMATION REQUIRED BY LAW AND THE RULES ISSUED AND PERSCRIBED BY THE DEPARTMENT OF ENVIRONMENTAL PROTECTION.



STATE OF WEST VIRGINIA, DIVISION OF ENVIRONMENTAL PROTECTION, OFFICE OF OIL AND GAS

WILLOW LAND SURVEYING PLLC
220 MASONIC AVE. PENNSBORO WEST VIRGINIA 26415

JOB # 18-024WA
DRAWING # RIGGS1HAD
SCALE 1" = 2000'
MINIMUM DEGREE OF ACCURACY SUBMETER
PROVEN SOURCE OF ELEV. SUBMETER MAPPING GRADE GPS
STATE OF WEST VIRGINIA DEPARTMENT OF ENERGY DIVISION OF OIL AND GAS

LEGEND
- - - - - Surface Owner Boundary Lines +/-
- - - - - Interior Surface Tracts +/-
O - - - - - Proposed Well Path
- - - - - As Drilled Well Path
DOUGLAS R. ROWE P.S. 2202 AUG 5 2020
DATE 06/04/20
OPERATOR'S WELL# RIGGS UNIT #1H

NOTE
1. NO OCCUPIED DWELLINGS OR BUILDINGS TWO THOUSAND FIVE HUNDRED (2,500) SQUARE FEET OR LARGER USED TO HOUSE OR SHELTER DAIRY CATTLE OR POULTRY HUSBANDRY ARE LOCATED WITHIN SIX HUNDRED TWENTY-FIVE (625) FEET OF THE CENTER OF THE WELL PAD.
2. TOP HOLE DATA SHOWN HEREON WAS PROVIDED BY ANTERO RESOURCES CORPORATION.
3. AS DRILLED DATA WAS PROVIDED BY ANTERO RESOURCES CORPORATION.
4. WLS IS NOT CERTIFYING THE DATA AND INFORMATION PROVIDED LISTED IN NOTES 2 AND 3, ONLY THE RELATIONSHIP TO THE DATA AND INFORMATION PROVIDED TO THE LEASE BOUNDARIES.
5. WLS IS BY NO MEANS RESPONSIBLE FOR ANY ERRORS OR INACCURACIES WITH THE DATA AND INFORMATION THAT HAS BEEN PROVIDED.

WELL TYPE: OIL ___ GAS X LIQUID INJECTION ___ WASTE DISPOSAL ___ 47 - 085 - 10384
(IF "GAS") PRODUCTION X STORAGE ___ DEEP ___ SHALLOW X STATE COUNTY PERMIT
LOCATION: ELEVATION 1,149' AS BUILT WATERSHED NORTH FORK HUGHES RIVER QUADRANGLE PULLMAN 7.5' (SHL) PENNSBORO 7.5' (BHL)
SURFACE OWNER TERRY LEE RICHARDS ACREAGE 60 ACRES +/- DISTRICT CLAY COUNTY RITCHIE
OIL & GAS ROYALTY OWNER LORETTA K. CLARK BARE ET AL; MILES H. LAMM ET UX; WANEMA RIGGS ET VIR; LEASE ACREAGE 60 AC±; 44 AC±; 23.5 AC±;
STEPHEN LENTZ SR. ET UX; IRA J. LAMM ET AL; DUANE RIGGS; THOMAS G. BEE ET UX; ALMARINE HOUGE; HARRY J. TAYLOR; 7.35 AC±; 38 AC±; 42.5 AC±; 63.19 AC±; 80 AC±; 155 AC±;
MARY HOLLAND ET VIR; GROVER C. TAYLOR ET AL; LENA R. CARR ET AL; DALE WEEKLY ET AL; 220 AC±; 577 AC±; 163 AC±; 140 AC±
PROPOSED WORK: DRILL ___ CONVERT ___ DRILL DEEPER ___ REDRILL ___ FRACTURE OR STIMULATE ___
PLUG OFF OLD FORMATION ___ PERFORATE NEW FORMATION ___ OTHER PHYSICAL CHANGE IN WELL (SPECIFY) AS DRILLED ___ PLUG & ABANDON ___ CLEAN OUT & REPLUG ___
TARGET FORMATION MARCELLUS ESTIMATED DEPTH 6,437' TVD 21,669' MD
WELL OPERATOR ANTERO RESOURCES CORP DESIGNATED AGENT DIANNA STAMPER - CT CORPORATION SYSTEM
ADDRESS 1615 WYNKOOP ST. ADDRESS 5400 D BIG TYLER ROAD
DENVER, CO 80202 CHARLESTON, WV 25313

NORTH ZONE
GRID NORTH

LONGITUDE 80°57'30"

14,247'

13,120'

LONGITUDE 80°55'00"

COUNTY NAME PERMIT