

LATITUDE 39°10'00"

LATITUDE 39°12'30" 109'

Antero Resources Corporation  
Well No. Maxson Unit 2H

NOTES:

WELL 2H TOP HOLE INFORMATION:  
N: 246,901ft E: 1,610,058ft 2H BOTTOM  
LAT: 39°09'37.00" LON: 80°52'31.39" HOLE  
BOTTOM HOLE INFORMATION:  
N: 243,465ft E: 1,610,489ft  
LAT: 39°09'37.00" LON: 80°52'25.24"  
WEST VIRGINIA COORDINATE  
SYSTEM OF 1927 NORTH ZONE.  
ZONE WAS DERIVED FROM  
MEASUREMENTS TAKEN WITH  
TRIMBLE GEOXT SUBMETER  
MAPPING GRADE GPS UNIT.  
PLAT ORIENTATION, CORNER,  
AND WELL REFERENCE TIE LINES  
ARE BASED ON GRID NORTH.

(NAD) 83 (UTM) ZONE 17 COORDS:  
WELL 2H TOP HOLE INFORMATION:  
N: 4,335,625m E: 510,780m  
BOTTOM HOLE INFORMATION:  
N: 4,334,580m E: 510,929m

(NAD) 27 (UTM) ZONE 17 COORDS:  
WELL 2H TOP HOLE INFORMATION:  
N: 14,223,748ft E: 1,670,735ft  
POINT OF ENTRY INFORMATION:  
N: 14,224,121ft E: 1,674,930ft  
BOTTOM HOLE INFORMATION:  
N: 14,220,320ft E: 1,676,224ft

NOTE  
NO OCCUPIED DWELLINGS OR BUILDINGS TWO  
THOUSAND FIVE HUNDRED (2,500) SQUARE FEET  
OR LARGER USED TO HOUSE OR SHELTER DAIRY  
CATTLE OR POULTRY HUSBANDRY ARE LOCATED  
WITHIN SIX HUNDRED TWENTY-FIVE (625) FEET  
OF THE CENTER OF THE WELL PAD.

NOTE:  
1 WATER WELLS WAS  
LOCATED WITHIN 2000'  
OF THE CENTER OF PAD

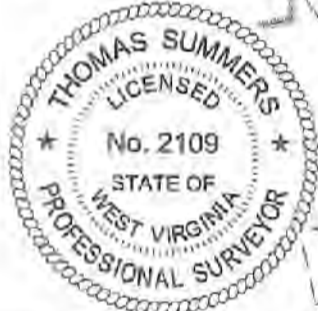
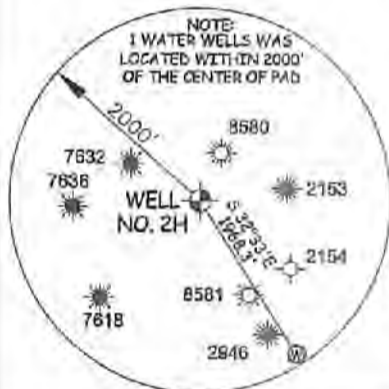

Union District - Ritchie County

14-19	David W. Weekley
20-3	David W. Weekley
20-4	David W. Weekley
20-7	David W. Weekley
20-8	David W. Weekley
20-9	Albin Gesek
20-10	David W. Weekley
20-11	Antero Resources Corp.
20-11.4	Bryan Ireland
20-12	Albin Gesek
20-12.1	Albin Gesek
20-13	David Pierce
20-13.1	Dallas Smith
20-17	Christopher Cross
20-18	Richard Pierce
20-19	Charles Adams
20-20	Mark Spiker
20-21	Charles Adams
20-3	Dallas Smith
21-5	James Beak
26-6	Mark Spiker
26-6.1	Earl Fleisher
26-7	Donald Sheets
26-8	Mark Spiker
26-9	Donald Sheets
26-14	Mark Spiker
26-14.1	Mark Spiker
26-15	Mark Spiker
26-16	South Fork Sportmen Assn, Inc.
26-16.1	South Fork Sportmen Assn, Inc.
26-17	South Fork Sportmen Assn, Inc.
26-26	Marvin Brissett
26-27	South Fork Sportmen Assn, Inc.
26-30	South Fork Sportmen Assn, Inc.
27-1	Linda Jennings
27-1.1	Linda Jennings
27-2	Randall Hess
27-3	Steven Lusk
27-3.1	Kent Grotjan
27-3.5	Joshua Friedman
27-3.6	Lillian Martin
27-11	Miles Ball
27-10	Randall Pierce
27-10.1	Randall Pierce
27-16	Clerence Bush
27-20	South Fork Sportmen Assn, Inc.
27-21	Maxson Land LLC
27-22	Clerence Bush
32-1	Stanley Echard
32-1.3	Stanley Echard
32-2	Harold Pierce

I, THE UNDERSIGNED, HEREBY CERTIFY THAT THIS PLAT IS CORRECT TO THE BEST OF MY KNOWLEDGE AND BELIEF AND SHOWS ALL THE INFORMATION REQUIRED BY LAW AND THE RULES ISSUED AND PERSCRIBED BY THE DEPARTMENT OF ENVIRONMENTAL PROTECTION.



STATE OF WEST VIRGINIA, DIVISION  
OF ENVIRONMENTAL PROTECTION,  
OFFICE OF OIL AND GAS  
  
WILLOW LAND SURVEYING PLLC  
220 MASONIC AVE. PENNSBORO  
WEST VIRGINIA 26415

JOB # 15-058WA	LEGEND
DRAWING # MAXSON2HR2S	Surface Owner Boundary Lines +/-
SCALE 1" = 2000'	Adjoining Surface Tracts +/-
MINIMUM DEGREE OF ACCURACY SUBMETER	Found monument, as noted
PROVEN SOURCE OF ELEV. SUBMETER MAPPING GRADE GPS	<i>Thomas Summers</i>
STATE OF WEST VIRGINIA DEPARTMENT OF ENERGY DIVISION OF OIL AND GAS	THOMAS SUMMERS P.S. 2109
	DATE 09/02/21
	OPERATOR'S WELL# MAXSON UNIT #2H

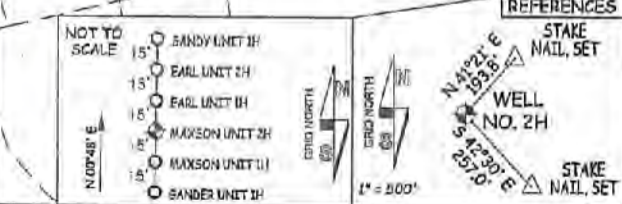

WELL TYPE: OIL  GAS  LIQUID INJECTION  WASTE DISPOSAL  47 - 085 - 10413 H6A  
(IF "GAS") PRODUCTION  STORAGE  DEEP  SHALLOW  STATE COUNTY PERMIT  
LOCATION: ELEVATION 1,138'-ORIGINAL 1,125'-PROPOSED WATERSHED SOUTH FORK HUGHES RIVER  
QUADRANGLE TH-PULLMAN 7.5' BH- OXFORD 7.5' DISTRICT UNION COUNTY RITCHIE  
SURFACE OWNER DAVID W. & DAVID MARTIN WEEKLEY ACREAGE 39.87 ACRES +/- 12/24/2021  
OIL & GAS ROYALTY OWNER T.D. DOTSON ET UX; JOHN M. DEBRULAR ET UX; BRADFORD SPIKER ET UX; LEASE ACREAGE 39.87 AC. ±; 154AC. ±; 52 AC. ±;

PROPOSED WORK: DRILL  CONVERT  DRILL DEEPER  REDRILL  FRACTURE OR STIMULATE   
PLUG OFF OLD FORMATION  PERFORATE NEW FORMATION  OTHER PHYSICAL CHANGE IN WELL  
(SPECIFY)  PLUG & ABANDON  CLEAN OUT & REPLUG  
TARGET FORMATION MARCELLUS ESTIMATED DEPTH 7,000' TVD 9,400' MD  
WELL OPERATOR ANTERO RESOURCES CORP. DESIGNATED AGENT DIANNA STAMPER - CT CORPORATION SYSTEM  
ADDRESS 1615 WYNKOOP ST. ADDRESS 5400 D BIG TYLER ROAD  
DENVER, CO 80202 CHARLESTON, WV 25313

2,327' 10" BOTTOM HOLE LONGITUDE 80°50'00"

14,073'

LONGITUDE 80°52'30"

COUNTY NAME

PERMIT



Antero Resources Corporation Well No. Maxson Unit 2H

NOTES:

WELL 2H TOP HOLE INFORMATION: N: 246,901ft E: 1,610,058ft 2H BOTTOM LAT: 39°09'37.00" LON: 80°52'31.39" HOLE

BOTTOM HOLE INFORMATION: N: 243,455ft E: 1,610,489ft LAT: 39°09'37.00" LON: 80°52'25.24" WEST VIRGINIA COORDINATE SYSTEM OF 1927 NORTH ZONE. ZONE WAS DERIVED FROM MEASUREMENTS TAKEN WITH TRIMBLE GEOXT SUBMETER MAPPING GRADE GPS UNIT. PLAT ORIENTATION, CORNER, AND WELL REFERENCE TIE LINES ARE BASED ON GRID NORTH.

(NAD) 83 (UTM) ZONE 17 COORDS: WELL 2H TOP HOLE INFORMATION: N: 4,335,625m E: 510,780m BOTTOM HOLE INFORMATION: N: 4,334,580m E: 510,929m

(NAD) 27 (UTM) ZONE 17 COORDS: WELL 2H TOP HOLE INFORMATION: N: 14,223,748ft E: 1,675,735ft POINT OF ENTRY INFORMATION: N: 14,224,121ft E: 1,674,930ft BOTTOM HOLE INFORMATION: N: 14,220,320ft E: 1,676,224ft

NOTE: NO OCCUPIED DWELLINGS OR BUILDINGS TWO THOUSAND FIVE HUNDRED (2,500) SQUARE FEET OR LARGER USED TO HOUSE OR SHELTER DAIRY CATTLE OR POULTRY HUSBANDRY ARE LOCATED WITHIN SIX HUNDRED TWENTY-FIVE (625) FEET OF THE CENTER OF THE WELL PAD.

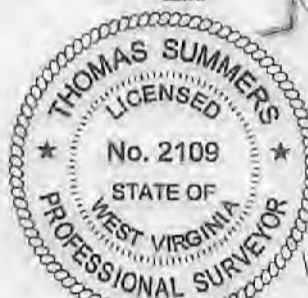

Table listing lease numbers and owners in Ritchie County, West Virginia. Owners include David W. Weekley, Albin Gesek, Bryon Ireland, Dallas Smith, Christopher Cress, Richard Pierce, Charles Adams, Mark Spiker, James Besk, Earl Fleaher, Donald Sheets, Mark Spiker, Donald Sheets, Mark Spiker, Mark Spiker, South Fork Sportmen Assn, Inc., Linda Jennings, Linda Jennings, Randall Hess, Steven Lush, Kent Grafton, Joshua Friedman, Lillian Martin, Miles Ball, Randall Pierce, Randall Pierce, Clarence Bush, South Fork Sportmen Assn, Inc., Maxson Land LLC, Clarence Bush, Stanley Echard, Stanley Echard, Harold Pierce.

2,327' TO BOTTOM HOLE LONGITUDE 80°50'00"

14,073' LONGITUDE 80°52'30"

I, THE UNDERSIGNED, HEREBY CERTIFY THAT THIS PLAT IS CORRECT TO THE BEST OF MY KNOWLEDGE AND BELIEF AND SHOWS ALL THE INFORMATION REQUIRED BY LAW AND THE RULES ISSUED AND PERSCRIBED BY THE DEPARTMENT OF ENVIRONMENTAL PROTECTION.



STATE OF WEST VIRGINIA, DIVISION OF ENVIRONMENTAL PROTECTION, OFFICE OF OIL AND GAS. WILLOW LAND SURVEYING PLLC 220 MASONIC AVE. PENNSBORO WEST VIRGINIA 26415

JOB # 15-059WA DRAWING # MAXSON2HR2S SCALE 1" = 2000' MINIMUM DEGREE OF ACCURACY SUBMETER PROVEN SOURCE OF ELEV. SUBMETER MAPPING GRADE GPS STATE OF WEST VIRGINIA DEPARTMENT OF ENERGY DIVISION OF OIL AND GAS

LEGEND: Surface Owner Boundary Lines +/-, Adjoining Surface Tracts +/-, Found monument, as noted. Signature of Thomas Summers, P.S. 2109. DATE 09/02/21 OPERATOR'S WELL # MAXSON UNIT #2H

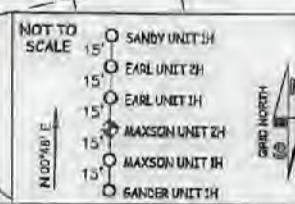

WELL TYPE: OIL GAS X LIQUID INJECTION WASTE DISPOSAL 47 085 -10413,64 (IF "GAS") PRODUCTION X STORAGE DEEP SHALLOW X STATE COUNTY PERMIT LOCATION: ELEVATION 1,138'-ORIGINAL 1,125'-PROPOSED WATERSHED SOUTH FORK HUGHES RIVER QUADRANGLE TH-PULLMAN 7.5 BH-OXFORD 7.5 DISTRICT UNION COUNTY RITCHIE SURFACE OWNER DAVID W. & DAVID MARTIN WEEKLEY ACREAGE 39.87 ACRES +/- 12/24/2021 OIL & GAS ROYALTY OWNER T.D. DOTSON ET UX; JOHN M. DEBRULAR ET UX; BRADFORD SPIKER ET UX; LEASE ACREAGE 39.87 AC +/- 154AC +/- 52 AC +/-

PROPOSED WORK: DRILL X CONVERT DRILL DEEPER REDRILL FRACTURE OR STIMULATE X PLUG OFF OLD FORMATION PERFORATE NEW FORMATION X OTHER PHYSICAL CHANGE IN WELL (SPECIFY) PLUG & ABANDON CLEAN OUT & REPLUG TARGET FORMATION MARCELLUS ESTIMATED DEPTH 7,000' TVD 9,400' MD WELL OPERATOR ANTERO RESOURCES CORP. DESIGNATED AGENT DIANNA STAMPER-CT CORPORATION SYSTEM ADDRESS 1615 WYNKOOP ST. ADDRESS 5400 D BIG TYLER ROAD DENVER, CO 80202 CHARLESTON, WV 25313