

LATITUDE 39°12'30" 109'

LATITUDE 39°10'00" 7,377' TO BOTTOM HOLE

Antero Resources Corporation Well No. Earl Unit 1H

AS DRILLED DATA: WELL 1H TOP HOLE INFORMATION: N: 246,916ft E: 1,610,058ft LAT: 39°10'11.05" LON: 80°52'31.39" BOTTOM HOLE INFORMATION: N: 234,564ft E: 1,614,421ft LAT: 39°08'09.62" LON: 80°51'33.62" WEST VIRGINIA COORDINATE SYSTEM OF 1927 NORTH ZONE. ZONE WAS DERIVED FROM MEASUREMENTS TAKEN WITH TRIMBLE GEOXT SUBMETER MAPPING GRADE GPS UNIT. PLAT ORIENTATION, CORNER, AND WELL REFERENCE TIE LINES ARE BASED ON GRID NORTH.

(NAD) 83 (UTM) ZONE 17 COORDS: WELL 1H TOP HOLE INFORMATION: N: 4,335,629m E: 510,779m BOTTOM HOLE INFORMATION: N: 4,331,888m E: 512,172m

WELL 1H POINT OF ENTRY INFORMATION: WV STATE PLANE NAD '27 (NORTH ZONE): N: 247,543ft E: 1,610,241ft GEOGRAPHIC (NAD) 27: LAT: 39°10'17.27" LON: 80°52'29.19" (NAD) 83 (UTM) ZONE 17 COORDS: N: 4,335,821m E: 510,832m

Table listing landowners and lease information for various tracts, including names like David W. Weekley, Albin Gesek, and Antero Resources Corp.

WV NORTH ZONE GRID NORTH

11,168' TO BOTTOM HOLE

14,058'

LONGITUDE 80°50'00"

LONGITUDE 80°52'30"

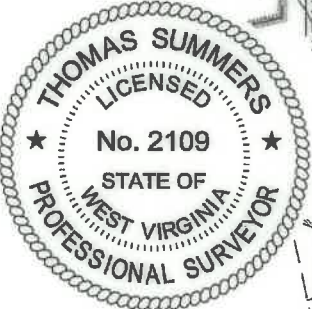

I THE UNDERSIGNED, HEREBY CERTIFY THAT THIS PLAT IS CORRECT TO THE BEST OF MY KNOWLEDGE AND BELIEF AND SHOWS ALL THE INFORMATION REQUIRED BY LAW AND THE RULES ISSUED AND PERSCRIBED BY THE DEPARTMENT OF ENVIRONMENTAL PROTECTION.



STATE OF WEST VIRGINIA, DIVISION OF ENVIRONMENTAL PROTECTION, OFFICE OF OIL AND GAS. WILLOW LAND SURVEYING PLLC 220 MASONIC AVE. PENNSBORO WEST VIRGINIA 26415

JOB # 16-04WA DRAWING # EARL1HAD SCALE 1" = 2000' MINIMUM DEGREE OF ACCURACY SUBMETER PROVEN SOURCE OF ELEV. SUBMETER MAPPING GRADE GPS STATE OF WEST VIRGINIA DEPARTMENT OF ENERGY DIVISION OF OIL AND GAS

LEGEND: Surface Owner Boundary Lines +/- Interior Surface Tracts +/- Proposed Well Path As Drilled Well Path. THOMAS SUMMERS P.S. 2109 DATE 8/19/22 OPERATOR'S WELL# EARL UNIT #1H

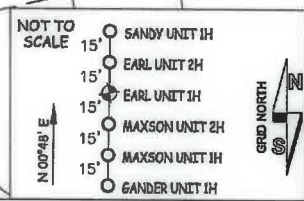

- NOTES: 1. NO OCCUPIED DWELLINGS OR BUILDINGS TWO THOUSAND FIVE HUNDRED (2,500) SQUARE FEET OR LARGER USED TO HOUSE OR SHELTER DAIRY CATTLE OR POULTRY HUSBANDRY ARE LOCATED WITHIN SIX HUNDRED TWENTY-FIVE (625) FEET OF THE CENTER OF THE WELL PAD. 2. TOP HOLE DATA SHOWN HEREON WAS PROVIDED BY ANTERO RESOURCES CORPORATION. 3. AS DRILLED DATA WAS PROVIDED BY ANTERO RESOURCES CORPORATION. 4. WLS IS NOT CERTIFYING THE DATA AND INFORMATION PROVIDED LISTED IN NOTES 2 AND 3, ONLY THE RELATIONSHIP TO THE DATA AND INFORMATION PROVIDED TO THE LEASE BOUNDARIES. 5. WLS IS BY NO MEANS RESPONSIBLE FOR ANY ERRORS OR INACCURACIES WITH THE DATA AND INFORMATION THAT HAS BEEN PROVIDED.

WELL TYPE: OIL ___ GAS X LIQUID INJECTION ___ WASTE DISPOSAL ___ 47 - 085 - 10414 (IF "GAS") PRODUCTION X STORAGE ___ DEEP ___ SHALLOW X STATE COUNTY PERMIT LOCATION: ELEVATION 1,125' - AS BUILT WATERSHED SOUTH FORK HUGHES RIVER QUADRANGLE TH - PULLMAN 7.5' BH - OXFORD 7.5' DISTRICT UNION COUNTY RITCHIE SURFACE OWNER DAVID W. & DAVID MARTIN WEEKLEY ACREAGE 39.87 ACRES +/- OIL & GAS ROYALTY OWNER T. D. DOTSON ET UX; ALIX PRUNTY ET UX; EARL PIERCE ET UX; LEASE ACREAGE 39.87 AC +/-; 300AC +/-; 51 AC +/-; EDWARD PIERCE; DONALD J. SHEETS; MARY J. BRITTON ET AL; CHARLES MAXSON; GLEN MAXSON; 92 AC +/-; 89 AC +/-; 97 AC +/-; 70 AC +/-; 72.62 AC +/-; ELIZABETH E. BRITTON; HARRY H. SHEETS ET AL; BERNICE HAUGHT ET AL; ELVA MAXSON ET UX 115.5 AC +/-; 75 AC +/-; 66.75 AC +/-; 66 AC +/- PROPOSED WORK: DRILL ___ CONVERT ___ DRILL DEEPER ___ REDRILL ___ FRACTURE OR STIMULATE ___ PLUG OFF OLD FORMATION ___ PERFORATE NEW FORMATION ___ OTHER PHYSICAL CHANGE IN WELL (SPECIFY) AS DRILLED PLUG & ABANDON CLEAN OUT & REPLUG TARGET FORMATION MARCELLUS ESTIMATED DEPTH 6,534' TVD 20,536' MD WELL OPERATOR ANTERO RESOURCES CORP. DESIGNATED AGENT DIANNA STAMPER - CT CORPORATION SYSTEM ADDRESS 1615 WYNKOOP ST. ADDRESS 5400 D BIG TYLER ROAD FORM WW-6 DENVER, CO 80202 CHARLESTON, WV 25313

GRID NORTH HIGH

Antero Resources Corporation
Well No. Earl Unit 1H

AS DRILLED DATA:
WELL 1H TOP HOLE INFORMATION:
N: 546,916ft E: 1,610,088ft
LAT: 39°10'11.08" LON: 80°25'31.32"
02/10/2023

WELL 1H TOP HOLE INFORMATION:
N: 4,332,623m E: 810,772m
LAT: 39°08'09.82" LON: 80°21'33.62"
WEST VIRGINIA COORDINATE SYSTEM OF 1927 NORTH ZONE
MEASUREMENTS TAKEN WITH TRIMBLE GEOXT SUBMETER
MAPPING GRADE 625 UNIT.
FLAT ORIENTATION, CORNER, PLAT WELL REFERENCE LINES ARE BASED ON GRID NORTH.

WELL 1H TOP HOLE INFORMATION:
N: 4,331,888m E: 812,175m
LAT: 39°10'17.27" LON: 80°25'29.12"
WEST VIRGINIA COORDINATE SYSTEM OF 1927 NORTH ZONE
MEASUREMENTS TAKEN WITH TRIMBLE GEOXT SUBMETER
MAPPING GRADE 625 UNIT.
FLAT ORIENTATION, CORNER, PLAT WELL REFERENCE LINES ARE BASED ON GRID NORTH.

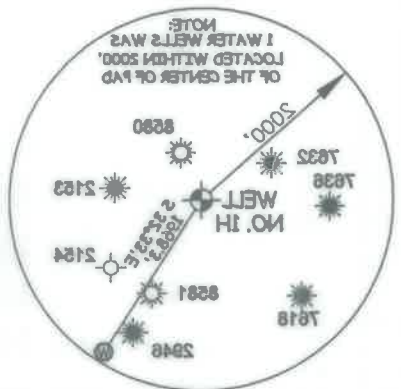

STATE OF WEST VIRGINIA
DIVISION OF OIL AND GAS
OFFICE OF ENVIRONMENTAL PROTECTION
WILLOW LAND SURVEYING P.L.L.C.
520 MASONIC AVE. PENNSBORO
WEST VIRGINIA 26115

STATE OF WEST VIRGINIA
DEPARTMENT OF ENERGY
DIVISION OF OIL AND GAS
DATE 8/10/23
THOMAS SUMMERS P.S. 2109

THE UNDERSIGNED, HEREBY CERTIFY THAT THIS PLAT IS CORRECT TO THE BEST OF MY KNOWLEDGE AND BELIEF AND SHOWS ALL THE INFORMATION REQUIRED BY LAW AND THE RULES ISSUED AND PERSCRIBED BY THE DEPARTMENT OF ENVIRONMENTAL PROTECTION.

JOB # 18-044WA	DRAWING # EARL1HAD	SCALE 1" = 2000'	MINIMUM DEGREE OF ACCURACY SUBMETER	PROVEN SOURCE OF ELEV. SUBMETER MAPPING GRADE GPS	STATE OF WEST VIRGINIA DEPARTMENT OF ENERGY DIVISION OF OIL AND GAS
LEGEND	As Drilled Well Path	Proposed Well Path	Interior Surface Tracts +/-	Surface Owner Boundary Lines +/-	THOMAS SUMMERS P.S. 2109

WELL TYPE: OIL GAS X LIQUID INJECTION WASTE DISPOSAL
(IF "GAS") PRODUCTION X STORAGE DEEP SHALLOW X
LOCATION: ELEVATION 1122.42 BUILT
QUADRANGLE TH - PULLMAN T.S. BH - OXFORD T.S.
SURFACE OWNER DAVID W. & DAVID MARTIN WEEKLEY
OIL & GAS ROYALTY OWNER T. D. DOTSON ET UX: ALIX PRUNTY ET UX: EARL PIERCE ET UX: LEASE ACREAGE 39.87 AC +/- 300AC +/- 81 AC +/-
EDWARD PIERCE DONALD J. SHEETS MARY J. BRITTON ET AL: CHARLES MAXSON: GLEN MAXSON: 82 AC +/- 88 AC +/- 70 AC +/- 72.82 AC +/-
ELIZABETH E. BRITTON: HARRY H. SHEETS ET AL: BERNICE HAUGHT ET AL: ELVA MAXSON ET UX: 112.5 AC +/- 75 AC +/- 88.75 AC +/- 88 AC +/-
PROPOSED WORK: DRILL CONVERT DRILL DEEPER REDRILL FRACTURE OR STIMULATE
PLUG OFF OLD FORMATION PERFORATE NEW FORMATION OTHER PHYSICAL CHANGE IN WELL
(SPECIFY) AS DRILLED
TARGET FORMATION MARCELLUS
WELL OPERATOR ANTERO RESOURCES CORP.
ADDRESS 1615 WYMKOP ST. DENVER, CO 80205
DESIGNATED AGENT DIANNA STAMPER - CT CORPORATION SYSTEM
CLEAN OUT & REPLUG
PERMIT 10414

Union District - Ritchie County

14-13	David W. Weekley
14-12	David W. Weekley
14-11	David W. Weekley
14-10	David W. Weekley
14-9	David W. Weekley
14-8	David W. Weekley
14-7	David W. Weekley
14-6	David W. Weekley
14-5	David W. Weekley
14-4	David W. Weekley
14-3	David W. Weekley
14-2	David W. Weekley
14-1	David W. Weekley
14-0	David W. Weekley
13-14	David W. Weekley
13-13	David W. Weekley
13-12	David W. Weekley
13-11	David W. Weekley
13-10	David W. Weekley
13-9	David W. Weekley
13-8	David W. Weekley
13-7	David W. Weekley
13-6	David W. Weekley
13-5	David W. Weekley
13-4	David W. Weekley
13-3	David W. Weekley
13-2	David W. Weekley
13-1	David W. Weekley
12-14	David W. Weekley
12-13	David W. Weekley
12-12	David W. Weekley
12-11	David W. Weekley
12-10	David W. Weekley
12-9	David W. Weekley
12-8	David W. Weekley
12-7	David W. Weekley
12-6	David W. Weekley
12-5	David W. Weekley
12-4	David W. Weekley
12-3	David W. Weekley
12-2	David W. Weekley
12-1	David W. Weekley
11-14	David W. Weekley
11-13	David W. Weekley
11-12	David W. Weekley
11-11	David W. Weekley
11-10	David W. Weekley
11-9	David W. Weekley
11-8	David W. Weekley
11-7	David W. Weekley
11-6	David W. Weekley
11-5	David W. Weekley
11-4	David W. Weekley
11-3	David W. Weekley
11-2	David W. Weekley
11-1	David W. Weekley
10-14	David W. Weekley
10-13	David W. Weekley
10-12	David W. Weekley
10-11	David W. Weekley
10-10	David W. Weekley
10-9	David W. Weekley
10-8	David W. Weekley
10-7	David W. Weekley
10-6	David W. Weekley
10-5	David W. Weekley
10-4	David W. Weekley
10-3	David W. Weekley
10-2	David W. Weekley
10-1	David W. Weekley
9-14	David W. Weekley
9-13	David W. Weekley
9-12	David W. Weekley
9-11	David W. Weekley
9-10	David W. Weekley
9-9	David W. Weekley
9-8	David W. Weekley
9-7	David W. Weekley
9-6	David W. Weekley
9-5	David W. Weekley
9-4	David W. Weekley
9-3	David W. Weekley
9-2	David W. Weekley
9-1	David W. Weekley
8-14	David W. Weekley
8-13	David W. Weekley
8-12	David W. Weekley
8-11	David W. Weekley
8-10	David W. Weekley
8-9	David W. Weekley
8-8	David W. Weekley
8-7	David W. Weekley
8-6	David W. Weekley
8-5	David W. Weekley
8-4	David W. Weekley
8-3	David W. Weekley
8-2	David W. Weekley
8-1	David W. Weekley
7-14	David W. Weekley
7-13	David W. Weekley
7-12	David W. Weekley
7-11	David W. Weekley
7-10	David W. Weekley
7-9	David W. Weekley
7-8	David W. Weekley
7-7	David W. Weekley
7-6	David W. Weekley
7-5	David W. Weekley
7-4	David W. Weekley
7-3	David W. Weekley
7-2	David W. Weekley
7-1	David W. Weekley
6-14	David W. Weekley
6-13	David W. Weekley
6-12	David W. Weekley
6-11	David W. Weekley
6-10	David W. Weekley
6-9	David W. Weekley
6-8	David W. Weekley
6-7	David W. Weekley
6-6	David W. Weekley
6-5	David W. Weekley
6-4	David W. Weekley
6-3	David W. Weekley
6-2	David W. Weekley
6-1	David W. Weekley
5-14	David W. Weekley
5-13	David W. Weekley
5-12	David W. Weekley
5-11	David W. Weekley
5-10	David W. Weekley
5-9	David W. Weekley
5-8	David W. Weekley
5-7	David W. Weekley
5-6	David W. Weekley
5-5	David W. Weekley
5-4	David W. Weekley
5-3	David W. Weekley
5-2	David W. Weekley
5-1	David W. Weekley
4-14	David W. Weekley
4-13	David W. Weekley
4-12	David W. Weekley
4-11	David W. Weekley
4-10	David W. Weekley
4-9	David W. Weekley
4-8	David W. Weekley
4-7	David W. Weekley
4-6	David W. Weekley
4-5	David W. Weekley
4-4	David W. Weekley
4-3	David W. Weekley
4-2	David W. Weekley
4-1	David W. Weekley
3-14	David W. Weekley
3-13	David W. Weekley
3-12	David W. Weekley
3-11	David W. Weekley
3-10	David W. Weekley
3-9	David W. Weekley
3-8	David W. Weekley
3-7	David W. Weekley
3-6	David W. Weekley
3-5	David W. Weekley
3-4	David W. Weekley
3-3	David W. Weekley
3-2	David W. Weekley
3-1	David W. Weekley
2-14	David W. Weekley
2-13	David W. Weekley
2-12	David W. Weekley
2-11	David W. Weekley
2-10	David W. Weekley
2-9	David W. Weekley
2-8	David W. Weekley
2-7	David W. Weekley
2-6	David W. Weekley
2-5	David W. Weekley
2-4	David W. Weekley
2-3	David W. Weekley
2-2	David W. Weekley
2-1	David W. Weekley
1-14	David W. Weekley
1-13	David W. Weekley
1-12	David W. Weekley
1-11	David W. Weekley
1-10	David W. Weekley
1-9	David W. Weekley
1-8	David W. Weekley
1-7	David W. Weekley
1-6	David W. Weekley
1-5	David W. Weekley
1-4	David W. Weekley
1-3	David W. Weekley
1-2	David W. Weekley
1-1	David W. Weekley

LATITUDE 39.15.30" 108

LATITUDE 39.10.00"

11' 88.10 BOTTOM HOLE

1' 028.

LONGITUDE 80.20.00"

LONGITUDE 80.25.30"

1. NO COVERED DWELLINGS OR BUILDINGS TWO THOUSAND (2000) SQUARE FEET OR LARGER USED TO HOUSE OR SHEDDY OR OTHER USES. HIGHLIGHTED ARE LOCATED ON THE CENTER OF THE WELL PAD. 2. TOP HOLE DATA SHOWS SECTION WAS PROVIDED BY WATERED RESOURCES CORPORATION. 3. AS DRILLED DATA WAS PROVIDED BY WATERED RESOURCES CORPORATION. 4. THIS IS NOT CERTIFYING THE DATA AND INFORMATION PROVIDED LISTED IN NOTES 2 AND 3 ONLY THE RELIABILITY TO THE FRACTIONAL INTERESTS TO THE FRACTIONAL INTERESTS. 5. THIS IS BY NO MEANS RESPONSIBLE FOR ANY ERRORS OR INACCURACIES WITH THE DATA AND INFORMATION THAT HAS BEEN PROVIDED.

