

LATITUDE 39°12'30"

6,880'

LATITUDE 39°15'00"

11,080' TO BOTTOM HOLE

Antero Resources Corporation Well No. Twig 2H

| Union District - Ritchie County |                     |
|---------------------------------|---------------------|
| 9-9.1                           | Naomi Cunningham    |
| 9-14                            | John Lauke          |
| 9-15                            | Marvin Osborne      |
| 9-15.1                          | Marvin Osborne      |
| 9-16                            | Marvin Osborne      |
| 9-18                            | Jack Guthrie Trust  |
| 9-19                            | Twila Evitts        |
| 9-20                            | Twila Evitts        |
| 9-20.1                          | Mark Morrison       |
| 9-20.2                          | Brian Bonner        |
| 9-21                            | Stephanie Knight    |
| 9-22                            | Stephanie Knight    |
| 9-23                            | Marvin Osborne      |
| 14-3.3                          | Mary Harms          |
| 14-4                            | Stephanie Knight    |
| 14-4.1                          | Stephanie Knight    |
| 14-11                           | Nathaniel Hendricks |
| 14-11.6                         | Nathaniel Hendricks |
| 14-11.7                         | Nathaniel Hendricks |
| 14-11.8                         | Nathaniel Hendricks |
| 14-17                           | Ralph Thacker       |
| 14-20                           | David Weekley       |
| 15-1                            | Timothy Alexander   |
| 15-1.1                          | Ralph Thacker       |
| 15-2                            | Ralph Thacker       |
| 15-3                            | Larry Gander        |
| 15-4                            | Stout Valley Trust  |
| 15-5                            | Larry Gander        |
| 15-6                            | Ralph Thacker       |
| 15-7                            | Stephanie Knight    |
| 15-8                            | Stephanie Knight    |
| 21-1                            | Ralph Thacker       |
| 21-2                            | Brian Park Trust    |
| 21-3                            | Dallas Smith Et Al  |
| 21-4                            | Larry Gander        |
| 21-4.1                          | Joseph Bianchini    |
| 21-4.2                          | Marie Bianchini     |
| 21-4.3                          | Joseph Bianchini    |
| 21-5                            | James Beck Et Al    |
| 21-6                            | WF Smith            |
| 21-6.1                          | Lois Gander         |
| 21-7                            | Elmer Pierce        |
| 21-7.1                          | Larry Gander        |
| 21-7.2                          | Larry Gander        |
| 21-8.4                          | Brian Vansant       |
| 21-10                           | James Beck          |
| 21-10.1                         | Harvey Shepler      |
| 21-10.2                         | James Beck          |

| Southwest District - Doddridge County |                        |
|---------------------------------------|------------------------|
| 1-1                                   | Jeffrey Polan          |
| 4-2                                   | Cevasco Family Trust   |
| 4-10                                  | James Webb             |
| 4-11                                  | Juanita Leggett        |
| 4-14                                  | Juanita Leggett        |
| 4-16                                  | James Webb             |
| 4-18                                  | James Webb             |
| 4-19.3                                | CNG Transmission Corp. |
| 4-19.4                                | CNG Transmission Corp. |
| 4-19.5                                | Dana Hurst             |
| 4-19.7                                | James Webb             |
| 4-19.8                                | James Webb             |
| 4-19.9                                | James Webb             |
| 4-21                                  | Anthony Ayers          |
| 4-22                                  | Reed Zinn              |
| 4-24                                  | I.L. Morris            |
| 4-25                                  | Tina Osborne           |
| 4-25.1                                | Stanley Chipps         |
| 4-28.3                                | Alfred Farley          |
| 4-31                                  | Vicki Moore            |
| 4-31.2                                | Bradley Davis          |
| 4-34                                  | Carl Ravin             |
| 8-1                                   | Richard Brown          |
| 8-3                                   | Randall Russell        |
| 8-4                                   | John Gray Hrs          |
| 8-5                                   | Larry Gander           |
| 12-1                                  | David Ball             |

AS DRILLED DATA:  
 WELL 2H TOP HOLE INFORMATION:  
 N: 247,755ft E: 1,615,114ft  
 LAT: 39°10'20.09" LON: 80°51'27.36"  
 BOTTOM HOLE INFORMATION:  
 N: 261,049ft E: 1,611,111ft  
 LAT: 39°12'30.88" LON: 80°52'20.76"  
 WEST VIRGINIA COORDINATE SYSTEM OF 1927 NORTH ZONE.  
 ZONE WAS DERIVED FROM MEASUREMENTS TAKEN WITH TRIMBLE GEOXT SUBMETER MAPPING GRADE GPS UNIT. PLAT ORIENTATION, CORNER, AND WELL REFERENCE TIE LINES ARE BASED ON GRID NORTH.

(NAD) 83 (UTM) ZONE 17 COORDS:  
 WELL 2H TOP HOLE INFORMATION:  
 N: 4,335,910m E: 512,316m  
 BOTTOM HOLE INFORMATION:  
 N: 4,339,940m E: 511,028m

(NAD) 27 (UTM) ZONE 17 COORDS:  
 WELL 2H TOP HOLE INFORMATION:  
 N: 14,224,685ft E: 1,680,775ft  
 POINT OF ENTRY INFORMATION:  
 N: 14,224,874ft E: 1,681,988ft  
 BOTTOM HOLE INFORMATION:  
 N: 14,237,906ft E: 1,676,552ft

- NOTE
1. NO OCCUPIED DWELLINGS OR BUILDINGS TWO THOUSAND FIVE HUNDRED (2,500) SQUARE FEET OR LARGER USED TO HOUSE OR SHELTER DAIRY CATTLE OR POULTRY HUSBANDRY ARE LOCATED WITHIN SIX HUNDRED TWENTY-FIVE (625) FEET OF THE CENTER OF THE WELL PAD.
  2. TOP HOLE DATA SHOWN HEREON WAS PROVIDED BY ANTERO RESOURCES CORPORATION.
  3. AS DRILLED DATA WAS PROVIDED BY ANTERO RESOURCES CORPORATION.
  4. WLS IS NOT CERTIFYING THE DATA AND INFORMATION PROVIDED LISTED IN NOTES 2 AND 3, ONLY THE RELATIONSHIP TO THE DATA AND INFORMATION PROVIDED TO THE LEASE BOUNDARIES.
  5. WLS IS BY NO MEANS RESPONSIBLE FOR ANY ERRORS OR INACCURACIES WITH THE DATA AND INFORMATION THAT HAS BEEN PROVIDED.

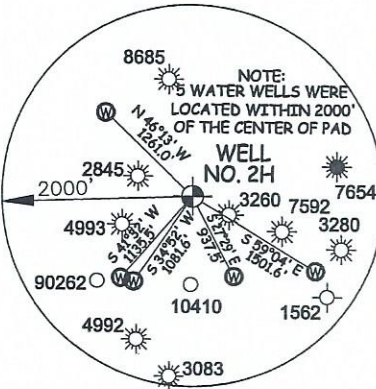

I THE UNDERSIGNED, HEREBY CERTIFY THAT THIS PLAT IS CORRECT TO THE BEST OF MY KNOWLEDGE AND BELIEF AND SHOWS ALL THE INFORMATION REQUIRED BY LAW AND THE RULES ISSUED AND PERSCRIBED BY THE DEPARTMENT OF ENVIRONMENTAL PROTECTION.



STATE OF WEST VIRGINIA, DIVISION OF ENVIRONMENTAL PROTECTION, OFFICE OF OIL AND GAS

WILLOW LAND SURVEYING PLLC  
 220 MASONIC AVE. PENNSBORO WEST VIRGINIA 26415

JOB # 23-007WA  
 DRAWING # TWIG2HAD  
 SCALE 1" = 2000'  
 MINIMUM DEGREE OF ACCURACY SUBMETER  
 PROVEN SOURCE OF ELEV. SUBMETER MAPPING GRADE GPS

| LEGEND |                                  |
|--------|----------------------------------|
| ---    | Surface Owner Boundary Lines +/- |
| ---    | Interior Surface Tracts +/-      |
| ○      | Proposed Well Path               |
| ⊗      | As Drilled Well Path             |

THOMAS SUMMERS P.S. 2109  
 DATE 05/07/24  
 OPERATOR'S WELL# TWIG 2H

STATE OF WEST VIRGINIA DEPARTMENT OF ENERGY DIVISION OF OIL AND GAS

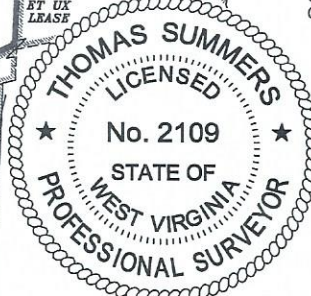
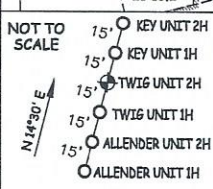

WELL TYPE: OIL \_\_\_ GAS X LIQUID INJECTION \_\_\_ WASTE DISPOSAL \_\_\_ 47 \_\_\_ 085 \_\_\_ 10499  
 (IF "GAS") PRODUCTION X STORAGE \_\_\_ DEEP \_\_\_ SHALLOW X STATE COUNTY PERMIT  
 LOCATION: ELEVATION 1,019' -AS-BUILT WATERSHED SOUTH FORK HUGHES RIVER  
 QUADRANGLE OXFORD 7.5' DISTRICT UNION COUNTY RITCHIE  
 SURFACE OWNER ELMER W. PIERCE ACREAGE 67.78 ACRES +/-  
 OIL & GAS ROYALTY OWNER R. F. KIESTER ET AL LEASE ACREAGE 70 AC±

PROPOSED WORK: DRILL \_\_\_ CONVERT \_\_\_ DRILL DEEPER \_\_\_ REDRILL \_\_\_ FRACTURE OR STIMULATE \_\_\_  
 PLUG OFF OLD FORMATION \_\_\_ PERFORATE NEW FORMATION \_\_\_ OTHER PHYSICAL CHANGE IN WELL \_\_\_  
 (SPECIFY) AS DRILLED PLUG & ABANDON \_\_\_ CLEAN OUT & REPLUG \_\_\_  
 TARGET FORMATION MARCELLUS ESTIMATED DEPTH 6,513' TVD 20,977' MD  
 WELL OPERATOR ANTERO RESOURCES CORP. DESIGNATED AGENT KEVIN ELLIS  
 ADDRESS 1615 WYNKOOP ST. ADDRESS 535 WHITE OAK BLVD.  
 FORM WW-6 DENVER, CO 80202 BRIDGEPORT, WV 26330

06/14/2024

COUNTY NAME PERMIT