

LATITUDE 39°12'30" 10,361' TO BOTTOM HOLE 6,876'

LATITUDE 39°15'00" 10,361' TO BOTTOM HOLE

Antero Resources Corporation Well No. Key 1H

Union District - Ritchie County	
9-9.1	Naomi Cunningham
9-14	John Louke
9-15	Marvin Osborne
9-15.1	Marvin Osborne
9-16	Marvin Osborne
9-18	Jack Guthrie Trust
9-19	Twila Evtits
9-20	Twila Evtits
9-20.1	Mark Morrison
9-20.2	Brian Banner
9-21	Stephanie Knight
9-22	Stephanie Knight
9-23	Marvin Osborne
14-3.3	Mary Harms
14-4	Stephanie Knight
14-4.1	Stephanie Knight
14-11	Nathaniel Hendricks
14-11.6	Nathaniel Hendricks
14-11.7	Nathaniel Hendricks
14-11.8	Nathaniel Hendricks
14-17	Ralph Thacker
14-20	David Waszley
15-1	Timothy Alexander
15-1.1	Ralph Thacker
15-2	Ralph Thacker
15-3	Larry Gander
15-4	Stout Valley Trust
15-5	Larry Gander
15-6	Ralph Thacker
15-7	Stephanie Knight
15-8	Stephanie Knight
21-1	Ralph Thacker
21-2	Briar Fork Trust
21-3	Dallas Smith Et Al
21-4	Larry Gander
21-4.1	Joseph Bianchini
21-4.2	Marie Bianchini
21-4.3	Joseph Bianchini
21-5	James Beck Et Al
21-6	WF Smith
21-6.1	Lols Gander
21-7	Elmer Pierce
21-7.1	Larry Gander
21-7.2	Larry Gander
21-8.4	Brian Vansant
21-10	James Beck
21-10.1	Harvey Shepler
21-10.2	James Beck

NOTE

- NO OCCUPIED DWELLINGS OR BUILDINGS TWO THOUSAND FIVE HUNDRED (2,500) SQUARE FEET OR LARGER USED TO HOUSE OR SHELTER DAIRY CATTLE OR POULTRY HUSBANDRY ARE LOCATED WITHIN SIX HUNDRED TWENTY-FIVE (625) FEET OF THE CENTER OF THE WELL PAD.
- TOP HOLE DATA SHOWN HEREON WAS PROVIDED BY ANTERO RESOURCES CORPORATION.
- AS DRILLED DATA WAS PROVIDED BY ANTERO RESOURCES CORPORATION.
- WLS IS NOT CERTIFYING THE DATA AND INFORMATION PROVIDED LISTED IN NOTES 2 AND 3, ONLY THE RELATIONSHIP TO THE DATA AND INFORMATION PROVIDED TO THE LEASE BOUNDARIES.
- WLS IS BY NO MEANS RESPONSIBLE FOR ANY ERRORS OR INACCURACIES WITH THE DATA AND INFORMATION THAT HAS BEEN PROVIDED.

Southwest District - Doddridge County	
1-1	Jeffrey Polan
4-2	Cevasco Family Trust
4-10	James Webb
4-11	Juanita Leggett
4-14	Juanita Leggett
4-16	James Webb
4-18	James Webb
4-19.3	CNG Transmission Corp.
4-19.4	CNG Transmission Corp.
4-19.5	Dana Hurst
4-19.7	James Webb
4-19.8	James Webb
4-19.9	James Webb
4-21	Anthony Ayers
4-22	Reed Zinn
4-24	I L Morris
4-25	Tina Osborne
4-25.1	Stanley Chipps
4-28.3	Alfred Farley
4-31	Vicki Moore
4-31.2	Bradley Davis
4-34	Carl Ravin
8-1	Richard Brown
8-3	Randall Russell
8-4	John Gray Hrs
8-5	Larry Gander
12-1	David Ball

AS DRILLED DATA:

WELL 1H TOP HOLE INFORMATION:
N: 247,769ft E: 1,615,118ft
LAT: 39°10'20.23" LON: 80°51'27.31"

BOTTOM HOLE INFORMATION:
N: 261,925ft E: 1,611,843ft
LAT: 39°12'39.65" LON: 80°52'11.63"

WEST VIRGINIA COORDINATE SYSTEM OF 1927 NORTH ZONE. ZONE WAS DERIVED FROM MEASUREMENTS TAKEN WITH TRIMBLE GEOXT SUBMETER MAPPING GRADE GPS UNIT. PLAT ORIENTATION, CORNER, AND WELL REFERENCE TIE LINES ARE BASED ON GRID NORTH.

(NAD) 83 (UTM) ZONE 17 COORDS:

WELL 1H TOP HOLE INFORMATION:
N: 4,335,915m E: 512,317m

BOTTOM HOLE INFORMATION:
N: 4,340,211m E: 511,247m

(NAD) 27 (UTM) ZONE 17 COORDS:

WELL 1H TOP HOLE INFORMATION:
N: 14,224,699ft E: 1,680,778ft

POINT OF ENTRY INFORMATION:
N: 14,225,203ft E: 1,682,974ft

BOTTOM HOLE INFORMATION:
N: 14,238,794ft E: 1,677,269ft

WV NORTH ZONE GRID NORTH

14,199' TO BOTTOM HOLE

13,129'

LONGITUDE 80°50'00"

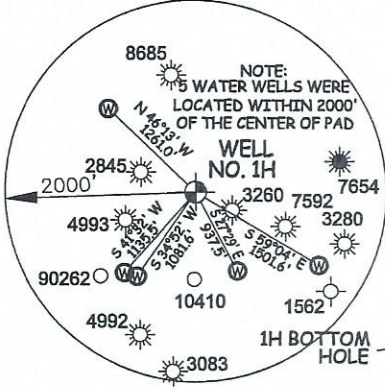

I THE UNDERSIGNED, HEREBY CERTIFY THAT THIS PLAT IS CORRECT TO THE BEST OF MY KNOWLEDGE AND BELIEF AND SHOWS ALL THE INFORMATION REQUIRED BY LAW AND THE RULES ISSUED AND PERSCRIBED BY THE DEPARTMENT OF ENVIRONMENTAL PROTECTION.



STATE OF WEST VIRGINIA, DIVISION OF ENVIRONMENTAL PROTECTION, OFFICE OF OIL AND GAS

WILLOW LAND SURVEYING PLLC
220 MASONIC AVE. PENNSBORO WEST VIRGINIA 26415

JOB # 23-007WA
DRAWING # KEY1HAD
SCALE 1" = 2000'
MINIMUM DEGREE OF ACCURACY SUBMETER
PROVEN SOURCE OF ELEV. SUBMETER MAPPING GRADE GPS

STATE OF WEST VIRGINIA DEPARTMENT OF ENERGY DIVISION OF OIL AND GAS

LEGEND

- Surface Owner Boundary Lines +/-
- Interior Surface Tracts +/-
- Proposed Well Path
- As Drilled Well Path

Thomas Summers
THOMAS SUMMERS P.S. 2109

DATE 05/07/24
OPERATOR'S WELL# KEY 1H

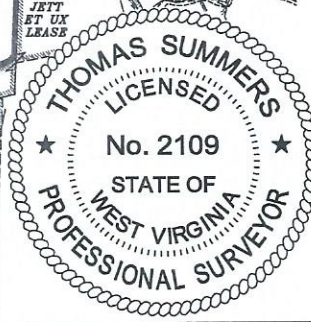
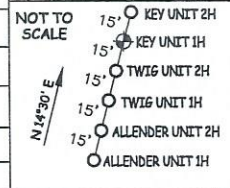

WELL TYPE: OIL ___ GAS X LIQUID INJECTION ___ WASTE DISPOSAL ___ 47 - 085 - 10500
(IF "GAS") PRODUCTION X STORAGE ___ DEEP ___ SHALLOW X STATE COUNTY PERMIT

LOCATION: ELEVATION 1,019' -AS-BUILT WATERSHED SOUTH FORK HUGHES RIVER
QUADRANGLE OXFORD 7.5' DISTRICT UNION COUNTY RITCHIE

SURFACE OWNER LARRY GANDER ET UX ACREAGE 17 ACRES +/- LEASE ACREAGE 50 AC.±

OIL & GAS ROYALTY OWNER B. GUY WHITEHAIR ET UX

PROPOSED WORK: DRILL ___ CONVERT ___ DRILL DEEPER ___ REDRILL ___ FRACTURE OR STIMULATE ___
PLUG OFF OLD FORMATION ___ PERFORATE NEW FORMATION ___ OTHER PHYSICAL CHANGE IN WELL
(SPECIFY) AS DRILLED PLUG & ABANDON CLEAN OUT & REPLUG

TARGET FORMATION MARCELLUS ESTIMATED DEPTH 6,520' TVD 21,933' MD

WELL OPERATOR ANTERO RESOURCES CORP. DESIGNATED AGENT KEVIN ELLIS

ADDRESS 1615 WYNKOOP ST. ADDRESS 535 WHITE OAK BLVD.
DENVER, CO 80202 BRIDGEPORT, WV 26330

COUNTY NAME PERMIT

06/14/2024