

LATITUDE 39°17'30" 2,216'

LATITUDE 39°15'00"

Antero Resources Corporation
Well No. Doll #1H

AS DRILLED DATA:

WELL 1H TOP HOLE INFORMATION:
N: 289,405ft E: 1,573,215ft
LAT: 39°17'05.12" LON: 81°00'28.18"
BOTTOM HOLE INFORMATION:
N: 272,805ft E: 1,581,298ft
LAT: 39°14'22.39" LON: 80°58'41.92"
WEST VIRGINIA COORDINATE
SYSTEM OF 1927 NORTH ZONE.
ZONE WAS DERIVED FROM
MEASUREMENTS TAKEN WITH
TRIMBLE GEOXT SUBMETER
MAPPING GRADE GPS UNIT.
PLAT ORIENTATION, CORNER,
AND WELL REFERENCE TIE LINES
ARE BASED ON GRID NORTH.

(NAD) 83 (UTM) ZONE 17 COORDS:
WELL 1H TOP HOLE INFORMATION:
N: 4,348,386m E: 499,339m
BOTTOM HOLE INFORMATION:
N: 4,343,370m E: 501,886m

(NAD) 27 (UTM) ZONE 17 COORDS:
WELL 1H TOP HOLE INFORMATION:
N: 14,265,616ft E: 1,638,201ft
POINT OF ENTRY INFORMATION:
N: 14,265,246ft E: 1,641,013ft
BOTTOM HOLE INFORMATION:
N: 14,249,158ft E: 1,646,558ft

PAD LAYOUT

NOT TO
SCALE

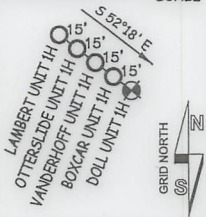

| | | |
|----|------------|---------|
| W1 | S 71°25' W | 1358.7' |
| W2 | S 62°13' W | 1490.5' |
| W3 | S 54°03' W | 1347.9' |
| W4 | S 48°45' W | 1249.2' |
| W5 | S 61°19' E | 645.2' |
| W6 | S 87°36' E | 1955.5' |

WELL NO. 1H

W1
W2
W3
W4
W5
W6

NOTE:
(6) WATER WELLS WERE
LOCATED WITHIN 2000'
OF THE CENTER OF PAD



STATE OF WEST VIRGINIA, DIVISION
OF ENVIRONMENTAL PROTECTION,
OFFICE OF OIL AND GAS

WILLOW LAND SURVEYING PLLC
220 MASONIC AVE. PENNSBORO
WEST VIRGINIA 26415

I, THE UNDERSIGNED, HEREBY CERTIFY THAT THIS PLAT IS CORRECT
TO THE BEST OF MY KNOWLEDGE AND BELIEF AND SHOWS ALL THE
INFORMATION REQUIRED BY LAW AND THE RULES ISSUED AND
PERSORIBED BY THE DEPARTMENT OF ENVIRONMENTAL PROTECTION.

NOTE
1. NO OCCUPIED DWELLINGS OR BUILDINGS TWO
THOUSAND FIVE HUNDRED (2,500) SQUARE FEET
OR LARGER USED TO HOUSE OR SHELTER DAIRY
CATTLE OR POULTRY HUSBANDRY ARE LOCATED
WITHIN SIX HUNDRED TWENTY-FIVE (625) FEET
OF THE CENTER OF THE WELL PAD.
2. TOP HOLE DATA SHOWN HEREON WAS
PROVIDED BY ANTERO RESOURCES
CORPORATION.
3. AS DRILLED DATA WAS PROVIDED BY ANTERO
RESOURCES CORPORATION.
4. WLS IS NOT CERTIFYING THE DATA AND
INFORMATION PROVIDED LISTED IN NOTES 2
AND 3, ONLY THE RELATIONSHIP TO THE DATA
AND INFORMATION PROVIDED TO THE LEASE
BOUNDARIES.
5. WLS IS BY NO MEANS RESPONSIBLE FOR ANY
ERRORS OR INACCURACIES WITH THE DATA AND
INFORMATION THAT HAS BEEN PROVIDED.

JOB # 23-020WA

DRAWING # DOLL1HAD

SCALE 1" = 2000'

MINIMUM DEGREE OF
ACCURACY SUBMETER

PROVEN SOURCE OF ELEV.
SUBMETER MAPPING GRADE GPS

STATE OF WEST VIRGINIA
DEPARTMENT OF ENERGY
DIVISION OF OIL AND GAS

LEGEND

- Surface Owner Boundary Lines +/-
- - - Interior Surface Tracts +/-
- Proposed Well Path
- ⊗ As Drilled Well Path

THOMAS SUMMERS P.S. 2109

DATE 02/11/25

OPERATOR'S WELL# DOLL UNIT #1H

| PENNSBORO CORPORATION RITCHIE COUNTY | |
|-----------------------------------------|------------------------------------------|
| 10-1 | JPE Hardwood Lumber Inc. |
| 10-1.1 | Tracey Tallman |
| 10-1.3 | Brenda Edmisten |
| 10-6 | Louwilda Satterfield |
| 10-7 | JPE Hardwood Lumber Inc. |
| 15-1 | Simonton Building Products Inc. |
| 15-2 | Pennsboro Industrial Park Dev. Authority |
| 15-3 | Pennsboro Industrial Park |
| 15-3.1 | Simonton Building Products Inc. |
| 15-3.3 | Simonton Building Products Inc. |
| 15-3.4 | Simonton Building Products Inc. |
| 15-3.5 | Simonton Building Products Inc. |
| 15-3.6 | Simply Blessed Designs & Rentals LLC |
| 15-6 | Charles Richards |

WELL TYPE: OIL GAS ☒ LIQUID INJECTION WASTE DISPOSAL 47 085 10516
(IF "GAS") PRODUCTION ☒ STORAGE DEEP SHALLOW ☒ STATE COUNTY PERMIT
LOCATION: ELEVATION AS BUILT - 1,025' WATERSHED NORTH FORK HUGHES RIVER 04/11/2025
QUADRANGLE ELLENBORO 7.5' DISTRICT CLAY COUNTY RITCHIE
SURFACE OWNER NELSON MARK HAYHURST ACREAGE 9.65 ACRES +/- LEASE ACREAGE 9.65 ACRES±
OIL & GAS ROYALTY OWNER EVELYN HAYHURST
PROPOSED WORK: DRILL CONVERT DRILL DEEPER REDRILL FRACTURE OR STIMULATE
PLUG OFF OLD FORMATION PERFORATE NEW FORMATION OTHER PHYSICAL CHANGE IN WELL
(SPECIFY) AS DRILLED PLUG & ABANDON CLEAN OUT & REPLUG
TARGET FORMATION MARCELLUS ESTIMATED DEPTH 6,319' TVD 24,122' MD
WELL OPERATOR ANTERO RESOURCES CORP. DESIGNATED AGENT KEVIN ELLIS
ADDRESS 1615 WYNKOOP ST. ADDRESS 535 WHITE OAKS BLVD
FORM WW-6 DENVER, CO 80202 BRIDGEPORT, WV 26330

COUNTY NAME
PERMIT