

12/20/2024

LATITUDE 39°17'30"

6,004'

LATITUDE 39°17'30"

6,301' TO BOTTOM HOLE

1,724' LONGITUDE 81°00'00"

4,404' TO BOTTOM HOLE LONGITUDE 81°00'00"

Antero Resources Corporation Well No. Saturn #1H

CLAY DISTRICT - RITCHIE COUNTY	
18-14.2	RONALD HAYHURST
24-04	DAVID LAWRENCE
24-4.1	ROGER HART
24-05	RICHARD BLOUIR
24-5.2	FREDERICK WANSTREET
24-21	FRANKLIN OWENS
24-22	CHARLES THOMAS
24-22.1	TRIPLE B TRUCKING INC
24-23	CLARENCE MCCULLOUGH
24-23.1	CLARENCE MCCULLOUGH
24-24	KIMBERLY BARNES
24-24.1	MATTHEW BLOUIR
24-33	CHRISTOPHER LANE
24-34	CRAIG HOGUE
24-34.1	CRAIG HOGUE
24-34.2	STONEWALL PROPERTY HOLDINGS LLC
24-34.4	BARNES & SONS TRUCKING LLC
24-34.5	RODNEY HOGUE
24-35	RICHARD LAMBERT
24-35.1	RICHARD LAMBERT
24-35.3	RICHARD LAMBERT
24-36	BRUCETON FARM SERVICE INC
24-36.1	RONALD LANE INC.
24-37	RONALD LANE INC.
24-37.1	PARKS PERKINS PROPERTIES LLC
24-38	CHRISTOPHER LANE
24-40.2	PARKS PERKINS PROPERTIES LLC
24-40.3	MICHAEL HALL
24-41	HALL FAMILY TRUST
24-41.1	NEW MARTINSVILLE SUPPLY COMPANY INC.
24-45	MICHAEL HALL
24-45.1	MICHAEL HALL
24-45.2	DAVID SEESE
24-45.3	ROBERT OWENS
24-45.4	PATRICK SEESE
24-45.5	DAVID SEESE
24-46	CLINTEN GILLIS
24-46.2	DAVID SEESE
24-59	RONALD LANE INC.
29-4.1	ROBERT SHIPE
29-4.2	ROBERT SHIPE
29-4.3	ROBERT SHIPE
29-4.4	ROBERT SHIPE
29-05	THE NATURE CONSERVANCY
29-10	JOHNNIE BOSTON
29-29	MARK MOSSOR
29-30	ERICA DEEM
29-31	LORRAINE RANKIN
29-31.1	CURTIS SEESE
29-32	WILLIAM EDMINSTER
29-33	AMOS BUNNER
29-47	ROBERT KOCH
29-49	ERICA DEEM
29-50	ERICA DEEM
29-51	ERICA DEEM

NOTES:  
 WELL 1H TOP HOLE INFORMATION:  
 N: 290,263ft E: 1,569,440ft  
 LAT: 39°17'12.97" LON: 81°01'16.37"  
 BOTTOM HOLE INFORMATION:  
 N: 287,588ft E: 1,569,099ft  
 LAT: 39°16'46.48" LON: 81°01'20.13"  
 WEST VIRGINIA COORDINATE SYSTEM OF 1927 NORTH ZONE. ZONE WAS DERIVED FROM MEASUREMENTS TAKEN WITH TRIMBLE GEOXT SUBMETER MAPPING GRADE GPS UNIT. PLAT ORIENTATION, CORNER, AND WELL REFERENCE TIE LINES ARE BASED ON GRID NORTH.

(NAD) 83 (UTM) ZONE 17 COORDS:  
 WELL 1H TOP HOLE INFORMATION:  
 N: 4,348,628m E: 498,185m  
 BOTTOM HOLE INFORMATION:  
 N: 4,347,811m E: 498,095m

(NAD) 27 (UTM) ZONE 17 COORDS:  
 WELL 1H TOP HOLE INFORMATION:  
 N: 14,266,410ft E: 1,634,414ft  
 POINT OF ENTRY INFORMATION:  
 N: 14,264,203ft E: 1,633,954ft  
 BOTTOM HOLE INFORMATION:  
 N: 14,263,731ft E: 1,634,118ft

PAD LAYOUT

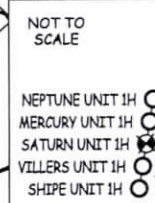

LEASES

A	WV DIVISION OF MULTIMODAL TRANSPORTATION FACILITIES
B	TOM G. STRICKLER JR. ET UX
C	KIMBERLY BARNES
D	NANCY LOUISE VAUGHN
T	VIRGINIA L. CONNERS
U	AGNES L. ROGERS
V	F. HAYHURST FAMILY TRUST
W	AGNES L. ROGERS
X	CLARENCE J. MCCULLOUGH ET UX
Y	RICHARD BLOUIR ET AL

WV NORTH ZONE GRID NORTH

WATER WELLS

W1	S 13°36' E	1772.1'
W2	N 87°26' W	929.2'
W3	S 24°40' W	864.4'
W4	S 19°28' E	906.8'
W5	S 27°55' E	993.1'
W6	S 40°30' E	1566.5'
W7	N 40°45' W	960.8'
W8	S 48°22' E	1604.4'
W9	S 52°09' E	1872.9'

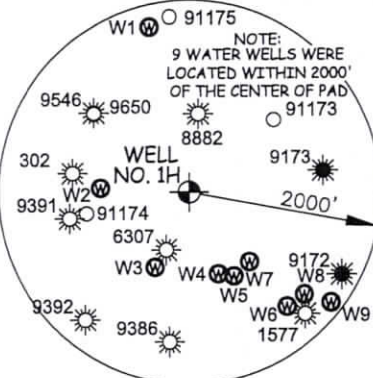

I THE UNDERSIGNED, HEREBY CERTIFY THAT THIS PLAT IS CORRECT TO THE BEST OF MY KNOWLEDGE AND BELIEF AND SHOWS ALL THE INFORMATION REQUIRED BY LAW AND THE RULES ISSUED AND PERSCRIBED BY THE DEPARTMENT OF ENVIRONMENTAL PROTECTION.



STATE OF WEST VIRGINIA, DIVISION OF ENVIRONMENTAL PROTECTION, OFFICE OF OIL AND GAS  
 WILLOW LAND SURVEYING PLLC  
 220 MASONIC AVE. PENNSBORO WEST VIRGINIA 26415

JOB # 23-010WA  
 DRAWING # SATURN1HSR  
 SCALE 1" = 2000'  
 MINIMUM DEGREE OF ACCURACY SUBMETER  
 PROVEN SOURCE OF ELEV. SUBMETER MAPPING GRADE GPS

LEGEND  
 ——— Surface Owner Boundary Lines +/-  
 - - - - - Adjoining Surface Tracts +/-  
 ⊕ Found monument, as noted

*Thomas Summers*  
 THOMAS SUMMERS P.S. 2109  
 DATE 11/06/24  
 OPERATOR'S WELL# SATURN UNIT #1H  
 47 - 085 - 1053b  
 STATE COUNTY PERMIT

NOTE  
 NO OCCUPIED DWELLINGS OR BUILDINGS TWO THOUSAND FIVE HUNDRED (2,500) SQUARE FEET OR LARGER USED TO HOUSE OR SHELTER DAIRY CATTLE OR POULTRY HUSBANDRY ARE LOCATED WITHIN SIX HUNDRED TWENTY-FIVE (625) FEET OF THE CENTER OF THE WELL PAD.

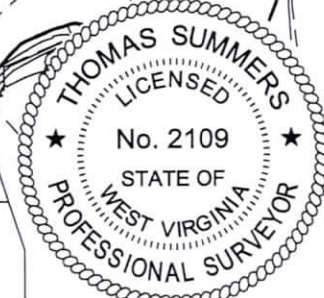

STATE OF WEST VIRGINIA DEPARTMENT OF ENERGY DIVISION OF OIL AND GAS

WELL TYPE: OIL \_\_\_ GAS X LIQUID INJECTION \_\_\_ WASTE DISPOSAL  
 (IF "GAS") PRODUCTION X STORAGE \_\_\_ DEEP \_\_\_ SHALLOW  
 LOCATION: ELEVATION PROPOSED - 1,007' WATERSHED NORTH FORK HUGHES RIVER  
 QUADRANGLE ELLENBORO 7.5' DISTRICT CLAY COUNTY RITCHIE  
 SURFACE OWNER RICHARD E. BLOUIR ET UX ACREAGE 53.682 ACRES +/-  
 OIL & GAS ROYALTY OWNER AGNES L. ROGERS LEASE ACREAGE 57 ACRES±  
 PROPOSED WORK: DRILL X CONVERT \_\_\_ DRILL DEEPER \_\_\_ REDRILL \_\_\_  
 FRACTURE OR STIMULATE X PLUG OFF OLD FORMATION PERFORATE NEW  
 FORMATION \_\_\_ OTHER PHYSICAL CHANGE IN WELL (SPECIFY) \_\_\_  
 PLUG & ABANDON \_\_\_ CLEAN OUT & REPLUG \_\_\_  
 TARGET FORMATION MARCELLUS ESTIMATED DEPTH 7,600' TVD 10,900' MD  
 WELL OPERATOR ANTERO RESOURCES CORP. DESIGNATED AGENT KEVIN ELLIS  
 ADDRESS 1615 WYNKOOP ST. ADDRESS 535 WHITE OAKS BLVD  
 FORM WW-6 DENVER, CO 80202 BRIDGEPORT, WV 26330

