

LATITUDE 39°17'30"

6,009'

LATITUDE 39°15'00"

1,439' TO BOTTOM HOLE

1,753' LONGITUDE 81°00'00"

6,165' TO BOTTOM HOLE LONGITUDE 81°00'00"

Antero Resources Corporation Well No. Shipe #1H

CLAY DISTRICT - RITCHIE COUNTY	
18-14.2	RONALD HAYHURST
18-17.1	CAROL SPANGLER
18-20.2	MICHAEL REED
24-02	KEVIN MINOR
24-04	DAVID LAWRENCE
24-4.1	ROGER HART
24-05	RICHARD BLOUIR
24-5.2	FREDERICK WANSTREET
24-21	FRANKLIN OWENS
24-21.1	RODNEY WEBBER
24-22	CHARLES THOMAS
24-22.1	TRIPLE B TRUCKING INC
24-23	CLARENCE MCCULLOUGH
24-23.1	CLARENCE MCCULLOUGH
24-24	KIMBERLY BARNES
24-24.1	MATTHEW BLOUIR
24-32	ANNA WILLIAMSON
24-36.1	RONALD LANE INC.
24-37	RONALD LANE INC.
24-37.1	PARKS PERKINS PROPERTIES LLC
24-40.1	WV DOT
24-40.2	PARKS PERKINS PROPERTIES LLC
24-40.3	MICHAEL HALL
24-40.5	HALL'S WVA WELDING EQUIPMENT INC.
24-40.6	MICHAEL HALL
24-41	HALL FAMILY TRUST
24-44.3	MICHAEL HALL
24-45.1	MICHAEL HALL
24-59	RONALD LANE INC.
29-04	ROBERT SHIPE
29-4.1	ROBERT SHIPE
29-4.2	ROBERT SHIPE
29-4.3	ROBERT SHIPE
29-4.4	ROBERT SHIPE
29-05	THE NATURE CONSERVANCY
29-09	ROBERT KOCH
29-10	JOHNNIE BOSTON
29-13	RICKY KOCH
29-20	THE NATURE CONSERVANCY
29-29	MARK MOSSOR
29-30	ERICA DEEM
29-31	LORRAINE RANKIN
29-31.1	CURTIS SEESE
29-47	ROBERT KOCH
29-48	RICKY KOCH
29-49	ERICA DEEM
29-50	ERICA DEEM
29-52	ERICA DEEM
29-55	ERICA DEEM
29-56	TRISTAN RAY

NOTES:
WELL 1H TOP HOLE INFORMATION:
 N: 290,234ft E: 1,569,435ft
 LAT: 39°17'12.68" LON: 81°01'16.42"
BOTTOM HOLE INFORMATION:
 N: 270,572ft E: 1,573,678ft
 LAT: 39°13'59.07" LON: 81°00'18.28"
 WEST VIRGINIA COORDINATE SYSTEM OF 1927 NORTH ZONE.
 ZONE WAS DERIVED FROM MEASUREMENTS TAKEN WITH TRIMBLE GEOXT SUBMETER MAPPING GRADE GPS UNIT. PLAT ORIENTATION, CORNER, AND WELL REFERENCE TIE LINES ARE BASED ON GRID NORTH.

(NAD) 83 (UTM) ZONE 17 COORDS:
WELL 1H TOP HOLE INFORMATION:
 N: 4,348,619m E: 498,184m
BOTTOM HOLE INFORMATION:
 N: 4,342,651m E: 499,576m

(NAD) 27 (UTM) ZONE 17 COORDS:
WELL 1H TOP HOLE INFORMATION:
 N: 14,266,391ft E: 1,634,410ft
POINT OF ENTRY INFORMATION:
 N: 14,263,791ft E: 1,633,033ft
BOTTOM HOLE INFORMATION:
 N: 14,246,800ft E: 1,638,979ft

A	TOM G. STRICKLER, JR., ET UX
B	FRANKLIN OWENS AND ANNIE L OWENS
C	LAURA GAIL GROVES
D	RONALD LANE
E	RONALD LANE
F	BRUCETON FARM SERVICE, LLC
G	BRUCETON FARM SERVICE, LLC
H	TERRY LYNN SPENCER
I	PARKS & PERKINS PROPERTIES, LLC
J	WV DOT, DOH
K	LYNN C. WELLS AND CAROL SUE WELLS
L	MICHAEL T. HALL
M	HALL'S WVA WELDING EQUIPMENT, INC.
O	NORMAN LLOYD JACKSON
P	WILLIAM MOORE AND MELVINA MOORE
Q1	WILLIAM MOORE AND MELVINA MOORE
Q2	WILLIAM MOORE AND MELVINA MOORE
Q3	WILLIAM MOORE AND MELVINA MOORE
Q4	WILLIAM MOORE AND MELVINA MOORE
Q5	WILLIAM MOORE AND MELVINA MOORE
R	MINNIE L. HILEY
S1	RIDGETOP TEN, LLC.
S2	RIDGETOP TEN, LLC.
T1	RIDGEWOOD DEVELOPMENT, LLC.
T2	RIDGEWOOD DEVELOPMENT, LLC.
T3	RIDGEWOOD DEVELOPMENT, LLC.
U	THE NATURE CONSERVANCY
V	CRAIG LEE BETH AND LINDA EVE BETH
W1	INA W. BARNARD, ET AL
W2	INA W. BARNARD, ET AL
X	JANET RIDDLE-STANLEY
Y	VIRGINIA L. CONNORS
Z	AGNES L. ROGERS
AA	F. ROBERT HAYHURST FAMILY TRUST
AB	F. ROBERT HAYHURST FAMILY TRUST
AC	F. ROBERT HAYHURST
AD	F. ROBERT HAYHURST
AE	TOM G. STRICKLER, JR., ET UX
AF	CLARENCE J. MCCULLOUGH ET UX
AG	CLARENCE J. MCCULLOUGH ET UX
AH	TOM G. STRICKLER, JR., ET UX
AI	RICHARD BLOUIR ET AL
AJ	WILLIAM MOORE ET UX
AK	CHARLES A. BROADWATER
AL	WEST VIRGINIA DIVISION OF MULTIMODAL TRANSPORTATION FACILITIES

NOTE
 NO OCCUPIED DWELLINGS OR BUILDINGS TWO THOUSAND FIVE HUNDRED (2,500) SQUARE FEET OR LARGER USED TO HOUSE OR SHELTER DAIRY CATTLE OR POULTRY HUSBANDRY ARE LOCATED WITHIN SIX HUNDRED TWENTY-FIVE (625) FEET OF THE CENTER OF THE WELL PAD.

WV NORTH ZONE
GRID NORTH

WATER WELLS		
W1	S 13°36' E	1772.1'
W2	N 87°26' W	929.2'
W3	S 24°40' W	864.4'
W4	S 19°28' E	906.8'
W5	S 27°55' E	993.1'
W6	S 40°30' E	1566.5'
W7	N 40°45' W	960.8'
W8	S 48°22' E	1604.4'
W9	S 52°09' E	1872.9'

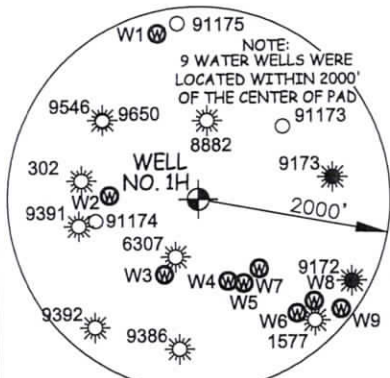

I THE UNDERSIGNED, HEREBY CERTIFY THAT THIS PLAT IS CORRECT TO THE BEST OF MY KNOWLEDGE AND BELIEF AND SHOWS ALL THE INFORMATION REQUIRED BY LAW AND THE RULES ISSUED AND PERSCRIBED BY THE DEPARTMENT OF ENVIRONMENTAL PROTECTION.



STATE OF WEST VIRGINIA, DIVISION OF ENVIRONMENTAL PROTECTION, OFFICE OF OIL AND GAS
 WILLOW LAND SURVEYING PLLC
 220 MASONIC AVE. PENNSBORO WEST VIRGINIA 26415

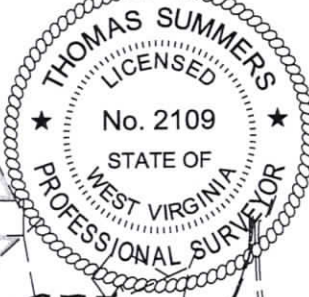

JOB # 23-010WA
 DRAWING # SHIPE1HR2
 SCALE 1" = 2000'
 MINIMUM DEGREE OF ACCURACY SUBMETER
 PROVEN SOURCE OF ELEV. SUBMETER MAPPING GRADE GPS
 STATE OF WEST VIRGINIA DEPARTMENT OF ENERGY DIVISION OF OIL AND GAS

LEGEND		
---	Surface Owner Boundary Lines +/-	
- - -	Adjoining Surface Tracts +/-	
⊕	Found monument, as noted	
THOMAS SUMMERS P.S. 2109		
DATE 01/29/25		
OPERATOR'S WELL# SHIPE UNIT #1H		
47	085	10539
STATE	COUNTY	PERMIT

WELL TYPE: OIL GAS LIQUID INJECTION WASTE DISPOSAL (IF "GAS") PRODUCTION STORAGE DEEP SHALLOW
 LOCATION: ELEVATION PROPOSED -1,007' WATERSHED NORTH FORK HUGHES RIVER
 QUADRANGLE ELLENBORO 7.5' DISTRICT CLAY COUNTY RITCHIE
 SURFACE OWNER RICHARD E. BLOUIR ET UX ACREAGE 53.682 ACRES +/-
 OIL & GAS ROYALTY OWNER AGNES L. ROGERS LEASE ACREAGE 57 ACRES±
 PROPOSED WORK: DRILL CONVERT DRILL DEEPER REDRILL
 FRACTURE OR STIMULATE PLUG OFF OLD FORMATION PERFORATE NEW FORMATION OTHER PHYSICAL CHANGE IN WELL (SPECIFY) MOD-BHL
 PLUG & ABANDON CLEAN OUT & REPLUG
 TARGET FORMATION MARCELLUS ESTIMATED DEPTH 7,600' TVD 29,100' MD
 WELL OPERATOR ANTERO RESOURCES CORP. DESIGNATED AGENT KEVIN ELLIS
 ADDRESS 1615 WYNKOOP ST. ADDRESS 535 WHITE OAKS BLVD
 DENVER, CO 80202 BRIDGEPORT, WV 26330

