

LATITUDE 39°17'30"

6,002'

LATITUDE 39°15'00"

Antero Resources Corporation Well No. Mercury #1H

Table listing adjacent well owners and their well numbers, including Ronald Hayhurst, Richard Blouir, and others.

PAD LAYOUT

NOT TO SCALE

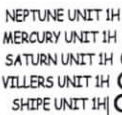

1H BOTTOM HOLE

Table listing water wells W1 through W9 with their coordinates and depths.

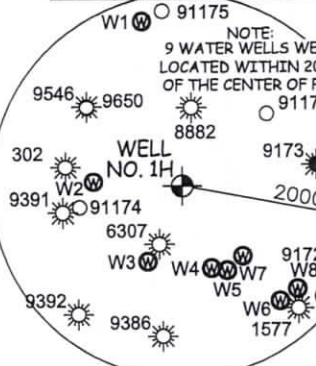

REFERENCES



NOTES:

WELL 1H TOP HOLE INFORMATION: N: 290,278ft E: 1,569,442ft LAT: 39°17'13.12" LON: 81°01'16.34" BOTTOM HOLE INFORMATION: N: 266,856ft E: 1,576,894ft LAT: 39°13'22.88" LON: 80°59'36.63" WEST VIRGINIA COORDINATE SYSTEM OF 1927 NORTH ZONE. ZONE WAS DERIVED FROM MEASUREMENTS TAKEN WITH TRIMBLE GEOXT SUBMETER MAPPING GRADE GPS UNIT. PLAT ORIENTATION, CORNER, AND WELL REFERENCE TIE LINES ARE BASED ON GRID NORTH.

(NAD) 83 (UTM) ZONE 17 COORDS: WELL 1H TOP HOLE INFORMATION: N: 4,348,632m E: 498,186m BOTTOM HOLE INFORMATION: N: 4,341,535m E: 500,575m

(NAD) 27 (UTM) ZONE 17 COORDS: WELL 1H TOP HOLE INFORMATION: N: 14,266,425ft E: 1,634,417ft POINT OF ENTRY INFORMATION: N: 14,264,352ft E: 1,635,962ft BOTTOM HOLE INFORMATION: N: 14,243,139ft E: 1,642,255ft

- List of adjacent well owners and their well numbers, including Rodney Steve Hogue, Ww Division of Multimodal Transportation Facilities, Kimberly Barnes, Nancy Louise Vaughn, Dorothy L. Kleffel, Ronald Lane, William Moore and Melvina Moore, etc.

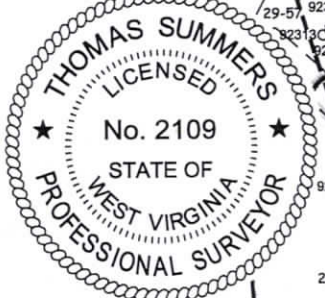

STATE OF WEST VIRGINIA, DIVISION OF ENVIRONMENTAL PROTECTION, OFFICE OF OIL AND GAS. WILLOW LAND SURVEYING PLLC, 220 MASONIC AVE. PENNSBORO WEST VIRGINIA 26415

JOB # 23-010WA DRAWING # MERCURY1HR3 SCALE 1" = 2000' MINIMUM DEGREE OF ACCURACY SUBMETER PROVEN SOURCE OF ELEV. SUBMETER MAPPING GRADE GPS

LEGEND table with symbols for Surface Owner Boundary Lines, Adjoining Surface Tracts, and Found monument.

NOTE: NO OCCUPIED DWELLINGS OR BUILDINGS TWO THOUSAND FIVE HUNDRED (2,500) SQUARE FEET OR LARGER USED TO HOUSE OR SHELTER DAIRY CATTLE OR POULTRY HUSBANDRY ARE LOCATED WITHIN SIX HUNDRED TWENTY-FIVE (625) FEET OF THE CENTER OF THE WELL PAD.

Form containing well details: WELL TYPE: OIL GAS X LIQUID INJECTION WASTE DISPOSAL; LOCATION: ELEVATION PROPOSED -1.007' WATERSHED NORTH FORK HUGHES RIVER; SURFACE OWNER RICHARD E. BLOUIR ET UX; OIL & GAS ROYALTY OWNER AGNES L. ROGERS; PROPOSED WORK: DRILL CONVERT DRILL DEEPER X REDRILL; TARGET FORMATION MARCELLUS; ESTIMATED DEPTH 7,600' TVD 32,600' MD; WELL OPERATOR ANTERO RESOURCES CORP.; DESIGNATED AGENT KEVIN ELLIS; ADDRESS 1615 WYNKOOP ST. DENVER, CO 80202; ADDRESS 535 WHITE OAKS BLVD BRIDGEPORT, WV 26330

02/21/2025