

Longitude - 81° 16' 44.8

8,300'

NOTES ON SURVEY

- 1 - Well ties and Latitude and Longitude were measured by DGPS (Sub-meter Mapping Grade). Bearings are referenced to UTM Zone 17 North - NADCON Conus).
- 2 - Surface owners and adjoiners information obtained from the Roane County Assessor's tax records.

LATITUDE 38° 45' 00"

DAVID SIMMONS  
1000 AC.

N85° 45'E

7.5' Topo

1076  
23

48

69.5 P.

Clover Run.

T.M. PEROT  
1,376 AC.

LONGITUDE 81° 15' 00"

Latitude - 38° 44' 42.5"

DAVID SIMMONS  
1000 AC.

3035  
10

0913  
21

CHAMBERS HEIRS LEASE  
329 1/4A

W&B FARMS - SURFACE

32.5 AC.

ASBURY LEWIS  
240 AC.

2993  
15

36  
3

140 P.

ED CRINER  
24 AC.

WELL COORDINATES

UTM (NAD 1983)  
N - 4,288,541 m.  
E - 475,759 m.

(+) DENOTES LOCATION OF WELL ON UNITED STATES TOPOGRAPHIC MAPS

FILE NO. 1359  
 BOOK 1040 PAGE 53  
 SCALE 1" = 500'  
 MINIMUM DEGREE OF ACCURACY Sub-Meter  
 PROVEN SOURCE OF ELEVATION DGPS Survey

I THE UNDERSIGNED, HEREBY CERTIFY THAT THIS PLAT IS CORRECT TO THE BEST OF MY KNOWLEDGE AND BELIEF AND SHOWS ALL THE INFORMATION REQUIRED BY LAW AND THE REGULATIONS ISSUED AND PRESCRIBED BY THE DEPARTMENT OF MINES.

(SIGNED)   
 TIMOTHY P. ROUSH PS 793

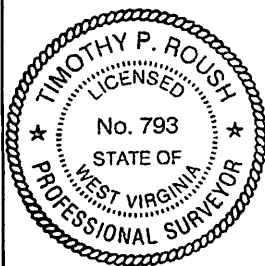

WEST VIRGINIA  
 Division of Environmental Protection  
 Office of Oil and Gas  
 601 57th Street  
 Charleston, West Virginia 25304



DATE January 3, 2013  
 FARM Chambers Heirs NO. 5  
 API WELL NO. 47-087-02436 F

WELL TYPE: OIL  GAS  LIQUID INJECTION  WASTE DISPOSAL   
 (IF "GAS") PRODUCTION  STORAGE  DEEP  SHALLOW   
 LOCATION: ELEVATION 1,067' WATERSHED Chambers Fork  
 DISTRICT Smithfield COUNTY Roane  
 QUADRANGLE Looneyville 7.5'

SURFACE OWNER W&B Farms Inc. ACREAGE 220.79 Ac.  
 OIL & GAS ROYALTY OWNER HG Energy, LLC et al. LEASE ACREAGE 329.25 Ac.  
 LEASE NO. 74937-50

PROPOSED WORK: DRILL  CONVERT  DRILL DEEPER  REDRILL  FRACTURE OR STIMULATE  PLUG OFF OLD FORMATION  PERFORATE NEW FORMATION  OTHER PHYSICAL CHANGE IN WELL (SPECIFY) \_\_\_\_\_

PLUG AND ABANDON  CLEAN OUT AND REPLUG   
 TARGET FORMATION Big Injun ESTIMATED DEPTH 2,218'  
 WELL OPERATOR HG Energy, LLC DESIGNATED AGENT Mike Kirsch  
 ADDRESS 5260 Dupont Road ADDRESS 5260 Dupont Road  
Parkersburg, WV 26101 Parkersburg, WV 26101 02/22/2013

FORM IV-6

SUBJECT WELL  
Chambers Heirs No.5

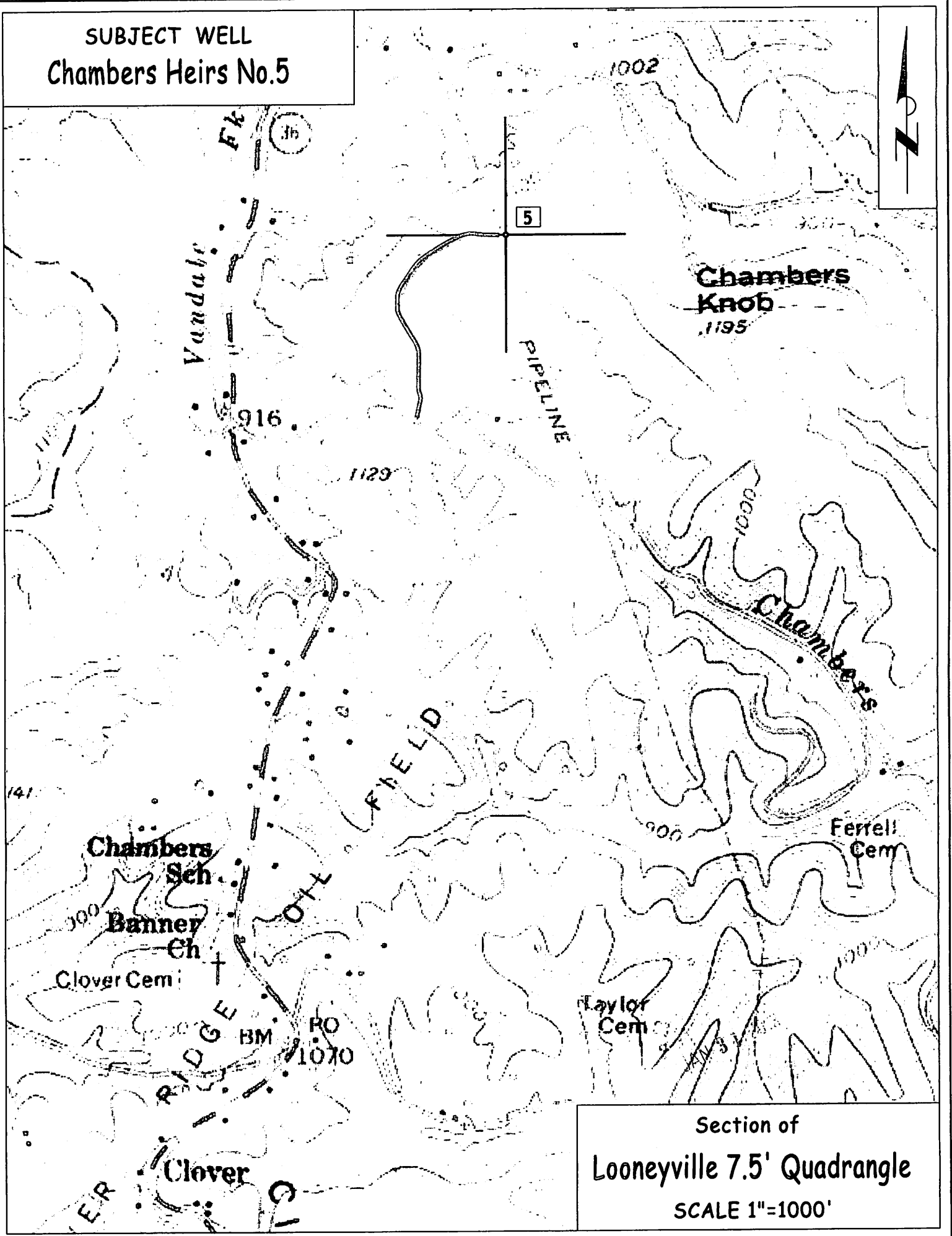

Section of  
Looneyville 7.5' Quadrangle  
SCALE 1"=1000'

87-02436 F