

LINE	BEARING	DISTANCE
L1	S 40°00' W	165.00
L2	N 38°30' W	627.00
L3	N 23°30' W	280.50
L4	N 41°30' W	305.25
L5	N 15°30' W	668.25
L6	N 31°30' W	379.50
L7	N 32°30' W	66.00
(BOUNDARY TIE TO WELL)		
L8	N 44°59' E	155.93
L9	N 00°15' W	367.52

DEBORAN BUCHANAN  
320/535  
T.M. 24 PAR. 27

JULIE ANDERSON  
W.B. 23/699  
T.M. 3 PAR. 6

JERRY VANCE  
368/435  
T.M. 3 PAR. 8

JERRY VANCE  
368/435  
T.M. 3 PAR. 4

BRADLEY HALL  
411/331  
T.M. 3 PAR. 7

RONALD LOTTS  
393/97  
T.M. 8 PAR. 5

VIRGINIA EAGLE  
409/650  
T.M. 8 PAR. 15

UTM COORD:  
NAD 83 17 04 55 830E  
43 05 972N

STATE PLANE COORD:  
NAD 83 N=692815  
E=1823503

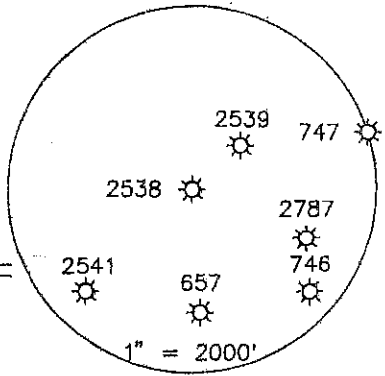

LEGEND  
● CALCULATED POINT

(+) DENOTES LOCATION OF WELL ON UNITED STATES TOPOGRAPHIC MAPS

FILE NO. \_\_\_\_\_  
DRAWING NO. 11-42  
SCALE 1" = 500'  
MINIMUM DEGREE OF ACCURACY 1 IN 200  
PROVEN SOURCE OF ELEVATION G.P.S.

I THE UNDERSIGNED, HEREBY CERTIFY THAT THIS PLAT IS CORRECT TO THE BEST OF MY KNOWLEDGE AND BELIEF AND SHOWS ALL THE INFORMATION REQUIRED BY LAW AND THE REGULATIONS ISSUED AND PRESCRIBED BY THE DEPARTMENT OF ENERGY.  
(SIGNED) *[Signature]*  
R.P.E. \_\_\_\_\_ L.L.S. 851



STATE OF WEST VIRGINIA  
Division of Environmental Protection  
OFFICE OF OIL AND GAS

DATE 06/29, 2012  
OPERATOR'S WELL NO. E.L. FLEMING #2  
API WELL NO. 47-087-2538W  
STATE COUNTY PERMIT

WELL TYPE: OIL  GAS \_\_\_\_\_ LIQUID INJECTION \_\_\_\_\_ WASTE DISPOSAL \_\_\_\_\_  
(IF "GAS") PRODUCTION  STORAGE \_\_\_\_\_ DEEP \_\_\_\_\_ SHALLOW

LOCATION: ELEVATION 982 WATER SHED BRUSHY FORK  
DISTRICT REEDY COUNTY ROANE  
QUADRANGLE LIVERPOOL

SURFACE OWNER JERRY VANCE ACREAGE 45  
OIL & GAS ROYALTY OWNER SUMMIT ENERGY & OTHERS LEASE ACREAGE 45  
LEASE NO. \_\_\_\_\_

PROPOSED WORK: DRILL \_\_\_\_\_ CONVERT \_\_\_\_\_ DRILL DEEPER \_\_\_\_\_ REDRILL \_\_\_\_\_ FRACTURE OR  
STIMULATE  PLUG OFF OLD FORMATION \_\_\_\_\_ PERFORATE NEW  
FORMATION \_\_\_\_\_ OTHER PHYSICAL CHANGE IN WELL (SPECIFY): RUN 4 1/2"

PLUG AND ABANDON \_\_\_\_\_ CLEAN OUT AND REPLUG \_\_\_\_\_  
TARGET FORMATION BEREA ESTIMATED DEPTH 2,700'  
WELL OPERATOR KRAKROW, INC. DESIGNATED AGENT ROY G. HILDRETH Jr.  
ADDRESS P.O. BOX 1007 ADDRESS P.O. BOX 1007  
SPENCER, WV 25276 SPENCER, WV 25276

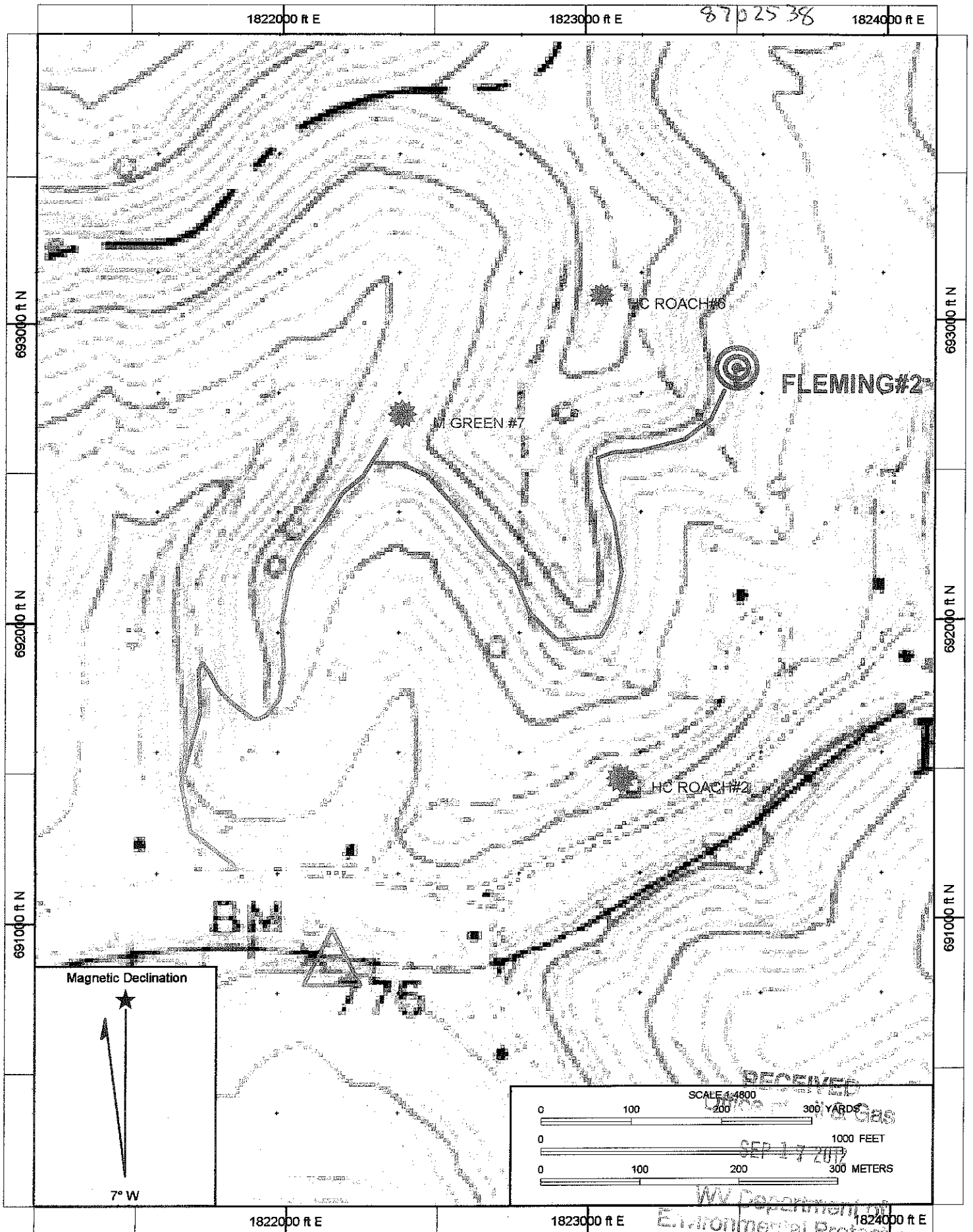

Datum: NAD83

Copyright (C) 1997, Maptech, Inc.

10/05/2012