

UTM NAD.83
17 0456108E
4305806N

STATE PLANE COOR.
NAD 83
N 692,294
E 1,824,439

NAD 83
LAT. 38.9000432N
LONG. 81.5061736W

(+) DENOTES LOCATION OF WELL ON UNITED STATES TOPOGRAPHIC MAPS

FILE NO. _____
DRAWING NO. 12-12
SCALE 1"=500'
MINIMUM DEGREE OF ACCURACY 1 IN 200
PROVEN SOURCE OF ELEVATION GPS

I THE UNDERSIGNED, HEREBY CERTIFY THAT THIS PLAT IS CORRECT TO THE BEST OF MY KNOWLEDGE AND BELIEF AND SHOWS ALL THE INFORMATION REQUIRED BY LAW AND THE REGULATIONS ISSUED AND PRESCRIBED BY THE DEPARTMENT OF ENERGY.

(SIGNED) _____
R.P.E. _____ L.L.S. 851

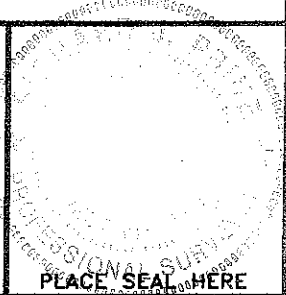

STATE OF WEST VIRGINIA Department of Environmental Protection OFFICE OF OIL AND GAS		DATE <u>6/29</u> , 20 <u>12</u> OPERATOR'S WELL NO. <u>FLEMING#4</u> API WELL NO. <u>47 - 087 - 04721R</u> STATE COUNTY PERMIT
WELL TYPE: OIL <input checked="" type="checkbox"/> GAS _____ LIQUID INJECTION _____ WASTE DISPOSAL _____ (IF "GAS") PRODUCTION _____ STORAGE _____ DEEP _____ SHALLOW _____		
LOCATION: ELEVATION <u>936</u> WATER SHED _____ BRUSHY FORK DISTRICT <u>REEDY</u> COUNTY <u>ROANE</u> QUADRANGLE <u>LIVERPOOL</u>		
SURFACE OWNER <u>MARY B. SNYDER</u> ACREAGE <u>30</u> OIL & GAS ROYALTY OWNER <u>GMH GAS CO. INC</u> LEASE ACREAGE <u>5</u> LEASE NO. _____		
PROPOSED WORK: DRILL _____ CONVERT _____ DRILL DEEPER _____ REDRILL _____ FRACTURE OR STIMULATE <input checked="" type="checkbox"/> PLUG OFF OLD FORMATION _____ PERFORATE NEW FORMATION _____ OTHER PHYSICAL CHANGE IN WELL (SPECIFY): <u>RUN 4 1/2"</u>		
PLUG AND ABANDON _____ CLEAN OUT AND REPLUG _____		
TARGET FORMATION <u>BEREA</u> ESTIMATED DEPTH <u>2800</u> WELL OPERATOR <u>KRAKROW, INC.</u> DESIGNATED AGENT <u>ROY G. HILDRETH JR</u> ADDRESS <u>PO BOX 1007</u> ADDRESS <u>PO BOX 1007</u> <u>SPENCER, WV 25276</u> <u>SPENCER, WV 25276</u>		

08/10/2012

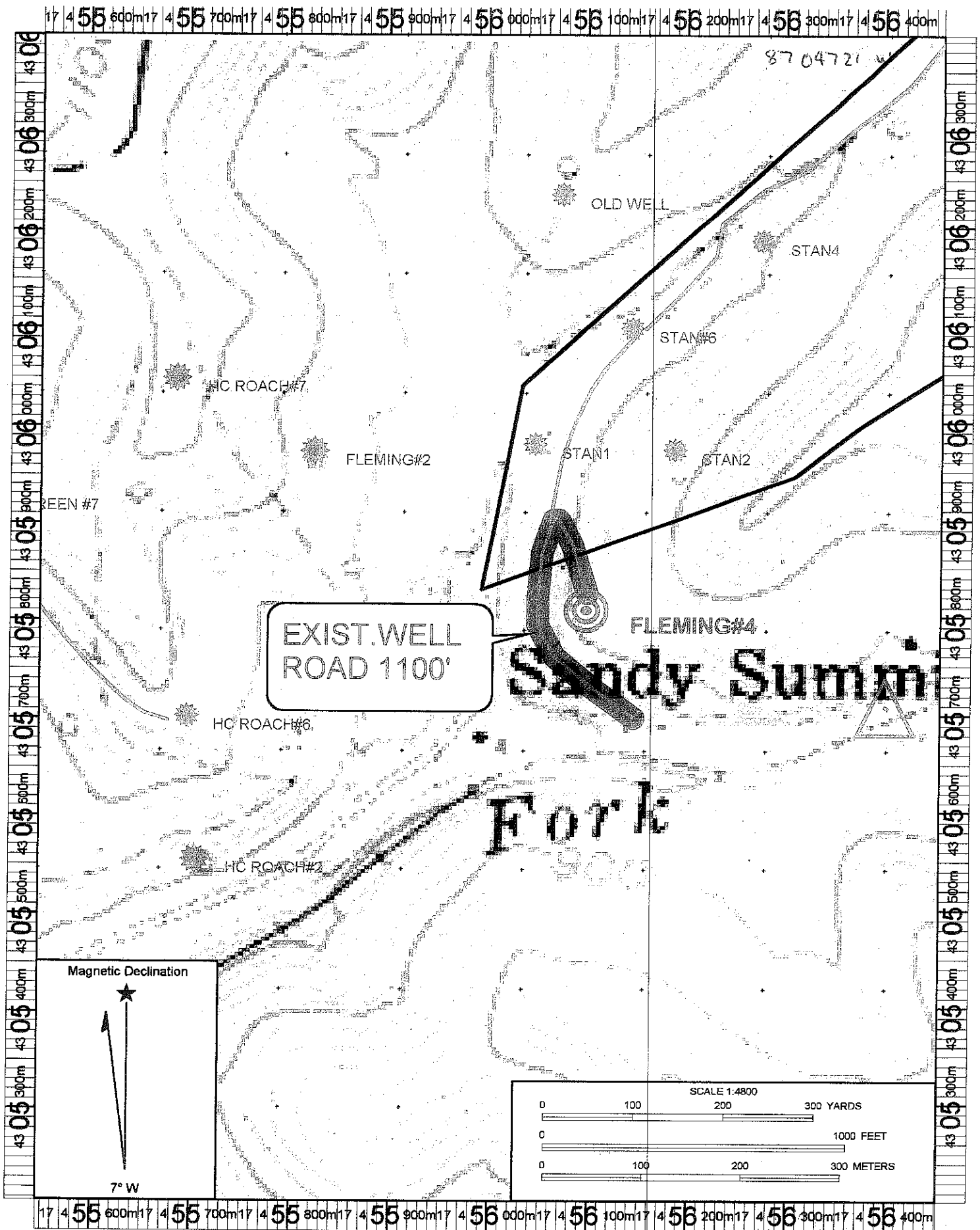

Datum: NAD83

Copyright (C) 1997, Maptech, Inc.