

NOTE: NO BUILDING STRUCTURES IDENTIFIED WITHIN 200'

SURFACE HOLE	
STATE PLANE WV	NORTH/SOUTH ZONE NAD 1927
N - 689,108.27	: E - 1,889,365.44
LATITUDE: (N) 38.8917778	LONGITUDE: (W) 81.3886739
UTM, NAD83	
17 - 84W TO 78W, METERS	N - 4,304,848.282 : E - 466,306.469
BOTTOM HOLE	
STATE PLANE WV	NORTH/SOUTH ZONE NAD 1927
N - 685,613.87	: E - 1,889,563.24
LATITUDE: (N) 38.8821857	LONGITUDE: (W) 81.3879276
UTM, NAD83	
17 - 84W TO 78W, METERS	N - 4,303,783.610 : E - 466,366.665

(+) DENOTES LOCATION OF WELL ON UNITED STATES TOPOGRAPHIC MAPS

FILE NO.	HR-481A.DGN
DRAWING NO.	HR-481
SCALE	1" = 1000'
MINIMUM DEGREE OF ACCURACY	1:200
PROVEN SOURCE OF ELEVATION	MAPPING GRADE GPS

I THE UNDERSIGNED, HEREBY CERTIFY THAT THIS PLAT IS CORRECT TO THE BEST OF MY KNOWLEDGE AND BELIEF AND SHOWS ALL THE INFORMATION REQUIRED BY LAW AND THE REGULATIONS ISSUED AND PRESCRIBED BY THE DEPARTMENT OF ENVIRONMENTAL PROTECTION.

(SIGNED) *Paul E. Miller*

R.P.E. _____ L.L.S. 647

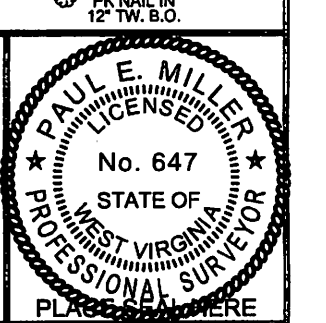

STATE OF WEST VIRGINIA DIVISION OF ENVIRONMENTAL PROTECTION OIL AND GAS DIVISION		DATE <u>NOVEMBER 06</u> , 20 <u>12</u>
WELL TYPE: OIL <input type="checkbox"/> GAS <input checked="" type="checkbox"/> LIQUID INJECTION <input type="checkbox"/> WASTE DISPOSAL <input type="checkbox"/>		OPERATOR'S WELL NO. <u>HR-481A</u>
(IF "GAS,") PRODUCTION <input checked="" type="checkbox"/> STORAGE <input type="checkbox"/> DEEP <input type="checkbox"/> SHALLOW <input checked="" type="checkbox"/>		API WELL NO. <u>47 087 04728 H</u>
LOCATION: ELEVATION <u>1035'</u> WATER SHED <u>CRANENEST RUN</u>		STATE <u>47</u> COUNTY <u>087</u> PERMIT <u>04728 H</u>
DISTRICT <u>REEDY</u> COUNTY <u>ROANE</u>		
QUADRANGLE <u>REEDY, WV 7.5'</u>		
SURFACE OWNER <u>JOHN & TAMMY HUDDLESTON</u> ACREAGE <u>103.84</u>		
OIL & GAS ROYALTY OWNER <u>Flesher, Huddleston</u> LEASE ACREAGE <u>240</u>		
LEASE NO. _____		
PROPOSED WORK: DRILL <input checked="" type="checkbox"/> CONVERT <input type="checkbox"/> DRILL DEEPER <input type="checkbox"/> REDRILL <input type="checkbox"/> FRACTURE OR STIMULATE <input checked="" type="checkbox"/> PLUG OFF OLD FORMATION <input type="checkbox"/> PERFORATE NEW FORMATION <input checked="" type="checkbox"/> OTHER PHYSICAL CHANGE IN WELL (SPECIFY) _____		
PLUG AND ABANDON <input type="checkbox"/> CLEAN OUT AND REPLUG <input type="checkbox"/>		
TARGET FORMATION <u>LOWER HURON</u> ESTIMATED DEPTH <u>7850' MD; 4610' TVD</u>		
WELL OPERATOR <u>HARD ROCK EXPLORATION, INC.</u> DESIGNATED AGENT <u>JAMES L. STEPHENS</u>		
ADDRESS <u>1244 MARTINS BRANCH ROAD, CHARLESTON, WV 25312</u> ADDRESS <u>SAME</u>		

02/08/2013

FORM WW-6

COUNTY NAME

PERMIT

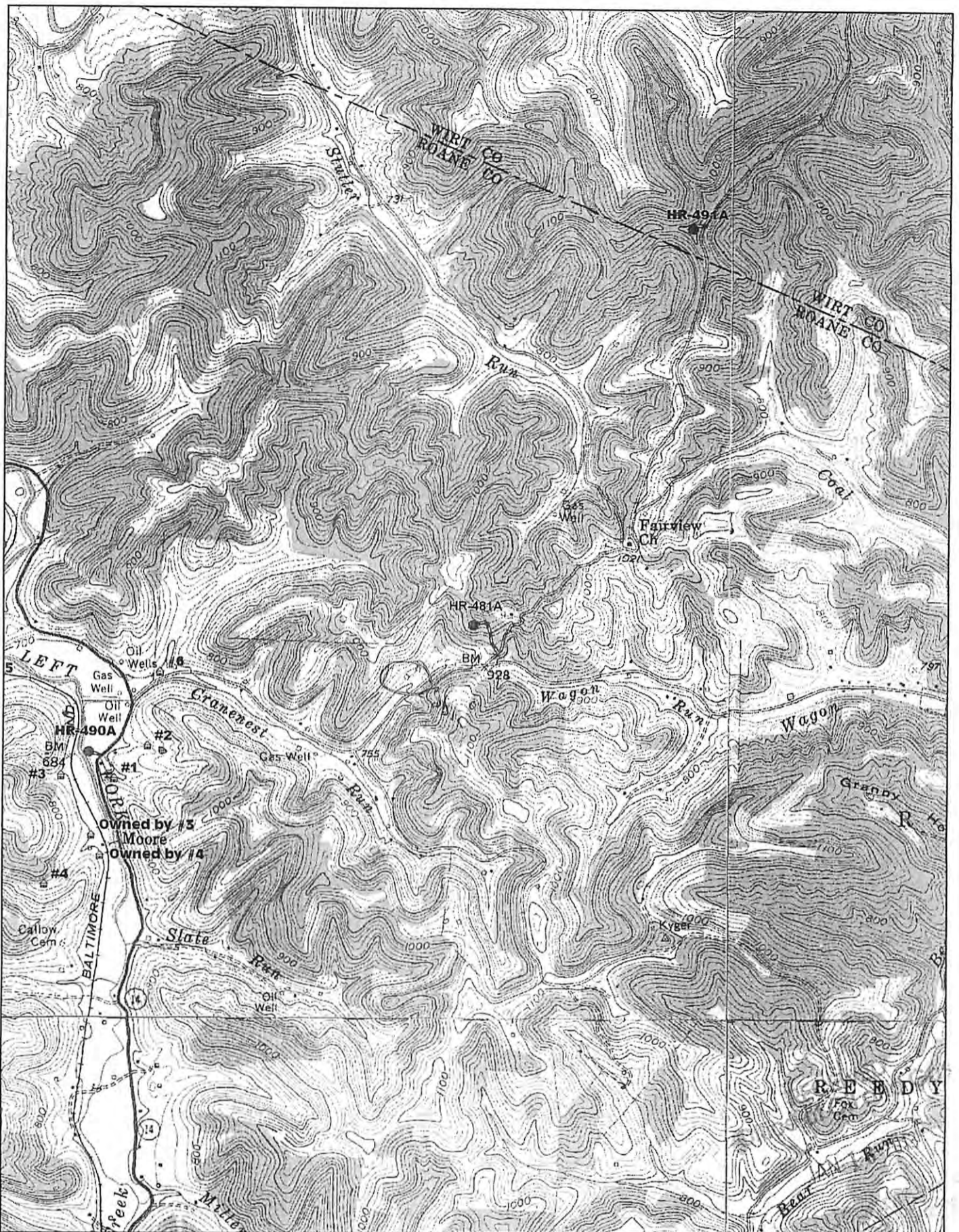

DELORME Scale 1 : 24,000
 1" = 2,000 ft
 © 2001 DeLorme. XMap®. Data copyright of content owner.
 Zoom Level: 14-0 Datum: NAD27

87-04728 H HR-481A
 HARD ROCK EXPLORATION INC

Farm Name: Huddleston, John & Tammy