

LONGITUDE 81° 15' 00"

11,165'

Bottom Hole Lat. = 38° 43' 14.7"

Latitude = 38° 43' 09.65"

SECTION OF WVDEP GIS Dataviewer  
Accuracy, completeness and precision of this data is not guaranteed. Use at your own risk.

Well Coordinates	
UTM (NAD83) - Meters	
Surface	Bottom Hole
N - 4,285,678	N - 4,285,834
E - 476,368	E - 476,155

Location References	
(Magnetic Bearing - Slope Dist.)	
N28°E 133'	T-Post
N80°E 136'	18" Hickory

- NOTES ON SURVEY**
- 1 - Well ties and Latitude and Longitude were measured by DGPS (Sub-meter Mapping Grade). Bearings are referenced to UTM Grid North (Zone 17 North - NAD 1927).
  - 2 - Latitude/Longitude shown are NAD 1927.
  - 3 - Surface owner information obtained from the Roane County Assessor's tax records.

- ◆ - DENOTES A POSSIBLE WATER SUPPLY SOURCE LOCATED FROM CIRCA 2003 AERIAL PHOTOGRAPHY - NOT BY SURVEY. OTHER SOURCES MAY BE PRESENT.
- ⊕ - DENOTES LOCATION OF WELL ON UNITED STATES TOPOGRAPHIC MAPS.

FILE NO. 1501

SCALE 1" = 1000'

MINIMUM DEGREE OF ACCURACY Sub-Meter

PROVEN SOURCE OF ELEVATION DGPS Survey  
(Sub-Meter Mapping Grade)

I, THE UNDERSIGNED, HEREBY CERTIFY THAT THIS PLAT IS CORRECT TO THE BEST OF MY KNOWLEDGE AND BELIEF AND SHOWS ALL THE INFORMATION REQUIRED BY LAW AND THE REGULATIONS ISSUED AND PRESCRIBED BY THE DEPARTMENT OF ENVIRONMENTAL PROTECTION.

(SIGNED) *Timothy P. Roush*

TIMOTHY P. ROUSH PS 793

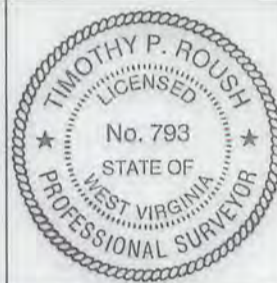

WEST VIRGINIA  
Division of Environmental Protection  
Office of Oil and Gas  
601 57th Street  
Charleston, West Virginia 25301



DATE March 1, 2016

FARM A.W. Edgell No.127

API WELL NO. 47 - 087 - 04784 5

WELL TYPE: OIL \_\_\_ GAS \_\_\_ LIQUID INJECTION  WASTE DISPOSAL \_\_\_  
(IF "GAS") PRODUCTION \_\_\_ STORAGE \_\_\_ DEEP \_\_\_ SHALLOW \_\_\_

LOCATION: ELEVATION 1042' WATERSHED Edgell Fork  
DISTRICT Smithfield COUNTY Roane  
QUADRANGLE Looneyville 7.5'

SURFACE OWNER Patty C. Webb ACREAGE 41.75 Ac.

OIL & GAS ROYALTY OWNER HG Energy, LLC., et al LEASE ACREAGE 43 Ac. **05/13/2016**  
LEASE NO. 61724-50

PROPOSED WORK: DRILL  CONVERT \_\_\_ DRILL DEEPER \_\_\_ REDRILL \_\_\_ FRACTURE OR  
STIMULATE  PLUG OFF OLD FORMATION \_\_\_ PERFORATE NEW  
FORMATION \_\_\_ OTHER PHYSICAL CHANGE IN WELL (SPECIFY) Well will be directionally drilled as shown.

PLUG AND ABANDON \_\_\_ CLEAN OUT AND REPLUG \_\_\_

TARGET FORMATION Big Injun ESTIMATED DEPTH 2,383' MD

WELL OPERATOR HG Energy LLC. DESIGNATED AGENT Diane White  
ADDRESS 5260 DuPont Road ADDRESS 5260 DuPont Road  
Parkersburg, WV 26101 Parkersburg, WV 26101

SUBJECT WELL  
A.W. Edgell No.127

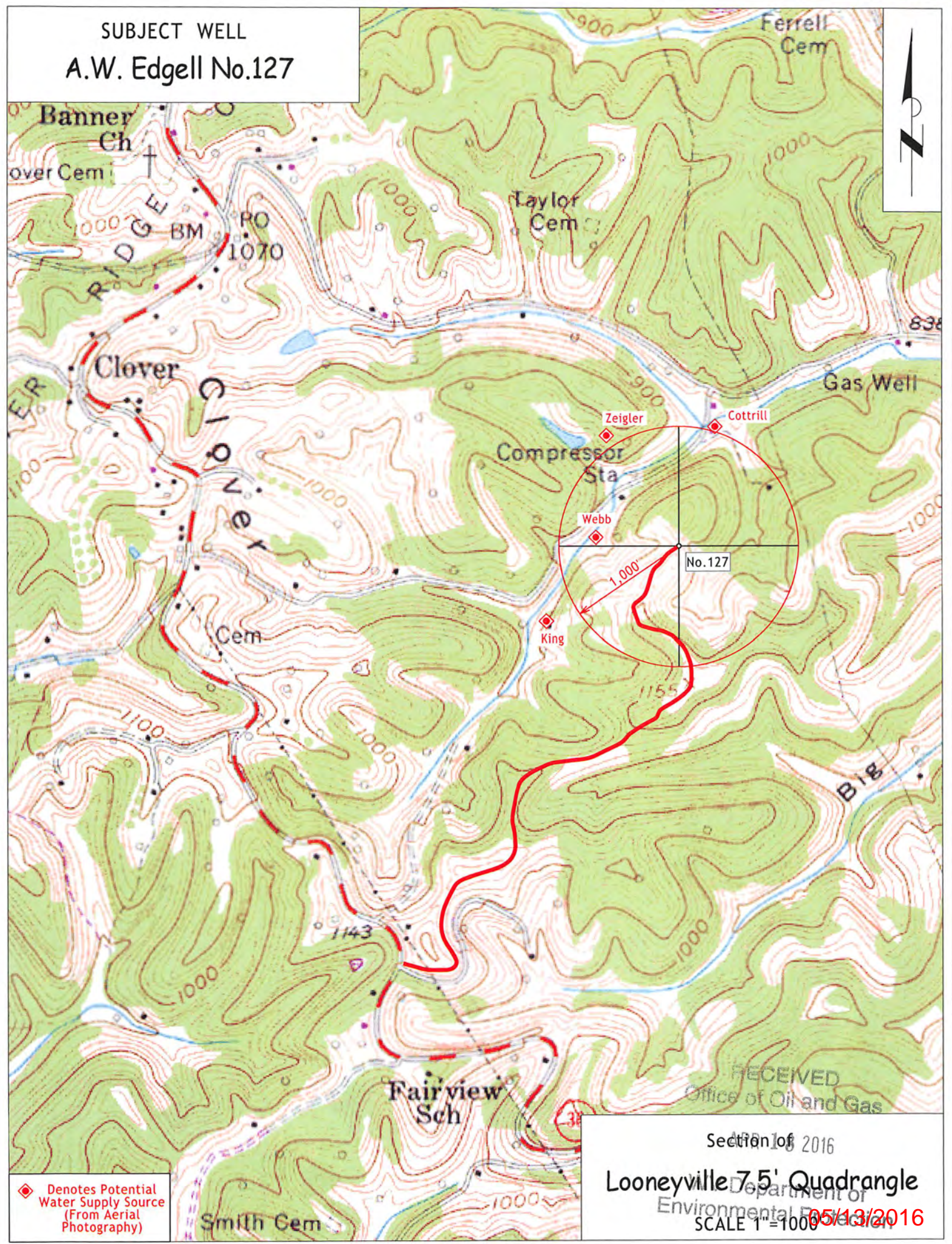

◆ Denotes Potential Water Supply Source (From Aerial Photography)

Section of 2016  
Looneyville 7.5' Quadrangle  
Department of Environmental Protection  
SCALE 1"=1000'  
05/13/2016

RECEIVED  
Office of Oil and Gas