

LATITUDE 38° 47' 30"

400,56,18 LONGITUDE

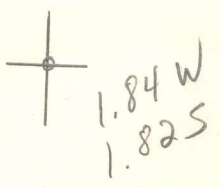

7'5 OGIS topo location

7.5' loc _____ 15' loc _____
 _____ (calc.) _____

Company _____

Farm _____

Quad Peniel 7/2'

County Noane

District Curtis

WELL LOCATION MAP

File No. 087-86A

I, the undersigned, hereby certify that this map is correct and shows all the information to the best of my knowledge and belief, required by the Oil and Gas Section of the Mining Laws of West Virginia.

G. Cunningham
Engineer

Acknowledged before me, a Notary Public of Kanawha County, W. Va.

this 4 day of May 1934.

My Commission expires May 2, 1940 J. J. Martin

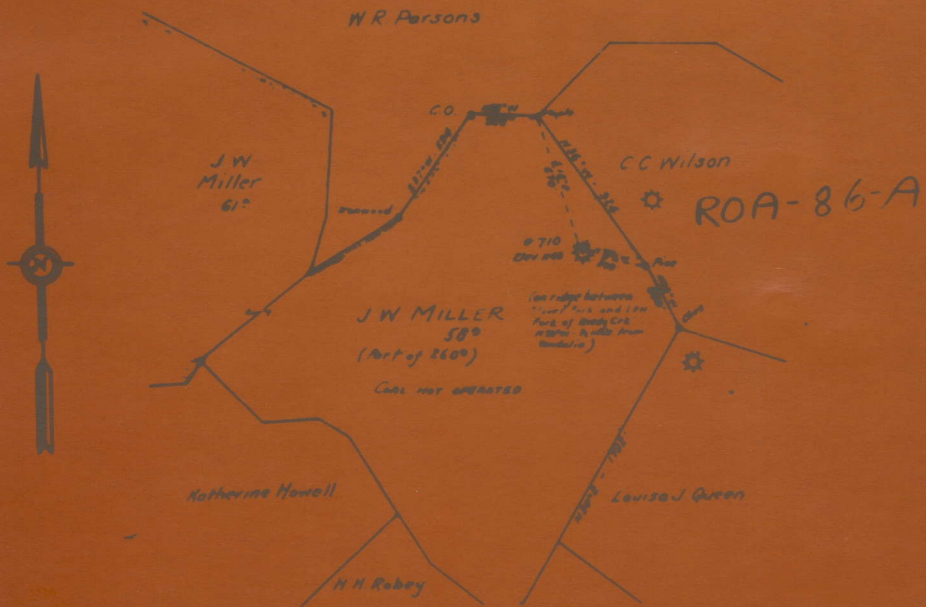

J. W. Miller
Well No. 710
Curtis District
Roane County, W. Va.
May 4, 1934

UNITED FUEL GAS CO.
MAP SHOWING
WELL TO BE ABANDONED
SCALE - 1 INCH = 660 FEET

MAY 6 - 1934

86A

Curtis District, Roane County, W. Va.
 By United Fuel Gas Co., Charleston, W. Va.
 On 260 acres, surface and mineral rights owned by J. W. Miller,
 Route 1, Spencer, W. Va.
 Drilled previous to June 1, 1929.
 Elevation, 1140' B.
 13" conductor, 16'; 6-5/8" casing, 2318'.
 Bottom hole packer, 8 1/2 x 6-5/8", set at 2305'.
 No coal was encountered.
 Abandonment reported to Dept. of Mines May 5, 1934.
 Well was not shot.
 Fresh water at 1330'; salt water at 1930'.
 Gas well.

	Top.	Bottom.	Thickness.
Pittsburgh Sand	650	- 740	90
Little Dunkard Sand	1120	- 1170	50
Big Dunkard Sand (water, 1330')	1400	- 1450	50
Shale	1452	- 1470	18
Gas Sand	1470	- 1850	380
Slate	1850	- 1865	15
Salt Sand (water, 1930'; gas, 1895')	1865	- 2230	365
Big Lime	2230	- 2305	75
Big Injun Sand	2305	- 2320	15
Berea Sand (gas, 2704-2711')	2701	- 2724	23
Shell	//// 2372	- 2400	28
Total depth			2724