

LATITUDE 38° 55'

LONGITUDE 91° 08'

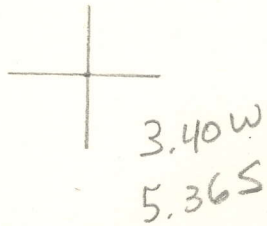

7'5 OGIS topo location

7.5' loc _____ 15' loc _____
 _____ (calc.) _____

Company _____

Farm _____

Quad Spencer (EC)

County Rowe

District Spencer

WELL LOCATION MAP

File No. 087-770A

CRAIG, W. S., NO. 8.

Roa-770-A.

By Weston-Spencer Corp.

Spencer Dist.

(NO PLAT)

see microfilm for
well record & Plat