

Latitude 38 40'

Longitude 81 15'

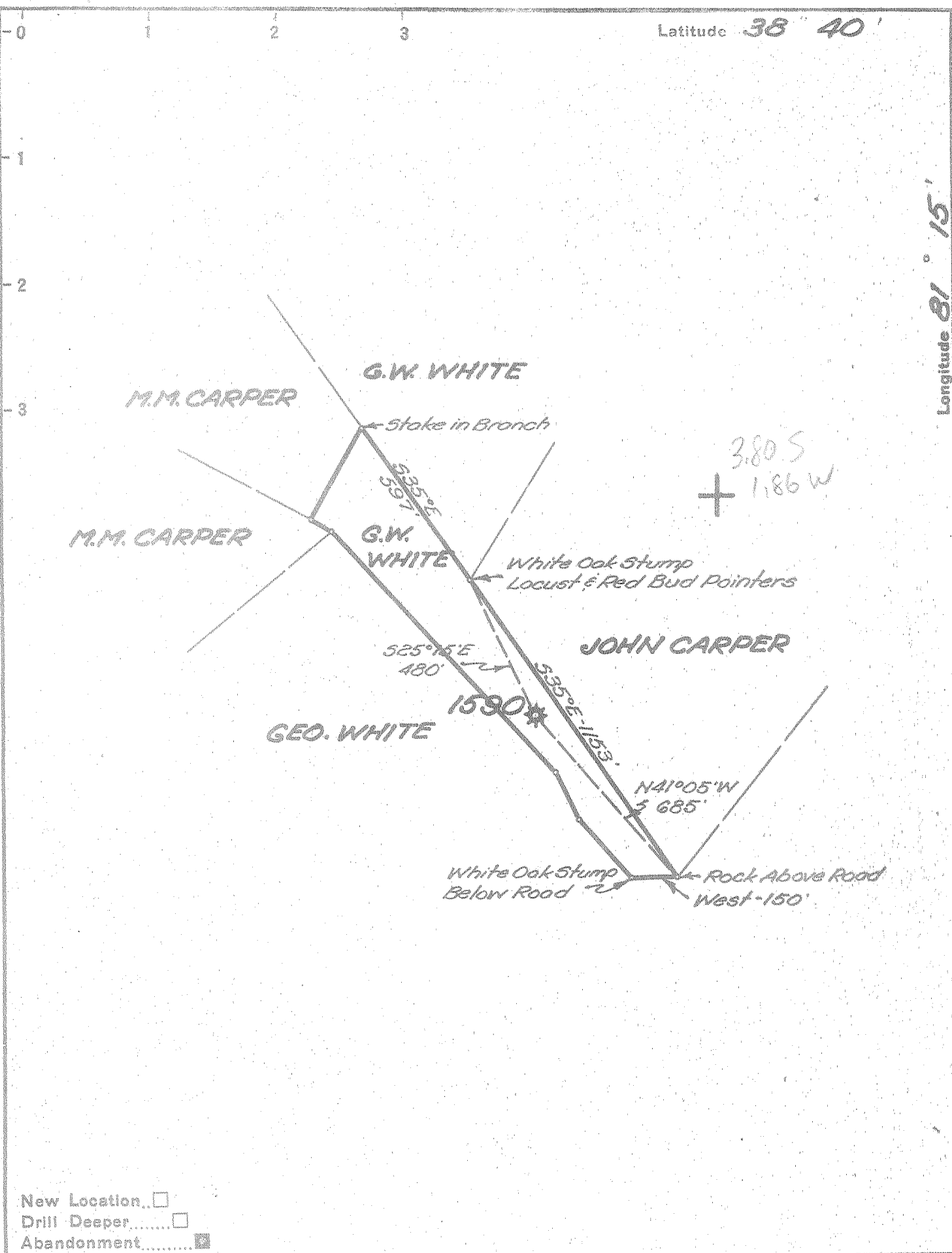

New Location   
 Drill Deeper   
 Abandonment

Company UNITED FUEL GAS CO.  
 Address CHARLESTON, W.VA.  
 Farm G.W. WHITE  
 Tract \_\_\_\_\_ Acres 8 Lease No. 9369  
 Well (Farm) No. 1 Serial No. 1590  
 Elevation (Spirit Level) 825.5'  
 Quadrangle WALTON  
 County ROANE District GEARY  
 Engineer Sybert Russell  
 Engineer's Registration No. 2529  
 File No. 80-75 Drawing No. \_\_\_\_\_  
 Date 4-28-54 Scale 1"=400'

STATE OF WEST VIRGINIA  
 DEPARTMENT OF MINES  
 OIL AND GAS DIVISION  
 CHARLESTON  
 9537  
 2152 see microfilm for well Record  
**WELL LOCATION MAP**  
 FILE NO. ROA-827-A

+ Denotes location of well on United States Topographic Maps, scale 1 to 62,500, latitude and longitude lines being represented by border lines as shown.  
 - Denotes one inch spaces on border line of original tracing.