

Latitude 38° 35'

Longitude 81° 15'

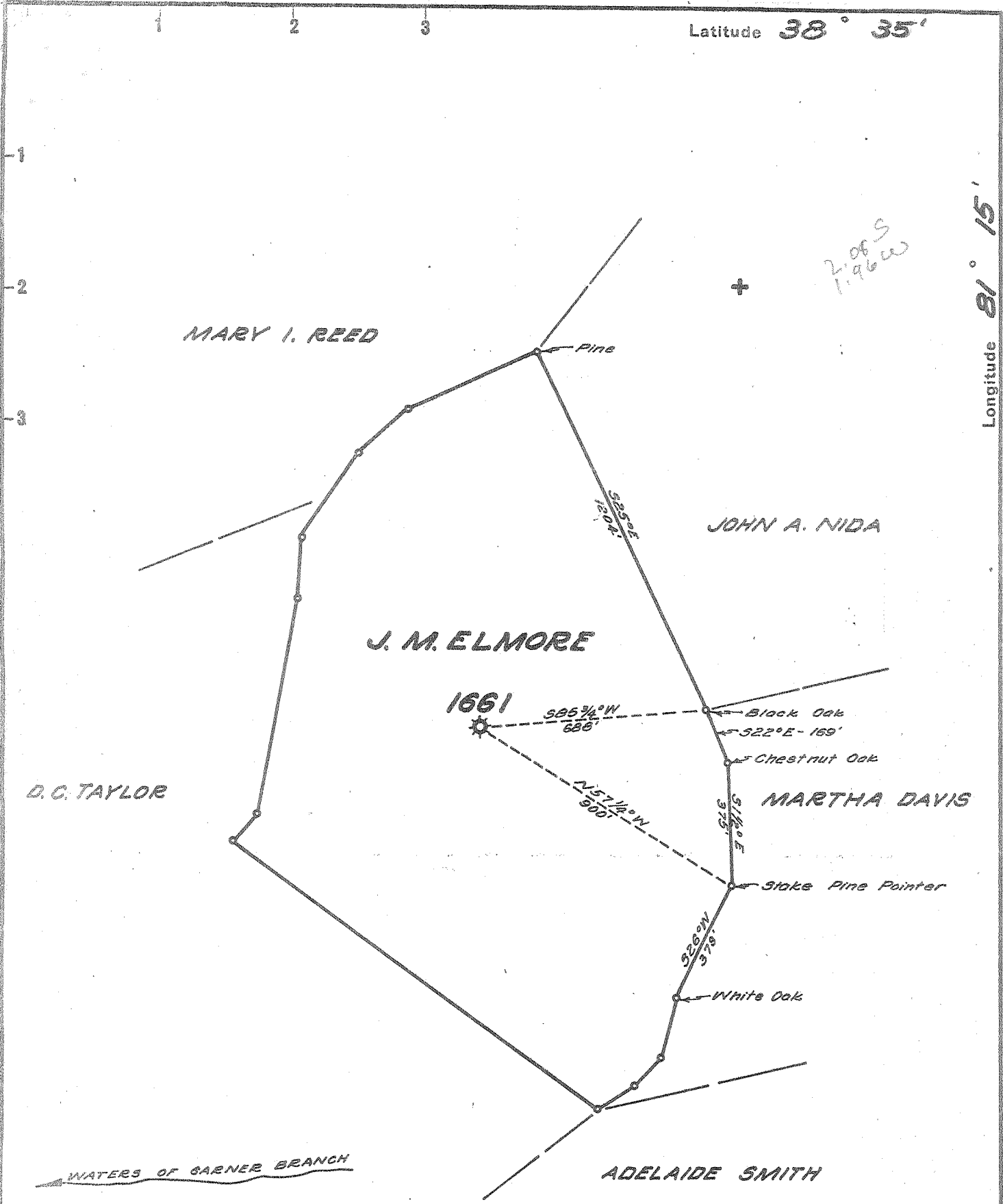

- New Location...
- Drill Deeper.....
- Abandonment.....

Company UNITED FUEL GAS CO.
 Address CHARLESTON, W. VA.
 Farm J. M. ELMORE
 Tract _____ Acres 50 Lease No. 19290
 Well (Farm) No. _____ Serial No. 1661
 Elevation (Spirit Level) 959.0
 Quadrangle WALTON
 County ROANE District GEARY
 Engineer Walter R. Russell
 Engineer's Registration No. 2529
 File No. 80-73 Drawing No. _____
 Date 6-24-55 Scale 1" = 400

STATE OF WEST VIRGINIA
 DEPARTMENT OF MINES
 OIL AND GAS DIVISION
 CHARLESTON

WELL LOCATION MAP
 FILE NO. ROA-950-A

- + Denotes location of well on United States Topographic Maps, scale 1 to 62,500, latitude and longitude lines being represented by border lines as shown.
- Denotes one inch spaces on border line of original tracing.

United Fuel Gas Company
COMPANY

519

AB 950-A

5000

Elm 959' L

SERIAL WELL NO. _____

LEASE NO. _____

MAP SQUARE _____

RECORD OF WELL NO. 1661	on the	CASING AND TUBING				TEST BEFORE SHOT	
John N. Elmore	farm of	Acres	SIZE	WEIGHT	USED IN DRILLING	LEFT IN WELL	/10 of Water in _____ inch
in Geary	District		8 1/2"		614'	614'	/10 of Merc. in _____ inch
Roane	County		6-5/8"		1712'	1712'	Volume _____ Cu. ft.
State of: West Virginia							TEST AFTER SHOT
Field:							/10 of Water in _____ inch
Rig Commenced	194						/10 of Merc. in _____ inch
Rig Completed	194						Volume _____ Cu. ft.
Drilling Commenced	June 29th	26					_____ Hours After Shot
Drilling Completed	August 1st	194					Rock Pressure _____
Drilling to cost	\$1.75	per foot					Date Shot _____
Contractor is: Lawrence Hoffman							Size of Torpedo _____
Address: c/o Jefferson Hotel							Oil Flowed _____ bbls. 1st 24 hrs.
Charleston, W. Va.					SHUT IN		Oil Pumped _____ bbls. 1st 24 hrs.
Driller's Name Paul More					Date: 8/3/26		
John Templeton					_____ in.	Tubing or Casing	
George Baker					Size of Packer 3" x 6-5/8"		Well abandoned and
O. H. Reed					Kind of Packer Anchor		Plugged _____ 194
Elevation:					1st. Perf. Set 1931' from		
					2nd Perf. Set 1889' from		

DRILLER'S RECORD
3rd Set 1839'

FORMATION	TOP	BOTTOM	THICKNESS	REMARKS
Clay	0	12	12	
Conductor		16		Gas Pay in Big Lime, Small Show.
Sand	16	28	12	No Test Taken 1756' to 1760'.
Red Rock	28	60	32	(Steel Line).
Shale	60	98	38	
Slate	98	120	22	
Sand	120	150	30	
				Water in Sand (2 Bailers) 145'.
Red Rock	150	210	60	
Slate	210	220	10	
Lime	220	225	5	
Sand	225	250	25	
Slate & Shells	250	300	50	
Black Slate	300	350	50	
Big Dunkard Sand	350	440	90	
Lime	440	460	20	
Slate & Lime Shells	460	540	90	

AUG 12 1955

