

Latitude 38° 35'

Longitude 81° 25'

1,585
1,100 W

+

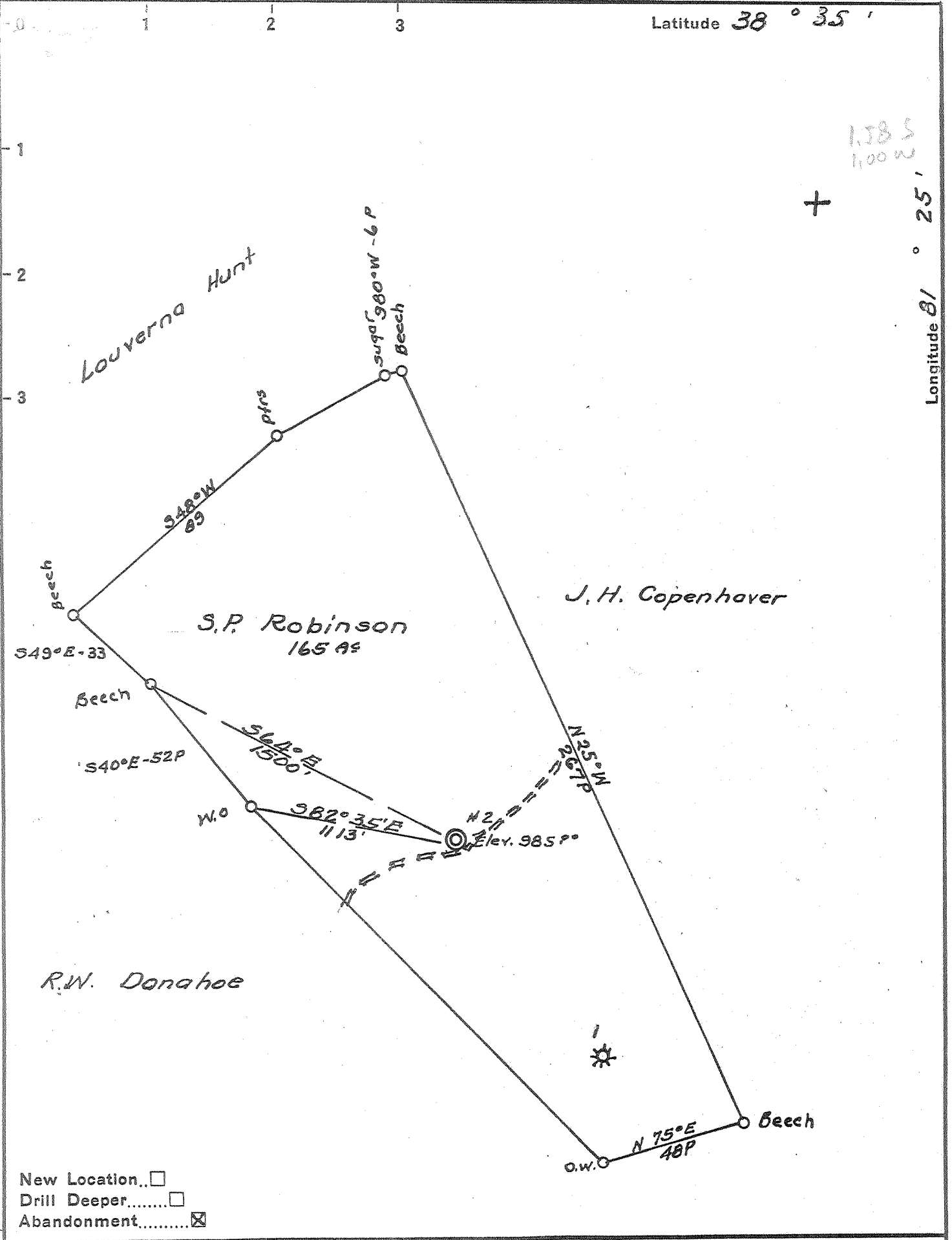

- New Location..
- Drill Deeper.....
- Abandonment.....

Company Ryan Oil Co.
 Address Walton Wva.
 Farm S.P. Robinson
 Tract _____ Acres 165 Lease No. _____
 Well (Farm) No. 2 Serial No. _____
 Elevation (Spirit Level) 985.00
 Quadrangle Walton
 County Roane District Walton
 Engineer L. F. Dye
 Engineer's Registration No. 804
 File No. _____ Drawing No. _____
 Date 11-7-55 Scale 1" = 40 Pdes

STATE OF WEST VIRGINIA
 DEPARTMENT OF MINES
 OIL AND GAS DIVISION
 CHARLESTON

WELL LOCATION MAP
 FILE NO. ROA-1005-A

+ Denotes location of well on United States Topographic Maps, scale 1 to 62,500, latitude and longitude lines being represented by border lines as shown.

- Denotes one inch spaces on border line of original tracing.



180

STATE OF WEST VIRGINIA
DEPARTMENT OF MINES
OIL AND GAS DIVISION

Quad. Walton
 Permit No. 1005-A
 Company Ryan Oil Company
 Address 218 Court Bldg., Evansville, Ind.
 Farm S. P. Robinson Acres 165
 Location (waters) Green Creek
 Well No. 2 Elev. 985'
 District Walton County Roane
 The surface of tract is owned in fee by Robinson Heirs Address ---
 Mineral rights are owned by Ryan Oil Co. Address as above
 Drilling commenced Info. not shown on
 Drilling completed present records
 Date Shot From --- To ---
 With ---
 Open Flow --- /10ths Water in --- Inch
--- /10ths Merc. in --- Inch
 Volume --- Cu. Ft.
 Rock Pressure --- lbs. /10 hrs.
 Oil --- bbls., 1st 24 hrs.
 Fresh water --- feet
 Salt water --- feet

WELL RECORD

Oil or Gas Well GAS
(KIND)

Casing and Tubing	Used in Drilling	Left in Well	Packers
Size			Kind of Packer *
16			* <u>NO RECORD</u>
13			Size of
10	300'	0'	Depth set
8 1/4	800'	0'	Perf. top
6 3/4	1425'	1425'	Perf. bottom
5 3/16			Perf. top
3	1870'	1870'	Perf. bottom
2			
Liners Used			

CASING CEMENTED --- SIZE --- No. Ft. --- Date ---
 COAL WAS ENCOUNTERED AT --- FEET --- INCHES
--- FEET --- INCHES --- FEET --- INCHES
--- FEET --- INCHES --- FEET --- INCHES

Formation	Color	Hard or Soft	Top	Bottom	Oil, Gas or Water	Depth Found	Remarks
Salt sand			1570'				
Big Lime			1828'				
Big Injun			1965'	2066'			
Total Depth				2066'			

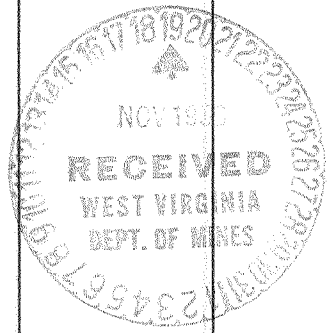

JUN 20 1957