

*TJED*

LATITUDE 38° 40'  
38 37 30

LONGITUDE 81° 25'

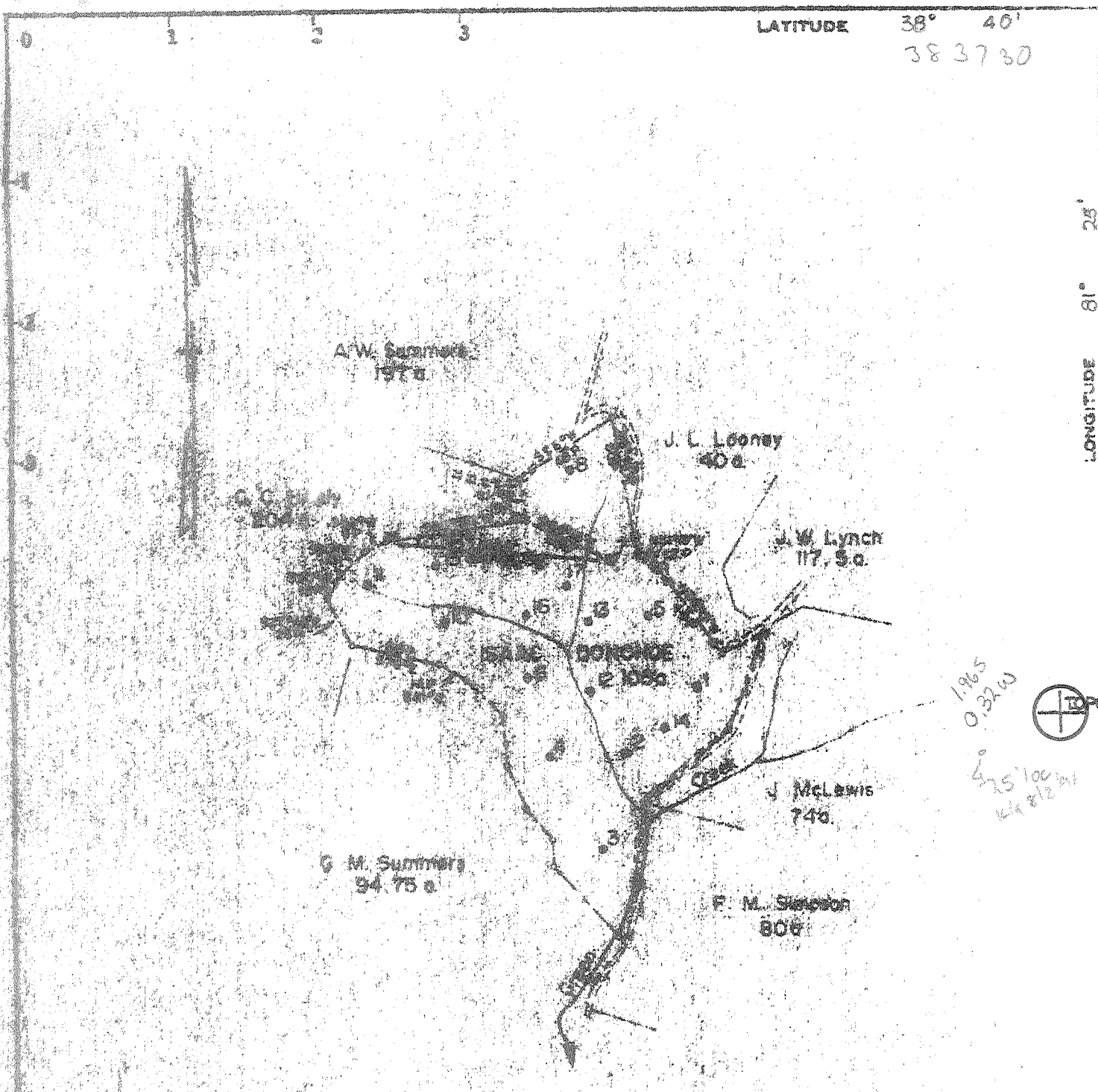

Surveyor:  
Evo M. Jarron  
Metch, W. Va.  
25296

Minimum Spacing of Crosses 1 in: 200'  
Source of Records PENNZOIL COMPANY RECORDS

I, the undersigned, hereby certify that this map is correct to the best of my knowledge and belief, and that the same complies with the provisions of paragraph 5 of the rules and regulations of the Oil and Gas Board of the State of West Virginia.

*[Signature]*  
No. 70 588 E W46

Company	PENNZOIL COMPANY
Address	P.O. Box 150, Piquette, W. Va. 26052
Firm	DAVID BOWDRE
Tract	Area 92 Lease No. 2178-52
Well (Farm) No.	7 Serial No.
Elevation (Spot Level)	307.95'
County	WILLIAMS
District	WILLIAMS
Surveyor	CURTIS A. LUCAS
Surveyor's Registration No.	875
File No.	1500 Drawing No.
Date	6-18-74 Scale 1" = 1000'

STATE OF WEST VIRGINIA  
Department of Mines  
OIL AND GAS DIVISION  
CHARLESTON

WELL LOCATION MAP  
FILE NO. ROA-1167-A

+ Denotes location of well on United States Topographic Map, scale 1 to 62,500, latitude and longitude lines being represented by dotted lines as shown.

- Denotes one inch spaces on border line of original tracing. **47 087**

6-6 (196)

87-31167

Sheet #559

Chatham Oil Co. COMPLETION

SERIAL NO. FARM T.A. Donahue WELL NO. 7
ELEVATION N. S. 58 E. W. 47
CONTRACTOR ACRES
WATERS OF Green Creek
DISTRICT Walton COUNTY Roane STATE W. Va.
DRILLING COMMENCED COMPLETED 8/15/08 DEPTH 2075 2070

Table with columns: SANDS, TOP, BOTTOM, ELEV. TOP, CASING. Includes row for PGH. COAL OR BIG LIME and PACKERS AND DEPTH SET.

INITIAL PROD. 40 Bbls. SAND Injun DEPTH
GAS TEST " "
SHOT QUARTS "
REMARKS Comp. in Injun
See microfilm for well record
REPORTED BY ABANDONED

Form 534

FILE NO. Roa-1167-A

PENNZOIL UNITED, INC. - COMPLETION

SERIAL NO. FARM Isaac Donohoe WELL NO. 7
ELEVATION 997.95 N. S. 58 E. W. 47
LEASE NO. ACRES 105
WATERS OF MAP NO. 70
DISTRICT Walton COUNTY Roane STATE W. Va.
DRILLING COMMENCED COMPLETED DEPTH

Table with columns: SANDS, TOP, BOTTOM, ELEV. TOP, CASING. Includes row for PGH. COAL OR BIG LIME and PACKERS AND DEPT. SET.

INITIAL PROD. SAND DEPTH
GAS TEST " "
SHOT - FRAC. "
REMARKS
REPORTED BY AREA ABANDONED 10-4-74

70321  
7076

Walton District, Roane County, W. Va.

By Louis P. Faye Oil Co.

Contractor, Joshua Davis. (\$1.40).

Elevation, 993' L.

Drilling commenced July 10, 1908; completed Aug. 14, 1908.

Shot Aug. 14, 1908, with 35 qts., at 2035-2060'; Apr. 26, 1913,  
with 60 qts., at 2030-2060'; and Apr. 2, 1923, with 30 qts.,  
at 2040-2060'.

7-25-28.--Barrel and perforation lowered; 10' 9" anchor.

13" casing, 13'; 10", 370'; 8 1/2", 890'; 6 3/4", 1890' (left in).

Record in Eastern Petroleum Co. Well Record book of Clifton Oil & Gas Co.

	Top.	Bottom.
Little Dunkard Sand	765	- 802
Big Dunkard Sand	815	- 925
First Salt Sand (water, 1513')	1420	- ....
Little Lime	1860	- 1885
Big Lime	1888	- ....
Big Injun Sand (oil, 2030-2070')	2035	- 2070
Total depth		2070

# WELL RECORD

287-31167  
287-1167A

PRODUCTION FIRST 24  
HOURS FROM

Sand

Blbs. Approved.

Sand

Blbs. By

Supt.

*I A Donohoe*  
*J. S. Summers, Donohoe, Donohoe* FARM No. OF LEASE ..... No. ACRES  
*Walton* DISTRICT *Roane* COUNTY *W. Va.* STATE

WELL No. *7* DATE OF LOCATION ..... 19.....

RIG COMMENCED .....	19.....	} <i>Joshua Davis</i> <i>2.1.40</i> CONTRACTOR
RIG COMPLETED .....	19.....	
DRILLING COMMENCED <i>July 10</i> .....	19. <i>2.8</i> .....	
DRILLING COMPLETED <i>August 14</i> .....	19. <i>0.8</i> .....	

### CASING RECORD

Size	CHARGED TO WELL		PUT IN WELL		BOTTOM OF CASING		PULLED OUT OF WELL		LEFT IN WELL		TRANSFERRED Before Completion		LEFT AT WELL NOT IN USE	
	Feet	In.	Feet	In.	Feet	In.	Feet	In.	Feet	In.	Feet	In.	Feet	In.
<i>13</i>			<i>13</i>											
<i>10</i>			<i>370</i>											
<i>8 1/2</i>			<i>830</i>											
<i>6 3/4</i>			<i>1890</i>							<i>1890</i>				

*See microfilm for Well Record*

Formation	Top	Bottom	Remarks
Conductor			<i>Shot 8/14/08 35gts</i>
Native Coal			<i>" 4/20/13 "60"</i>
Pittsburgh Coal			<i>" 4/2/23 "30"</i>
Little Dunkard Sand	<i>765</i>	<i>802</i>	
Big Dunkard Sand	<i>815</i>	<i>925</i>	
First Salt Sand	<i>1420</i>		
Second Salt Sand			
Water	<i>1513</i>		
Maxon Sand			
Little Lime	<i>1860</i>	<i>1885</i>	
Pencil Cave			
Big Lime	<i>1888</i>		
Big Injun Sand	<i>2035</i>	<i>2070</i>	<i>25</i>
Gas			
First Pay			
Second Pay			
Water			
Squaw Sand			
Gantz Sand			
Fifty Foot Sand			
Thirty Foot Sand			
Gordon Stray Sand			
Gordon Sand			
Gas			
First Pay			
Second Pay			
Fourth Sand			
Fifth Sand			
Gas			
Oil	<i>2030</i>	<i>2070</i>	
Bayard Sand			
Total Depth		<i>2070</i>	

ABANDONED ..... 19.....

Size Casing Pulled Casing Left In

REMARKS