

# BOWLEY LEASE 44.5 ACRES±

LATITUDE 39°17'30"

## BOWLEY 2

MALEY  
38.20 ACRES±

MAYLE, ET AL  
43.75 ACRES±

MYERS POINT INC.  
26.63 ACRES±

SHERRON  
30.62 ACRES±

MCVICKER  
99.44 ACRES±

BOWLEY  
34.15 ACRES±

CONSERVATION  
COMMISSION OF  
WEST VIRGINIA  
134.5 ACRES±

USA  
12.62 ACRES±

BOWLEY 2  
STATE PLANE  
COORDINATES  
NORTH ZONE  
(N) 282362  
(E) 1850586

BOWLEY 2  
DECIMAL L & L  
39.27406  
80.02778

### NOTES ON SURVEY

TIES TO WELLS AND CORNERS ARE BASED ON STATE PLANE GRID NORTH WV NORTH ZONE NAD '27.

TIES TO REFERENCES ARE BASED ON MAGNETIC NORTH 09-29-08.

LEASE BOUNDARY SHOWN HEREON TAKEN FROM A WELL PLAT FOR WELL 47-091-00924 AND INFORMATION PROVIDED BY PETROLEUM DEVELOPMENT CORP.

SURFACE OWNER AND ADJOINER INFORMATION TAKEN FROM THE ASSESSOR AND COUNTY CLERK RECORDS OF TAYLOR COUNTY IN DECEMBER, 2008 AND INFORMATION PROVIDED BY PETROLEUM DEVELOPMENT CORP.

WELL LAT./LONG. ESTABLISHED BY DGPS(SUBMETER MAPPING GRADE).

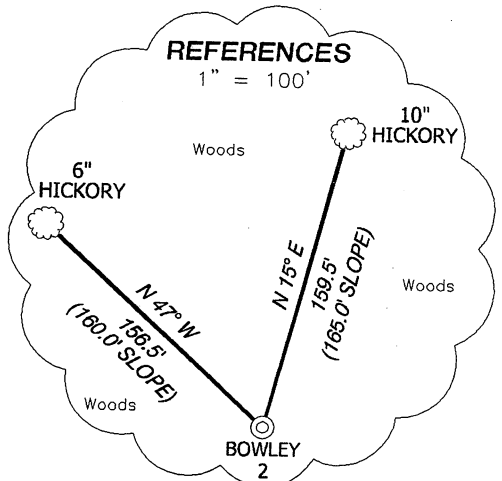
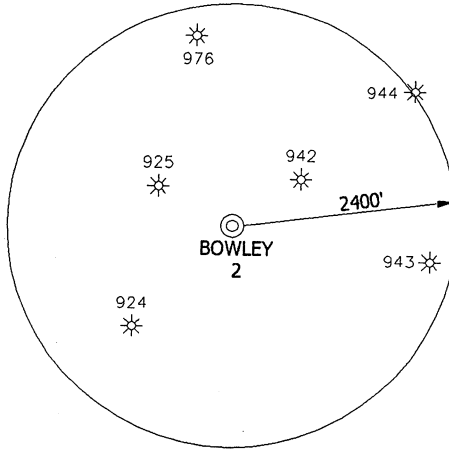

I THE UNDERSIGNED, HEREBY CERTIFY THAT THIS PLAT IS CORRECT TO THE BEST OF MY KNOWLEDGE AND BELIEF AND SHOWS ALL THE INFORMATION REQUIRED BY LAW AND THE REGULATIONS ISSUED AND PRESCRIBED BY THE DIVISION OF ENVIRONMENTAL PROTECTION.

P.S. 834   
 HUPP Surveying & Mapping  
 P.O. Box 647 Grantsville, WV 26147  
 (304) 354-7035 EMAIL: hupp@frontiernet.net

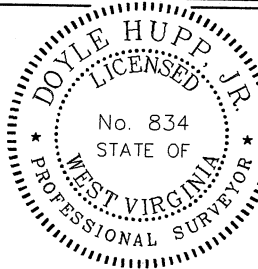

(+) DENOTES LOCATION OF WELL ON UNITED STATES TOPOGRAPHIC MAPS.

DATE APRIL 22, 20 09

OPERATORS WELL NO. BOWLEY 2

API WELL NO. 47-091-01145  
 STATE WV COUNTY PE PERMIT CANCELLED

MINIMUM DEGREE OF ACCURACY 1/200 FILE NO. W1790 (BK 37-67)  
 PROVEN SOURCE OF ELEVATION DGPS (SUBMETER GRADE) SCALE 1" = 500'

STATE OF WEST VIRGINIA  
 DIVISION OF ENVIRONMENTAL PROTECTION  
 OFFICE OF OIL AND GAS

WELL TYPE : OIL  GAS  LIQUID INJECTION  WASTE DISPOSAL  IF "GAS" PRODUCTION  STORAGE  DEEP  SHALLOW

LOCATION : ELEVATION 1,268' WATERSHED TYGART VALLEY RIVER  
 DISTRICT COURT HOUSE COUNTY TAYLOR QUADRANGLE GRAFTON 7.5'

SURFACE OWNER FRED & AVELINA BOWLEY ACREAGE 34.15±  
 ROYALTY OWNER FRED & AVELINA BOWLEY LEASE ACREAGE 44.5±

PROPOSED WORK : LEASE NO. 478100  
 DRILL  CONVERT  DRILL DEEPER  REDRILL  FRACTURE OR STIMULATE  PLUG OFF OLD FORMATION  PERFORATE NEW FORMATION  PLUG AND ABANDON  CLEAN OUT AND REPLUG  OTHER

PHYSICAL CHANGE IN WELL (SPECIFY) \_\_\_\_\_ TARGET FORMATION BENSON  
 ESTIMATED DEPTH 5,500'

WELL OPERATOR PETROLEUM DEVELOPMENT CORP. DESIGNATED AGENT ALAN SMITH  
 ADDRESS 120 GENESIS BLVD. BRIDGEPORT, WV 26330 ADDRESS 120 GENESIS BLVD. BRIDGEPORT, WV 26330