

PDC MOUNTAINEER, LLC
WELL NO. UNB 2HM

NOTE:
 -BOTTOM HOLE 25' NORTH OF LEASE LINE

LATITUDE 39° 27' 30"

6,701' BOTTOM HOLE

NOTES:
 -PLAT ORIENTATION, CORNERS, AND WELL REFERENCES ARE BASED UPON THE GRID NORTH MERIDIAN FOR THE WV STATE PLANE COORDINATE SYSTEM, NORTH ZONE NAD 27. WELL LOCATION REFERENCE TIES ARE BASED UPON THE MAGNETIC MERIDIAN.
 -THERE APPEARS TO BE 1 WATER WELL LOCATED WITHIN 1000' OF WELL UNB 2HM.

BRIAN D. & TRACEY D. PARK & SURV
 TM 3 PAR 21
 DB 256 PG 10
 35.88 AC±

MARY ERICKSON
 TM 3 PAR 22
 WB 57 PG 194
 3 AC±

JAMES E. & WANDA M. MCCARTNEY & SURV
 TM 3 PAR 33.1
 DB 302 PG 131
 12.2 AC±

CHARLES E. MACDONALD
 TM 3 PAR 16
 DB 126 PG 230
 222.75 AC±

CARL B. MCCARTNEY SR (HORS)
 TM 3 PAR 33
 DB 235 PG 332
 98.8 AC±

ESMAIL R. & SHERRY MOHAZAM & SURV
 TM 3 PAR 23
 DB 256 PG 8 8.44 AC±

WV L00519

WV L00665

VIRGINIA MORGAN BREWER
 TM 6 PAR 7
 DB 162 PG 385
 230 AC±

VIRGINIA MORGAN BREWER
 TM 6 PAR 6
 DB 162 PG 385
 4.004 AC±

VIRGINIA MORGAN BREWER
 TM 6 PAR 4
 DB 162 PG 385
 37.91 AC±

VIRGINIA MORGAN BREWER
 TM 6 PAR 44
 DB 162 PG 385
 96 AC±

VIRGINIA MORGAN BREWER
 TM 6 PAR 43
 DB 162 PG 385
 49.67 AC±

VIRGINIA MORGAN BREWER
 TM 6 PAR 42
 DB 162 PG 385
 50 AC±

RONALD G. & MARY L. FORD & SURV
 TM 6 PAR 64
 DB 172 PG 566
 29.8 AC±

JACK D. & SHIRLEY R. CAWTHON & SURV
 TM 6 PAR 60 DB
 298 PG 70
 15.9 AC±

VERNON L. & ROMA POLING & SURV
 TM 6 PAR 59
 DB 296 PG 221
 24.98 AC±

ROY L. II & SUSAN A. SEXTON & SURV
 TM 6 PAR 8
 DB 196 PG 70
 94.4 AC±

MORGANTOWN LANDSCAPERS INC.
 TM 6 PAR 39
 DB 231 PG 488
 71 AC±

JOSEPH R. & TAMMY K. BARNES & SURV
 TM 8 PAR 40.11
 DB 289 PG 335
 10.7 AC±

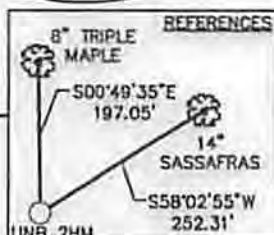

WELL NO. 2HM
 TOP HOLE
 STATE PLANE COORDINATES
 (NAD 27 NORTH ZONE)
 N: 340484.4230
 E: 1874550.5453
 LAT: 39° 26' 02.326"
 LON: 79° 56' 38.911"
 UTM COORDINATES
 (NAD 83-METER)
 N: 4365479.421
 E: 590888.240

WELL NO. 2HM
 LAUNCH POINT
 STATE PLANE COORDINATES
 (NAD 27 NORTH ZONE)
 N: 340102.426
 E: 1873670.323
 LAT: 39° 25' 58.825"
 LON: 79° 56' 49.358"
 UTM COORDINATES
 (NAD 83-METER)
 N: 4365358.566
 E: 590619.979

WELL NO. 2HM
 BOTTOM HOLE
 STATE PLANE COORDINATES
 (NAD 27 NORTH ZONE)
 N: 334217.286
 E: 1875582.521
 LAT: 39° 25' 00.754"
 LON: 79° 56' 24.620"
 UTM COORDINATES
 (NAD 83-METER)
 N: 4363575.224
 E: 591232.411

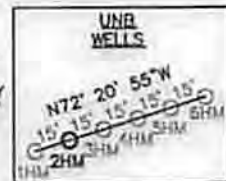

Michael R. Hyman, P.S. 983

I, THE UNDERSIGNED, HEREBY CERTIFY THAT THIS PLAT IS CORRECT TO THE BEST OF MY KNOWLEDGE AND BELIEF AND SHOWS ALL THE INFORMATION REQUIRED BY LAW AND THE REGULATIONS ISSUED AND PRESCRIBED BY THE DIVISION OF ENVIRONMENTAL PROTECTION.

FILE NO. 030-1999

SCALE: 1"=1000'

MINIMUM DEGREE OF ACCURACY: 1 in 2500

PROVEN SOURCE OF ELEVATION: OPUS SURVEY GRADE GPS

STATE OF WEST VIRGINIA
 DIVISION OF ENVIRONMENTAL PROTECTION
 OFFICE OF OIL & GAS

DATE OCTOBER, 2013

OPERATOR'S WELL NO. UNB NO. 2HM

API WELL NO. MOD
 47 - 091 - 01259H6A
 STATE COUNTY PERMIT

WELL TYPE: OIL GAS LIQUID INJECTION WASTE DISPOSAL (IF "GAS"), PRODUCTION STORAGE DEEP SHALLOW
 LOCATION: ELEVATION: 1878' WATER SHED: WHITE DAY CREEK
 DISTRICT: FETTERMAN COUNTY: TAYLOR
 QUADRANGLE: GLADESVILLE 7.5' ACREAGE: 222.75 AC±
 SURFACE OWNER: CHARLES E. MACDONALD LEASE ACREAGE: 322.42 AC +
 OIL & GAS ROYALTY OWNER: UNION NAT'L BANK, TRUSTEE FOR GORE-MORRIS, ET AL. LEASE NO. WV L00519 WV L00665

PROPOSED WORK: DRILL CONVERT DRILL DEEPER REDRILL FRACTURE OR STIMULATE
 PERFORATE NEW FORMATION PLUG OFF OLD FORMATION OTHER PHYSICAL CHANGE IN WELL (SPECIFY)

PLUG AND ABANDON CLEAN OUT AND REPLUG
 TARGET FORMATION: MARCELLUS SHALE ESTIMATED DEPTH: 7,830' TVD / 14,920' MD

WELL OPERATOR: PDC MOUNTAINEER, LLC DESIGNATED AGENT: JAMES A HAGA
 ADDRESS: 120 GENESIS BOULEVARD ADDRESS: 120 GENESIS BOULEVARD
 BRIDGEPORT, WV 26330 BRIDGEPORT, WV 26330

08/15/2014

USER: kooth LAYOUT: WELLS (2) NORTH PLOT DATE/TIME: 10/7/2013 - 2:34pm CAD FILE: R:\030-1999 PDC Compton A\Survey\030-1999 WELLS 9-3-13.dwg