

SURFACE HOLE SURVEYED 39° 17' 30" (NAD27)  
 BOTTOM HOLE SURVEYED 39° 12' 30" (NAD27)

Latitude: (NAD27)

BOTTOM HOLE NAD27  
 LAT. 39.207510°  
 LON. -80.137011°

822' 3.472'

12.048'

(NAD83-WVN) US SURVEY FT.

TOP HOLE  
 N) 277031.722  
 E) 1779051.662  
 LANDING POINT  
 N) 277336.930  
 E) 1781507.600  
 BOTTOM HOLE  
 N) 258398.570  
 E) 1788050.020

(NAD83-LAT/LONG) DECIMAL

TOP HOLE  
 N) 39.258663  
 E) -80.169081  
 LANDING POINT  
 N) 39.259552  
 E) -80.160396  
 BOTTOM HOLE  
 N) 39.207604  
 E) -80.136816

(UTM, NAD83) METER

TOP HOLE  
 N) 4345810.424  
 E) 571690.244  
 LANDING POINT  
 N) 4345915.858  
 E) 572436.944  
 BOTTOM HOLE  
 N) 4340169.931  
 E) 574526.258



REFERENCE NOTES  
 1. Property lines as shown taken from deeds, tax maps, and field locations. A full boundary survey is not expressed or implied. All bearings are based on grid North. Ownership taken from public records for Taylor, Harrison, and Barbour County, West Virginia Date 2022  
 2. State Plane Coordinates & NAD83 Lat/Long by differential submeter mapping grade GPS.  
 3. There are no railroads, dwellings, or agricultural buildings within 625 feet of center of pad.  
 4. No water wells found within 250' of the center of well pad.

LEGEND

- PROPOSED WELL LATERAL
- - - - PROPOSED WELL TIE LINE
- STREAM
- EXISTING ROAD
- BUFFER
- PROPERTY LINE
- MINERAL TRACT BOUNDARY
- COUNTY BOUNDARY LINE
- #H PROPOSED WELL HEAD
- ⊗ EXISTING WELL HEAD (Active)
- ⊕ EXISTING WELL HEAD (Plugged)
- ⊖ EXISTING WELL HEAD (Abandoned)
- ⊙ EXISTING WELL HEAD (Never Drilled)
- EXISTING WELL HEAD (Future Drill)
- LANDING POINT/BOTTOM HOLE
- ⊕ SURFACE OWNER

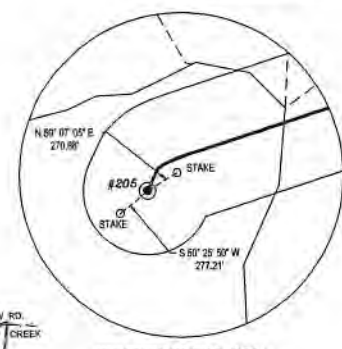
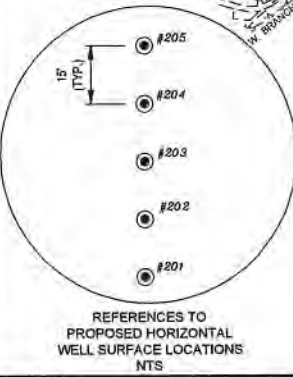

SURFACE HOLE NAD27 #205  
 LAT. 39.258572°  
 LON. -80.169254°

RECEIVED  
 Office of Oil & Gas  
 JUL 05 2022  
 WV Department of  
 Environmental Protection

FILE#: 22078-001  
 SHEET#: 1 of 2  
 SCALE: 1" = 3000'  
 TICK SCALE: 1" = 2000'  
 MINIMUM DEGREE OF ACCURACY: 1/200  
 PROVEN SOURCE OF ELEVATION: WV-RTN CORS STATION

I, THE UNDERSIGNED, HEREBY CERTIFY THAT THIS PLAT IS CORRECT TO THE BEST OF MY KNOWLEDGE AND BELIEF AND SHOWS ALL THE INFORMATION REQUIRED BY LAW AND THE REGULATIONS ISSUED AND PRESCRIBED BY THE DEPARTMENT OF ENVIRONMENTAL PROTECTION.  
 Signed: *Herbert L. Parsons, III* 6-28-2022  
 P.S. #2361: Herbert L. Parsons, III P.S.



(+) DENOTES LOCATION OF WELL ON UNITED STATES TOPOGRAPHIC MAPS  
 WVDEP  
 OFFICE OF OIL & GAS  
 601 57TH STREET  
 CHARLESTON, WV 25304  
 Well Type:  Oil  Waste Disposal  Production  Deep  
 Gas  Liquid Injection  Storage  Shallow  
 WATERSHED: SIMPSON CREEK  
 COUNTY / DISTRICT: TAYLOR CO. FLEMINGTON DISTRICT  
 SURFACE OWNER: RENEE JOHNSON  
 OIL & GAS ROYALTY OWNER: SEE WW-6A1  
 TARGET FORMATION: MARCELLUS  
 WELL OPERATOR: ARSENAL RESOURCES  
 ADDRESS: 6031 WALLACE ROAD EXTENSION # 300  
 CITY: WEXFORD STATE: PA ZIP: 15090



DATE: JUNE 28, 2022  
 JOHNSON TFP-40  
 OPERATOR'S WELL #: # 205  
 API WELL #: 47 091 01370 H6A  
 STATE COUNTY PERMIT  
 ELEVATION: 1,332.5'  
 QUADRANGLE: ROSEMONT, WV  
 ACREAGE: 284 ±  
 ACREAGE: 284 ±  
 ESTIMATED DEPTH: TVD: 7,903.5' TMD: 28,840.6'  
 DESIGNATED AGENT: NATHAN SKEEN  
 ADDRESS: 633 MAIN STREET  
 CITY: BRIDGEPORT STATE: WV ZIP: 26330

- DRILL  CONVERT  DRILL DEEPER  REDRILL  FRACTURE OR STIMULATE
- PLUG OFF FORMATION  PERFORATE NEW FORMATION  PLUG & ABANDON
- CLEAN OUT & REPLUG  OTHER CHANGE SPECIFY: \_\_\_\_\_

BOTTOM HOLE SURVEYED 80° 07' 30" (NAD27)  
 SURFACE HOLE SURVEYED 80° 10' 00" (NAD27)



ID#	DEP#	PARCEL NUMBER	OWNER NAME
1	033	17-15-0331-0027-0000	JOHNSON RENEE
5	091	46-04-0011-0001-0000	CFS FARMS LIMITED LIABILITY CO
2	001	01-09-0009-0002-0000	STEWART FARM LLC
21	091	46-04-0011-0005-0005	BECKWITH LUMBER COMPANY
28	091	46-04-0011-0005-0003	SEESE BRENDA KAY & JOANN V SMITH & SURV
26	091	46-04-0011-0005-0001	RAVIS THOMAS E
27	091	46-04-0011-0003-0000	PROPT PAUL
43	001	01-09-0009-0022-0000	WOLFE LARRY, ROBERT WOLFE & STANLEY WOLFE ET UXES, HWS
51	001	01-09-0009-0022-0003	KRAZNER FRANK A & RENEE B HWS
197	001	01-09-0012-0013-0002	FARRIS VERNIE L/E THEN RAYMOND E FARRIS
55	001	01-09-0012-0015-0000	TR MT VERNON BAP CHURCH
56	001	01-09-0012-0012-0000	BOARD OF EDUCATION
37	001	01-09-0012-0013-0000	FARRIS VERNIE L/E
102	001	01-09-012B-0046-0002	HILL MARK ALLEN & DEBRA K
103	001	01-09-012B-0046-0003	MILLER ASHLEY
58	001	01-09-0012-0010-0000	VUKOVICH ROBERT K & SHELIA MARIE VUKOVICH & CAROL A SPEAR
104	001	01-09-0012-0052-0000	MONTGOMERY BRADFORD EUGENE & GEORGIA, HWS
106	001	01-09-0012-0051-0002	BECKWITH LUMBER CO
108	001	01-09-0012-0052-0001	MARTIN ROBERT E
160	001	01-09-0012-0054-0000	MARTIN ROBERT E
159	001	01-09-0012-0050-0001	STREETS BRENDA K ET ALS
162	001	01-09-0012-0055-0000	CORDER WAYNE D & JEANETTE S, HWS

ID#	DEP#	PARCEL NUMBER	OWNER NAME
100	033	17-15-0351-0009-0000	JOHNSON RENEE
88	033	17-15-0351-0010-0000	JOHNSON RENEE
101		RIGHT-OF-WAY	COUNTY ROUTE 17 ORAL LAKE ROAD
3	091	17-15-0351-0013-0000	GCSTREAM LLC
4	091	17-15-0351-0012-0000	GCSTREAM LLC
99	091	46-04-0007-0006-0000	FRUM SHIRLEY A
96	091	46-04-0007-0009-0000	CEQUEL III COMMUNICATIONS
97	091	46-04-0007-0027-0000	CEQUEL III COMMUNICATIONS
96	091	46-04-0008-0021-0000	MILLARD CARLYLE G
6	091	46-04-0008-0022-0000	GRIPPIN JAMES S & ELAINE M
7	091	46-04-0008-0023-0000	GRAY RANDALL & RITA
8	091	46-04-0008-0035-0000	MARKS BETTY P
9	091	46-04-0008-0029-0000	COALQUEST DEVELOPMENT LLC
10	091	46-04-0008-0105-0000	BLOSSER PATRICK B ETAL ROBERT C & CLINTON D & SURV
11	091	46-04-0008-0081-0000	SIMMONS HUNTER
12	091	46-04-0008-0083-0000	PRATT JANICE&CHARLENE MOORE & CURTIS & DAVID STEWART
13	091	46-04-0008-0084-0000	PRATT JANICE & CHARLENE MOORE & CURTIS & DAVID STEWART
14	091	46-04-0008-0090-0001	SINSEL FRANCES E
15	091	46-04-0008-0084-0000	COUNTY ROUTE 3/10 STEWARTS HOLLOW ROAD
16	091	46-04-0008-0037-0001	CRISS DAVID & CATHY & SURV
159		RIGHT-OF-WAY	STATE ROUTE 76 E. VETERANS MEMORIAL HWY.
16	091	46-04-0011-0019-0000	SALTIS STEVEN A & NICOLE J & SURV
17	091	46-04-0011-0017-0000	GRONAU JOHN R & KAITLYN N & SURV
17	091	46-04-0011-0001-0001	ANDERSON DANIEL & KAREN & SURV
19	091	46-04-0011-0017-0003	SIMPSON JOHN E
20	091	46-04-0011-0009-0000	WATKINS DOUGLAS R & ANNA M & SURV
23	091	46-04-0011-0008-0000	ASTOR CEMETERY
22	091	46-04-0011-0005-0006	SMITH ROBIN M
24	091	46-04-0011-0007-0005	SANFORD RICHARD LEE & PAMELA & SURV
25	091	46-04-0011-0006-0000	RAVIS THOMAS E
94	091	46-04-0011-0005-0000	SWICK DEARL J
29	091	46-04-0011-0004-0000	SEESE BRENDA K & SMITH JOANN V & SURV
30	091	46-04-0011-0002-0000	PROPT PAUL
31	001	01-09-0009-0006-0000	CLEAVENGER LEONARD D
32	001	01-09-0009-0008-0002	CLEAVENGER LEONARD D
33	001	01-09-0009-0007-0000	CROUSE STEPHEN DALE & MICHAEL LYNN
34	001	01-09-0009-0006-0000	STEWART FARM LLC
36	001	01-09-0009-0004-0000	STEWART FARM LLC
39	001	01-09-0009-0001-0000	STEWART FARM LLC
40	001	01-09-0009-0020-0000	SEESE ROBERT & BRENDA HWS
44	001	01-09-0009-0017-0001	MADDIX MICHAEL R & JUDITH L
45	001	01-09-0009-0011-0000	SALTIS STEVE JR & AMY HWS
46	001	01-09-0009-0012-0000	SALTIS STEVE JR & AMY R HWS
47	001	01-09-0009-0013-0000	MURPHY GEORGE H JR & TAMELA J, HWS
48	001	01-09-0009-0022-0002	WOLFE MICHAEL B
60		RIGHT-OF-WAY	COUNTY ROUTE 1/6 BEAR MOUNTAIN ROAD
63		RIGHT-OF-WAY	GALLOWAY STATE ROUTE 76
49	001	01-09-0012-0004-0002	KNOTT'S TERRY & DONETTA
50	001	01-09-0012-0014-0000	MOSESJOHN A TRUST
61	001	01-09-0012-0004-0000	SWIGER ARGYLE C
191	001	01-09-0012-0004-0004	TINGLER RUSSEL J
192	001	01-09-012A-0095-0000	KITTLE FRANK G HRS ET AL
193	001	01-09-012A-0096-0000	BARTLETT MICHAEL ALLEN SR
54	001	01-09-012A-0091 thru 94 & 107	CRISS DAVID A
62	001	01-09-012A-0107-0001	DARR WILLIAM
190	001	01-09-012A-0090-0000	ELMOND MUREL L (L/E)
52	001	PLAN OF LOTS	CLEAVENGER PLATT
95	001	01-09-0012-0027-0000	WOLFE LARRY MICHAEL
42	001	01-09-0011-0001-0000	POLINO ENTERPRISES INC
53	001	01-09-0012-0004-0003	FARRIS VERNIE & RUSSELL JOSEPH, WROS
54	001	01-09-0012-0013-0001	FARRIS VERNIE L/E RUSSELL J&HOMER J FARRIS WS
57	001	01-09-0012-0011-0000	HENLINE EDWARD
59	001	01-09-0012-0004-0005	NEWMAN JERRY & JENNIFER WROS
111	001	PLAN OF LOTS	BEAR MOUNTAIN SUBDIVISION NO. 1
110	001	01-09-0012-0008-0000	GOFF ROBERT H III & TINA M HWS
109	001	01-09-0012-0009-0001	MYER JON E SR & ANTHONY (WS)
188	001	01-09-0012-0056-0000	MCCAULEY RONALD D
161	001	01-09-0012-0054-0001	MCCAULEY RONALD D
163		RIGHT-OF-WAY	COUNTY ROUTE 77/1 CAMP RUN ROAD
164	001	01-09-0022-0007-0000	WARE SHIRLEY LIVING TRUST
166	001	01-09-0012-0050-0000	MARTIN ROBERT E
167	001	01-09-0022-0009-0000	STREETS FRANKLIN D & BRENDA (WROS)
168	001	01-09-0012-0050-0004	MCCLINE CLAYTON & CHARLOTTE WS
107		RIGHT-OF-WAY	COUNTY ROUTE 7/2 STILLHOUSE RUN ROAD
158	001	01-09-0012-0050-0007	MIKE ROSS & WACO OIL & GAS CO
153	001	01-09-0012-0053-0000	MARTIN ROBERT E
105	001	01-09-0012-0051-0004	MONTGOMERY GEORGIA

RECEIVED  
Office of Oil & Gas  
JUL 05 2022

WV Department of  
Environmental Protection

REFERENCE NOTES  
1. Property lines as shown taken from deeds, tax maps, and field locations. A full boundary survey is not expressed or implied. All bearings are based on grid North. Ownership taken from public records for Taylor, Harrison, and Barbour County, West Virginia Date 2022.  
2. State Plane Coordinates & NAD83 Lat/Long by differential submeter mapping grade GPS.  
3. There are no railroads, dwellings, or agricultural buildings within 625 feet of center of pad.  
4. No water wells found within 250' of the center of well pad.

**LEGEND**

-----	PROPOSED WELL LATERAL
-----	PROPOSED WELL TIE LINE
-----	STREAM
-----	EXISTING ROAD
-----	BUFFER
-----	PROPERTY LINE
-----	MINERAL TRACT BOUNDARY
-----	COUNTY BOUNDARY LINE
⊙ #H	PROPOSED WELL HEAD
⊗	EXISTING WELL HEAD (Active)
⊕	EXISTING WELL HEAD (Plugged)
⊖	EXISTING WELL HEAD (Abandoned)
⊘	EXISTING WELL HEAD (Never Drilled)
□	EXISTING WELL HEAD (Future Drill)
○	LANDING POINT/BOTTOM HOLE
⊙	SURFACE OWNER

FILE#: 22078-001  
SHEET#: 2 of 2  
SCALE: 1" = 3000'  
TICK SCALE: 1" = 2000'  
MINIMUM DEGREE OF ACCURACY: 1/200  
PROVEN SOURCE OF ELEVATION: WV-RTN CORS STATION

I, THE UNDERSIGNED, HEREBY CERTIFY THAT THIS PLAT IS CORRECT TO THE BEST OF MY KNOWLEDGE AND BELIEF AND SHOWS ALL THE INFORMATION REQUIRED BY LAW AND THE REGULATIONS ISSUED AND PRESCRIBED BY THE DEPARTMENT OF ENVIRONMENTAL PROTECTION.  
Signed: Herbert L. Parsons, III 6-28-2022  
P.S. #2361: Herbert L. Parsons, III P.S.



(+) DENOTES LOCATION OF WELL ON UNITED STATES TOPOGRAPHIC MAPS  
WVDEP  
OFFICE OF OIL & GAS  
601 57TH STREET  
CHARLESTON, WV 25304



DATE: JUNE 28, 2022  
JOHNSON TFP-40  
OPERATOR'S WELL #: # 205  
API WELL #: 47 091 01370  
STATE COUNTY PERMIT

Well Type:  Oil  Waste Disposal  Production  Deep  
 Gas  Liquid Injection  Storage  Shallow  
WATERSHED: SIMPSON CREEK  
COUNTY / DISTRICT: TAYLOR CO. FLEMINGTON DISTRICT  
SURFACE OWNER: RENEE JOHNSON  
OIL & GAS ROYALTY OWNER: SEE WW-6A1

ELEVATION: 1,332.5'  
QUADRANGLE: ROSEMONT, WV  
ACREAGE: 284 ±  
ACREAGE: 284 ±

DRILL  CONVERT  DRILL DEEPER  REDRILL  FRACTURE OR STIMULATE  
 PLUG OFF FORMATION  PERFORATE NEW FORMATION  PLUG & ABANDON  
 CLEAN OUT & REPLUG  OTHER CHANGE SPECIFY: \_\_\_\_\_  
TARGET FORMATION: MARCELLUS ESTIMATED DEPTH: TVD: 7,903.5' TMD: 28,840.6'  
WELL OPERATOR: ARSENAL RESOURCES DESIGNATED AGENT: NATHAN SKEEN  
ADDRESS: 6031 WALLACE ROAD EXTENSION # 300 ADDRESS: 633 MAIN STREET  
CITY: WEXFORD STATE: PA ZIP: 15090 CITY: BRIDGEPORT STATE: WV ZIP: 26330