

REFERENCES

- a) S64°57'E 670' to REBAR
- b) S12°32'E 731' to 1/2" IRON PIPE

RESTAKING REFERENCES

- c) S66°23'E 253.5' to NW corner of barn
- d) S33°20'W 154.9' to a corner fence post

LATITUDE 39°00'00"

2500'

0.455
2.67W



7.5' QUAD. LOCATION

0.455
0.43W

LONGITUDE 79°27'30"
79°25'

NORTH

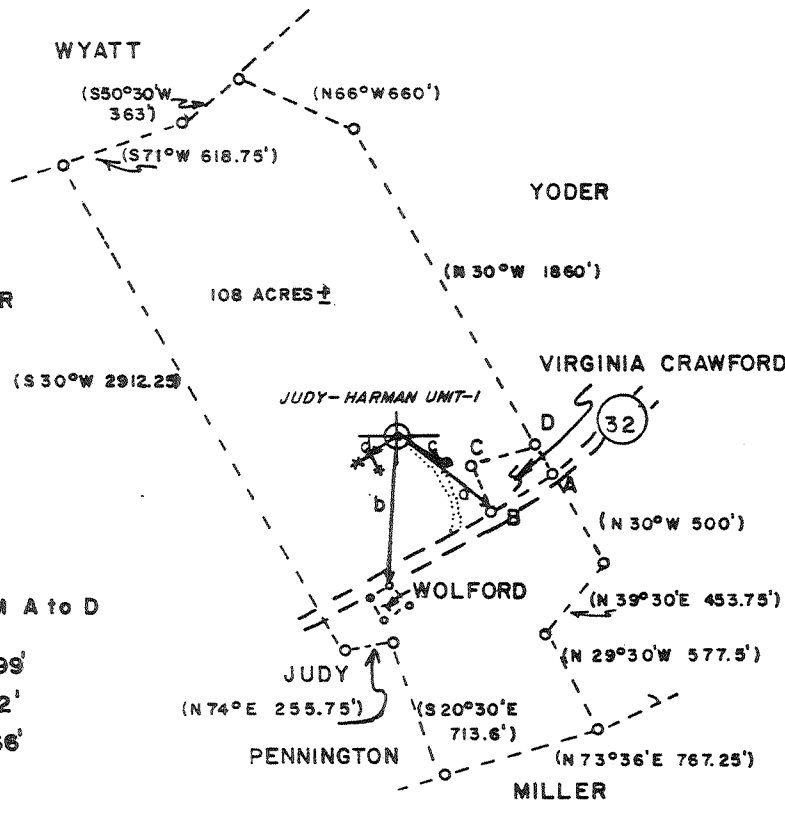

DEED CALLS FROM A to D

- A S53°47'W 347.99'
- B N24°49'W 299.2'
- C N76°26'E 341.66'
- D

(+) DENOTES LOCATION OF WELL ON UNITED STATES TOPOGRAPHIC MAPS

FILE NO. _____
 DRAWING NO. _____
 SCALE 1"=1000'
 MINIMUM DEGREE OF ACCURACY 1:200
 PROVEN SOURCE OF ELEVATION BM 2353

I THE UNDERSIGNED, HEREBY CERTIFY THAT THIS PLAT IS CORRECT TO THE BEST OF MY KNOWLEDGE AND BELIEF AND SHOWS ALL THE INFORMATION REQUIRED BY LAW AND THE REGULATIONS ISSUED AND PRESCRIBED BY THE DEPARTMENT OF MINES.
 (SIGNED) Harold K. Gainer, Jr.
 R.P.E. _____ L.L.S. 606

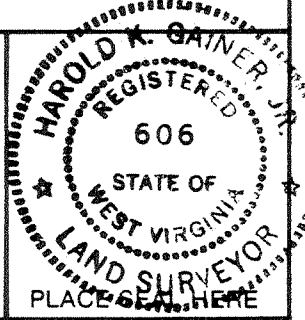

**STATE OF WEST VIRGINIA
 DEPARTMENT OF MINES
 OIL AND GAS DIVISION**



DATE 8/2, 1984
 OPERATOR'S WELL NO. JUDY-HARMAN UNIT-1
 API WELL NO. _____

WELL TYPE: OIL ___ GAS X LIQUID INJECTION ___ WASTE DISPOSAL ___
 (IF "GAS,") PRODUCTION ___ STORAGE ___ DEEP X SHALLOW ___

LOCATION: ELEVATION 2920 WATERSHED RED CREEK
 DISTRICT DRY FORK 4 COUNTY TUCKER
 QUADRANGLE LANESVILLE 427 Omega 094 NW1

SURFACE OWNER ADAM JUDY, JR., et. al ACREAGE 108
 OIL & GAS ROYALTY OWNER SAME LEASE ACREAGE 108

LEASE NO. _____
 PROPOSED WORK: DRILL X CONVERT ___ DRILL DEEPER ___ REDRILL ___ FRACTURE OR STIMULATE ___ PLUG OFF OLD FORMATION ___ PERFORATE NEW FORMATION ___ OTHER PHYSICAL CHANGE IN WELL (SPECIFY) _____

PLUG AND ABANDON ___ CLEAN OUT AND REPLUG ___
 TARGET FORMATION ORISKANY ESTIMATED DEPTH 8200'
 WELL OPERATOR BEREA OIL & GAS CORP. DESIGNATED AGENT MARK SCHUMACHER
 ADDRESS 901 CHEMICAL BANK BLD. 69, DELEWARE AVE. ADDRESS ONE BEREA PLAZA
BUFFALO, NY 14202 BRIDGEPORT, WV 26330

OCT 09 1984

COUNTY NAME
 PERMIT

FORM IV-6 (8-78)
 HT HALL

DEEP WELL 5-5 unnamed (Tucker 35) 0



CONFIDENTIAL

IV-35
(Rev 8-81)

Date December 18, 1984
Operator's
Well No. Judy-Harman Unit #1
Farm Adam Judy, Jr.
API No. 47 - 093 - 0066

State of West Virginia
Department of Mines
Oil and Gas Division

WELL OPERATOR'S REPORT
OF
DRILLING, FRACTURING AND/OR STIMULATING, OR PHYSICAL CHANGE

WELL TYPE: Oil ___ / Gas x / Liquid Injection ___ / Waste Disposal ___ /
(If "Gas," Production x / Underground Storage ___ / Deep x / Shallow ___ /)

LOCATION: Elevation: 2920' ^K Watershed Red Creek
District: Dry Fork ² County Tucker Quadrangle Laneville 427

COMPANY Berea Oil & Gas Corp. 22-450
ADDRESS P. O. Box 299, Bridgeport, WV 26330
DESIGNATED AGENT Thomas E. Riley, P.E.
ADDRESS P. O. Box 299, Bridgeport, WV 26330
SURFACE OWNER Adam Judy, Jr. et al
ADDRESS Box 15, Dry Fork 26263
MINERAL RIGHTS OWNER Adam Judy, Jr. et al
ADDRESS Box 15, Dry Fork, 26263
OIL AND GAS INSPECTOR FOR THIS WORK Russell Beall
ADDRESS P.O. Box 160, Philippi, WV
PERMIT ISSUED 10-1-84
DRILLING COMMENCED 10-9-84
DRILLING COMPLETED 11-7-84
IF APPLICABLE: PLUGGING OF DRY HOLE ON CONTINUOUS PROGRESSION FROM DRILLING OR REWORKING. VERBAL PERMISSION OBTAINED ON _____

Casing & Tubing	Used in Drilling	Left in Well	Cement fill up Cu. ft.
Size 20-16 Cond.			
13 3/8" 13-10"	226'	215'	170 sks.
9 5/8	3024'	3014'	975 sks.
8 5/8			
7			
5 1/2			
4 1/2	8224'	8216'	425 sks.
3			
2 3/8"		7953'	----
Liners used			

GEOLOGICAL TARGET FORMATION Oriskany Depth 8160' feet
Depth of completed well 8224' feet Rotary X / Cable Tools _____
Water strata depth: Fresh 160' feet; Salt _____ feet
Coal seam depths: N/A Is coal being mined in the area? No

OPEN FLOW DATA
Producing formation Oriskany Pay zone depth See Well Treatment Details feet
Gas: Initial open flow none Mcf/d Oil: Initial open flow none Bbl/d
Final open flow 3.34 M Mcf/d Final open flow none Bbl/d
Test Date 12/2/84 Time of open flow between initial and final tests 72 hours
Static rock pressure 1500 psig (surface measurement) after 2 hours shut in
(If applicable due to multiple completion--)
Second producing formation _____ Pay zone depth _____ feet
Gas: Initial open flow _____ Mcf/d Oil: Initial open flow _____ Bbl/d
Final open flow _____ Mcf/d Oil: Final open flow _____ Bbl/d
Time of open flow between initial and final tests _____ hours
Static rock pressure _____ psig (surface measurement) after _____ hours shut in

(Continue on reverse side) APR 7 1985

DETAILS OF PERFORATED INTERVALS, FRACTURING OR STIMULATING, PHYSICAL CHANGE, ETC.

Perf. Oriskany 11/19/84

7976' - 7980' 4 holes
8034' - 8042' 8 holes
8046' - 8050 4 holes
8116' - 8120' 2 holes

Frac Oriskany 11/20/84

Formation broke @ 2400#. ISIP 3100# after 5 min. 2700#. Avg. pump rate 35 BPM @ 4700#. Used 90,000# 20/40 sand and 7,000 gal. HCL acid and 1140 BW.

WELL LOG

FORMATION	COLOR	HARD OR SOFT	TOP FEET	BOTTOM FEET	REMARKS Including indication of all fresh and salt water, coal, oil and gas
FROM DRILLERS LOG:					
KB - GL			0	10	
Soil			10	15	
Lime			15	150	
Sand & Shale			150	340	1 1/2" stream water @ 160'
R.R. & Shale			340	415	1/4" stream water @ 415'
Sand			415	550	
Sand & Shale			550	780	
Sand			780	810	
Sand & Shale			810	840	
Sand			840	1270	
Sand & Shale			1270	1500	
Sand			1500	1550	
Sand & Shale			1550	2320	
Br. Sand			2320	2360	
Sand & Shale			2360	2770	
Sand			2770	2960	
Sand & Shale			2960	3715	
Sand			3715	3740	
Sand & Shale			3740	7343	Gas Check @ 5197' - No Show
FROM CDL LOG:					
Tully L.S.			445	7337	7389
Shale				7389	7642
Marcellus			455	7642	7680
Onondaga			461	7680	7848
Hunterville Chert			463	7848	7887
Needmore Shale			465	7887	7910
Oriskany			475	7910	8138
Helderberg L.S.			485	8138	8210
LTD			8210'		
DTD			8224'		
		top		thickness	
from nearby wells					
Dorchester		237		?	
Hampshire		237		900	
Channing		1137		?	
Genesee		6937		400	

(Attach separate sheets as necessary)

Berea Oil & Gas Corp.

Well Operator

By: Thomas E. Riley, P.E., Manager of Engineering

Date: December 18, 1984

Note: Regulation 2.02(i) provides as follows:

"The term 'log' or 'well log' shall mean a systematic detailed geological record of all formations, including coal, encountered in the drilling of a well."



1) Date: August 7, 1984
 2) Operator's Well No. Judy/Harman Unit #1
 3) API Well No. 47 - 093 - 0066
 State County Permit

STATE OF WEST VIRGINIA
 DEPARTMENT OF MINES, OIL AND GAS DIVISION
 APPLICATION FOR A WELL WORK PERMIT

- 4) WELL TYPE: A Oil / Gas X /
 B (If "Gas", Production X / Underground storage / Deep X / Shallow)
- 5) LOCATION: Elevation: 2920' Watershed: Red Creek
 District: Dry Fork County: Tucker Quadrangle: Lanesville
- 6) WELL OPERATOR Berea Oil & Gas Corp. 7) DESIGNATED AGENT Mark Schumacher
 Address P.O. Box 569 Address P.O. Box 299
Dover, OH 44622 Bridgeport, WV 26330
- 8) OIL & GAS INSPECTOR TO BE NOTIFIED 9) DRILLING CONTRACTOR:
 Name Russell Beall Name
 Address Phone: (304)866-4608 Address
- 10) PROPOSED WELL WORK: Drill X / Drill deeper / Redrill / Stimulate
 Plug off old formation / Perforate new formation
 Other physical change in well (specify)
- 11) GEOLOGICAL TARGET FORMATION, Oriskany
- 12) Estimated depth of completed well, 8160 feet
- 13) Approximate strata depths: Fresh, 100 feet; salt, 2700 feet.
- 14) Approximate coal seam depths: N/A Is coal being mined in the area? Yes / No X

RECEIVED
 AUG 27 1984

OIL & GAS DIVISION
 DEPT. OF MINES

15) CASING AND TUBING PROGRAM

CASING OR TUBING TYPE	SPECIFICATIONS					FOOTAGE INTERVALS		CEMENT FILL-UP OR SACKS (Cubic feet)	PACKERS	
	Size	Grade	Weight per ft.	New	Used	For drilling	Left in well		Kinds	by Rule
Conductor	13 3/8	J55	48#	X		200'	200'	to surface	Kinds	by Rule 15.05
Fresh water	9 5/8	N80	36#	X		2650'	2650'	CTS		
Coal									Sizes	
Intermediate										
Production	4 1/2	N80	11.6#	X		8100'		1000' Fillup	Depths set	Or U.S. Reg. by Rule 15.01
Tubing									Perforations:	
Liners									Top	Bottom

OFFICE USE ONLY
 DRILLING PERMIT

Permit number 47-093-0066

October 1, 19 84
 Date

This permit covering the well operator and well location shown below is evidence of permission granted to drill in accordance with the pertinent legal requirements subject to the conditions contained herein and on the reverse hereof. Notification must be given to the District Oil and Gas Inspector. (Refer to No. 8) Prior to the construction of roads, locations and pits for any permitted work. In addition, the well operator or his contractor shall notify the proper district oil and gas inspector 24 hours before actual permitted work has commenced.)

The permitted work is as described in the Notice and Application, plat, and reclamation plan, subject to any modifications and conditions specified on the reverse hereof.

Permit expires October 1, 1986 unless well work is commenced prior to that date and prosecuted with due diligence.

Bond: <u>17</u> <u>BLANKET</u>	Agency <u>LD</u>	Plat: <u>MH</u>	Casing <u>MH</u>	Fee <u>33174</u>
-----------------------------------	------------------	-----------------	------------------	------------------

Margaret J. Hesse
 Administrator, Office of Oil and Gas

NOTE: Keep one copy of this permit posted at the drilling location.

See the reverse side of the APPLICANT'S COPY for instructions to the well operator.

File