

LATITUDE

39° 27' 30"

OGIS
7.5' loc

LONGITUDE
95° 45' 08"

LONGITUDE

7.5 OGIS topo location

| | | | |
|----------|---------------|---------|---------------|
| 7.5' loc | <u>0.51 S</u> | 15' loc | <u>3.39 S</u> |
| | <u>0.17 W</u> | (calc.) | <u>2.40 W</u> |

Company _____

Farm _____

Quad ^{7.5'} Middlebourne (West Union)

County Tyler NW

District Meade

WELL LOCATION MAP

File No. 095-52

0 1 2 3

Latitude $86^{\circ} 45'$
 $39^{\circ} 30'$

$85^{\circ} 50'$
 $89^{\circ} 50'$

Longitude

1
2
3

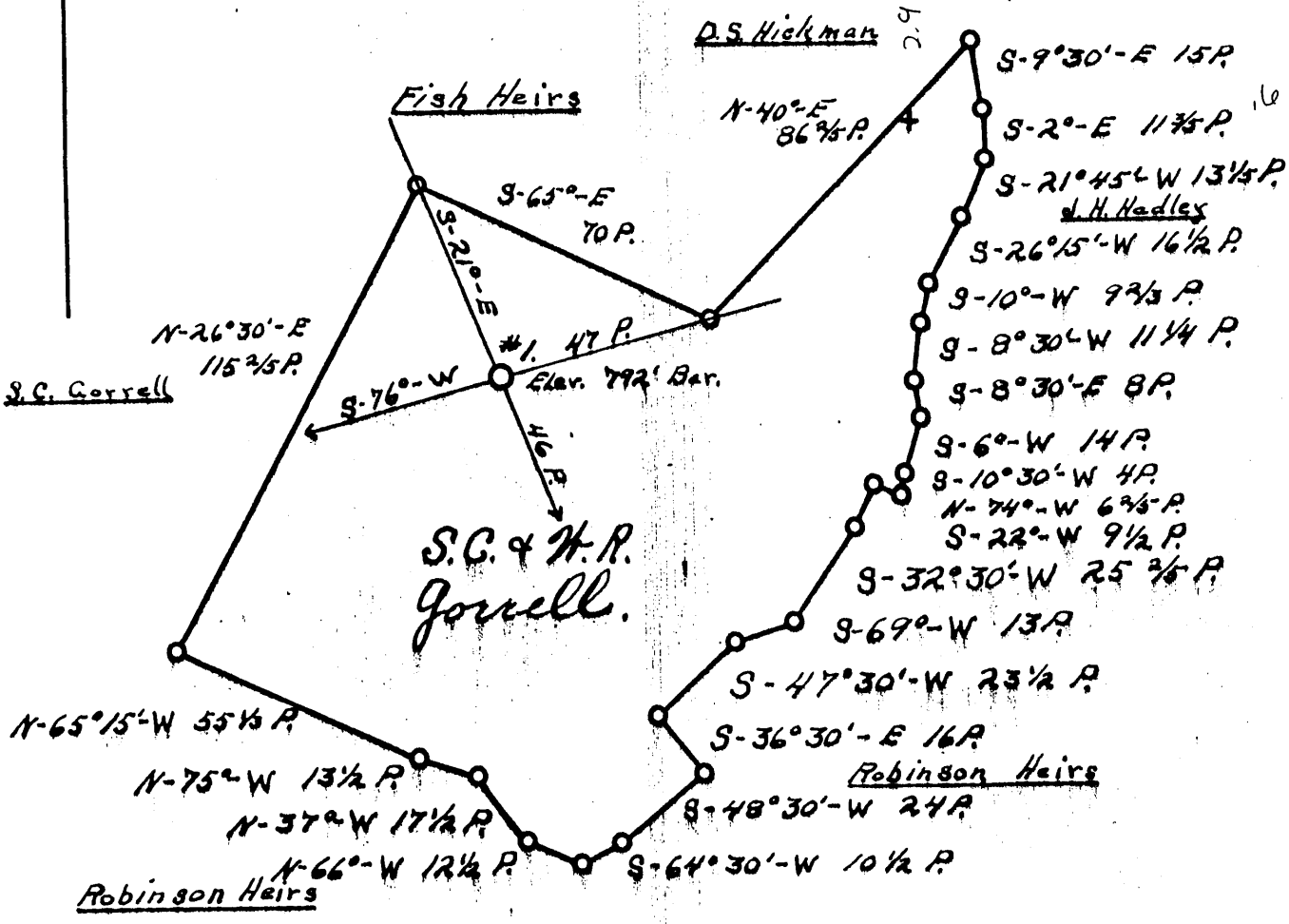

Company American Oil Development Co.
 Address Sistersville W. Va.
 Farm S.C. & H.R. Gorrell
 Tract _____ Acres 100 Lease No. _____
 Well (Farm) No. ONE Serial No. _____
 Quadrangle West Union N.H.
 County Tyler
 District Meade
 Engineer J.S. Haught
 Engineer's Registration No. County Surveyor, Tyler Co.
 File No. _____ Drawing No. _____
 Date Aug 12th 1936 Scale 1" = 40 rds.

STATE OF WEST VIRGINIA
 DEPARTMENT OF MINES
 OIL AND GAS DIVISION
 CHARLESTON

WELL LOCATION MAP
 FILE NO. TYL-52

+ Denotes location of well on United States Topographic Maps, scale 1 to 62,500, latitude and longitude lines being represented by border lines as shown.

- Denotes one inch spaces on border line of original tracing.

WEST VIRGINIA DEPARTMENT OF MINES

OIL AND GAS DIVISION

PRELIMINARY DATA SHEET NO. 1

File No. Tyl-52

Well No. 1

American Oil Development Company of Sistersville, W. Va.

S.C. & W.R. Gorrell

on the _____ Farm

containing 100 acres. Location _____

Meade District, in Tyler County, West Virginia

S. C. & W. R. Gorrell

The surface of the above tract is owned in fee by S.C. Gorrell, Middlebourne, W. Va.

of W.R. Gorrell, R.F.D., Friendly, W. Va. address, and the mineral rights are owned by

same. of _____

The oil and gas privileges are held under lease by the above named company, and this well is drilled under permit No. Tyl-52 issued by the West Virginia Department of Mines, Oil and Gas Division

August 28, 1936

Elevation of surface at top of well, 792' Surface Barometric.

The number of feet of the different sized casings used in the well.

_____ feet _____ size. Wood conductor.

420 feet 10" size, csg. 1020 feet 8-1/4" sized csg.

1415 feet 6-5/8" size, csg. _____ feet _____ sized csg.

_____ feet _____ size, csg. _____ feet _____ sized csg.

_____ packer of _____ size, set at _____

_____ packer of _____ size, set at _____

_____, in casing perforated at _____ feet to _____ feet.

_____, in casing perforated at _____ feet to _____ feet.

Coal was encountered at _____ feet, thickness _____ inches, and at _____

feet; thickness _____ inches; and at _____ feet; thickness _____ inches.

Liners were used as follows: (Give details) _____

Nov. 17, 1936.

Date.

American Oil Development Company

Approved _____ Owner.

By Walter A. Hays, Asst. Supt. (TITLE)

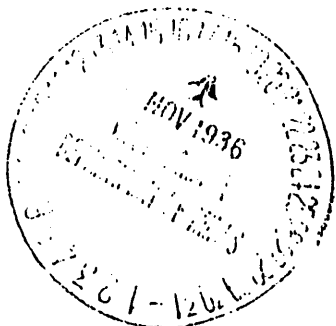

American Oil Development Company

OIL OR GAS WELL Gas Well

.....Company
Sistersville, W. Va.

COMPLETION DATA SHEET

NO. 2

FORMATION RECORD

.....Address
WELL NO. 1 Tyl-52 FARM J.C. & W.R. Gorrell

| Name | Color | Character | Oil, Gas or Water | Top | Bottom | Thickness | Total Depth | Remarks |
|-----------------------|-------|-----------|-------------------|-------|--------|-----------|-------------|---------|
| Sand | | | | 1000' | 1150' | 150' | | |
| Salt Sand | | | | 1275' | 1330' | 55' | | |
| Maxon Sand | | | | 1540' | | | | |
| Salt | | | Gas 1546-47 | | | 1' | | |
| | | | " 1560-62 | | | 2' | | |
| | | | | | | | 1590' | |

Well was not shot atfeet; well was shot atfeet.

Salt Fresh water atfeet; salt fresh water atfeet.

producing Well was hole.

Nov. 17, 1936 Date

American Oil Development Company
Approved Halter H. Bays Asst. Supt.
Owner

NOTE: All bottom formations must be noted as indicated above and all key-rocks and oil and gas sands must be recorded under their proper geological names in the district as well as any local names commonly used in the district for such strata.

