

100

Latitude 39° 30'

0.21 S
222 W

Hickory Nancy Michaels.

U. H. Mrs. Ginnis

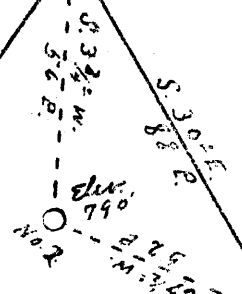

W.O.

stone & R.O.

Earl Stephens.

J. M. & Burl Baker.

N. 34° E. 222 P.

Barell's Run Road

J. W. & Agnes Baker.
175 acres.

S. 54° E. 81 P.

Maple

Buck

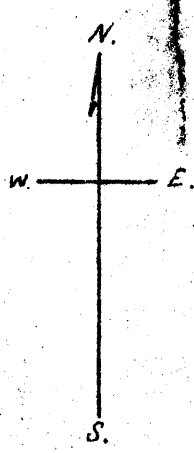

Rosco Mc Cullough.

Rosco Mc Cullough.

- New Location...
- Drill Deeper...
- Abandonment...

STATE OF WEST VIRGINIA
DEPARTMENT OF MINES
OIL AND GAS DIVISION
CHARLESTON

WELL LOCATION MAP
FILE NO. JYL-199

+ Denotes location of well on United States Topographic Maps, scale 1 to 62,500, latitude and longitude lines being represented by border lines as shown.

- Denotes one inch spaces on border line of original tracing.

Company Morgan Petroleum Corp.
 Address Akron Ohio
 Farm J. W. & Agnes Baker
 Tract _____ Acres 175 Lease No. _____
 Well (Farm) No. 2 Serial No. _____
 Elevation (Spirit Level) 790'
 Quadrangle West Union
 County Tyler District Ellsworth
 Engineer Robert R. Anderson
 By J. M. Triplett, Surveyor
 Engineer's Registration No. 296
 File No. _____ Drawing No. _____
 Date May 8 1951 Scale 1" = 40 P.

IMPERIAL TRADING CO. INC. K & E CO., N. Y.

5-0-0

J. W. AND AGNES BAUER NO. 2 WELL.

Ellsworth District, Tyler County, W. Va.

By Morgan Petroleum Corp., 109 E. Union St., Akron, Ohio.

Drilled under permit 7yl-199.

On 175 acres, on W side of Carroll Run.

Elevation, 750' L.

Located 0.22 mi. E. of 39° 30' and 2.27 mi. W. of 80° 50' - NE - West
Union Quadrangle.

Completed April 21, 1951.

Dry hole. Note from John R. Bean, Secy., MFC, Jan. 27, 1952.

	Top.	Bottom.
Total depth (through Big Injun Sand)		1750

Filled back to 1740' with cement and crushed stone, lead plug at 1740';
cement, 1740 to 1725'; crushed stone, 1725 to 1707'. Pocket shot,
1707 to 1687', with 20 qts. Fox head shot from 1687 to 1674' with
30 qts. nitroglycerine. Shot tamped with slag and pea gravel.