

6-6-90

6350

LATITUDE 39° 32' 30"

LONGITUDE 80° 50' 00"

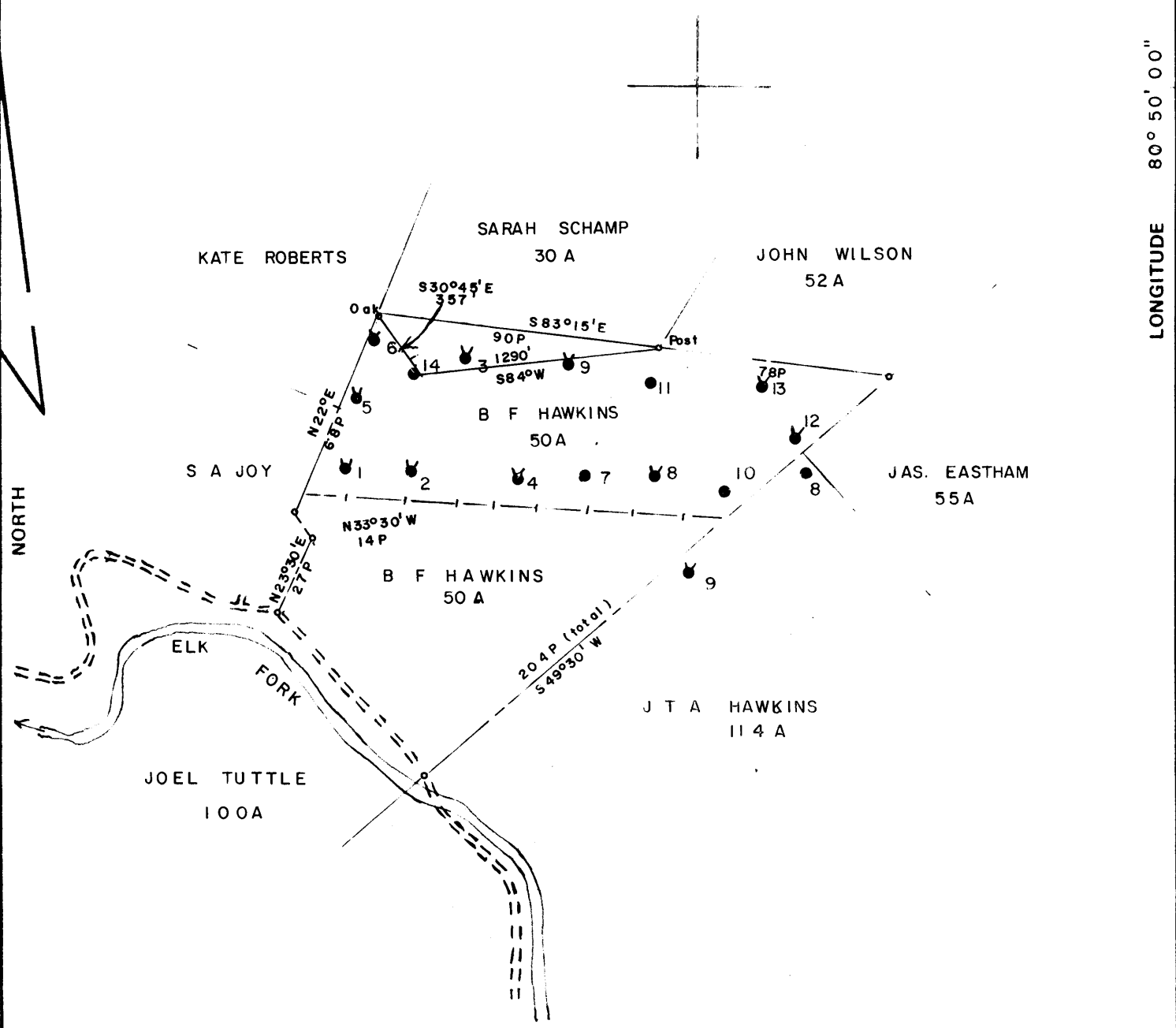

FILE NO. \_\_\_\_\_  
 DRAWING NO. \_\_\_\_\_  
 SCALE 1" = 800'  
 MINIMUM DEGREE OF ACCURACY 1 in 200  
 PROVEN SOURCE OF ELEVATION PENNZOIL CO. RECORDS

I THE UNDERSIGNED, HEREBY CERTIFY THAT THIS PLAT IS CORRECT TO THE BEST OF MY KNOWLEDGE AND BELIEF AND SHOWS ALL THE INFORMATION REQUIRED BY LAW AND THE REGULATIONS ISSUED AND PRESCRIBED BY THE DEPARTMENT OF MINES.  
 (SIGNED) Richard Ferrell  
 R.P.E. \_\_\_\_\_ L.L.S. 275

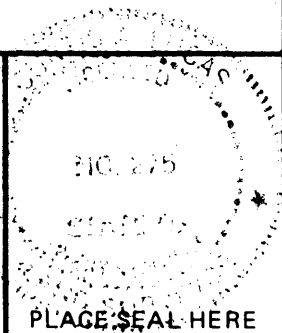

**STATE OF WEST VIRGINIA**  
 DEPARTMENT OF MINES  
 OIL AND GAS DIVISION

(+) DENOTES LOCATION OF WELL ON UNITED STATES TOPOGRAPHIC MAPS  
 WELL TYPE: OIL \_\_\_ GAS \_\_\_ LIQUID INJECTION \_\_\_ WASTE DISPOSAL \_\_\_  
 (IF "GAS,") PRODUCTION \_\_\_ STORAGE \_\_\_ DEEP \_\_\_ SHALLOW \_\_\_  
 LOCATION: ELEVATION 843 WATERSHED ELK FORK  
 DISTRICT ELLSWORTH COUNTY TYLER  
 QUADRANGLE PORTERS FALLS  
 SURFACE OWNER STANLEY LEMASTERS ACREAGE 50  
 OIL & GAS ROYALTY OWNER \_\_\_\_\_ LEASE ACREAGE 50  
 LEASE NO. \_\_\_\_\_  
 PROPOSED WORK: DRILL \_\_\_ CONVERT \_\_\_ DRILL DEEPER \_\_\_ REDRILL \_\_\_ FRACTURE OR STIMULATE \_\_\_ PLUG OFF OLD FORMATION \_\_\_ PERFORATE NEW FORMATION \_\_\_ OTHER PHYSICAL CHANGE IN WELL (SPECIFY) \_\_\_\_\_  
 PLUG AND ABANDON \_\_\_ CLEAN OUT AND REPLUG \_\_\_  
 TARGET FORMATION BLG INJUN ESTIMATED DEPTH 1800'  
 WELL OPERATOR S.MOKERISE PRODUCING CO DESIGNATED AGENT RICHARD FERRELL  
 ADDRESS 412 3rd STREET ADDRESS RT 1, BOX 211B  
MARIETTA OHIO MIDDLEBOURNE WV 26149

DATE MAY 16, 19 90  
 OPERATOR'S WELL NO. B F HAWKINS 14  
 API WELL NO. \_\_\_\_\_  
47 - 95 - 0269 LI  
 STATE COUNTY PERMIT  
 (30) JUN 11 1990

FORM IV-6 (8-78) H. T. HALL

Latitude 39° 35' 39°32'30"

Longitude 80° 50'

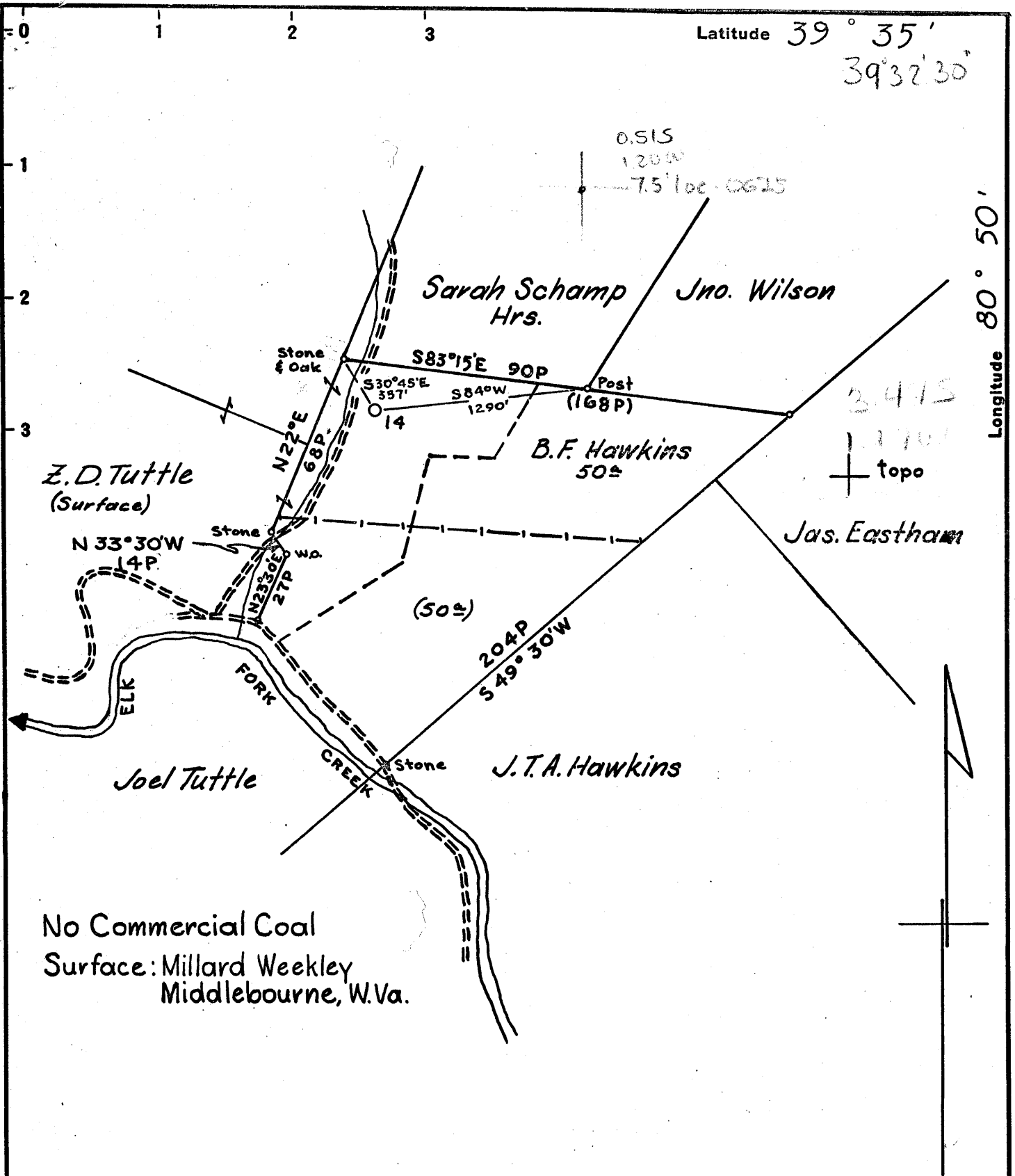

New Location...  
 Drill Deeper.....  
 Abandonment.....

Map N56 N7 W13

Company South Penn Natural Gas Co.  
 Address Parkersburg, W.Va.  
 Farm B.F. Hawkins  
 Tract \_\_\_\_\_ Acres 50 Lease No. 81331  
 Well (Farm) No. 14 Serial No. \_\_\_\_\_  
 Elevation (Spirit Level) 843.32 Porters Falls 7.5'  
 Quadrangle New Martinsville - SC  
 County Tyler District Ellsworth  
 Engineer A.C. Hilbert  
 Engineer's Registration No. 2534  
 File No. \_\_\_\_\_ Drawing No. \_\_\_\_\_  
 Date Mar. 20, 1958 Scale 1"=800'

STATE OF WEST VIRGINIA  
 DEPARTMENT OF MINES  
 OIL AND GAS DIVISION  
 CHARLESTON

WELL LOCATION MAP  
 FILE NO. JYL-269

+ Denotes location of well on United States Topographic Maps, scale 1 to 62,500, latitude and longitude lines being represented by border lines as shown.  
 - Denotes one inch spaces on border line of original tracing.

"IMPERIAL" TRACING CLOTH



STATE OF WEST VIRGINIA  
DEPARTMENT OF MINES  
OIL AND GAS DIVISION 22

*Quad - New Martinsville*

WELL RECORD

Permit No. TYL-269

Oil or Gas Well Oil  
(KIND)

Company South Penn Natural Gas Company  
Address P.O. Box 1280 - Parkersburg, W. Va.  
Farm B. F. Hawkins Acres 50  
Location (waters) Elk Fork Creek  
Well No. 14 Elev. 843.32 ft.  
District Ellsworth County Tyler  
The surface of tract is owned in fee by Millard Weekley  
Address Middlebourne, W. Va.  
Mineral rights are owned by Union National Bank, Atty  
for S. A. Smith Address Clarksburg, W. Va.  
Drilling commenced June 4, 1958  
Drilling completed June 27, 1958  
Date Shot ----- From ----- To -----  
With -----

Casing and Tubing	Used in Drilling	Left in Well	Packers
Size			Kind of Packer
16			<u>Steel Shoe</u>
18			Size of <u>7"</u>
10-3/4	<u>242</u>	<u>82</u>	Depth set <u>1675</u>
<del>8-5/8</del>	<u>969</u>	<u>None</u>	
<del>7</del>	<u>1675</u>	<u>1675</u>	
5 3/16			Perf. top
8			Perf. bottom
2			Perf. top
Liners Used			Perf. bottom

Open Flow /10ths Water in ----- Inch  
/10ths Merc. in ----- Inch  
Volume 11,982 Cu. Ft.  
Rock Pressure ----- lbs. ----- hrs.  
Oil 3 bbls., 1st 24 hrs.  
Fresh water 70 feet 125 - 130 feet  
Salt water 1420 feet

CASING CEMENTED ----- SIZE ----- No. Ft. ----- Date -----  
COAL WAS ENCOUNTERED AT 58-60 FEET ----- INCHES  
----- FEET ----- INCHES ----- FEET ----- INCHES  
----- FEET ----- INCHES ----- FEET ----- INCHES

Fermentation	Color	Hard or Soft	Top	Bottom	Oil, Gas or Water	Depth Found	Remarks
Clay			0	14			
Stone			14	19			
Red Rock			19	32			
Slate (Gray)			32	45			
Shale (Blk.)			45	58			
Coal			58	60			
Shale (Blue)			60	73			
Red Rock			73	85	Water	70	
Lime			85	94			
Red Rock			94	103			
Lime			103	110			
Shale (Blue)			110	125			
Red Rock			125	135	Water	125 - 130	
Shale (Blue)			135	145			
Red Rock			145	155			
Shale			155	165			
Red Rock			165	170			
Lime			170	185			
Shale			185	200			
Red Rock			200	208			
Shale (Dark)			208	215			
Red Rock			215	225			
Shale (Blue)			225	245			
Lime			245	255			
Sand			255	275			
Shale			275	280			
Red Rock			280	285			
Lime			285	302			
Red Rock			302	307			
Shale			307	314			
Lime			314	365			
Shale			365	375			
Sand			375	415			
Shale			415	422			
Sand			422	450			
Red Rock			450	457			
Shale			457	500			



Formation	Color	Hard or Soft	Top <sup>11</sup>	Bottom	Oil, Gas or Water	Depth Found	Remarks
Lime			500	520			
Shale			520	550			
Lime			550	563			
Shale			590	610			
Red Rock			610	615			
Shale			615	625			
Sand			625	642			
Shale			642	665			
Red Rock			665	710			
Shale			710	720			
Red Rock			720	730			
Shale			730	790			
Lime			790	810			
Shale & Lime			810	855			
Red Rock			855	857			
Shale & Lime			857	958			
Sand			958	1000			
Shale			1000	1016			
Sand			1016	1102			
Shale			1102	1131			
Sand			1131	1181			
Shale			1181	1205	Oil Show	1150	
Sand			1205	1295			
Shale			1295	1305			
Sand			1305	1380			
Shale			1380	1387			
Sand			1387	1420	Salt Water	1420	
Shale			1420	1450			
Sand			1450	1480			
Shale			1480	1495			
Lime			1495	1525			
Sand			1525	1542			
Shale			1542	1560			
Lime			1560	1575	1656		
Shale			1575	1584	843		
Lime			1584	1595	813		
Shale			1595	1601			
Little Lime			1601	1630			
Shale			1630	1644			
Lime			1644	1651			
Shale			1651	1656			
Big Lime			1656	1707			
Keener Sand			1707	1756			
Injun Sand			1756	1800	Oil & Gas Show Gas	1730 1734	
					Oil, Gas, and Water	1793 - 1794	
					Water	1794 - 1800	
Total Depth				1800			

Date August 18, 19 58

APPROVED South Penn Natural Gas Company, Owner

By George W. Milman (Title) Land Agent



WR-35 RECEIVED SEP 18 1989

DIVISION OF OIL & GAS DEPARTMENT OF ENERGY

State of West Virginia DEPARTMENT OF ENERGY Oil and Gas Division

Date 9/10/89 Operator's Well No. 14 Farm B.F. HAWKINS API No.

WELL OPERATOR'S REPORT OF DRILLING, FRACTURING AND/OR STIMULATING, OR PHYSICAL CHANGE

WELL TYPE: Oil / Gas / Liquid Injection X / Waste Disposal / (If "Gas," Production / Underground Storage / Deep / Shallow /)

LOCATION: Elevation: Watershed ELK FORK District: Pilsbrough County Tyler Quadrangle

COMPANY SMOKE RISE PRODUCING CO, ADDRESS 410 2nd ST. MARIETTA, OHIO DESIGNATED AGENT Richard FERRALL ADDRESS RT. 1 MIDDLEBOURNE, W.VA. SURFACE OWNER MILLARD WEAKLEY ADDRESS RT. 1 MIDDLEBOURNE, W.VA. MINERAL RIGHTS OWNER MILLARD WEAKLEY ADDRESS RT. 1 MIDDLEBOURNE, W.VA. OIL AND GAS INSPECTOR FOR THIS WORK ADDRESS

Table with 4 columns: Casing & Tubing, Used in Drilling, Left in Well, Cement fill up Cu. ft. Rows include sizes 20-16 Cond., 13-10", 9 5/8, 8 5/8, 7, 5 1/2, 4 1/2, 3, 2, and Liners used.

PERMIT ISSUED DRILLING COMMENCED June 4, 1958 DRILLING COMPLETED June 27, 1958 IF APPLICABLE: PLUGGING OF DRY HOLE ON CONTINUOUS PROGRESSION FROM DRILLING OR REWORKING. VERBAL PERMISSION OBTAINED ON

GEOLOGICAL TARGET FORMATION KEENER Depth 1707 feet Depth of completed well 1800 feet Rotary / Cable Tools X Water strata depth: Fresh 70, 125 feet; Salt 1793 feet Coal seam depths: 58'-60' Is coal being mined in the area? No

OPEN FLOW DATA Producing formation INTJUN Pay zone depth 1793 feet Gas: Initial open flow 11 Mcf/d Oil: Initial open flow 3 Bbl/d Final open flow Mcf/d Final open flow Bbl/d Time of open flow between initial and final tests hours Static rock pressure psig (surface measurement) after hours shut in (If applicable due to multiple completion--)

Lease No. 81331

Acres 50

Farm Name B. F. Hawkins (50a)

Well No. 14

N. 7 S. E. W. 13

Location Made March 20, 1958 Purchased From

Civil District Ellsworth

Rig Completed Drilled w/ Spudder Date Purchased

County Tyler

Dr'g Commenced June 14, 1958 Sold to

State West Virginia

Dr'g Completed June 27, 1958 Date Sold

GAS RIGHTS OWNED BY

Dr'g Contractor Rawe Drilling Co. Date Abandoned

FORMATION				CASING RECORD					
Kind	Top	Bottom	Steel Line Meas.	Tests	Size	Bottom Casing Steel Line	Put in Well Tally Meas.	Pulled Tally Meas.	Cemented
Stone	14	19			10 3/4		242	160	Date
Coal	58	60			8 5/8	969		969	Size Csg.
					7" OD				Top Csg.
Water		70		1 bailer/hr.	8 rd thd. R 1, 20#	J-55	1675 STM.		Bot. Csg.
Water	125	130		6- 13" Bailers per hour					

PACKERS AND SHOES			
Kind	Size	Depth Set	Date Set
Little Lime	1601	1630	Show of Oil at 1150'
Big Lime	1656	1707	
Keener Sand	1707	1756	1 1/2 Bailers Salt Water per hr at 1420'

TORPEDO RECORD					
Date	No. Qts.	Size Shell	Top Shot	Bottom	Results
Oil, Gas, and Water	1793	1794			Show of Oil & Gas at 1730'
Hole Full of Water	1794	1800			8,142 Cu. Ft. Gas at 1734'
TOTAL DEPTH		1800	1800		

Initial Prod.	Sand	* At Completion	* 30 Days After	*
Oil	Injun	3 Bbls. Oil;	15 Bbls. Water	
Gas		11,982 Cu. Ft.	1793-1794, Blowed Down	

APPROVED

\* Oil in Barrels  
\* Gas in M. Cu. Ft.

TESTS, REPORTS AND REMARKS ON REVERSE SIDE

Supt.

JUN 11 1990

