

Fracture
 New Location
 Drill Deeper
 Abandonment

Company McCombs, Conrad & Bennett
~~GANNON OIL COMPANY~~
 Address P.O. Box 88, New Concord, Ohio 43762
~~137 MADISON AVE. NEW YORK NY~~

Farm EVA ICE

Tract _____ Acres 31 Lease No. _____

Well (Farm) No. ONE Serial No. _____

Elevation (Spirit Level) 792

Quadrangle NEW MARTINSVILLE SC

County TYLER District LINCOLN

Engineer G. L. MCINTIRE

Engineer's Registration No. 1187

File No. _____ Drawing No. _____

Date 10-25-60 Scale 1" = 400'

STATE OF WEST VIRGINIA
 DEPARTMENT OF MINES
 OIL AND GAS DIVISION
 CHARLESTON

WELL LOCATION MAP
 FILE NO. TYL-302-FRAC W
302

+ Denotes location of well on United States Topographic Maps, scale 1 to 62,500, latitude and longitude lines being represented by border lines as shown.

- Denotes one inch spaces on border line of original tracing.

Willow Fork (29) 47095

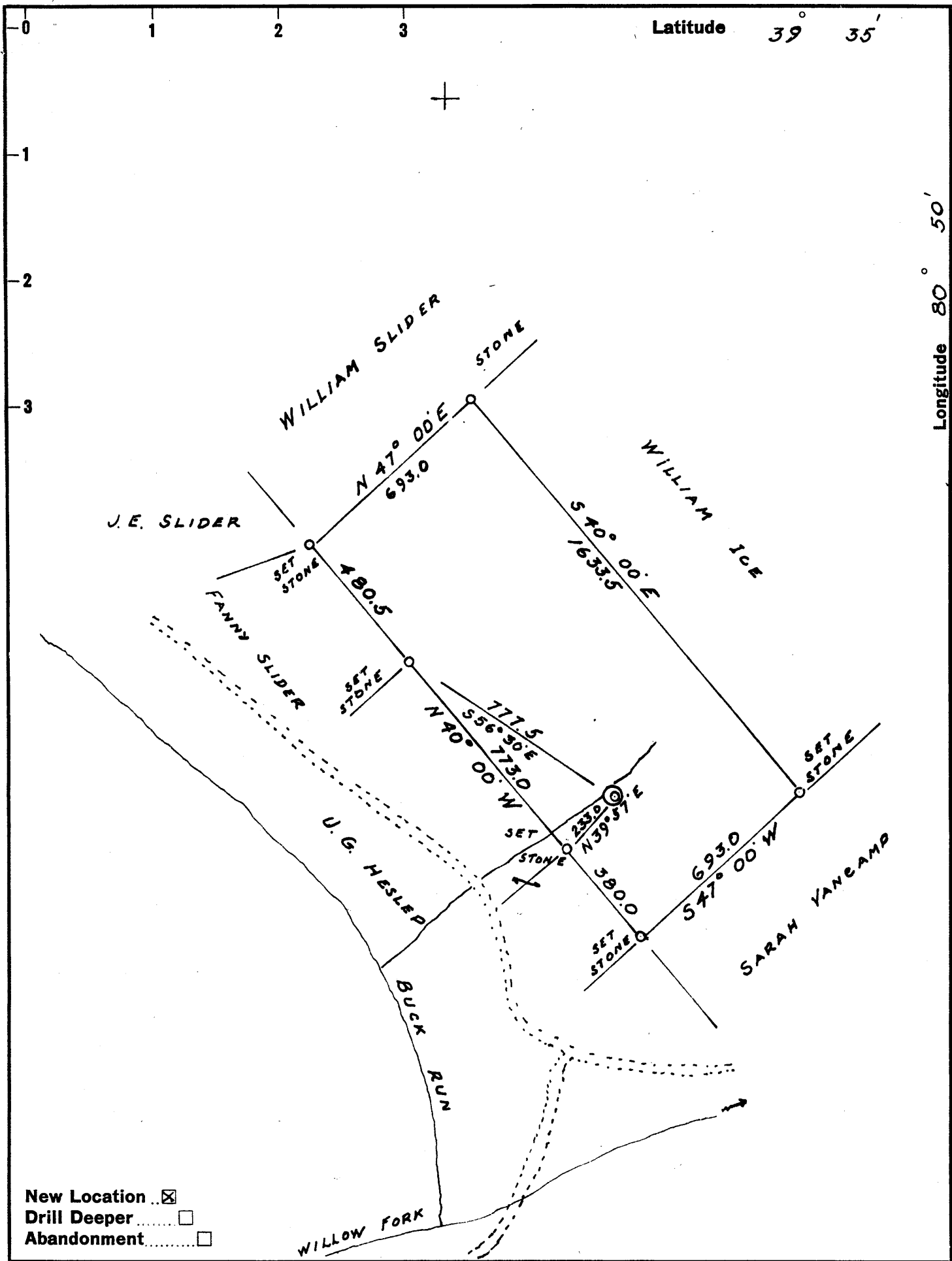

Company CANNON OIL COMPANY

Address 439 MADISON AVE. NEW YORK NY

Farm EVA ICE

Tract _____ Acres 31 Lease No. _____

Well (Farm) No. ONE Serial No. _____

Elevation (Spirit Level) 792

Quadrangle NEW MARTINSVILLE SC

County TYLER District LINCOLN

Engineer G. L. MCINTIRE

Engineer's Registration No. 1187

File No. _____ Drawing No. _____

Date 10-25-60 Scale 1" = 400'

STATE OF WEST VIRGINIA
DEPARTMENT OF MINES
OIL AND GAS DIVISION
CHARLESTON

WELL LOCATION MAP
FILE NO. TYL-302

+ Denotes location of well on United States Topographic Maps, scale 1 to 62,500, latitude and longitude lines being represented by border lines as shown.

- Denotes one inch spaces on border line of original tracing.

2-1-46
 8-1
 (7)



RECEIVED
 APR 1 1974

OIL & GAS DIVISION
 DEPT. OF MINES

STATE OF WEST VIRGINIA
 DEPARTMENT OF MINES
 OIL AND GAS WELLS DIVISION

- Spudder
- Cable Tools
- Storage

Quadrangle New Martinsville
~~Paden City~~

Permit No. TYL-302-FRAC W

WELL RECORD

Oil or Gas Well GAS (KIND)

Company <u>McCombs-Conrad & Barrett</u>	Casing and Tubing	Used in Drilling	Left in Well	Packers
Address <u>P. O. Box 88, New Concord, Ohio</u>	Size			Kind of Packer
Farm <u>Eva and Frank Ice</u> Acres <u>25</u>	16			Size of
Location (waters) <u>Small stream into Buck Run</u>	13			Depth set
Well No. <u>1</u> Elev. <u>792 Grn.</u>	10			Perf. top
District <u>Lincoln</u> County <u>Tyler</u>	8 1/4			Perf. bottom
The surface of tract is owned in fee by <u>Eva & Frank Ice</u>	6 3/8 7"	1125'	1125'	Perf. top
Rt. <u>1</u> Address <u>Sistersville, W. Va.</u>	5 3/16			Perf. bottom
Mineral rights are owned by <u>above</u>	4 1/2		3270'	
Workover Address <u>3/6/74</u>	3			
Workover commenced <u>3/13/74</u>	2 1 1/2"		2486	
Workover completed	Liners Used			
Date Shot <u>7/1/66</u> From <u>2210</u> To <u>2214</u> <u>Berea</u>				
With <u>2464</u> To <u>2469</u>				

Open Flow Perfs: /10ths Water in 2637 to 2642 Inch

Volume /10ths Merc. in 3178 to 3181 } Bayard Inch

Rock Pressure 3187 to 3190 Cu. Ft.

Attach copy of cementing record.

CASING CEMENTED	SIZE	No. Ft.	Date
Amount of cement used (bags)			
Name of Service Co.			

WELL ACIDIZED (DETAILS) FEET INCHES FEET INCHES

WELL FRACTURED (DETAILS) Set cast iron bridge plug at 2810'. Broke down with 1250 gals. acid. Frac with 650 bbls. water and 17,850 lbs. sand on 3/8/74

RESULT AFTER TREATMENT (Initial open Flow or bbls.) 30 MCF gas per day Treatment Report Attached

ROCK PRESSURE AFTER TREATMENT 700 psig HOURS

Fresh Water Feet Salt Water Feet

Producing Sand Berea, Gordon & Bayard Depth See perms. above

Formation	Color	Hard or Soft	Top	Bottom	Oil, Gas or Water	Depth	Remarks
<u>TYL-302</u>			Original permit issued during 1960 to Cannon Oil Co.				
TYL-398 DD			Permit issued during 1966 to Harvey L. Starr to drill deeper.				
			<u>2210-2214</u>	<u>Berea</u>		<u>2210</u>	
			<u>2464-2469</u>	<u>Gordon</u>		<u>792</u>	
			<u>2637-2642</u>	<u>5th?</u>	} new production	<u>1415</u>	
			<u>3178-81; 87-90</u>	<u>Bayard</u>			
			<u>Driller's T.D.</u>	<u>3274</u>			

PLEASE SUBMIT COPIES OF ALL GEOPHYSICAL LOGS DIRECTLY TO:

West Virginia Geological and Economic Survey
P. O. Box 379
Martinsburg, W. Va. 26105
AC 304-296-4461



STATE OF WEST VIRGINIA
DEPARTMENT OF MINES

RECEIVED

FEB 15 1974

OIL & GAS DIVISION
DEPT. OF MINES

Oil and Gas Division

OIL AND GAS WELL PERMIT APPLICATION

TO THE DEPARTMENT OF MINES,
Charleston, W. Va.

DATE February 12, 1974

Company McCombs-Conrad & Barrett

Address Box 88, New Concord, Ohio, 43762

Farm Eva Ice Acres 25

Location (waters) small stream into Buck Run

Well No. 1 Elevation 792 Gr.

District Lincoln County Tyler

Quadrangle Pader City

Surface Owner Eva and Frank Ice

Address Rt. 1, Sistersville, W. Va., 26175

Mineral Owner Eva and Frank Ice

Address same as above

Coal Owner none

Address _____

Coal Operator none

Address _____

* Original Permit No. Tyl-302, Cannon Oil Company; Plat dated 10/25/60. Copy of original plat attached. Well drilled deeper by Harvey L. Starr, Permit No. Tyl-398-DD during 1966.

INSPECTOR TO BE NOTIFIED P. Goodnight
Smithville, WV. PH: 477-2455

GENTLEMEN:

The undersigned well operator is entitled to drill upon the above named farm or tract of land for oil and gas, having fee title thereto, (or as the case may be) under ~~purchase~~ ^{assignment} dated May 21 19 73 by John and June Richmond made to McCombs-Conrad & Barrett and recorded on the 22 day of May 19 73, in Tyler County, Book 197 Page 451

_____ NEW WELL _____ DRILL DEEPER _____ REDRILL FRACTURE OR STIMULATE
 OIL AND GAS WELL ORIGINALLY DRILLED BEFORE JUNE 5, 1969.

The enclosed plat was prepared by a registered engineer or licensed land surveyor and all coal owners and/or operators have been notified as of the above date.

The above named coal owners and/or operator are hereby notified that any objection they wish to make, or are required to make by Section 3 of the Code, must be received by, or filed with the Department of Mines within ten (10) days. *

Copies of this notice and the enclosed plat were mailed by registered mail, or delivered to the above named coal operators or coal owners at their above shown respective address _____ day _____ before, or on the same day with the mailing or delivery of this copy to the Department of Mines at Charleston, West Virginia.

Very truly yours.

McCombs-Conrad & Barrett (Sign Name) Matthew Conrad
Well Operator

THIS PERMIT MUST BE POSTED AT THE WELL SITE

All provisions being in accordance with Chapter 22, ^{Address} of ^{of} the W. Va. Code, the location is hereby approved ^{Well Operator} for fracturing. This permit shall expire if operations have not commenced by 6-26-74

Robert A. Linder
Deputy Director - Oil & Gas Division

P. O. Box 88
Street
New Concord,
City or Town
Ohio 43762
State

National Grange Mutual Insurance Co.
Blanket Bond No. 5038443

*SECTION 3 If no objections are filed or found by the Department of mines, within the period of ten days from the receipt of notice and plat by the department of mines, to said proposed location, the department shall forthwith issue to the well operator a permit reciting the filing of such plat, that no objections have been made by the coal operators or found thereto by the department and that the same is approved and the well operator authorized to proceed.

*See Above Remarks

TYL-302-~~FAC~~ W PERMIT NUMBER

47 095

BLANKET BOND
Survey

THIS IS AN ESTIMATE ONLY
ACTUAL INFORMATION WILL BE SUBMITTED ON OG-10 UPON COMPLETION

PROPOSED WORK ORDER TO _____ DRILL _____ DEEPEN X FRACTURE-STIMULATE
 DRILLING CONTRACTOR: (If Known) _____ RESPONSIBLE AGENT: _____
 NAME _____ NAME William Metzner
 ADDRESS _____ ADDRESS 1216 Coff St., Wheeling, W. Va., 26001
 TELEPHONE _____ TELEPHONE 304-233-3519
~~XXXXXXXX~~ DEPTH OF COMPLETED WELL: 3285' Elec. Log ROTARY _____ CABLE TOOLS _____
 PROPOSED GEOLOGICAL FORMATION: Berea, Gordon, & Bayard
 TYPE OF WELL: OIL _____ GAS _____ COMB. X STORAGE _____ DISPOSAL _____
 RECYCLING _____ WATER FLOOD _____ OTHER _____

Temp. Cast Iron Bridge Plug to be set at 2720'
 TENTATIVE CASING PROGRAM:

CASING AND TUBING SIZE	USED FOR DRILLING	LIFT IN WELL	CEMENT FILL UP OR SACKS - CUBIC FT.
20 - 16			
13 - 10			
9 - 5/8			
8 - 5/8			
7	1125'	1125'	
5 1/2			
4 1/2 11.60#/ft.	---	3274 Drillers T. D.	
3			Perf. Top
2			Perf. Bottom
Liners			Perf. Top
			Perf. Bottom

APPROXIMATE FRESH WATER DEPTHS 32 FEET _____ SALT WATER _____ FEET _____
 APPROXIMATE COAL DEPTHS _____
 IS COAL BEING MINED IN THE AREA? No BY WHOM? _____

TO DRILL:

SUBMIT FIVE (5) COPIES OF OG - 1, \$100.00 PERMIT FEE, PERFORMANCE BOND AND PERMANENT COPY OF PLAT.

TO DRILL DEEPER OR REDRILL:

SUBMIT FIVE (5) COPIES OF OG - 1, SHOWING ORIGINAL PERMIT NUMBER AND PERFORMANCE BOND. ON WELLS DRILLED PRIOR TO 1929, A PERMANENT COPY OF THE PLAT AND THE ORIGINAL WELL RECORD MUST ALSO BE SUBMITTED.

TO FRACTURE - STIMULATE:

OIL AND/OR GAS WELL ORIGINALLY DRILLED BEFORE JUNE 5, 1929, FIVE (5) COPIES OG - 1, PERFORMANCE BOND, PERMANENT PLAT AND ORIGINAL WELL RECORD.

OIL AND/OR GAS WELL ORIGINALLY DRILLED ON AND/OR AFTER JUNE 5, 1929, FIVE COPIES OG - 1, SHOWING ORIGINAL PERMIT NUMBER, AND PERFORMANCE BOND.

Required forms must be filed within ninety (90) days of completion for bond release. Inspector to be notified twenty-four (24) hours in advance.

The following waiver must be completed by the coal operator if the permit is to be issued within ten days of receipt thereof.

WAIVER: I the undersigned, Agent for _____ Coal Company, Owner or Operator of the coal under this lease have examined and place on our mine maps this proposed well location.

We the _____ Coal Company have no objections to said well being drilled at this location, providing operator has complied with all rules and regulations in Articles 4, 5, and 7, Chapter 22 of the West Virginia Code.

For Coal Company

Official Title