

Latitude 39° 25'

Longitude 80° 50'

⊕ 1.225
4.09W

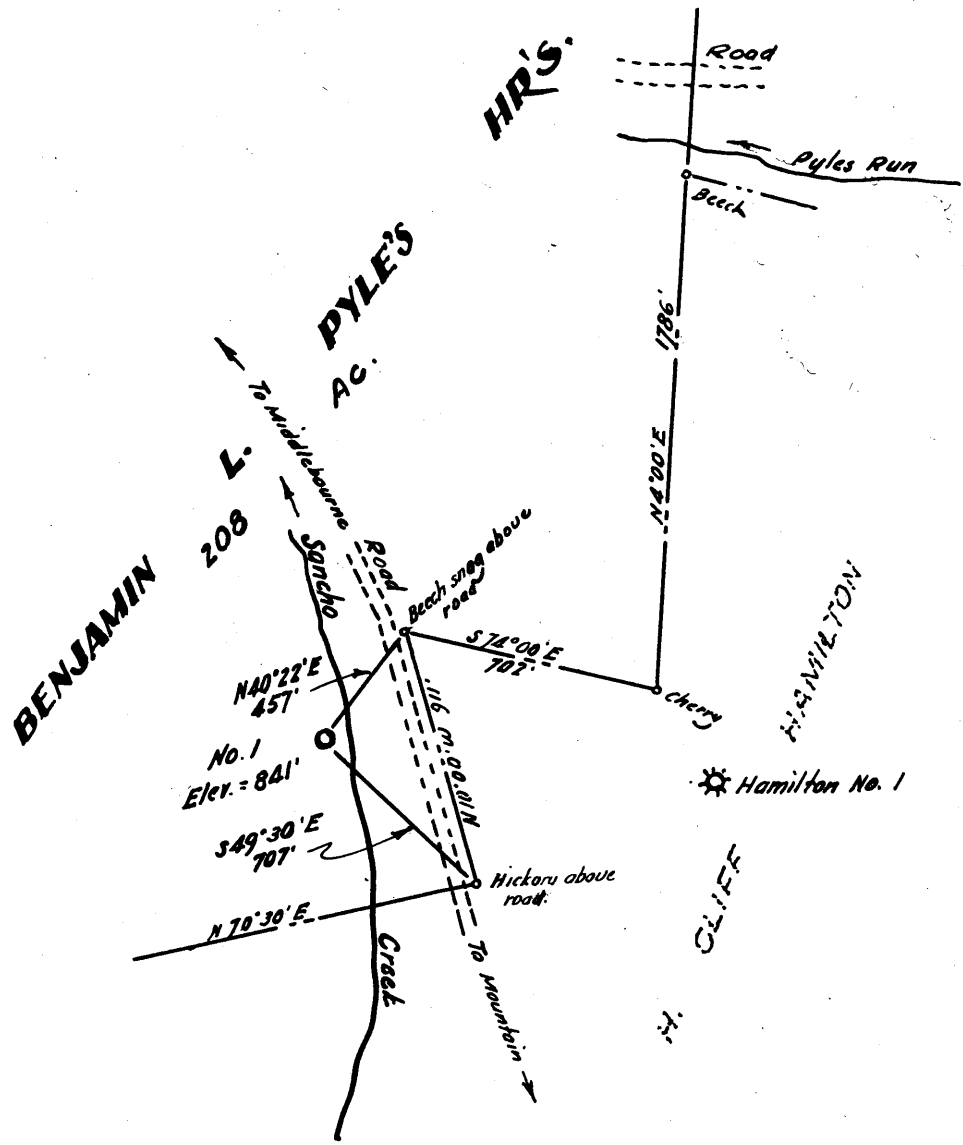
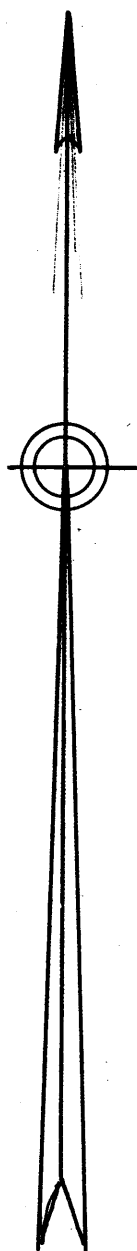

- New Location.
- Drill Deeper.....
- Redrill.....
- Abandonment.....

No coal
Surface is owned by A.C. Pyles, Route 1,
Middlebourne, West Va.
never drilled WV DEP database
Kla Gillis

Company ROBERT L. WOLFF
 Address 405 National Bank of Commerce Bldg. New Orleans, La.
 Farm Benjamin L. Pyle's Heirs
 Tract _____ Acres 208.0 Lease No. _____
 Well (Farm) No. One Serial No. _____
 Elevation (Spirit Level) 841'
 Quadrangle West Union
 County Tuler District Centerville
 Engineer [Signature]
 Engineer's Registration No. 1227
 File No. _____ Drawing No. _____
 Date February 1961 Scale 1" = 660' = 40p.

conc. 10/25/1961
 STATE OF WEST VIRGINIA
 DEPARTMENT OF MINES
 OIL AND GAS DIVISION
 CHARLESTON
WELL LOCATION MAP
 FILE NO. TYL-304

+ Denotes location of well on United States Topographic Maps, scale 1 to 62,500, latitude and longitude lines being represented by border lines as shown.
 — Denotes one inch spaces on border line of original tracing.