

7 1/2" TOPO
1.38W
0.05S

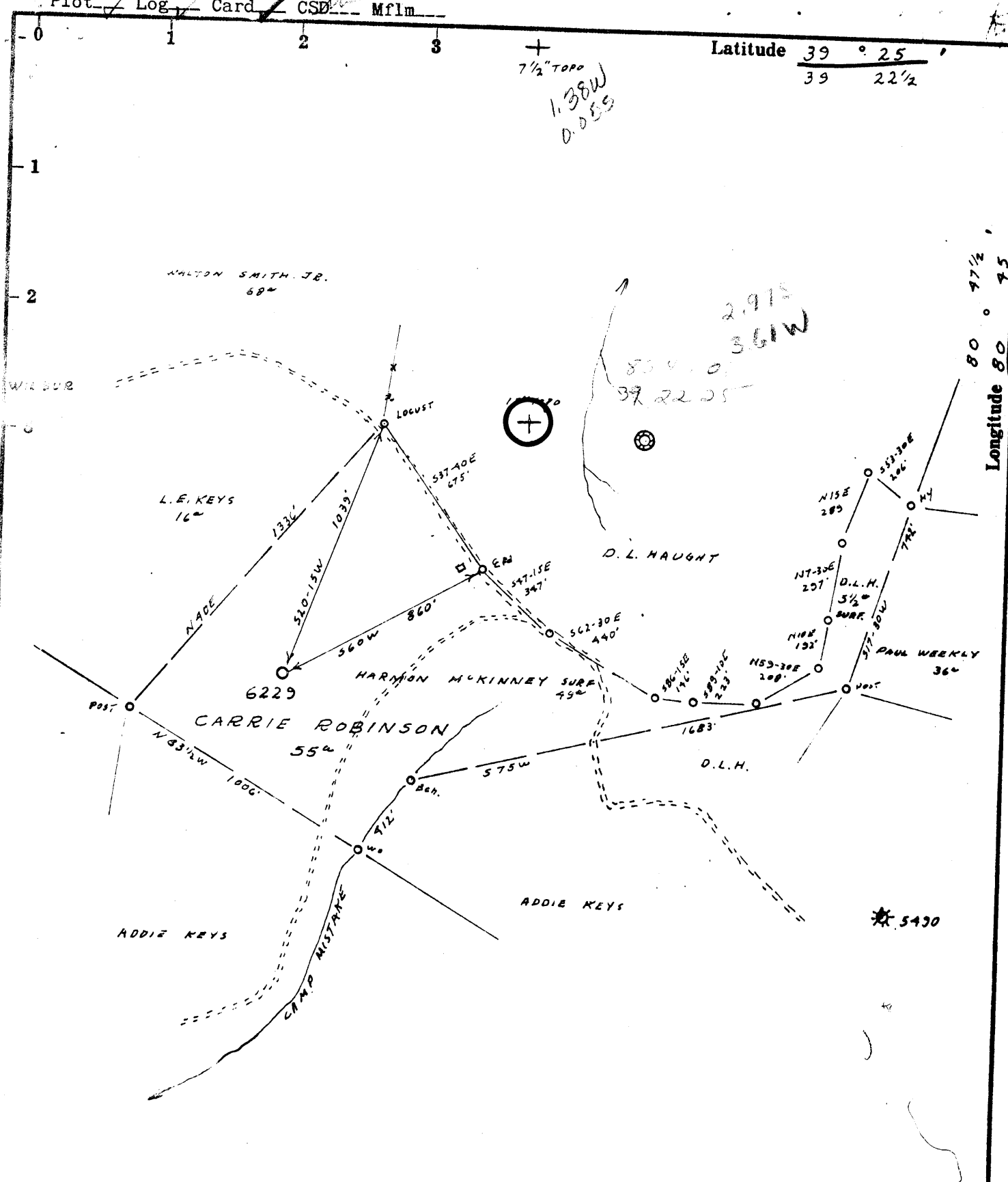

- Fracture...
- Redrill...
- New Location...
- Drill Deeper...
- Abandonment...

Source of Elevation HOPE NAT. CO. WELL 3710

I, the undersigned, hereby certify that this map is correct to the best of my knowledge and belief and shows all the information required by paragraph 6 of the rules and regulations of the oil and gas section of the mining laws of West Virginia.

Minimum accuracy, one part in 200

Company EQUITABLE GAS CO. WVA. DIV.
 Address PITTSBURGH, PA. 15219
 Farm CARRIE ROBINSON
 Tract _____ Acres 55 Lease No. 26213
 Well (Farm) No. _____ Serial No. 6229
 Elevation (Spirit Level) 1049' EC
 Quadrangle WEST UNION SE12
 County TYLER District M'ELROY
 Engineer P. D. McElroy
 Engineer's Registration No. 105 L.L.S.
 File No. 222-C/22 Drawing No. _____
 Date 7-27-76 Scale 1" = 500'

STATE OF WEST VIRGINIA
 DEPARTMENT OF MINES
 OIL AND GAS DIVISION
 CHARLESTON

WELL LOCATION MAP
 FILE NO. **TYL-478-RED**

+ Denotes location of well on United States Topographic Maps, scale 1 to 62,500, latitude and longitude lines being represented by border lines as shown.

— Denotes one inch spaces on border line of original tracing.

47-095



STATE OF WEST VIRGINIA
DEPARTMENT OF MINES
Oil and Gas Division

WELL RECORD

Quadrangle West Union SE 1.2

Permit No. TYL-478-RED

Rotary _____ Oil _____
Cable XX Gas XX
Recycling _____ Comb. _____
Water Flood _____ Storage _____
Disposal _____ (Kind) _____

Company Equitable Gas
Address Pittsburgh, Pa. 15219
Farm Carrie Robinson Acres 55
Location (waters) Jefferson Run
Well No. 6229 Elev. 1049
District McElroy County Tyler
The surface of tract is owned in fee by _____
Harmon McKinney
Address Wilbur, W. Va. 26146
Mineral rights are owned by Carl W. Ash
Address Friendly, W. Va. 26146
Re- Drilling Commenced 8-18-76
Re- Drilling Completed 9-24-76
Initial open flow _____ cu. ft. _____ bbls.
Final production 140 M cu. ft. per day _____ bbls.
Well open 92 hrs. before test 242# RP.

Casing and Tubing	Used in Drilling	Left in Well	Cement fill up Cu. ft. (Sks.)
Size 20-16			
Cond. 13-10"			
9 5/8			
8 5/8			
7	1914	1914	
5 1/2			
4 1/2	Ran	1956	50 sks. to 1500. gel to surface
3			
2			
Liners Used			

Well treatment details:

None

Attach copy of cementing record.

Coal was encountered at 635-638 Feet _____ Inches
Fresh water _____ Feet _____ Salt Water _____ Feet _____
Producing Sand Big Injun Depth _____

Formation	Color	Hard or Soft	Top Feet	Bottom Feet	Oil, Gas or Water	* Remarks
Sand			502	536		
Pittsburgh Coal (Driller Est.)			635	638		
Sand			646	660		
Murphy Sand			844	865		
L. Dunkard Sand			1020	1030		
B. Dunkard Sand			1078	1110		
Gas Sand			1158	1186		
Salt Sand			1254	1680		
Maxon Sand			1789	1802		
Little Lime			1858	1878		
Big Lime			1890	1960		
<u>Big Injun</u>			1964	2106	<u>Gas 1964-70</u>	
Cleaned Out to				2127		
Cement Plug Back to				1984		
Completed Total Depth				1984		

Note: Gamma Log from surface to 2126

(over)

* Indicates Electric Log tops in the remarks section.



STATE OF WEST VIRGINIA
DEPARTMENT OF MINES

RECEIVED

AUG 02 1976

OIL & GAS DIVISION
DEPT. OF MINES

Oil and Gas Division

OIL AND GAS WELL PERMIT APPLICATION

TO THE DEPARTMENT OF MINES,
Charleston, W. Va.

DATE July 29, 1976

Surface Owner Harmon McKinney

Company Equitable Gas

Address Wilbur, W. Va. 26459

Address Pittsburgh, Pa. 15219

Mineral Owner Carl W. Ash Route 1

Farm Carrie Robinson Acres 55

Address Box 34, Friendly, W. Va. 26146

Location (waters) Jefferson Run

Coal Owner Same as mineral owner

Well No. 6229 Elevation 1049

Address _____

District McElroy County Tyler

Coal Operator _____

Quadrangle West Union SE 1.2

Address _____

THIS PERMIT MUST BE POSTED AT THE WELL SITE

All provisions being in accordance with Chapter 22, of the W. Va. Code, the location is hereby approved for redrilling. This permit shall expire if operations have not commenced by 12-2-76.

INSPECTOR
TO BE NOTIFIED Paul Garrett

ADDRESS Clarksburg, W. Va.

PHONE 622-3871

[Signature]
Deputy Director - Oil & Gas Division

GENTLEMEN:

The undersigned well operator is entitled to drill upon the above named farm or tract of land for oil and gas, having fee title thereto, (or as the case may be) under grant or lease dated Oct. 1 1909 by Carrie Robinson made to Hope Natural Gas and recorded on the 2nd day of May 1911, in Tyler County, Book 70 Page 483

_____NEW WELL _____DRILL DEEPER _____XX REDRILL _____FRACTURE OR STIMULATE
_____OIL AND GAS WELL ORIGINALLY DRILLED BEFORE JUNE 5, 1969.

The enclosed plat was prepared by a registered engineer or licensed land surveyor and all coal owners and/or operators have been notified as of the above date.

The above named coal owners and/or operator are hereby notified that any objection they wish to make, or are required to make by Section 3 of the Code, must be received by, or filed with the Department of Mines within ten (10) days. *

Copies of this notice and the enclosed plat were mailed by registered mail, or delivered to the above named coal operators or coal owners at their above shown respective address _____ day _____ before, or on the same day with the mailing or delivery of this copy to the Department of Mines at Charleston, West Virginia.

Very truly yours, S. M. Linger
(Sign Name) Equitable Gas Co.
Well Operator

PLEASE SUBMIT COPIES OF ALL
GEOPHYSICAL LOGS DIRECTLY TO:

WEST VIRGINIA GEOLOGICAL AND
ECONOMIC SURVEY
P. O. BOX 879
MORGANTOWN, WEST VIRGINIA 26505
AC-304 - 292-6331

Address
of
Well Operator

420 Blvd. of the Allies
Street
Pittsburgh
City or Town
Pennsylvania 15219
State

*SECTION 3 If no objections are filed or found by the Department of mines, within said period of ten days from the receipt of notice and plat by the department of mines, to said proposed location, the department shall forthwith issue to the well operator a permit reciting the filing of such plat, that no objections have been made by the coal operators or found thereto by the department and that the same is approved and the well operator authorized to proceed.

TYL-478-RED. PERMIT NUMBER

THIS IS AN ESTIMATE ONLY
ACTUAL INFORMATION WILL BE SUBMITTED ON OG-10 UPON COMPLETION

PROPOSED WORK ORDER TO X Re-DRILL _____ DEEPEN _____ FRACTURE-STIMULATE _____
 DRILLING CONTRACTOR: (If Known) _____ RESPONSIBLE AGENT: _____
 NAME _____ NAME H. E. Gardner
 ADDRESS _____ ADDRESS Box 1550, Clarksburg, W. Va.
 TELEPHONE _____ TELEPHONE 624-6576
 ESTIMATED DEPTH OF COMPLETED WELL: 1980 ROTARY _____ CABLE TOOLS XX
 PROPOSED GEOLOGICAL FORMATION: Big Injun
 TYPE OF WELL: OIL _____ GAS XX COMB. _____ STORAGE _____ DISPOSAL _____
 RECYCLING _____ WATER FLOOD _____ OTHER _____

TENTATIVE CASING PROGRAM:

CASING AND TUBING SIZE	USED FOR DRILLING	LEFT IN WELL	CEMENT FILL UP OR SACKS - CUBIC FT.
20 - 16			
13 - 10			
9 - 5/8			
8 - 5/8			
7	1940	1940	
5 1/2	1970	1970 Pull	
4 1/2		Run 1960	Cem. to 1600
3			Perf. Top
2			Perf. Bottom
Liners			Perf. Top
			Perf. Bottom

APPROXIMATE FRESH WATER DEPTHS _____ FEET _____ SALT WATER _____ FEET _____
 APPROXIMATE COAL DEPTHS 635 _____
 IS COAL BEING MINED IN THE AREA? No BY WHOM? _____

TO DRILL:

SUBMIT FIVE (5) COPIES OF OG - 1, \$100.00 PERMIT FEE, PERFORMANCE BOND AND PERMANENT COPY OF PLAT.

TO DRILL DEEPER OR REDRILL:

SUBMIT FIVE (5) COPIES OF OG - 1, SHOWING ORIGINAL PERMIT NUMBER AND PERFORMANCE BOND. ON WELLS DRILLED PRIOR TO 1929, A PERMANENT COPY OF THE PLAT AND THE ORIGINAL WELL RECORD MUST ALSO BE SUBMITTED.

TO FRACTURE - STIMULATE:

OIL AND/OR GAS WELL ORIGINALLY DRILLED BEFORE JUNE 5, 1929, FIVE (5) COPIES OG - 1, PERFORMANCE BOND, PERMANENT PLAT AND ORIGINAL WELL RECORD.

OIL AND/OR GAS WELL ORIGINALLY DRILLED ON AND/OR AFTER JUNE 5, 1929, FIVE COPIES OG - 1, SHOWING ORIGINAL PERMIT NUMBER, AND PERFORMANCE BOND.

Required forms must be filed within ninety (90) days of completion for bond release. Inspector to be notified twenty-four (24) hours in advance.

The following waiver must be completed by the coal operator if the permit is to be issued within ten days of receipt thereof.

WAIVER: I the undersigned, Agent for _____ Coal Company, Owner or Operator of the coal under this lease have examined and place on our mine maps this proposed well location.

We the _____ Coal Company have no objections to said well being drilled at this location, providing operator has complied with all rules and regulations in Articles 4, 5, and 7, Chapter 22 of the West Virginia Code.

For Coal Company

Official Title