



west virginia department of environmental protection

Office of Oil and Gas
601 57th Street SE
Charleston, WV 25304
(304) 926-0450
(304) 926-0452 fax

Earl Ray Tomblin, Governor
Randy C. Huffman, Cabinet Secretary
www.dep.wv.gov

June 03, 2015

WELL WORK PLUGGING PERMIT

Plugging

This permit, API Well Number: 47-9500700, issued to SANCHO OIL & GAS CORPORATION, is evidence of permission granted to perform the specified well work at the location described on the attached pages and located on the attached plat, subject to the provisions of Chapter 22 of the West Virginia Code of 1931, as amended, and all rules and regulations promulgated thereunder, and to all conditions and provisions outlined in the pages attached hereto. Notification shall be given by the operator to the Oil and Gas Inspector at least 24 hours prior to the construction of roads, locations, and/or pits for any permitted work. In addition, the well operator shall notify the same inspector 24 hours before any actual well work is commenced and prior to running and cementing casing. Spills or emergency discharges must be promptly reported by the operator to 1-800-642-3074 and to the Oil and Gas inspector.

Upon completion of the plugging well work, the above named operator will reclaim the site according to the provisions of WV Code 22-6-30. The above named operator will also file, as required in WV Code 22-6-23, an affidavit on form WR-38 by two experienced persons in the operator's employment and the Oil and Gas inspector that the work authorized under this permit was performed and a description given. Failure to abide by all statutory and regulatory provisions governing all duties and operations here under may result in suspensions or revocation of this permit and in addition may result in civil and/or criminal penalties being imposed upon the operator.

This permit will expire in two (2) years from date of issue. If there are any questions, please free to contact me at (304) 926-0499 ext. 1654.

James Martin
Chief

Operator's Well No: NOLAN 2
Farm Name: NOLAN, CARL W.
API Well Number: 47-9500700
Permit Type: Plugging
Date Issued: 06/03/2015

Promoting a healthy environment.

06/05/2015

PERMIT CONDITIONS

West Virginia Code §22-6-11 allows the Office of Oil and Gas to place specific conditions upon this permit. Permit conditions have the same effect as law. Failure to adhere to the specified permit conditions may result in enforcement action.

CONDITIONS

1. All pits must be lined with a minimum of 20 mil thickness synthetic liner.
2. In the event of an accident or explosion causing loss of life or serious personal injury in or about the well or while working on the well, the well operator or its contractor shall give notice, stating the particulars of the accident or explosion, to the oil and gas inspector and the Chief within twenty-four (24) hours.
3. Well work activities shall not constitute a hazard to the safety of persons.

9500700A

WW-4A
Revised 6-07

1) Date: May 13, 2015
2) Operator's Well Number
Nolan 2

3) API Well No.: 47 - 095 - 00700

**STATE OF WEST VIRGINIA
DEPARTMENT OF ENVIRONMENTAL PROTECTION, OFFICE OF OIL AND GAS
NOTICE OF APPLICATION TO PLUG AND ABANDON A WELL**

4) Surface Owner(s) to be served:		5) (a) Coal Operator	
(a) Name	<u>Edna Monroe</u>	Name	<u>NO DECLARATIONS ON RECORD WITH COUNTY</u>
Address	<u>2543 Conaway Run Road</u> <u>Alma, WV 26320</u>	Address	<u></u>
(b) Name	<u></u>	(b) Coal Owner(s) with Declaration	
Address	<u></u>	Name	<u>NO DECLARATIONS ON RECORD WITH COUNTY</u>
		Address	<u></u>
(c) Name	<u></u>	Name	<u></u>
Address	<u></u>	Address	<u></u>
6) Inspector	<u>Michael Goff</u>	(c) Coal Lessee with Declaration	
Address	<u>601 57th Street SE</u> <u>Charleston, WV 25304</u>	Name	<u>NO DECLARATIONS ON RECORD WITH COUNTY</u>
Telephone	<u>304-549-9823</u>	Address	<u></u>

TO THE PERSONS NAMED ABOVE: You should have received this Form and the following documents:

- (1) The application to Plug and Abandon a Well on Form WW-4B, which sets out the parties involved in the work and describes the well its and the plugging work order; and
- (2) The plat (surveyor's map) showing the well location on Form WW-6.

The reason you received these documents is that you have rights regarding the application which are summarized in the instructions on the reverse side. However, you are not required to take any action at all.

Take notice that under Chapter 22-6 of the West Virginia Code, the undersigned well operator proposes to file or has filed this Notice and Application and accompanying documents for a permit to plug and abandon a well with the Chief of the Office of Oil and Gas, West Virginia Department of Environmental Protection, with respect to the well at the location described on the attached Application and depicted on the attached Form WW-6. Copies of this Notice, the Application, and the plat have been mailed by registered or certified mail or delivered by hand to the person(s) named above (or by publication in certain circumstances) on or before the day of mailing or delivery to the Chief.

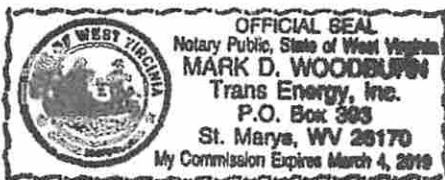

Well Operator Sancho Oil & Gas Corporation
 By: Loren Bagley
 Its: President
 Address: 210 2nd Street, PO Box 179
St. Marys, WV 26170
 Telephone: 304-884-7170

Subscribed and sworn before me this 18 day of MAY, 2015
Mark D. Woodburn Notary Public
 My Commission Expires MARCH 4, 2019

Oil and Gas Privacy Notice

The Office of Oil and Gas processes your personal information, such as name, address and phone number, as a part of our regulatory duties. Your personal information may be disclosed to other State agencies or third parties in the normal course of business or as needed to comply with statutory or regulatory requirements, including Freedom of Information Act requests. Our office will appropriately secure your personal information. If you have any questions about our use of your personal information, please contact DEP's Chief Privacy Officer at depprivacyofficer@wv.gov.

Received

MAY 29 2015

Office of Oil and Gas
Department of Environmental Protection

06/05/2015

9500700P

CERTIFIED MAIL RECEIPT
NOLAN 2 WELL
WW-4A AND WW-4B NOTICE OF APPLICATION
TO PLUG AND ABANDON A WELL
TO SURFACE OWNER

Received

MAY 29 2015

Office of Oil and Gas
WV Dept. of Environmental Protection

WV DEPT OF ENVIRONMENTAL PROTECTION

Instructions

- Each Click-N-Ship® label is unique. Labels are to be used as printed and used only once. **DO NOT PHOTO COPY OR ALTER LABEL.**
- Place your label so it does not wrap around the edge of the package.
- Adhere your label to the package. A self-adhesive label is recommended. If tape or glue is used, **DO NOT TAPE OVER BARCODE.** Be sure all edges are secure.
- To mail your package with PC Postage®, you may schedule a Package Pickup online, hand to your letter carrier, take to a Post Office™, or drop in a USPS collection box.
- Mail your package on the "Ship Date" you selected when creating this label.

Click-N-Ship® Label Record

Signature Confirmation™ :	
9410 8036 9930 0068 0653 02	
Trans. #:	338817608
Print Date:	05/21/2015
Ship Date:	05/21/2015
Expected	
Delivery Date:	05/26/2015
Priority Mail® Postage:	\$5.25
Signature Confirmation:	\$2.35
(Electronic Rate)	
Total:	\$7.60
From: ASHLE STEELE ANTERO RESOURCES 1815 WYNKOOP ST DENVER CO 80202-1106	
To: EDNA MONROE 2543 CONAWAY RUN RD ALMA WV 26320-7232	
<small>* Commercial Base Pricing Priority Mail rates apply. There is no fee for USPS Tracking™ service on Priority Mail service with use of this electronic rate shipping label. Refunds for unused postage paid labels can be requested online 30 days from the print date.</small>	



Thank you for shipping with the United States Postal Service!
Check the status of your shipment on the USPS Tracking™ page at usps.com

06/05/2015

SURFACE OWNER WAIVER

Operator's Well
Number

Nolan 2

INSTRUCTIONS TO SURFACE OWNERS NAMED ON PAGE WW4-A

The well operator named on page WW-4A is applying for a permit from the State to plug and abandon a well. (Note: If the surface tract is owned by more than three persons, then these materials were served on you because your name appeared on the Sheriff's tax ticket on the land or because you actually occupy the surface tract. In either case, you may be the only owner who will actually receive these materials.) See Chapter 22 of the West Virginia Code. Well work permits are valid for 24 months. If you do not own any interest in the surface tract, please forward these materials to the true owner immediately if you know who it is. Also, please notify the well operator and the Office of Oil and Gas.

**NOTE: YOU ARE NOT REQUIRED TO FILE ANY COMMENT.
WHERE TO FILE COMMENTS AND OBTAIN ADDITIONAL INFORMATION:**

Chief, Office of Oil and Gas
Department of Environmental Protection
601 57th St. SE
Charleston, WV 25304
(304) 926-0450

Time Limits and methods for filing comments. The law requires these materials to be served on or before the date the operator files his Application. You have **FIVE (5) DAYS** after the filing date to file your comments. Comments must be filed in person or received in the mail by the Chief's office by the time stated above. You may call the Chief's office to be sure of the date. Check with your postmaster to ensure adequate delivery time or to arrange special expedited handling. If you have been contacted by the well operator and you have signed a "voluntary statement of no objection" to the planned work described in these materials, then the permit may be issued at any time.

Comments must be in writing. Your comments must include your name, address and telephone number, the well operator's name and well number and the approximate location of the proposed well site including district and county from the application. You may add other documents, such as sketches, maps or photographs to support your comments.

The Chief has the power to deny or condition a well work permit based on comments on the following grounds:

- 1) The proposed well work will constitute a hazard to the safety of persons.
- 2) The soil erosion and sediment control plan is not adequate or effective;
- 3) Damage would occur to publicly owned lands or resources;
- 4) The proposed well work fails to protect fresh water sources or supplies;
- 5) The applicant has committed a substantial violation of a previous permit or a substantial violation of one or more of the rules promulgated under Chapter 22, and has failed to abate or seek review of the violation..."

If you want a copy of the permit as it is issued or a copy of the order denying the permit, you should request a copy from the Chief.

VOLUNTARY STATEMENT OF NO OBJECTION

I hereby state that I have read the instructions to surface owners and that I have received copies of a Notice and Application For A Permit To Plug And Abandon on Forms WW-4A and WW-4B, and a survey plat.

I further state that I have no objection to the planned work described in these materials, and I have no objection to a permit being issued on those materials.

**FOR EXECUTION BY A NATURAL PERSON
ETC**

FOR EXECUTION BY A CORPORATION,

Signature

Date 5/22/15 Name _____
By _____
Its _____

Date

Signature

Date

9500700P

WW-4B
Rev. 2/01

1) Date May 13, 2015
2) Operator's
Well No. Nolan 2
3) API Well No. 41-025-00700

STATE OF WEST VIRGINIA
DEPARTMENT OF ENVIRONMENTAL PROTECTION
OFFICE OF OIL AND GAS

APPLICATION FOR A PERMIT TO PLUG AND ABANDON

- 4) Well Type: Oil ___ / Gas X / Liquid injection ___ / Waste disposal ___ /
(If "Gas, Production ___ or Underground storage ___) Deep ___ / Shallow X
- 5) Location: Elevation 1159' Watershed Conaway Run
District Centerville County Tyler Quadrangle Middlebourne
- 6) Well Operator Sancho Oil & Gas Corporation 7) Designated Agent Loren E. Bagley
Address 210 2nd Street, PO Box 179 Address 210 2nd Street, PO Box 179
St. Marys, WV 26170 St. Marys, WV 26170
- 8) Oil and Gas Inspector to be notified Name Michael Goff 9) Plugging Contractor Name Antero Resources Corporation
Address 601 57th Street, SE Address 1615 Wynkoop Street
Charleston, WV 25304 Denver, CO 80202

10) Work Order: The work order for the manner of plugging this well is as follows:

*Please see attached Work Order.

Received

MAY 29 2015

Office of Oil and Gas
WV Dept. of Environmental Protection

Notification must be given to the district oil and gas inspector 24 hours before permitted work can commence.

Work order approved by inspector Michael Goff Date 5/28/15

06/05/2015

95007004

Nolan 2
Tyler County, WV
API #47-095-00700

Objective: Plug and Abandon Wellbore.

Pipe Schedule:

1. 10-3/4" set @ 330'. Cemented to surface
2. 7" J-55, 17# set @ 2,056' with estimated TOC @ 1,900'
3. 4-1/2" set @ 5,284' with estimated TOC @ 2,260'.

OIL 2083,
GAS 2150,
GAS 3610'
GAS 4754'
GAS 5125'

ELEV. 1160'

Procedure:

1. Coordinate and schedule casing jacks.
2. Notify WVDEP prior to commencing work, for plug witnessing (Mike Goff -304-549-9823)
3. Move in and rig up flat tank and frac tank (No pits will be utilized).
4. Move in rig up service unit.
5. Nipple up BOPE and test.
6. Kill well.
7. Rig up wireline and lubricator.
8. Make gauge ring run to CIBP Setting depth = 5,097' (20' above uppermost perf per CBL). Pull out of hole.
9. Run gyro survey
10. Lubricate in a cast iron bridge plug and set at 5,097'. Pull out with wireline.
11. Pressure test CIBP to 500 psi.
12. Pick up tubing, run in hole.
13. Tag and verify bridge plug setting depth.
14. Pull one foot above bridge plug.
15. Pump 100' plug from CIBP to 100' above CIBP. Cement = 10 sacks Class A with 2% CaCl₂; yield = 1.18 ft³/sk; water = 5.2 gals/sk; (Volume includes 20% excess).
16. Slowly pull out of cement plug. Pull tubing 200' and reverse circulate tubing clean.
17. Wait on cement 8hrs.
18. Load hole w/ GEL (approximately 456 ft³/82 bbls).
19. Run in tubing and verify top of cement plug at 4,997'.
20. If top of cement is deeper than 4,997'.
 - a. Mix and spot cement so top is a minimum depth of 4,997'.
 - b. Cement quantity to be determined but will be Class A with 2% CaCl₂; yield = 1.18 ft³/sk; water = 5.2 gals/sk; 20% excess.
 - c. Pull 200' of tubing and reverse circulate tubing clean (maintain hole full of GEL)
 - d. Wait on cement 8 hours.
 - e. Repeat steps until TOC is shallower than 4,997'.
 - f. Tag TOC after each/every plug set.
21. Trip in with wireline and run free point above top of cement (TOC = 2,260').
22. Trip out. Trip in and fire backoff charge at xxxx' (depth as determined via freepoint).
23. Back off casing at approximately xxxx' (depth a function of freepoint).
24. Pull out with wire line.
25. Rig up casing jacks and pull casing – lay down casing.
26. Run CBL from base of 7" casing to surface
27. Locate top of cement in 7" casing.
28. Pick up tubing and run in to 2,106'.
29. Pump a 100' balanced cement plug 50' below 7" casing at 2,106' from 2,006' to 2,106'. (50' above and 50' below 7" casing shoe). Cement = 35 sacks Class A with 2% CaCl₂; yield = 1.18 ft³/sk; water = 5.2 gals/sk; (Volume includes 20% excess).
30. Slowly pull out of plug. Pull 200' of tubing reverse circulate tubing clean (maintain hole full of GEL)
31. Wait on cement 8 hours.
32. Trip in and tag top of cement.
33. If cement is shallower than 2,006', then skip to step 35.
34. If top of cement is deeper than 2,006':
 - a. Mix and spot cement so top is a minimum depth of 2,006'.
 - b. Cement quantity to be determined but will be Class A with 2% CaCl₂; yield = 1.18 ft³/sk; water = 5.2 gals/sk; 20% excess.
 - c. Pull 200' of tubing and reverse circulate tubing clean (maintain hole full of mud).
 - d. Wait on cement 8 hours.

GEL MUST BE FRESH WATER WITH A MINIMUM OF 6% BENTONITE (BY WEIGHT).

Received
Office of Oil & Gas

MAY 26 2015

06/05/2015

Jamm

Nolan 2
Tyler County, WV
API # 47-095-00700.

- e. Repeat steps until TOC is shallower than 2,006'.
 - f. Tag TOC after each/every plug set.
35. When TOC is shallower than 2,006', pull 200' of tubing and reverse circulate tubing clean (maintain hole full of gel).
36. Trip out of hole.
- a. Trip in and fire backoff charge at a depth determined via freepoint.
 - b. Back off casing at approximately xxxx' (approximate depth of freepoint).
 - c. Pull out with wireline.
 - d. Rig up casing jacks and pull 7" casing – lay down casing. Maintain hole full of gel.
 - e. Trip in to depth of casing cut (~ 1,800').
 - f. Pump 100' cement plug from 1,850' to 1,750' (50' below and 50' above casing cut).
 Cement = 42 sacks Class A with 2% CaCl₂; yield = 1.18 ft³/sk; water = 5.2 gals/sk;
 (Volume includes 20% excess).
 - g. Pull 200' of tubing and reverse circulate tubing clean (maintain hole full of gel).
 - h. Wait on cement 8 hours.
 - i. Trip in and tag cement top.
 - j. If top of cement is deeper than 1,750'
 - a. Mix and spot cement so top is a minimum depth of 1,750'.
 - b. Cement quantity to be determined but will be Class A with 2% CaCl₂; yield = 1.18 ft³/sk; water = 5.2 gals/sk; 20% excess.
 - c. Pull 200' of tubing and reverse circulate tubing clean (maintain hole full of gel).
 - d. Wait on Cement 8 hours.
 - e. Repeat steps until TOC is shallower than 1,750'.
 - f. Tag TOC after each/every plug set.
37. Pick up to 1,160'(elevation) and set 100' cement plug from 1,160' to 1,060'.
- a. Pull 200' of tubing and reverse circulate tubing clean (maintain hole full of gel).
 - b. Wait on cement 8 hours.
 - c. Trip in and tag cement top.
38. If top of cement is deeper than 1,060'.
- a. Mix and spot cement so top is a minimum depth of 1,060'.
 - b. Cement quantity to be determined but will be Class A with 2% CaCl₂; yield = 1.18 ft³/sk; water = 5.2 gals/sk; 20% excess.
 - c. Reverse circulate tubing clean (maintain hole full of gel).
 - d. Wait on cement 8 hours.
 - e. Repeat steps until TOC is shallower than 1,060'.
 - f. Tap TOC after each/every plug set.
39. Pick up to 380'. Maintain hole full of gel. Set class A cement plug from 380' to 18' below ground.
40. During construction of new pad, cut off casing at 18' below ground level.

FOLLOW ATTACHED OFFSET MARKER GUIDANCE

OFFSET MARKER GUIDANCE

The Office of Oil and Gas is considering granting a general variance to the requirements under 35CSR4-5.5b of erecting a monument upon the plugging of certain wells. If granted, the following conditions will be met:

- 1) the well will be surveyed and a plat constructed as required under 22-6 of the WV Code and 35CSR4,
- 2) a readily visible, permanent offset marker, in as close proximity as reasonably possible, will be erected and will provide distance and bearing information to the plugged well,
- 3) the plugging affidavit (form WR-38), will document the absence of a monument at the well location and document the existence and location of the offset marker,
- 4) a steel plate no smaller than one square foot shall be affixed to the well casing no deeper than three feet below the ground surface and be inscribed with the api number of the well.

To qualify under the general variance, an operator may make a variance request to the Chief of the Office of Oil and Gas for a specific well(s) in conjunction with a showing of good cause by the surface owner.

JMM

06/05/2015

9500700P

WR-35
Rev (5-01)

DATE: December 31, 2001
API #: 47-095-00700

State of West Virginia
Department of Environmental Protection
Office of Oil and Gas

[Handwritten signature]

Well Operator's Report of Well Work

Farm name: Carl W. Nolan Operator Well No.: Two (2)

LOCATION: Elevation: 1159 A.S.L. Quadrangle: Middlebourne

District: Centerville County: Tyler
Latitude: 800 Feet South of 39 Deg. 25 Min. Sec.
Longitude 580 Feet West of 80 Deg. 52 Min. 30 Sec.

Company: Sancho Oil & Gas

	Casing & Tubing	Used in drilling	Left in well	Cement fill up Cu. Ft.
Address: <u>Box 179</u>				
<u>St. Marys. WV 26170</u>	<u>7</u>	<u>2056</u>	<u>2056</u>	
Agent: <u>Loren E. Bagley</u>				
Inspector: <u>Mike Underwood</u>	<u>4 1/2</u>		<u>5284</u>	<u>235 sacks</u>
Date Permit Issued:				
Date Well Work Commenced: <u>October 20, 2000</u>				
Date Well Work Completed: <u>November 4, 2000</u>				
Verbal Plugging:				
Date Permission granted on:				
Rotary Cable Rig				
Total Depth (feet):				
Fresh Water Depth (ft.):				
Salt Water Depth (ft.):				
Is coal being mined in area (N/Y)? <u>No</u>				
Coal Depths (ft.): <u>NA</u>				

20 SACKS

RECEIVED
Office of Oil & Gas
Permitting
JAN 11 2002
WV Department of
Environmental Protection

OPEN FLOW DATA

Producing formation Benson Sandstone Pay zone depth (ft) 5123-5127
Gas: Initial open flow show MCF/d Oil: Initial open flow 0 Bbl/d
Final open flow 900 MCF/d Final open flow 0 Bbl/d
Time of open flow between initial and final tests 72 Hours
Static rock Pressure 1450 psig (surface pressure) after 72 Hours

Second producing formation _____ Pay zone depth (ft) _____
Gas: Initial open flow _____ MCF/d Oil: Initial open flow _____ Bbl/d
Final open flow _____ MCF/d Final open flow _____ Bbl/d
Time of open flow between initial and final tests _____ Hours
Static rock Pressure _____ psig (surface pressure) after _____ Hours

NOTE: ON BACK OF THIS FORM PUT THE FOLLOWING: 1). DETAILS OF PERFORATED INTERVALS, FRACTURING OR STIMULATING, PHYSICAL CHANGE, ETC. 2). THE WELL LOG, WHICH IS A SYSTEMATIC DETAILED GEOLOGICAL RECORD OF ALL FORMATIONS, INCLUDING COAL ENCOUNTERED BY THE WELLBORE.

Signed: *[Signature]*
By: Loren E. Bagley
Date: December 31, 2001

06/05/2015

NOIAW 700

STAGE PERFORATIONS: 1ST Benson 5122-5126 12 holes
Nitrogen Assist with 300 Sks 20/40

STAGE PERFORATIONS:

STAGE PERFORATIONS:

FORMATION	TOP	BOTTOM COMMENTS
Big Lime	2038	2090
Keener Sandstone	2095	2178
Big Injun Sandstone	2180	2270
Weir Sandstone	2440	2550
Berea Sandstone	2625	2628
Gordon Sandstone	3054	3064
Warren Sandstone	3568	3610 gas
Riley Sandstone	4722	4754 gas
Benson Sandstone	5121	5125 gas
TD		5375

06/05/2015

STATE OF WEST VIRGINIA
DEPARTMENT OF MINES, OIL AND GAS DIVISION

Date: August 15, 1979, 19

FORM IV-35
(Obverse)
[08-78,

Operator's Well No. 2-11-766

WELL OPERATOR'S REPORT
OF

API Well No. 17-095-0700
State County Perm.

DRILLING, FRACTURING AND/OR STIMULATING, OR PHYSICAL CHANGE

WELL TYPE: Oil ___ / Gas X / Liquid Injection ___ / Waste Disposal ___
(If "Gas", Production X / Underground storage ___ / Deep ___ / Shallow X /)
LOCATION: Elevation: 1159' Watershed: Branch of Sancho Creek
District: Centerville County: Tyler Quadrangle: Middlebourne
Carl Nolan 2-H-766
WELL OPERATOR Glenn L. Haught & Sons DESIGNATED AGENT Warren R. Haught
Address Smithville, WV 26178 Address Smithville, WV 26178

PERMITTED WORK: Drill X / Convert ___ / Drill deeper ___ / Redrill ___ / Fracture or stimulate ___
Plug off old formation ___ / Perforate new formation ___
Other physical change in well (specify) _____

PERMIT ISSUED ON June 19, 19 79 OIL & GAS INSPECTOR FOR THIS WORK:
(IF APPLICABLE: PLUGGING OF DRY HOLE OR CONTINUOUS PROGRESSION FROM DRILLING OR REWORKING. VERBAL PERMISSION OBTAINED) Name Phil Tracey
Address Middlebourne, WV 26149

GEOLOGICAL TARGET FORMATION: Big Injun Depth 2150 to 2202 feet
Depth of completed well, 2202 feet Rotary X / Cable Tools ___
Water strata depth: Fresh, 790 feet; salt, ___ feet.
Coal seam depths: None Is coal being mined in the area? No
Work was commenced July 1, 19 79 and completed July 9, 19 79

CASING AND TUBING PROGRAM

CASING OR TUBING TYPE	SPECIFICATIONS				FOOTAGE INTERVALS		CEMENT FILL-UP OR SACKS (Cubic feet)	PACKERS	
	Size	Grade	Weight per ft.	New	Used	For drilling			Left in well
Conductor				X		337	337	150 sacks	None
Fresh water	10 3/4"			X		2056'	2056'	20 sacks	None
Coal									None
Intermediate	7"			X					Depth set
Production									Perforations:
Tubing									Top Bottom
Liners									

OCT 25 1979
OIL & GAS DIVISION
DEPT. OF MINES

OPEN FLOW DATA

Producing formation _____ Pay zone depth _____ feet
Gas: Initial open flow, _____ Mcf/d Oil: Initial open flow, _____ Bbl/d
Final open flow, 400 Mcf/d Final open flow, _____ Bbl/d
Time of open flow between initial and final tests, 8 hours
Static rock pressure, 425 psig (surface measurement) after 12 hours shut in.
[If applicable due to multiple completion--]
Second producing formation _____ Pay zone depth _____ feet
Gas: Initial open flow, _____ Mcf/d Oil: Initial open flow, _____ Bbl/d
Final open flow, _____ Mcf/d Final open flow, _____ Bbl/d
Time of open flow between initial and final tests, _____ hours

RECEIVED
Office of Oil & Gas Permitting
SEP 26 2000
WV Division of Environmental Protection

06/05/2015

9500700P

FORM IV-35
(Reverse)

00-70)

TYL-700

DETAILS OF PERFORATED INTERVALS, FRACTURING OR STIMULATING, PHYSICAL CHANGE, ETC.

Natural

WELL LOG

FORMATION	Color	Hard or Soft	5' Top Feet	Bottom Feet	Including indication of all fresh and salt water, coal, oil and gas
Sand	Yellow	Hard	48	70	
Red Rock	Red	Soft	70	85	
Shale	Grey	Soft	85	120	
Red Rock	Red	Soft	120	200	
Sand	White	Hard	200	225	
Red Rock	Red	Soft	225	250	
Sand	White	Hard	250	361	
Red Rock	Red	Soft	361	370	
Sand & Shale	White	Med.	370	385	
Red Rock	Red	Soft	385	407	
Shale	Grey	Soft	407	410	
Shale	White	Soft	410	420	
Sand	White	Hard	420	450	
Shale	Grey	Soft	450	520	
Sand & Shale	White	Med.	520	565	
Red Rock	Red	Soft	565	576	
Sand & Shale	White	Med.	576	600	
Red Rock	Red	Soft	600	625	
Sand & Shale	White	Med.	625	900	
Sand	White	Hard	900	950	
Shale	Grey	Med.	950	977	
Shale	Grey	Soft	977	1029	
Sand	Grey	Med.	1029	1068	
Shale	Black	Soft	1068	1093	
Sand	White	Med.	1093	1135	
Shale	Blue	Hard	1135	1154	
Sand		Hard	1154	1185	
Shale		Soft	1185	1200	
Red Rock		Soft	1200	1225	
Shale		Soft	1225	1240	
Red Rock		Soft	1240	1252	
Sand			1252	1293	
Shale		Soft	1293	1310	
Red Rock		Soft	1310	1322	
Sand		Med.	1322	1358	
Shale		Soft	1358	1377	
Sand		Hard	1377	1408	
Shale		Hard	1408	1455	
Sand		Hard	1455	1530	
Shale		Med.	1530	1616	
Sand		Hard	1616	1637	
Sand & Shale		Med.	1637	1715	
Sand		Hard	1715	1750	
Shale		Med.	1750	1830	
Sand		Hard	1830	1890	
Shale		Soft	1890	1920	
Sand		Hard	1920	2010	
L. Lime		Hard	2010	2037	
Fencil Cave/Shale		Soft	2037	2040	
B. Lime		Hard	2040	2150	
D. Injun			2150	2202	

RECEIVED
Office of Oil & Gas
Permitting
SEP 26 2000
WV Division of
Environmental Protection

Small Amount of
01102083 Gas & 01102120
Gas ... 02150 - Base of B.Lime
T.D. 2202

NOTE: Regulation 2.02(i) provides as follows:
"The term 'log' or 'well log' ..."

Glenn L. Haught & Sons
Well Operator
By *Thomas R. Haught*

06/05/2015

9500700P

WW-9
Rev. 5/08

Page _____ of _____
API Number 47 - 095 - 00700
Operator's Well No. Nolan 2

STATE OF WEST VIRGINIA
DEPARTMENT OF ENVIRONMENTAL PROTECTION
OFFICE OF OIL AND GAS

CONSTRUCTION AND RECLAMATION PLAN AND SITE REGISTRATION APPLICATION FORM
GENERAL PERMIT FOR OIL AND GAS PIT WASTE DISCHARGE

Operator Name Sancho Oil & Gas Corporation OP Code 307863
Watershed Conaway Run Quadrangle Middlebourne
Elevation 1159' County Tyler District Centerville

Description of anticipated Pit Waste: No pit will be used at this site (All fluids will be stored in tanks and either reused or hauled off site.)

Will a synthetic liner be used in the pit? N/A

Proposed Disposal Method For Treated Pit Wastes:

- Land Application
- Underground Injection (UIC Permit Number _____)
- Reuse (at API Number Future permitted well locations when applicable. API# will be provided on Form WR-34)
- Off Site Disposal (Meadowfill Landfill Permit #SWF-1032-98)
- Other (Explain _____)

MAG
5-28-15

Proposed Work For Which Pit Will Be Used:

- Drilling
- Workover
- Other (Explain _____)
- Swabbing
- Plugging

I certify that I understand and agree to the terms and conditions of the GENERAL WATER POLLUTION PERMIT issued on August 1, 2005, by the Office of Oil and Gas of the West Virginia Department of Environmental Protection. I understand that the provisions of the permit are enforceable by law. Violations of any term or condition of the general permit and/or other applicable law or regulation can lead to enforcement action.

I certify under penalty of law that I have personally examined and am familiar with the information submitted on this application form and all attachments thereto and that, based on my inquiry of those individuals immediately responsible for obtaining the information, I believe that the information is true, accurate, and complete. I am aware that there are significant penalties for submitting false information, including the possibility of fine or imprisonment.

Received

Company Official Signature Loren Bagley
Company Official (Typed Name) Loren Bagley
Company Official Title President

MAY 29 2015

Office of Oil and Gas
WV Dept. of Environmental Protection

Subscribed and sworn before me this 18 day of MAY, 2015

Mark D Woodburn

My commission expires MARCH 4, 2019

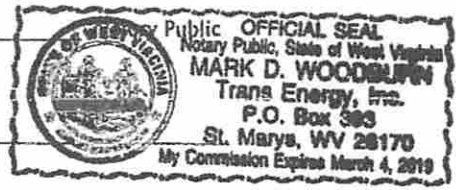

06/05/2015

Form WW-9

Operator's Well No. Nolan 2

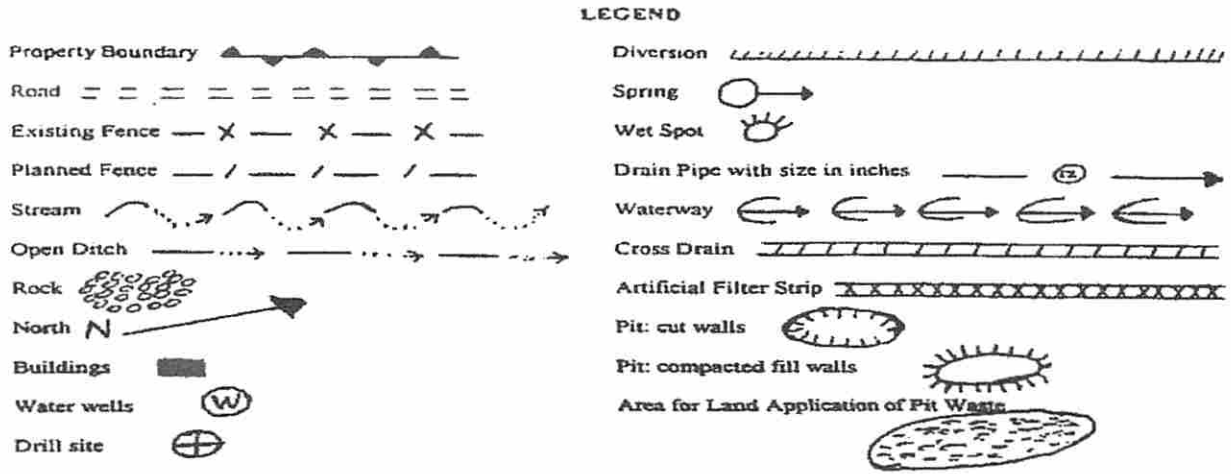

Proposed Revegetation Treatment: Acres Disturbed 5.13 (existing acres) Prevegetation pH _____

Lime 2-3 Tons/acre or to correct to pH 6.5

Fertilizer (10-20-20 or equivalent) 500 lbs/acre (500 lbs minimum)

Mulch 2-3 Tons/acre (Hay, straw or wood fiber (will be used where needed))

Seed Mixtures

Seed Type	Area I	lbs/acre	Seed Type	Area II	lbs/acre
Please reference Table IV-4A on page 12 of the Nolan 2 Well Plugging Plan			Please reference Table IV-4A on page 12 of the Nolan 2 Well Plugging Plan		
*or type of grass seed requested by surface owner			*or type of grass seed requested by surface owner		

Attach:
Drawing(s) of road, location, pit and proposed area for land application.

Photocopied section of involved 7.5' topographic sheet.

Plan Approved by: Michael Doff

Comments: Presced & mulch disturbed areas. Clean up all related trash. 6% gel spacers between plugs.

Title: Oil & Gas Inspector Date: 5-28-15

Field Reviewed? Yes No

Received

MAY 29 2015

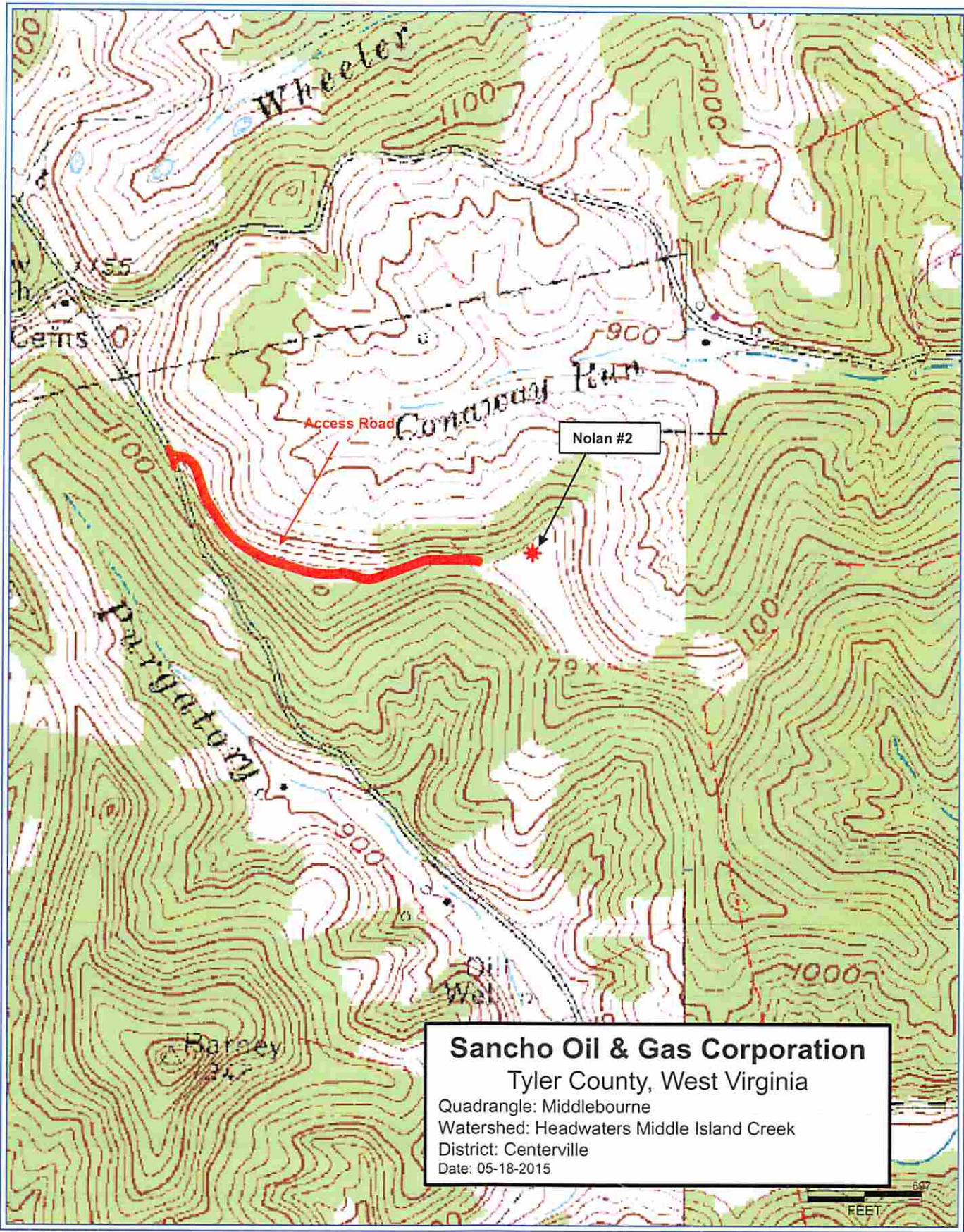

9500700A

WW-7
8-30-06



West Virginia Department of Environmental Protection
Office of Oil and Gas
WELL LOCATION FORM: GPS

API: 47-095-00700 WELL NO.: Nolan 2
FARM NAME: Monroe, Edna
RESPONSIBLE PARTY NAME: Sancho Oil & Gas Corporation
COUNTY: Tyler DISTRICT: Centerville
QUADRANGLE: Middlebourne
SURFACE OWNER: Edna Monroe
ROYALTY OWNER: Edna Monroe
UTM GPS NORTHING: 4362800.4
UTM GPS EASTING: 510497.75 GPS ELEVATION: 1160'

The Responsible Party named above has chosen to submit GPS coordinates in lieu of preparing a new well location plat for a plugging permit or assigned API number on the above well. The Office of Oil and Gas will not accept GPS coordinates that do not meet the following requirements:

1. Datum: NAD 1983, Zone: 17 North, Coordinate Units: meters, Altitude: height above mean sea level (MSL) – meters.
2. Accuracy to Datum – 3.05 meters
3. Data Collection Method:
Survey grade GPS : Post Processed Differential
Real-Time Differential
Mapping Grade GPS : Post Processed Differential
Real-Time Differential
4. Letter size copy of the topography map showing the well location.

Received
Office of Oil & Gas
MAY 26 2015

I the undersigned, hereby certify this data is correct to the best of my knowledge and belief and shows all the information required by law and the regulations issued and prescribed by the Office of Oil and Gas.

Ashley Steele Permit Representative 5/21/2015
Signature Title Date
on behalf of Sancho Oil & Gas Corp.

06/05/2015