



1) Date: MAY 23, 19 84
 2) Operator's Well No. JK-991
 3) API Well No. 47 - 095 - 1083
 State _____ County _____ Permit _____

STATE OF WEST VIRGINIA
 DEPARTMENT OF MINES, OIL AND GAS DIVISION
 APPLICATION FOR A WELL WORK PERMIT

- 4) WELL TYPE: A Oil / Gas /
 B (If "Gas", Production / Underground storage _____ / Deep _____ / Shallow /)
- 5) LOCATION: Elevation: 1127' Watershed: BIG RUN (M1-37) WEST UNION 7.5'
 District: CENTERVILLE County: TYLER Quadrangle: _____
- 6) WELL OPERATOR J & J ENTERPRISES, INC. 7) DESIGNATED AGENT RICHARD M. REDDECLIFF
 Address P.O. BOX 48 Address P.O. BOX 48
BUCKHANNON, WV 26201 BUCKHANNON, WV 26201
- 8) OIL & GAS INSPECTOR TO BE NOTIFIED 9) DRILLING CONTRACTOR:
 Name ROBERT A. LOWTHER Name S. W. JACK DRILLING CO.
 Address GENERAL DELIVERY Address P.O. BOX 48
MIDDLEBOURNE, WV 26149 BUCKHANNON, WV 26201
- 10) PROPOSED WELL WORK: Drill / Drill deeper _____ / Redrill _____ / Stimulate /
 Plug off old formation _____ / Perforate new formation _____ /
 Other physical change in well (specify) _____
- 11) GEOLOGICAL TARGET FORMATION, ALEXANDER
- 12) Estimated depth of completed well, 5300' feet
- 13) Approximate trata depths: Fresh, 95' feet; salt, N/A feet.
- 14) Approximate coal seam depths: 425' - 426' Is coal being mined in the area? Yes _____ / No /

15) CASING AND TUBING PROGRAM

CASING OR TUBING TYPE	SPECIFICATIONS					FOOTAGE INTERVALS		CEMENT FILL-UP OR SACKS (Cubic feet)	PACKERS
	Size	Grade	Weight per ft.	New	Used	For drilling	Left in well		
Conductor	11 3/4	H-40	42	X		30	0	0 Sacks	Kinds
Fresh water	8 5/8	ERW	23	X		1227'	1227'	To surface	NEAT
Coal	8 5/8	ERW	23	X		1227'	1227'	To surface	Sizes
Intermediate									Depths set
Production	4 1/2	J-55	10.5	X		5200'	5200'	225 Sacks	or as required by Rule 15-01
Tubing									Perforations:
Liners									Top Bottom

OFFICE USE ONLY
 DRILLING PERMIT

Permit number 47-095-1083 Date June 12, 19 84

This permit covering the well operator and well location shown below is evidence of permission granted to drill in accordance with the pertinent legal requirements subject to the conditions contained herein and on the reverse hereof. **Notification must be given to the District Oil and Gas Inspector, (Refer to No. 8) Prior to the construction of roads, locations and pits for any permitted work.** In addition, the well operator or his contractor shall notify the proper district oil and gas inspector 24 hours before actual permitted work has commenced.)

The permitted work is as described in the Notice and Application, plat, and reclamation plan, subject to any modifications and conditions specified on the reverse hereof.

Permit expires June 12, 1986 unless well work is commenced prior to that date and prosecuted with due diligence.

Bond:	Agent:	Plat:	Casing	Fee
<u>BB</u>	<u>mtl</u>	<u>mtl</u>	<u>mtl</u>	<u>1561</u>

[Signature]
 Administrator, Office of Oil and Gas

NOTE: Keep one copy of this permit posted at the drilling location.



OFFICE USE ONLY

PERMIT MODIFICATIONS AND CONDITIONS (IF ANY) TO THE PROPOSED WELL WORK

1) WELL ID: _____

2) LOCATION: _____

3) WELL OPERATOR: _____

4) DESIGNATED AGENT: _____

5) DRILLING CONTRACTOR: _____

6) OR & GAS INSPECTOR TO BE NOTIFIED: _____

7) PROPOSED WELL WORK: _____

8) GEOLOGICAL TARGET FORMATION: _____

9) APPROXIMATE TUBING DEPTH: _____

10) APPROXIMATE COAL SEAM DEPTH: _____

11) CASING AND TUBING PROGRAM: _____

OFFICE USE ONLY

This part of Form IV-2(b) is to record the dates of certain occurrences and any follow-up inspections.

	Date	Date(s)
Application received		
Well work started		
Completion of the drilling process		
Well Record received		
Reclamation completed		

OTHER INSPECTIONS

Reason: _____

Reason: _____

12/22/2023

#2280



IV-9
(Rev 8-81)

DATE May 11, 1984

WELL NO. JK-991

State of West Virginia API NO. 47-095-1083

Department of Mines
Oil and Gas Division

CONSTRUCTION AND RECLAMATION PLAN

COMPANY NAME J & J Enterprises, Inc. DESIGNATED AGENT Richard Reddcliff
 Address P.O. Box 48 Buckhannon, WV 26201 Address P.O. Box 48 Buckhannon, WV 26201
 Telephone 304-472-9403 Telephone 304-472-9403
 LANDOWNER Edith Griffin SOIL CONS. DISTRICT Upper Ohio
 Revegetation to be carried out by J & J Enterprises, Inc. (Agent)

This plan has been reviewed by Upper Ohio SCD. All corrections
 and additions become a part of this plan: 5/15/84
 (Date)
Kenneth R. Mason
 (SCD Agent)

ACCESS ROAD	LOCATION
Structure <u>Drainage Ditch</u> (A)	Structure <u>Diversion Ditch</u> (1)
Spacing <u>To be constructed along road</u>	Material <u>Soil</u>
Page Ref. Manual <u>2-12</u>	Page Ref. Manual <u>2-12</u>
Structure <u>Road Culvert</u> (B)	Structure <u>Rip-Rap</u> (2)
Spacing <u>Min. size 15"</u>	Material <u>Logs or brush</u> <i>small</i>
Page Ref. Manual <u>2-7</u>	Page Ref. Manual <u>N/A</u>
Structure <u>Cross Drain</u> (C)	Structure <u></u> (3)
Spacing <u>40'-250' apart depending upon grade</u>	Material <u></u>
Page Ref. Manual <u>2-1</u>	Page Ref. Manual <u></u>

RECEIVED
 MAY 25 1984
 DEPT. OF MINES
 OIL & GAS DIVISION

All structures should be inspected regularly and repaired if necessary. All commercial timber is to be cut and stacked and all brush and small timber to be cut and removed from the site before dirt work begins.

REVEGETATION

Treatment Area I

Lime	<u>3</u> Tons/acre
or correct to pH	<u>6.5</u>
Fertilizer	<u>600</u> lbs/acre
	(10-20-20 or equivalent)
Mulch Hay	<u>2</u> Tons/acre
Seed* KY-31	<u>30</u> lbs/acre
Annual Rye	<u>10</u> lbs/acre
Red Clover	<u>5</u> lbs/acre

Treatment Area II

Lime	<u>3</u> Tons/acre
or correct to pH	<u>6.5</u>
Fertilizer	<u>600</u> lbs/acre
	(10-20-20 or equivalent)
Mulch Hay	<u>3</u> Tons/acre
Seed* Orchard Grass	<u>30</u> lbs/acre
Ladino Clover	<u>5</u> lbs/acre
Red Clover	<u>5</u> lbs/acre

*Inoculate all legumes such as vetch, trefoil and clovers with the proper bacterium. Inoculate with 3X recommended amount.

PLAN PREPARED BY Smith Land Surveying Co.

ADDRESS 111 South Street 12/22/2023
Glenville, WV 26351

PHONE NO. 304-462-5634

NOTES: Please request landowner's cooperation to protect new seeding for one growing season. Attach separate sheets as necessary for comments.

Notary Public, GILMER County,
 State of WV

ATTACH OR PHOTOCOPY SECTION OF INVOLVED TOPOGRAPHIC MAP.

QUADRANGLE WEST UNION 7.5'

LEGEND

Well Site 

Access Road 



I N S T R U C T I O N S T O A P P L I C A N T

CONCERNING THE LINE ITEMS:

- 1) Date of Notice.
- 2) Your well name and number.
- 3) To be filled out by the Office of Oil & Gas.
- 4) & 5) Use separate sheet if necessary.
- 4) Surface owner(s) of record to be served with Notice and Application. However, see also Code § 22-4-1b(b) if "more than three tenants in common or other co-owners of interest described in subsection (a) of this section hold interests in such lands".
- 5(i) "Coal Operator" means any person, firm, partnership, partnership association or corporation that proposes to or does operate a coal mine.
- 5(ii, iii) See Code § 22-4-20.
- 6) See Code § 22-4-11(c). However, in lieu of filing the lease(s) or other continuing contract(s), the Applicant may fill out the information in the space provided below.
- 7) See Code §§ 22-4-11(d, e).

CONCERNING THE REQUIRED COPIES FOR FILING AND SERVICE:

Filing. Code § 22-4-1k and Regulation 7.02 provide that the original and required copies of the Notice and Application must be filed with the Administrator, accompanied by (i) a plat in the form prescribed by Regulation 11, (ii) a bond in one of the forms prescribed by Regulation 12, or in lieu thereof the other security allowed by Code § 22-4-1k(d) and the reclamation required by Code § 22-4-12b and Regulation 23, (iv) unless previously paid on the same well, the fees required by Code § 22-4-1a(c) and 22-3-12a, and (v) if applicable, the consent required by Code § 22-4-8a from the owner of any water well on dwelling within 200 feet of the proposed well.

Service. In addition, service must be made on the surface owner(s) and the person(s) with an interest in the coal. See Code §§ 22-4-1m, 22-4-2, 22-4-2a, and 22-4-2b.

INFORMATION SUPPLIED UNDER CODE § 22-4-11(d)
IN LIEU OF FILING LEASE(S) AND OTHER CONTINUING CONTRACT(S)

Under the oath required to make the verification on the obverse side of this Notice, I depose and say that I am the person who signed the Notice for the Applicant, and that--

- (1) the tract of land is the same tract described in the Application to which this Notice applies, partly or wholly depicted in the accompanying plat, and described in the Construction and Reclamation Plan;
- (2) the parties and recordation data (if recorded) for lease(s) or other continuing contract(s) by which the Applicant claims the right to extract, produce or market the oil or gas are as follows:

Grantor, lessor, etc.	Grantee, lessee, etc.	Royalty	Book Page
O.W. & EDITH A. GRIFFIN	J & J ENTERPRISES, $\frac{1}{8}$ INC.	100%	247/57

12/22/2023

P 574 015 741

RECEIPT FOR CERTIFIED MAIL

NO INSURANCE COVERAGE PROVIDED
NOT FOR INTERNATIONAL MAIL

(See Reverse)

★ U.S.G.P.O. 1983-403-517

PS Form 3800, Feb. 1982

Sent to O.W. & EDITH H. GRIFFIN	
Street and No. P.O. BOX 3025	
P.O., State and ZIP Code PARKERSBURG, WV 26101	
Postage	\$ 1.05
Certified Fee	.75
Special Delivery Fee	
Restricted Delivery Fee	
Return Receipt Showing to whom and Date Delivered	.60
Return receipt showing to whom, Date, and Address of Delivery,	
TOTAL Postage and Fees	\$ 2.40
Postmark or Date 	

OIL & GAS DIVISION
DEPT. OF MINES

MAY 25 1984

RECEIVED

HALLIBURTON SERVICES JOB SUMMARY

FORM 2025

HALLIBURTON
DIVISION
HALLIBURTON
LOCATION

Pittsburg, Pa
Weston, Wv

BILLED ON
TICKET NO. 802242

WELL DATA

FIELD _____ SEC. _____ TWP. _____ RNG. _____ COUNTY Tyler STATE WV

FORMATION NAME _____ TYPE _____

FORMATION THICKNESS _____ FROM _____ TO _____

INITIAL PROD: OIL _____ BPD. WATER _____ BPD.GAS _____ MCFD _____

PRESENT PROD: OIL _____ BPD. WATER _____ BPD.GAS _____ MCFD _____

COMPLETION DATE _____ MUD TYPE _____ MUD WT. _____

PACKER TYPE _____ SET AT _____

BOTTOM HOLE TEMP. _____ PRESSURE _____

MISC. DATA _____ TOTAL DEPTH 1794

	NEW USED	WEIGHT	SIZE	FROM	TO	MAXIMUM PSI ALLOWABLE
CASING	N	23	8 3/8	KB	1733	750
LINER						
TUBING						
OPEN HOLE						SHOTS/FT.
PERFORATIONS						
PERFORATIONS						
PERFORATIONS						

JOB DATA

CALLED OUT	ON LOCATION	JOB STARTED	JOB COMPLETED
DATE <u>7-31-84</u>	DATE <u>7-31-84</u>	DATE <u>7-31-84</u>	DATE <u>7-31-84</u>
TIME <u>0348</u>	TIME <u>0600</u>	TIME <u>0850</u>	TIME <u>0935</u>

PERSONNEL AND SERVICE UNITS

NAME	UNIT NO. & TYPE	LOCATION
<u>K Brown</u>	<u>94</u> <u>30507</u>	<u>Weston, Wv</u>
<u>T Thoms</u>	<u>61-6</u> <u>1185</u>	<u>"</u>
<u>J Triplett</u>	<u>TD</u> <u>3609</u>	<u>"</u>
<u>J Fisher</u>	<u>TD</u> <u>0711</u>	<u>"</u>

TOOLS AND ACCESSORIES

TYPE AND SIZE	QTY.	MAKE
FLOAT COLLAR		
FLOAT SHOE		
GUIDE SHOE <u>8 3/8</u>	<u>1 ea</u>	<u>Howco</u>
CENTRALIZERS		
BOTTOM PLUG		
TOP PLUG <u>8 3/8 Swiper</u>	<u>1</u>	<u>"</u>
HEAD <u>8 3/8 PC</u>		
PACKER		
OTHER <u>8 3/8 Cnt Basket</u>	<u>1</u>	<u>"</u>

MATERIALS

TREAT. FLUID _____ DENSITY _____ LB./GAL.-API _____

DISPL. FLUID _____ DENSITY _____ LB./GAL.-API _____

PROP. TYPE _____ SIZE _____ LB. _____

PROP. TYPE _____ SIZE _____ LB. _____

ACID TYPE _____ GAL. _____ % _____

ACID TYPE _____ GAL. _____ % _____

ACID TYPE _____ GAL. _____ % _____

SURFACTANT TYPE _____ GAL. _____ IN _____

NE AGENT TYPE _____ GAL. _____ IN _____

FLUID LOSS ADD. TYPE _____ GAL.-LB. _____ IN _____

GELLING AGENT TYPE _____ GAL.-LB. _____ IN _____

FRIC. RED. AGENT TYPE _____ GAL.-LB. _____ IN _____

BREAKER TYPE _____ GAL.-LB. _____ IN _____

BLOCKING AGENT TYPE _____ GAL.-LB. _____

PERFPAC BALLS TYPE _____ QTY. _____

OTHER _____

OTHER _____

DEPARTMENT Cement

DESCRIPTION OF JOB Cement 8 3/8 Csg

JOB DONE THRU: TUBING CASING ANNULUS TBC./ANN.

CUSTOMER REPRESENTATIVE X Danny Miller

HALLIBURTON OPERATOR KO Brown COPIES REQUESTED _____

CEMENT DATA

STAGE	NUMBER OF SACKS	TYPE	API CLASS	BRAND	BULK SACKED	ADDITIVES	YIELD CU.FT./SK.	MIXED LBS./GAL.
	<u>230</u>	<u>STD</u>	<u>A</u>	<u>Howco</u>	<u>B</u>	<u>3% Cacl 1/4" Flacke</u>	<u>118</u>	<u>15.6</u>
	<u>100</u>	<u>STD</u>	<u>A</u>	<u>"</u>	<u>B</u>	<u>3% Cacl</u>		

PRESSURES IN PSI

SUMMARY

VOLUMES

CIRCULATING _____ DISPLACEMENT _____ PRESLUSH: BBL.-GAL. _____ TYPE _____

BREAKDOWN _____ MAXIMUM _____ LOAD & BKON: BBL.-GAL. _____ PAD: BBL.-GAL. 120

AVERAGE _____ FRACTURE GRADIENT _____ TREATMENT: BBL.-GAL. _____ DISPL: BBL.-GAL. 110

SHUT-IN: INSTANT _____ 5-MIN. _____ 15-MIN. _____ CEMENT SLURRY: 80 BBL.-GAL.

HYDRAULIC HORSEPOWER _____ TOTAL VOLUME 310 BBL.-GAL.

ORDERED _____ AVAILABLE _____ USED _____ REMARKS See Job Log

AVERAGE RATES IN BPM _____

TREATING _____ DISPL. _____ OVERALL _____

CEMENT LEFT IN PIPE _____

FEET _____ REASON _____

12/22/2023

CUSTOMER

CUSTOMER
TT Enterprises
LEASE
Gallia
WELL NO. TX 991
JOB TYPE
Cmt 8 3/8 Csg
DATE 7-31-84



IV-35
(Rev 8-81)

RECEIVED
AUG 13 1984

State of West Virginia

OIL & GAS DIVISION
DEPT. OF MINES
Department of Mines
Oil and Gas Division

Date August 10, 1984
Operator's Well No. JK-991
Farm Edith Griffin
API No. 47 - 095 - 1083

WELL OPERATOR'S REPORT
OF
DRILLING, FRACTURING AND/OR STIMULATING, OR PHYSICAL CHANGE

WELL TYPE: Oil / Gas / Liquid Injection / Waste Disposal /
(If "Gas," Production / Underground Storage / Deep / Shallow /)

LOCATION: Elevation: 1127 Watershed Big Run
District: Centerville County Tyler Quadrangle West Union 7.5

COMPANY J&J Enterprises, INC.
ADDRESS P.O. Box 48, Buckhannon, WV 26201
DESIGNATED AGENT Richard Reddecliff
ADDRESS P.O. Box 48, Buckhannon, WV 26201
SURFACE OWNER O.W. Griffin
ADDRESS P.O. Box 3025, Parkersburg, WV 26101
MINERAL RIGHTS OWNER Same as surface
ADDRESS
OIL AND GAS INSPECTOR FOR THIS WORK Robert
Lowther ADDRESS Gen. Del. Middlebourne, WV
26149
PERMIT ISSUED 6/12/84
DRILLING COMMENCED 7/29/84
DRILLING COMPLETED 8/4/84

Casing & Tubing	Used in Drilling	Left in Well	Cement fill up Cu. ft.
Size 20-16 Cond.			
13-10"	32	0	0 sks.
9 5/8			
8 5/8	1718.05	1718.05	380 sks.
7			
5 1/2			
4 1/2	5986	5986	400 sks.
3			
2			
Liners used			

IF APPLICABLE: PLUGGING OF DRY HOLE ON CONTINUOUS PROGRESSION FROM DRILLING OR REWORKING. VERBAL PERMISSION OBTAINED ON

GEOLOGICAL TARGET FORMATION Alexander Depth feet
Depth of completed well 5995 feet Rotary / Cable Tools
Water strata depth: Fresh 275,700 feet; Salt 0 feet
Coal seam depths: None Is coal being mined in the area? No

OPEN FLOW DATA

Producing formation Devonian Pay zone depth 5891-5943 feet
Gas: Initial open flow Mcf/d Oil: Initial open flow Bbl/d
Combined Final open flow 866 Mcf/d Final open flow Bbl/d

Time of open flow between initial and final tests 4 hours

Static rock pressure 1800 psig (surface measurement) after 96 hours shut in
(If applicable due to multiple completion--)

Second producing formation Benson, Riley Pay zone depth 4596-4628 / 4990-98 feet

Gas: Initial open flow Mcf/d Oil: Initial open flow Bbl/d
Final open flow Mcf/d Oil: Final open flow Bbl/d

Time of open flow between initial and final tests hours

Static rock pressure psig (surface measurement) after hours shut in

(Continue on reverse side)

TYL 1083

12/22/2023

DETAILS OF PERFORATED INTERVALS, FRACTURING OR STIMULATING, PHYSICAL CHANGE, ETC.

Devonian Shale: Perforations: 5891-97(12 holes) 5940-43 (6 holes)
Fracturing: 300 sks. 20/40 sand: 375 Bbls. fluid.

Benson: Perforations: 4990-98 (16 holes) Fracturing: 4000 lbs. 20/40 sand: 450 Bbls. fluid.

Riley: Perforations: 4596-99 (4 holes) 4605.5-06.5(4 holes) 4615-17(4 holes) 4626-28 (7 holes)
Fracturing: 300 sks. 20/40 sand: 100 sks. 80/100 sand: 585 Bbls. fluid.

BOTTOM HOLE PRESSURE Pf=Pwe XGLS

$$t=60 + (0.0075 \times 5986) + 459.7 = 565 \quad X = \frac{1}{53.35} \times \frac{1}{565} = \frac{1}{30121} = 0.000033 \quad Pf = 1800 \times 2.72^{(0.000033)}$$

$$(0.742)(5247)(0.9) = 1800 \times 2.72^{0.12} = 1800 \times 1.1$$

Pf=2029 psi

WELL LOG

FORMATION	COLOR	HARD OR SOFT	TOP FEET	BOTTOM FEET	REMARKS
					Including indication of all fresh and salt water, coal, oil and gas
Red rock & shale			0	110	
Sand, red rock & shale			110	600	Damp @ 139
White sand			600	690	
Sand & shale			690	1455	1/2" stream @ 275'
Gray sand			1455	1577	1/2" stream @ 700'
Sand & shale			1577	1970	
Big Lime			1970	2045	Gas ck @ 2162 40/10-1" w/water
Big Injun			2045	2165	47,629 cu.ft.
Sand & shale			2165	4596	
Riley			4596	4628	Gas ck @ 2470 31/10-1" w/water
Sand & shale			4628	4990	43,600 cu.ft.
Benson			4990	4998	
Sand & shale			4998	5010	Gas ck @ 3637 10/10-1" w/water
Sand & shale			5010	5891	23,314 cu.ft.
Devonian Shale			5891	5943	
Sand & shale			5943	5995	Gas ck @ 4808 34/10-1" w/water
				T.D.	43,782 cu.ft.
					Gas ck @ 5023 30/1001" w/water
					41,222 cu.ft.
					Gas ck @ 5322 32/10-1" w/water
					43,600 cu.ft.

(Attach separate sheets as necessary)

J&J Enterprises, INC.

Well Operator

By:  Robert Dahlin - Geologist

12/22/2023

Date: 8/10/84

Note: Regulation 2.02(i) provides as follows:

"The term 'log' or 'well log' shall mean a systematic detailed geological record of all formations, including those encountered in the drilling of a well."

STATE OF WEST VIRGINIA
DEPARTMENT OF MINES
OIL AND GAS WELLS DIVISION

RECEIVED

AUG - 3 1984

INSPECTOR'S WELL REPORT OIL & GAS DIVISION
DEPT. OF MINES

Permit No. 095-1083

Oil or Gas Well _____
(KIND)

Company JT Enterprises
 Address Bachhannon w. Va
 Farm Criffin
 Well No. JH 991
 District Centerville County Tyler
 Drilling commenced July 30, 1984
 Drilling completed _____ Total depth 2640
 Date shot _____ Depth of shot _____
 Initial open flow _____ /10ths Water in _____ Inch
 Open flow after tubing _____ /10ths Merc. in _____ Inch
 Volume _____ Cu. Ft.
 Rock pressure _____ lbs. _____ hrs.
 Oil _____ bbls., 1st 24 hrs.
 Fresh water _____ feet _____ feet
 Salt water _____ feet _____ feet

CASING AND TUBING	USED IN DRILLING	LEFT IN WELL	PACKERS
Size			Kind of Packer _____
16			
13			Size of _____
10			
8 1/4	<u>1733</u>	<u>1733</u>	Depth set _____
6 3/4			
5 3/16			
3			Perf. top _____
2			Perf. bottom _____
Liners Used			Perf. top _____
			Perf. bottom _____

CASING CEMENTED 8 5/8 SIZE 1733 No. FT. 7-30-84 Date
 NAME OF SERVICE COMPANY Halliburton
 COAL WAS ENCOUNTERED AT _____ FEET _____ INCHES
 _____ FEET _____ INCHES FEET _____ INCHES
 _____ FEET _____ INCHES FEET _____ INCHES

Drillers' Names Tool pusher Danny Miller
S.W. Jack Rig 19

Remarks:

Aug 1, 1984
DATE

R. A. Lowther
DISTRICT WELL INSPECTOR

12/22/2023

STATE OF WEST VIRGINIA
DEPARTMENT OF MINES
OIL AND GAS WELLS DIVISION

RECEIVED

AUG - 7 1984

OIL & GAS DIVISION
DEPT. OF MINES

INSPECTOR'S WELL REPORT

Permit No. 095-1083

Oil or Gas Well _____
(KIND)

Company <u>J & J Enterprises</u>	CASING AND TUBING	USED IN DRILLING	LEFT IN WELL	PACKERS
Address <u>Buckhannon w. Va.</u>	Size			
Farm <u>Criffin</u>	16			Kind of Packer _____
Well No. <u>JH 991</u>	13			
District <u>Centerville</u> County <u>Tyler</u>	10			Size of _____
Drilling commenced _____	8 1/4			
Drilling completed <u>8-3-84</u> Total depth <u>5985</u>	6 3/4			Depth set _____
Date shot _____ Depth of shot _____	5 3/16			
Initial open flow _____ /10ths Water in _____ Inch	3			Perf. top _____
Open flow after tubing _____ /10ths Merc. in _____ Inch	2			Perf. bottom _____
Volume _____ Cu. Ft.	Liners Used _____			Perf. top _____
Rock pressure _____ lbs. _____ hrs.				Perf. bottom _____
Oil _____ bbls., 1st 24 hrs.	CASING CEMENTED _____ SIZE _____ No. FT. _____ Date _____			
Fresh water _____ feet _____ feet	NAME OF SERVICE COMPANY _____			
Salt water _____ feet _____ feet	COAL WAS ENCOUNTERED AT _____ FEET _____ INCHES			
	_____ FEET _____ INCHES _____ FEET _____ INCHES			
	_____ FEET _____ INCHES _____ FEET _____ INCHES			

Drillers' Names _____

Remarks: _____

Aug 3, 1984
DATE

R.A. Lowther
DISTRICT WELL INSPECTOR

12/22/2023



State of West Virginia
Department of Mines
Oil and Gas Division
Charleston 25305

FINAL INSPECTION REPORT
INSPECTORS COMPLIANCE REPORT
September 5, 1984

RECEIVED
JUN 5 - 1985
OIL & GAS DIVISION
DEPT. OF MINES

COMPANY J & J Enterprises, Inc.

PERMIT NO 095-1083

P. O. Box 48

FARM & WELL NO Edith Griffin #JK-991

Buckhannon, West Virginia 26201

DIST. & COUNTY Centerville/Tyler

RULE	DESCRIPTION	IN COMPLIANCE	
		YES	NO
23.06	Notification Prior to Starting Work	<input checked="" type="checkbox"/>	<input type="checkbox"/>
25.04	Prepared before Drilling to Prevent Waste	<input checked="" type="checkbox"/>	<input type="checkbox"/>
25.03	High-Pressure Drilling	<input checked="" type="checkbox"/>	<input type="checkbox"/>
16.01	Required Permits at Wellsite	<input checked="" type="checkbox"/>	<input type="checkbox"/>
15.03	Adequate Fresh Water Casing	<input checked="" type="checkbox"/>	<input type="checkbox"/>
15.02	Adequate Coal Casing	<input checked="" type="checkbox"/>	<input type="checkbox"/>
15.01	Adequate Production Casing	<input checked="" type="checkbox"/>	<input type="checkbox"/>
15.04	Adequate Cement Strenght	<input checked="" type="checkbox"/>	<input type="checkbox"/>
15.05	Cement Type	<input checked="" type="checkbox"/>	<input type="checkbox"/>
23.02	Maintained Access Roads	<input checked="" type="checkbox"/>	<input type="checkbox"/>
25.01	Necessary Equipment to Prevent Waste	<input checked="" type="checkbox"/>	<input type="checkbox"/>
23.04	Reclaimed Drilling Pits	<input checked="" type="checkbox"/>	<input type="checkbox"/>
23.05	No Surface or Underground Pollution	<input checked="" type="checkbox"/>	<input type="checkbox"/>
23.07	Requirements for Production & Gathering Pipelines	<input checked="" type="checkbox"/>	<input type="checkbox"/>
16.01	Well Records on Site	<input checked="" type="checkbox"/>	<input type="checkbox"/>
16.02	Well Records Filed	<input checked="" type="checkbox"/>	<input type="checkbox"/>
7.05	Identification Markings	<input checked="" type="checkbox"/>	<input type="checkbox"/>

I HAVE INSPECTED THE ABOVE CAPTIONED WELL AND RECOMMEND THAT IT BE RELEASED:

SIGNED R.A. Lowther

DATE May 30, 1985

Your well record was received and reclamation requirements approved. In accordance with Chapter 22, Article 4, Section 2, the above well will remain under bond coverage for the life of the well.

T.L. r. B.
Administrator-Oil & Gas Division

June 10, 1985
DATE

FERC-121

<p>1.0 API well number: (If not available, leave blank. 11 digits.)</p>	<p>47-095-1083-0000</p>			
<p>2.0 Type of determination being sought (Use the codes found on the front of this form.)</p>	<p>108 Section of NGPA</p>	<p>N/A Category Code</p>		
<p>3.0 Depth of the deepest completion location (Only show field numbers 103 or 107 in 2.0 category.)</p>	<p>5943 feet</p>			
<p>4.0 Name, address and code number of applicant (35 letters per line maximum. If code number not available, leave blank.)</p>	<p>J & J Enterprises, Inc. P.O. Box 697 Indiana Pa. 15701</p>		<p>009480 Serial Code</p>	
<p>5.0 Location of this well (Complete (a) or (b).) (a) For onshore wells (35 letters maximum for field name.)</p>	<p>Centerville Tyler WVA</p>		<p>State County</p>	
<p>(b) For OCS wells:</p>	<p>N/A</p>		<p>Block Number Date of Lease: Mo. Day Yr. OCS Lease Number</p>	
<p>(c) Name and identification number of this well (35 letters and digits maximum.)</p>	<p>JK-991</p>			
<p>(d) If code 4 or 5 in 2.0 above, name of the reservoir (35 letters maximum.)</p>	<p>N/A</p>			
<p>6.0 (a) Name and code number of the purchaser (35 letters and digits maximum. If code number not available, leave blank.)</p>	<p>Purchaser to be determined</p>			
<p>(b) Date of the contract.</p>	<p>Mo. Day Yr.</p>			
<p>(c) Estimated annual production:</p>	<p>Mbbl</p>			
	(a) Base Price (\$/MMBTU)	(b) Tax	(c) All Other Prices (Indicate (+) or (-).)	(d) Total of (a), (b) and (c)
<p>7.0 Contract price (As of filing date. Complete in 3 decimal places.)</p>	<p>4.432</p>	<p>278</p>	<p>---</p>	<p>4.710</p>
<p>8.0 Maximum lease rate (As of filing date. Complete in 3 decimal places.)</p>	<p>4.432</p>	<p>278</p>	<p>---</p>	<p>4.710</p>
<p>9.0 Person responsible for the application</p>	<p>J. H. McElwain</p>		<p>Exec.V.President</p>	
<p>Agency Use Only</p> <p>Date filed and transmitted to agency</p> <p>DEC - 9 1985</p> <p>Filed electronically for FERC</p>	<p>Name: <i>James H. McElwain</i></p> <p>Signature</p>		<p>Title</p>	
	<p>12-6-85</p>		<p>(412) 349-6000 12/22/2023</p>	
	<p>Date registration is completed</p>		<p>File # Number</p>	

DEC 30 1985

COVER SHEET, STATE APPLICATION FOR WELL CLASSIFICATION

Date: Dec 14, 1985 24150

Applicant's Name: J & J Enterprises, Inc.

Address: P. O. Box 697

Indiana, PA 15701

Gas Purchaser Contract No. _____

Date of Contract _____
(Month, day and year)

First Purchaser: Purchaser to be determined P629

Address: _____
(Street or P.O. Box)

(City) (State) (Zip Code)

FERC Seller Code 009480

AGENCY USE ONLY
WELL DETERMINATION FILE NUMBER
851209-1080-095-1083
Use Above File Number on all
Communications Relating to This Well

Designated Agent: Richard Reddecliff

Address: P. O. Box 48

Buckhannon, WVA 26201

FERC Buyer Code _____

NAME AND TITLE OF PERSON TO WHOM QUESTIONS CONCERNING THIS APPLICATION SHALL BE ADDRESSED:

Name: Vicki Vanderberg _____
(Print) (Title)

Signature: Vicki Vanderberg

Address: P. O. Box 697
(Street or P.O. Box)

Indiana PA 15701
(City) (State) (Zip Code)

Telephone: (412) 349-6800
(Area Code) (Phone Number)

(Certificate of Proof of Service to Purchaser)

NGPA Category Applied For

NGPA SECTION/SUBSECTION

- 102 New Natural Gas
- 102-2 2.5 Mile Test
- 102-3 1000 Foot Deeper Test
- 102-4 New Onshore Reservoir

- 103 New Onshore Production Well
- 103 New Onshore Production Well

- 107 High Cost Natural Gas
- 107-0 Deep (more than 15,000 feet)
- 107-1 Geopressured Brine
- 107-2 Coal Seams
- 107-3 Devonian Shale
- 107-5 Production enhancement
- 107-6 New Tight Formation
- 107-7 Recompletion Tight Formation

- 108 Stripper Well Natural Gas
- 108- Stripper Well
- 108-1 Seasonally Affected
- 108-2 Enhanced Recovery
- 108-3 Temporary Pressure Buildup

AGENCY USE ONLY
QUALIFIED

12/22/2023

RECEIVED
DEC - 6 1985

DIVISION OF OIL & GAS
DEPARTMENT OF ENERGY

Date Received

Determination Date

STATE OF WEST VIRGINIA
DEPARTMENT OF MINES, OIL AND GAS DIVISION

JK-991

WELL CLASSIFICATION FORM

STRIPPER GAS WELL

NGPA Section 108

Date: Dec 6, 1985

Operator's Well No. JK-991

API Well No. 47 - 095 - 1083
State County Permit

Well Operator: J & J Enterprises, Inc.

Address: P. O. Box 697
Indiana, PA 15701

Gas Purchaser: Purchaser to be determined

Address: _____

Designated Agent: Richard Reddecliff

Address: P.O. Box 48
Buckhannon, WVA 26201

Location: Elevation 1120

Watershed Big Run
Centerville
Dist. _____ County Tyler Quad. _____

Gas Purchase Contract No. 243250

Meter Chart Code 25280991

Date of Contract _____

All applicants must complete FERC Form 121, including question No. 2.0 which should state Section 108 of NGPA.

QUALIFICATIONS

1. Rate of Production

a.) What date did the well have first production? Aug 30, 1984

b.) What are the beginning and ending dates of the 90-day production period?

From July 1, 1985 to Sept 30, 1985. During this 90-day production period, what was the total and average per-day production? The well produced a total of 1205 MCF or average 13 MCF per day.

2. Maxium Efficient Rate of Flow

The operator must establish that the well produced at its maxium efficient rate of flow by use of one of the following procedures (Check one):

a.) If the filing date is more than one year from the date of first production, provide production on IV-39 for twelve months prior to the last day of the 90-day production period (2-1 in item 1). This twelve month period is 09 01 84 through 09 30 85 and produced a total of 4712 MCF or average 12 per day. 12/22/2023

b.) If the well does not have a 12-month history of production; but has recently

produced an average of 60 Mcf or less per production day for the 90-day period (item 1). All available months of production preceding the filing date are shown on Form IV-39.

c.) Will the maximum efficient rate of flow be established by other evidence? NO

3. Dates

a.) List the dates during the production period (including the 90-day production period) which gas was not produced. N/A

b.) Why was no gas produced on these dates? N/A

4. Crude Oil

How much oil did the well produce during the 90-day production period? NONE
How much oil per day? _____ (total bbls)

List all records reasonably available to you which contain information relevant to a determination of eligibility (including production records, B&O Tax records and royalty payment records) and indicate the location of such records.

Describe the search made of any records listed above:

AFFIDAVIT

I, James H. McElwain, having been first sworn according to law, state that I have caused to be made a diligent search of those records hereinbefore indicated in the manner herein described, that the information contained in this document is true and accurate and that on the basis of the records and examinations hereinbefore described, and to the best of my information, knowledge and belief, the well for which this certification is sought qualifies as a stripper well.

James H. McElwain

Executive Vice President

STATE OF Pennsylvania
COUNTY OF Indiana, TO-WIT:

I, Vicki L. Vanderberg, a Notary Public in and for the state and county aforesaid, do certify that James H. McElwain, whose name is signed to the writing above, bearing date the 6th day of Dec, 1985, has acknowledged the same before me, in my county aforesaid. 12/22/2023

Given under my hand and official seal this 6th day of Dec, 1985

My term of office expires on the 23 day of Jan, 1988.

Vicki L. Vanderberg
Notary Public Member, Pennsylvania Association of Notaries
VICKI L. VANDERBERG, NOTARY PUBLIC
INDIANA BOROUGH, INDIANA COUNTY
MY COMMISSION EXPIRES JAN. 23, 1988

STATE OF WEST VIRGINIA
DEPARTMENT OF MINES - OIL AND GAS DIVISION

REPORT DATE

12/6/85

REPORT OF MONTHLY PRODUCTION
GAS VOLUMES IN MCF @ 14.73
OIL IN BARRELS @ 60 DEGREES

J. & J. ENTERPRISES, INC.
P.O. BOX 697
INDIANAPOLIS, IN 46201

OPERATOR _____

YEAR 19 84

API	FARM	COUNTY	AVG. FLOW PRESSURE	SHUT-IN PRESSURE	TOTALS
GAS MCF					1351
OIL BBL	J- _____	F- _____	M- _____	J- _____	2
DAYS ON LINE					91

API	FARM	COUNTY	AVG. FLOW PRESSURE	SHUT-IN PRESSURE	TOTALS
GAS MCF	<u>461</u>	<u>291</u>	<u>476</u>	<u>66</u>	5361
OIL BBL	J- _____	F- _____	M- _____	J- _____	0
DAYS ON LINE	<u>31</u>	<u>31</u>	<u>28</u>	<u>31</u>	304

API	FARM	COUNTY	AVG. FLOW PRESSURE	SHUT-IN PRESSURE	TOTALS
GAS MCF					
OIL BBL	J- _____	F- _____	M- _____	J- _____	
DAYS ON LINE					

API NUMBERS

N/A

SUMMARIZATION SCHEDULE
Section 271.804 (b)

In accordance with Section 271.804 (b) please list all other wells which are to be used in determining this well classification under Part 271 Subpart H.

12/22/2023
JK-991

1/725'

LATITUDE 39° 22' 30"

GRIFFIN LEASE WELL NO. JK-991 88 ACRES± TOTAL

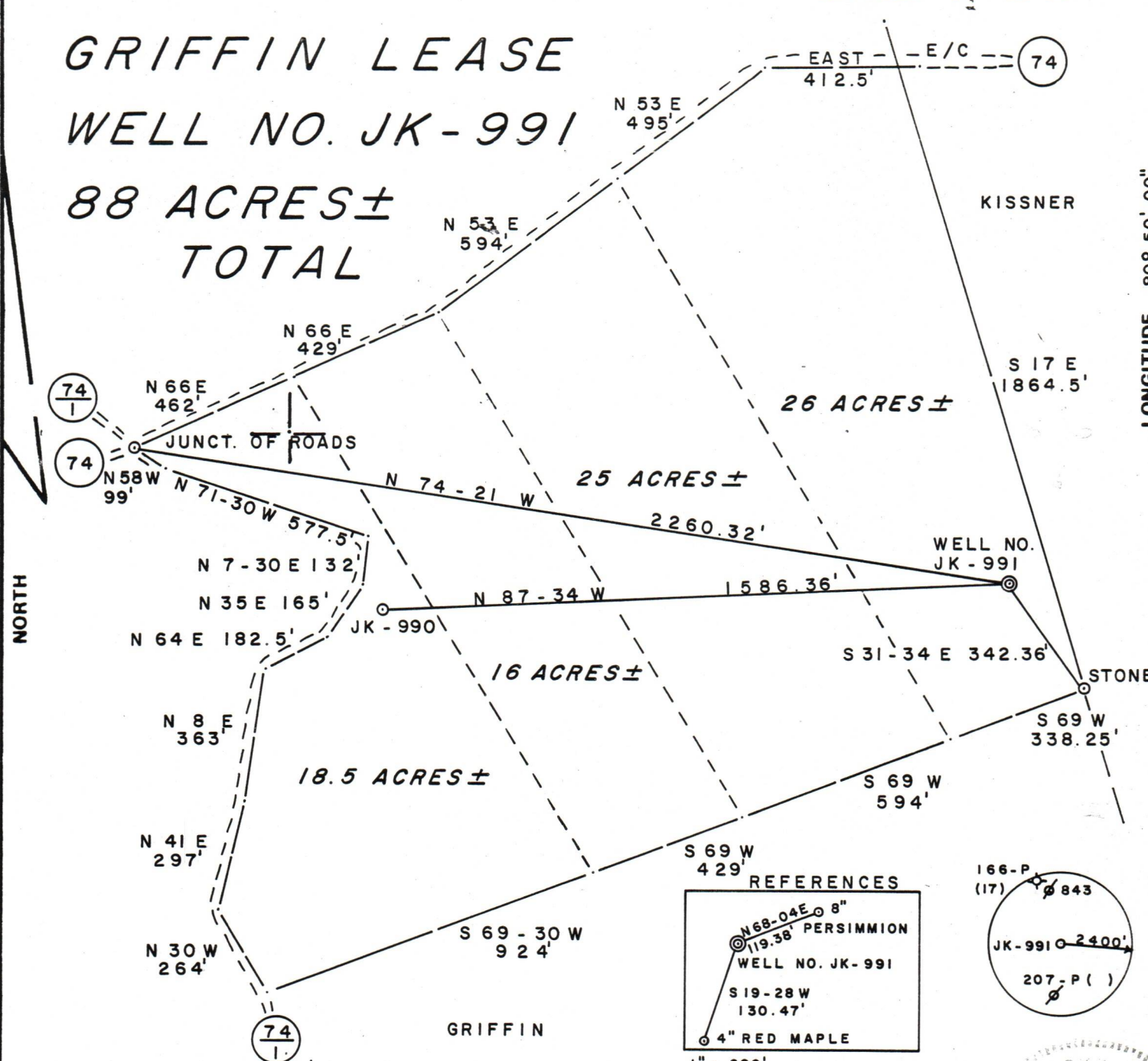

KISSNER
S 17 E
1864.5'

26 ACRES±

25 ACRES±

16 ACRES±

18.5 ACRES±

REFERENCES

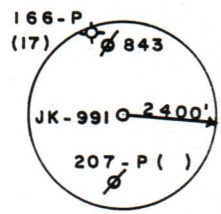
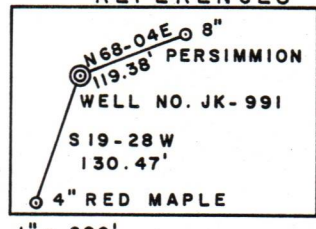

FILE NO. 13-36
 DRAWING NO. _____
 SCALE 1" = 400'
 MINIMUM DEGREE OF ACCURACY 1/200
 PROVEN SOURCE OF ELEVATION BM ELEV. 951'

I THE UNDERSIGNED, HEREBY CERTIFY THAT THIS PLAT IS CORRECT TO THE BEST OF MY KNOWLEDGE AND BELIEF AND SHOWS ALL THE INFORMATION REQUIRED BY LAW AND THE REGULATIONS ISSUED AND PRESCRIBED BY THE DEPARTMENT OF MINES.
 (SIGNED) Gregory A. Smith
 R.P.E. _____ L.L.S. 677

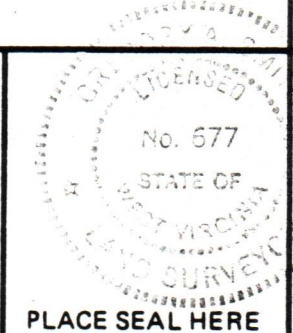

(+) DENOTES LOCATION OF WELL ON UNITED STATES TOPOGRAPHIC MAPS
 FORM IV-6 (8-78)



DATE MAY 11, 19 84
 OPERATOR'S WELL NO. JK-991
 API WELL NO. 47-095-1083
 STATE COUNTY PERMIT

STATE OF WEST VIRGINIA DEPARTMENT OF MINES OIL AND GAS DIVISION

WELL TYPE: OIL ___ GAS X LIQUID INJECTION ___ WASTE DISPOSAL ___
 (IF "GAS,") PRODUCTION X STORAGE ___ DEEP ___ SHALLOW X
 LOCATION: ELEVATION 1127' WATER SHED BIG RUN
 DISTRICT CENTERVILLE COUNTY TYLER
 QUADRANGLE WEST UNION 7.5'
 SURFACE OWNER O. W. & EDITH A. GRIFFIN ACREAGE 88
 OIL & GAS ROYALTY OWNER O. W. & EDITH A. GRIFFIN LEASE ACREAGE 88
 LEASE NO. JJ-1479
 PROPOSED WORK: DRILL X CONVERT ___ DRILL DEEPER ___ REDRILL ___ FRACTURE OR STIMULATE X PLUG OFF OLD FORMATION ___ PERFORATE NEW FORMATION ___ OTHER PHYSICAL CHANGE IN WELL (SPECIFY) _____
 PLUG AND ABANDON ___ CLEAN OUT AND REPLUG ___
 TARGET FORMATION A' XANDER ESTIMATED DEPTH 5300'
 WELL OPERATOR J & J ENTERPRISES, INC. DESIGNATED AGENT RICHARD M. REDDECLIFF
 ADDRESS P.O. BOX 48 ADDRESS P.O. BOX 48
BUCKHANNON, WV 26201 BUCKHANNON, WV 26201

12/22/2023

1) Date: MAY 23, 19 84
2) Operator's Well No. JK-991
3) API Well No. 47-095-1083
State County Permit

STATE OF WEST VIRGINIA
DEPARTMENT OF MINES, OFFICE OF OIL & GAS

NOTICE OF APPLICATION FOR A WELL WORK PERMIT

4) SURFACE OWNER(S) OF RECORD TO BE SERVED

(i) Name O.W. & EDITH GRIFFIN
Address P.O. BOX 3025
PARKERSBURG, WV 26101

(ii) Name _____
Address _____

(iii) Name _____
Address _____

5(i) COAL OPERATOR N/A
Address _____

5(ii) COAL OWNER(S) WITH DECLARATION ON RECORD:
Name same as surface
Address _____

Name _____
Address _____

5(iii) COAL LESSEE WITH DECLARATION ON RECORD:
Name N/A
Address _____

TO THE PERSON(S) NAMED ABOVE: You should have received this Form and the following documents:

- (1) The Application for a Well Work Permit on Form IV-2(B) (or Form IV-4 if the well is to be plugged, which sets out the parties involved in the drilling or other work, and describes the well and its location and, if applicable, the proposed casing and cementing program;
- (2) The plat (surveyor's map) showing the well location on Form IV-6; and
- (3) The Construction and Reclamation Plan on Form IV-9 (unless the well work is only to plug a well), which sets out the plan for erosion and sediment control and for reclamation for the site and access road.

THE REASON YOU RECEIVED THESE DOCUMENTS IS THAT YOU HAVE RIGHTS REGARDING THE APPLICATION WHICH ARE SUMMARIZED IN THE "INSTRUCTIONS" ON THE REVERSE SIDE OF THE COPY OF THE APPLICATION (FORM IV-2(B) OR FORM 4, DESIGNATED FOR YOU. HOWEVER, YOU ARE NOT REQUIRED TO TAKE ANY ACTION AT ALL.

Take notice that under Chapter 22 of the West Virginia Code, the undersigned well operator proposes to file or has filed this Notice and Application and accompanying documents for a Well Work Permit with the Administrator of the Office of Oil and Gas, West Virginia Department of Mines, with respect to a well at the location described on attached Application and depicted on attached Form IV-6. Copies of this Notice, the Application, the plat, and the Construction and Reclamation Plan have been mailed by registered or certified mail or delivered by hand to the person(s) named above (or by publication in certain circumstances) on or before the day of mailing or delivery to the Administrator.

6) EXTRACTION RIGHTS

Check and provide one of the following:

- Included is the lease or leases or other continuing contract or contracts by which I hold the right to extract oil or gas.
- The requirement of Code 22-4-1-(c) (1) through (4). (See reverse side for specifics.)

7) ROYALTY PROVISIONS

Is the right to extract, produce or market the oil or gas based upon a lease or leases or other contract or contracts providing for flat well royalty or any similar provision for compensation to the owner of the oil or gas in place which is not inherently related to the volume of oil or gas so extracted, produced or marketed? Yes No

If the answer above is No, nothing additional is needed. If the answer is Yes, you may use Affidavit Form IV-60.

See the reverse side for line item instructions, and for instructions concerning the required copies of the Notice and Application, plat, and Construction and Reclamation Plan.

The truth of the information on the Notice and Application is verified and sworn to and the Notice is signed on behalf of the Well Operator in my County and State by

RICHARD M. REDDECLIFF,
this 23 day of May, 1984.

My commission expires 12-7, 1992.

Gregory A. Smith
Notary Public, GILMER County,
State of WV

WELL

OPERATOR J & J ENTERPRISES, INC.

By [Signature]
Its DESIGNATED AGENT
Address P.O. BOX 48
BUCKHANNON, WV 26201
Telephone 472 - 9403

DEPT. OF MINES
OIL & GAS DIVISION

RECEIVED
MAY 25 1984

I N S T R U C T I O N S T O A P P L I C A N T

CONCERNING THE LINE ITEMS:

- 1) Date of Notice.
- 2) Your well name and number.
- 3) To be filled out by the Office of Oil & Gas.
- 4) & 5) Use separate sheet if necessary.
- 4) Surface owner(s) of record to be served with Notice and Application. However, see also Code § 22-4-1b(b) if "more than three tenants in common or other co-owners of interest described in subsection (a) of this section hold interests in such lands".
- 5(i) "Coal Operator" means any person, firm, partnership, partnership association or corporation that proposes to or does operate a coal mine.
- 5(ii, iii) See Code § 22-4-20.
- 6) See Code § 22-4-11(c). However, in lieu of filing the lease(s) or other continuing contract(s), the Applicant may fill out the information in the space provided below.
- 7) See Code § § 22-4-11(d, e).

CONCERNING THE REQUIRED COPIES FOR FILING AND SERVICE:

Filing. Code § 22-4-1k and Regulation 7.02 provide that the original and required copies of the Notice and Application must be filed with the Administrator, accompanied by (i) a plat in the form prescribed by Regulation 11, (ii) a bond in one of the forms prescribed by Regulation 12, or in lieu thereof the other security allowed by Code § 22-4-1k(d) and the reclamation required by Code § 22-4-12b and Regulation 23, (iv) unless previously paid on the same well, the fees required by Code § 22-4-1a(c) and 22-3-12a, and (v) if applicable, the consent required by Code § 22-4-8a from the owner of any water well on dwelling within 200 feet of the proposed well.

Service. In addition, service must be made on the surface owner(s) and the person(s) with an interest in the coal. See Code § § 22-4-1m, 22-4-2, 22-4-2a, and 22-4-2b.

INFORMATION SUPPLIED UNDER CODE § 22-4-11(d)

IN LIEU OF FILING LEASE(S) AND OTHER CONTINUING CONTRACT(S)

Under the oath required to make the verification on the obverse side of this Notice, I depose and say that I am the person who signed the Notice for the Applicant, and that--

- (1) the tract of land is the same tract described in the Application to which this Notice applies, partly or wholly depicted in the accompanying plat, and described in the Construction and Reclamation Plan;
- (2) the parties and recordation data (if recorded) for lease(s) or other continuing contract(s) by which the Applicant claims the right to extract, produce or market the oil or gas are as follows:

<u>Grantor, lessor, etc.</u>	<u>Grantee, lessee, etc.</u>	<u>Royalty</u>	<u>Book Page</u>
O.W. & EDITH A. GRIFFIN	J & J ENTERPRISES, $\frac{1}{8}$ INC.	100%	247/57

#2280



IV-9
(Rev 8-81)

DATE May 11, 1984

WELL NO. JK-991

State of West Virginia
Department of Mines
Oil and Gas Division

API NO. 47-095-1083

CONSTRUCTION AND RECLAMATION PLAN

COMPANY NAME J & J Enterprises, Inc. DESIGNATED AGENT Richard Reddcliff
Address P.O. Box 48 Buckhannon, WV 26201 Address P.O. Box 48 Buckhannon, WV 26201
Telephone 304-472-9403 Telephone 304-472-9403
LANDOWNER Edith Griffin SOIL CONS. DISTRICT Upper Ohio
Revegetation to be carried out by J & J Enterprises, Inc. (Agent)

This plan has been reviewed by Upper Ohio SCD. All corrections and additions become a part of this plan: 5/18/84 (Date)
Kenneth R. Mason (SCD Agent)

ACCESS ROAD	LOCATION
Structure <u>Drainage Ditch</u> (A)	Structure <u>Diversion Ditch</u> (1)
Spacing <u>To be constructed along road</u>	Material <u>Soil</u>
Page Ref. Manual <u>2-12</u>	Page Ref. Manual <u>2-12</u>
Structure <u>Road Culvert</u> (B)	Structure <u>Rip-Rap</u> (2)
Spacing <u>Min. size 15"</u>	Material <u>Logs or brush</u> <i>50' x 2'</i>
Page Ref. Manual <u>2-7</u>	Page Ref. Manual <u>N/A</u>
Structure <u>Cross Drain</u> (C)	Structure <u></u> (3)
Spacing <u>40'-250' apart depending upon grade</u>	Material <u></u>
Page Ref. Manual <u>2-1</u>	Page Ref. Manual <u></u>

All structures should be inspected regularly and repaired if necessary. All commercial timber is to be cut and stacked and all brush and small timber to be cut and removed from the site before dirt work begins.

REVEGETATION

Treatment Area I	Treatment Area II
Lime <u>3 Tons/acre</u> or correct to pH <u>6.5</u>	Lime <u>3 Tons/acre</u> or correct to pH <u>6.5</u>
Fertilizer <u>600 lbs/acre</u> (10-20-20 or equivalent)	Fertilizer <u>600 lbs/acre</u> (10-20-20 or equivalent)
Mulch <u>Hay 2 Tons/acre</u>	Mulch <u>Hay 3 Tons/acre</u>
Seed* <u>KY-31 30 lbs/acre</u>	Seed* <u>Orchard Grass 30 lbs/acre</u>
<u>Annual Rye 10 lbs/acre</u>	<u>Ladino Clover 5 lbs/acre</u>
<u>Red Clover 5 lbs/acre</u>	<u>Red Clover 5 lbs/acre</u>

*Inoculate all legumes such as vetch, trefoil and clovers with the proper bacterium. Inoculate with 3X recommended amount.

PLAN PREPARED BY Smith Land Surveying Co. 12/22/2023
ADDRESS 111 South Street
Glenville, WV 26351
PHONE NO. 304-462-5634

NOTES: Please request landowner's cooperation to protect new seedling for one growing season. Attach separate sheets as necessary for comments.

RECEIVED
MAY 25 1984
OIL & GAS DIVISION
DEPT. OF MINES

ATTACH OR PHOTOCOPY SECTION OF INVOLVED TOPOGRAPHIC MAP. QUADRANGLE WEST UNION 7.5'

LEGEND

Well Site 



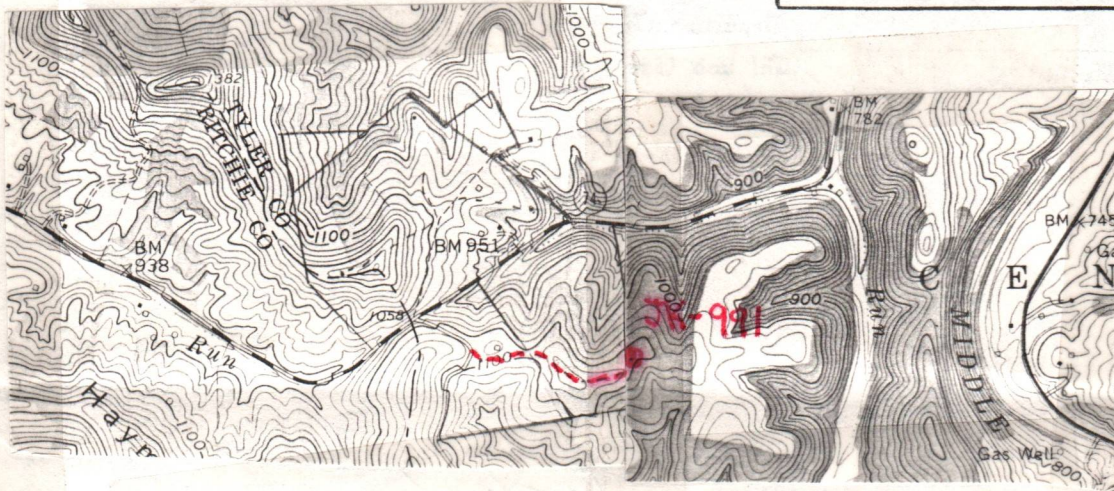





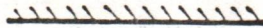

Access Road 



WELL SITE PLAN

Sketch to include well location, existing access road, roads to be constructed, well site, drilling pits and necessary structures numbered or lettered to correspond with the first part of this plan. Include all natural drainage.

LEGEND

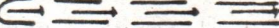
Property boundary 	Diversion 
Road 	Spring 
Existing fence 	Wet spot 
Planned fence 	Building 
Stream 	Drain pipe 
Open ditch 	Waterway 

Access road subject to change between company and land owner, or aquirement of right-of-way. If change is made, a revised reclamation plan will be submitted. All cuts 2:1 slope. All topsoil to be stockpiled and used in reclamation. All grades for roads and locations as well as sediment structures shown on drawing.

