

Janie 9/13/90

10,475'

LATITUDE 39° 25' 00"

WELL REFERENCES:
N61°45'E, 158.50' TO 10" C. OAK
N89°30'E, 137' TO 10" POPLAR

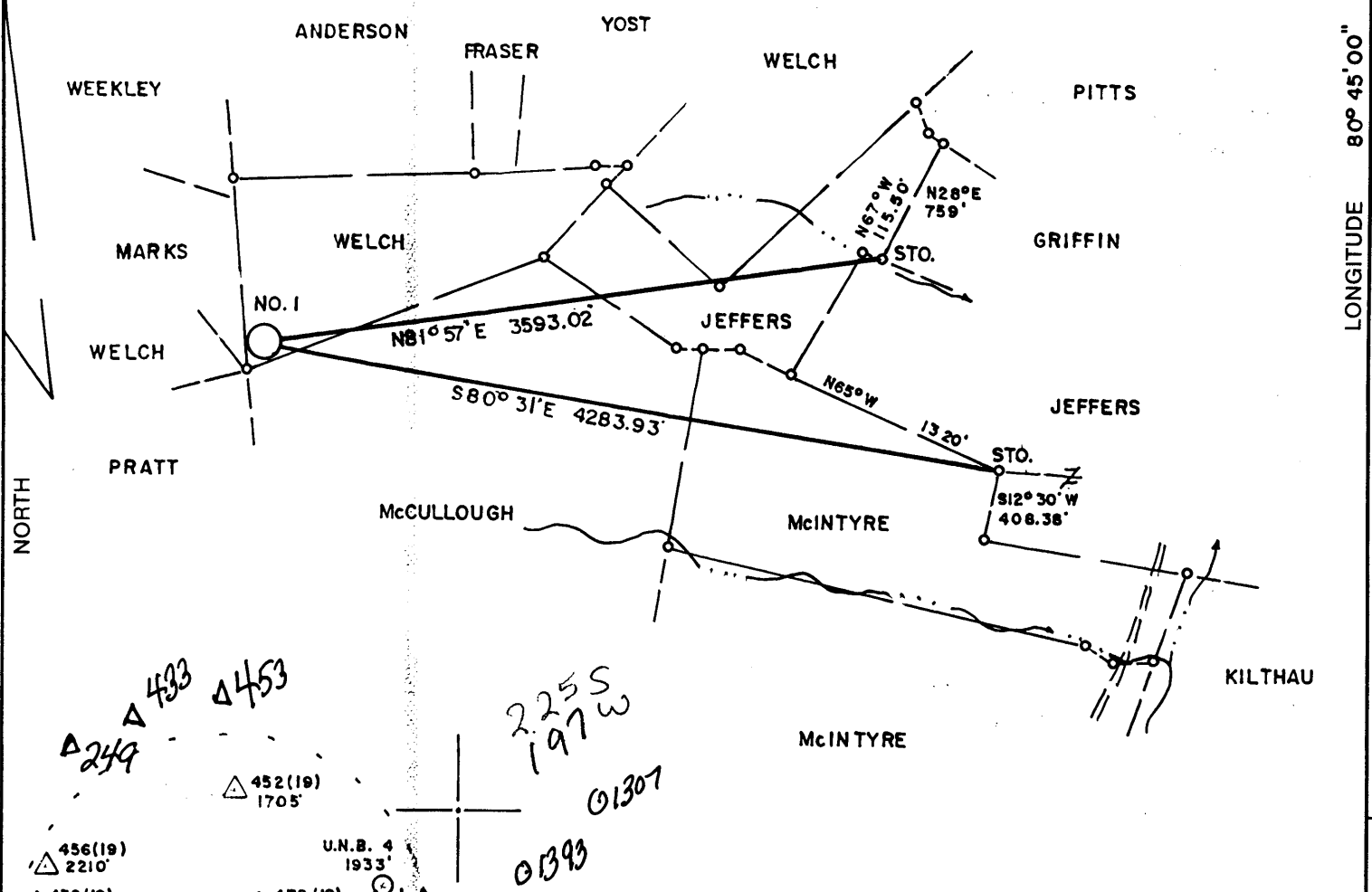

LONGITUDE 80° 45' 00" 12,000'

NORTH

NOTE: CALL BETWEEN STONES IS
N28°55'W, 1380.69

LAND SURVEYING SERVICES
21 CEDAR LANE
BRIDGEPORT, WV 26330
PHONE: 304-842-2018

(+) DENOTES LOCATION OF WELL ON UNITED STATES TOPOGRAPHIC MAPS

FILE NO. _____
 DRAWING NO. _____
 SCALE 1" = 1000'
 MINIMUM DEGREE OF ACCURACY 1 in 200
 PROVEN SOURCE OF ELEVATION RD. INTER. 5450' S.E. OF LOCATION ELEV. 812'

I THE UNDERSIGNED, HEREBY CERTIFY THAT THIS PLAT IS CORRECT TO THE BEST OF MY KNOWLEDGE AND BELIEF AND SHOWS ALL THE INFORMATION REQUIRED BY LAW AND THE REGULATIONS ISSUED AND PRESCRIBED BY THE DEPARTMENT OF ENERGY.

(SIGNED) Stephen D. Losh
 R.P.E. _____ L.L.S. 674
 STEPHEN D. LOSH

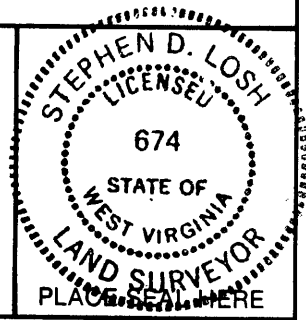

STATE OF WEST VIRGINIA
 DEPARTMENT OF ENERGY
 OIL AND GAS DIVISION



DATE MARCH 26, 1990
 OPERATOR'S WELL NO. DAVIS NO. 1
 API WELL NO.

WELL TYPE: OIL ___ GAS ___ LIQUID INJECTION ___ WASTE DISPOSAL ___
 (IF "GAS,") PRODUCTION ___ STORAGE ___ DEEP ___ SHALLOW ___

LOCATION: ELEVATION 1182' WATER SHED PRATT RUN
 DISTRICT Mc ELROY 5 COUNTY TYLER
 QUADRANGLE SHIRLEY 7.5 min. W. Union

SURFACE OWNER N. M. WELCH ACREAGE 38.50
 OIL & GAS ROYALTY OWNER FANNY DAVIS LEASE ACREAGE 38.50
 LEASE NO. _____

PROPOSED WORK: DRILL CONVERT ___ DRILL DEEPER ___ REDRILL ___ FRACTURE OR
 STIMULATE ___ PLUG OFF OLD FORMATION ___ PERFORATE NEW
 FORMATION ___ OTHER PHYSICAL CHANGE IN WELL (SPECIFY) _____

PLUG AND ABANDON ___ CLEAN OUT AND REPLUG ___
 TARGET FORMATION BENSON ESTIMATED DEPTH 5500'
 WELL OPERATOR STONEWALL GAS COMPANY DESIGNATED AGENT JESSIE SHELL
 ADDRESS P. O. DRAWER R 847 ADDRESS P. O. DRAWER R
 JANE LEW, WV 26378 JANE LEW, WV 26378

SEP 24 1990

G-b Wilbur

(092)

FORM WW-6 HALLS, INC. 068055

COUNTY NAME PERMIT

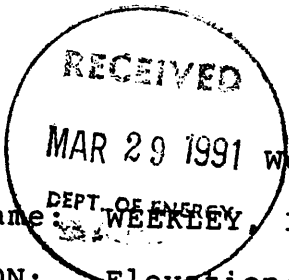

State of West Virginia
DEPARTMENT OF ENERGY
Division of Oil and Gas

Well Operator's Report of Well Work

Farm name: WEEKLEY, ISIAIAH

Operator Well No.: DAVIS 1-440-S

LOCATION: Elevation: 1182.00 Quadrangle: SHIRLEY

District: MCELROY County: TYLER
Latitude: 12000 Feet South of 39 Deg. 25Min. 0 Sec.
Longitude: 10475 Feet West of 80 Deg. 45 Min. 0 Sec.

Company: STONEWALL GAS COMPANY
909 E. MAIN ST. P.O. BOX 1575
RICHMOND, VA 23219-1575

Casing & Tubing Size	Used in Drilling	Left in Well	Cement Fill Up Cu. Ft.
11 3/4	213	213	115 SKS
8 5/8	2360	2360	670 SKS
4 1/2	5271	5271	585 SKS

Agent: JESSE A. SHELL

Inspector: GLEN P. ROBINSON
Permit Issued: 09/21/90
Well work Commenced: 02-01-91
Well work Completed: 02-08-91
Verbal Plugging
Permission granted on: _____
Rotary X Cable _____ Rig
Total Depth (feet) 5300
Fresh water depths (ft) 50'
Salt water depths (ft) _____
585
Is coal being mined in area (Y/N) NO
Coal Depths (ft): 917

OPEN FLOW DATA

Producing formation BENSON/RILEY Pay zone depth (ft) 5183/4745
Gas: Initial open flow 25 MCF/d Oil: Initial open flow 0 Bbl/d
Final open flow 3503 MCF/d Final open flow 0 Bbl/d
Time of open flow between initial and final tests 1 Hours
Static rock Pressure 1600 psig (surface pressure) after 168 Hours

Second producing formation _____ Pay zone depth (ft) _____
Gas: Initial open flow _____ MCF/d Oil: Initial open flow _____ Bbl/d
Final open flow _____ MCF/d Final open flow _____ Bbl/d
Time of open flow between initial and final tests _____ Hours
Static rock Pressure _____ psig (surface pressure) after _____ Hours

NOTE: ON BACK OF THIS FORM PUT THE FOLLOWING: 1). DETAILS OF PERFORATED INTERVALS, FRACTURING OR STIMULATING, PHYSICAL CHANGE, ETC. 2). THE WELL LOG WHICH IS A SYSTEMATIC DETAILED GEOLOGICAL RECORD OF ALL FORMATIONS, INCLUDING COAL ENCOUNTERED BY THE WELLBORE.

For: STONEWALL GAS COMPANY

By: [Signature]
Date: MARCH 26, 91

RAY M. FREAR, JR.
PETROLEUM ENGINEER

APR 12 1991

2	STAGE	FRAC	WATER	DATE	02-20-91		
ZONES	PERFS	HOLES		BBL	BP	ISIP	
BENSON/RILEY	5183-5187/4745-4750	12/6	800	1580	1620		
GORDON	2871-2875	16	500	1930	1900		

FORMATION	COLOR	HARD/SOFT	TOP	BOTTOM	REMARKS
FILL	BROWN	SOFT	0	6	DAMP @ 50'
SAND	BROWN	SOFT	6	9	
RR & SHALE	GRAY	SOFT	9	75	HOLE DAMP @ 585'
SAND & SHALE	GRAY	HARD	75	515	
SAND	BROWN	HARD	515	540	GAS CK 2144 NO SHOW
SHALE	GRAY	HARD	540	580	GAS CK 2174 12/10 2" W/M
SAND	BROWN	HARD	580	625	GAS CK 2205 12/10 2" W/M
SAND & SHALE	BROWN	SOFT	625	838	GAS CK 2237 12/10 2" W/M
SAND	GRAY	SOFT	838	865	GAS CK 2359 20/10 2" W/M
SAND & SHALE	GRAY	SOFT	865	917	
COAL	BLACK	SOFT	917	920	GAS CK 2981 N/S (ODOR)
SAND & SHALE	GRAY	HARD	920	1110	
SAND	GRAY	HARD	1110	1125	GAS CK 3822 NO SHOW
SAND & SHALE	GRAY	HARD	1125	1590	GAS CK 4757 N/S
RR & SHALE	BROWN	SOFT	1590	1620	GAS CK 5189 6/10 1" W/W
SAND & SHALE	BROWN	SOFT	1620	1940	GAS CK TD 6/10 1" W/W
LITTLE LIME	BROWN	SOFT	1940	2070	
BIG LIME	GRAY	HARD	2070	2148	
BIG INJUN	GRAY	HARD	2148	2330	
SAND & SHALE	GRAY	SOFT	2330	2875	
GORDON	GRAY	SOFT	2875	2950	
SAND & SHALE	BROWN	SOFT	2950	4710	
RILEY	GRAY	HARD	4710	4775	
SAND & SHALE	GRAY	HARD	4775	5170	
BENSON	GRAY	HARD	5170	5180	
SAND & SHALE	BROWN	SOFT	5180	5300	
TD				5300	

NO GAS WAS FOUND IN GORDON THEREFORE, IT WAS SQUEEZED, CEMENTED AND ABANDONED.

11230

STATE OF WEST VIRGINIA
DEPARTMENT OF ENERGY, DIVISION OF OIL AND GAS
WELL WORK PERMIT APPLICATION

- 1) Well Operator: ⁸⁴⁷ STONEWALL GAS COMPANY 47850 (5) 606
- 2) Operator's Well Number: DAVIS #1
- 3) Elevation: 1182'
- 4) Well type: (a) Oil ___ / or Gas X /
(b) If Gas: Production ___ / Underground Storage ___ /
Deep ___ / Shallow X /
- 5) Proposed Target Formation(s): BENSON 435
- 6) Proposed Total Depth: 5250' feet
- 7) Approximate fresh water strata depths: 70'
- 8) Approximate salt water depths: 220' & 465'
- 9) Approximate coal seam depths: 320'
- 10) Does land contain coal seams tributary to active mine? Yes ___ / No X /
- 11) Proposed Well Work: DRILL & STIMULATE *New Well*
- 12)

RECEIVED
Division of Energy
SEPT 05 1990
Permitting
Oil and Gas Section

CASING AND TUBING PROGRAM

TYPE	SPECIFICATIONS			FOOTAGE INTERVALS		CEMENT
	Size	Grade	Weight per ft.	For drilling	Left in well	Fill-up (cu. ft.)
<i>4/19/90</i> Conductor	11 3/4"		28#	100'	100 CTS	38 CSR 18-11.3
Fresh Water						
Coal						
Intermediate	8 5/8"		20#	1300'	1300 CTS	38 CSR 18-11.2.2
Production	4 1/2"		10.5#	5200'	5200	38 CSR 18-11.1
Tubing						
Liners						

PACKERS : Kind _____
Sizes _____
Depths set _____

For Division of Oil and Gas Use Only

Fee(s) paid: Well Work Permit Reclamation Fund WPCP
 Plat WW-9 WW-2B Bond CID Blanket Agent

*6944
25*

RECEIVED

Division of Energy

SEP 0 5 90

Permitting
Oil and Gas Section

Page 1 of _____
Form WW2-A
(09/87)
File Copy

1) Date: JULY 10, 1990
2) Operator's well number
DAVIS #1 440-S
3) API Well No: 47 - 095 - 1430
State - County - Permit

STATE OF WEST VIRGINIA
DEPARTMENT OF ENERGY, DIVISION OF OIL AND GAS

NOTICE AND APPLICATION FOR A WELL WORK PERMIT

- 4) Surface Owner(s) to be served:
- (a) Name ISAIAH WEEKLEY HRS.
Address C/O DALE B. HUSK
5511 GLOUCESTER ST., CHURCHTON, MD
 - (b) Name 20733
Address N.M. WELCH
C/O MARY M. WELCH, ADM.
 - (c) Name PO BOX 4308
Address PARKERSBURG, WV 26101
- 5) (a) Coal Operator:
Name N/A
Address _____
- (b) Coal Owner(s) with Declaration
Name SAME AS SURFACE
Address _____
- Name _____
Address _____
- (c) Coal Lessee with Declaration
Name N/A
Address _____
- 6) Inspector GLEN ROBINSON
Address RT 1, #6 MT. PLEASANT EST.
MINERAL WELLS, WV 26150
Telephone (304)-489-2736

TO THE PERSON(S) NAMED ABOVE TAKE NOTICE THAT:

_____ Included is the lease or leases or other continuing contract or contracts by which I hold the right to extract oil and gas OR

X Included is the information required by Chapter 22B, Article 1, Section 8(d) of the Code of West Virginia (see page 2)

I certify that as required under Chapter 22B of the West Virginia Code I have served copies of this notice and application, a location plat, and accompanying documents pages 1 through _____ on the above named parties, by:

- _____ Personal Service (Affidavit attached)
- X Certified Mail (Postmarked postal receipt attached)
- _____ Publication (Notice of Publication attached)

I have read and understand Chapter 22B and 38 CSR 11-18, and I agree to the terms and conditions of any permit issued under this application.

I certify under penalty of law that I have personally examined and am familiar with the information submitted on this application form and all attachments, and that based on my inquiry of those individuals immediately responsible for obtaining the information, I believe that the information is true, accurate, and complete.

I am aware that there are significant penalties for submitting false information, including the possibility of fine and imprisonment.

Well Operator STONEWALL GAS COMPANY
By: [Signature]
Its: PRESIDENT
Address PO DRAWER R
JANE LEW, WV 26378
Telephone 304-884-7881

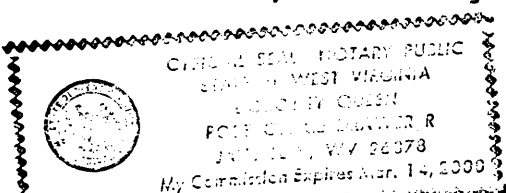

Subscribed and sworn before me this 10TH day of JULY, 1990

[Signature] Notary Public
My commission expires MARCH 14, 2000