

95 01796P

WW-7
8-30-06



West Virginia Department of Environmental Protection
Office of Oil and Gas

WELL LOCATION FORM: GPS

API: 47-095-01796 WELL NO.: 9

FARM NAME: J.Q. McIntyre

RESPONSIBLE PARTY NAME: Ascent Resources - Marcellus LLC

COUNTY: Tyler DISTRICT: McElroy

QUADRANGLE: Center Point

SURFACE OWNER: Gerald and Anne Sizemore

ROYALTY OWNER: Ascent Resources - Marcellus LLC

UTM GPS NORTHING: 4365795.6

UTM GPS EASTING: 526719.4 GPS ELEVATION: 1010'

The Responsible Party named above has chosen to submit GPS coordinates in lieu of preparing a new well location plat for a plugging permit or assigned API number on the above well. The Office of Oil and Gas will not accept GPS coordinates that do not meet the following requirements:

1. Datum: NAD 1983, Zone: 17 North, Coordinate Units: meters, Altitude: height above mean sea level (MSL) – meters.
2. Accuracy to Datum – 3.05 meters
3. Data Collection Method:

Survey grade GPS : Post Processed Differential

Real-Time Differential

Mapping Grade GPS : Post Processed Differential

Real-Time Differential

RECEIVED
Office of Oil and Gas

SEP 15 2017

WV Department of
Environmental Protection

4. **Letter size copy of the topography map showing the well location.**

I the undersigned, hereby certify this data is correct to the best of my knowledge and belief and shows all the information required by law and the regulations issued and prescribed by the Office of Oil and Gas.

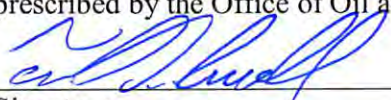
Signature

Sr. Regulatory Analyst
Title

8/29/2017
Date

10/06/2017

SEP 15 2017

WV Department of
Environmental Protection

Ascent Resources— Marcellus LLC.

Proposed Plugging of J.Q. McIntyre No.9 (095-01796) McElroy District Tyler County, WV

TOP HOLE (NAD 83)
N) 345070.28
E) 1632575.43
LAT.) 39°26'28.7"
LONG.) 80°41'22.2"
DEC. LAT.) 39.441297
DEC. LONG.) 80.689495

TOP HOLE (NAD 27)
N) 345034.18
E) 1664016.33
LAT.) 39°26'28.4"
LONG.) 80°41'22.8"
DEC. LAT.) 39.441214
DEC. LONG.) 80.689672

TOP HOLE (UTM NAD 83)
N) 4365795.6
E) 526719.4

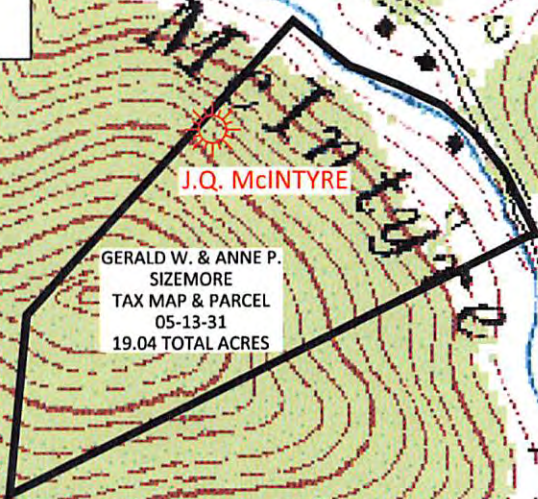

PRELIMINARY

BOORD, BENCHEK and ASSOC., INC.
Engineering, Surveying, Construction,
and Mining Services
Southpointe, PA 15317 Phone: 724-746-1055

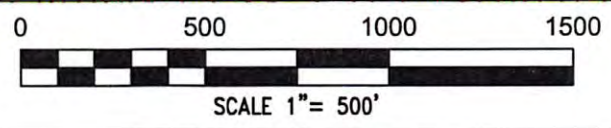

JULY 27, 2017