

State of West Virginia  
Department of Environmental Protection - Office of Oil and Gas  
Well Operator's Report of Well Work

API 47-095-02140 County Tyler District McElroy  
Quad Center Point Pad Name Bashful Field/Pool Name \_\_\_\_\_  
Farm name Rodney & Vickie Tippins Well Number Bashful 2  
Operator (as registered with the OOG) Jay-Bee Oil & Gas, Inc.  
Address 3570 Shields Hill Rd. City Cairo State WV Zip 26337

As Drilled location NAD 83/UTM Attach an as-drilled plat, profile view, and deviation survey  
Top hole Northing 4,369,319.265 Easting 524,005.638  
Landing Point of Curve Northing N/A Easting N/A  
Bottom Hole Northing 4,371,614.919 Easting 523,274.301

Elevation (ft) 1,201.6' GL Type of Well  New  Existing Type of Report  Interim  Final  
Permit Type  Deviated  Horizontal  Horizontal 6A  Vertical Depth Type  Deep  Shallow  
Type of Operation  Convert  Deepen  Drill  Plug Back  Redrilling  Rework  Stimulate  
Well Type  Brine Disposal  CBM  Gas  Oil  Secondary Recovery  Solution Mining  Storage  Other \_\_\_\_\_  
Type of Completion  Single  Multiple Fluids Produced  Brine  Gas  NGL  Oil  Other \_\_\_\_\_  
Drilled with  Cable  Rotary

Drilling Media Surface hole  Air  Mud  Fresh Water Intermediate hole  Air  Mud  Fresh Water  Brine  
Production hole  Air  Mud  Fresh Water  Brine  
Mud Type(s) and Additive(s)  
ABS 40

Date permit issued 2/14/2014 Date drilling commenced 5/29/2014 Date drilling completed 5/28/2014  
Date completion activities began 11/1/2014 Date completion activities ceased \_\_\_\_\_  
Verbal plugging (Y/N) N Date permission granted N/A Granted by N/A

Please note: Operator is required to submit a plugging application within 5 days of verbal permission to plug  
Freshwater depth(s) ft 75' Open mine(s) (Y/N) depths \_\_\_\_\_  
Salt water depth(s) ft N/A Void(s) encountered (Y/N) depths N  
Coal depth(s) ft N/A Cavern(s) encountered (Y/N) depths N  
Is coal being mined in area (Y/N) N

**RECEIVED**  
**Office of Oil and Gas**  
**MAR 21 2016**  
**WV Department of Environmental Protection**  
Reviewed by: \_\_\_\_\_  
**APPROVED**  
NAME: \_\_\_\_\_  
DATE: 9/8/16 **10/28/2016**

API 47-095 02140

Farm name Rodney & Vickie Tippins

Well number Bashful 2

CASING STRINGS	Hole Size	Casing Size	Depth	New or Used	Grade wt/ft	Basket Depth(s)	Did cement circulate (Y/N) * Provide details below*
Conductor	17"	16"	30'	New	20/32/24		Y
Surface	15"	11 3/4"	400'	New	20/23/24	50'	Y
Coal							
Intermediate 1	11"	8 5/8"	2,443'	New	20/17/24	1500'	Y
Intermediate 2							
Intermediate 3							
Production	7 7/8"	5 1/2"	14,517'	New	20#		Y
Tubing							
Packer type and depth set							

Comment Details

CEMENT DATA	Class/Type of Cement	Number of Sacks	Slurry wt (ppg)	Yield (ft <sup>3</sup> /sks)	Volume (ft <sup>3</sup> )	Cement Top (MD)	WOC (hrs)
Conductor							
Surface	Class A	230	15.2	1.26	190	CTS	8
Coal							
Intermediate 1	Class A	590	14.7	1.36	617	CTS	8
Intermediate 2							
Intermediate 3							
Production	Class A	1,849	14.4	1.32	2,440.98	428' from surface	8
Tubing							

Drillers TD (ft) 14,517'

Loggers TD (ft) 14,517'

Deepest formation penetrated Marcellus

Plug back to (ft) N/A

Plug back procedure N/A

Kick off depth (ft) 8,250'

Check all wireline logs run

- caliper     density     deviated/directional     induction  
 neutron     resistivity     gamma ray     temperature     sonic

Well cored  Yes  No

Conventional    Sidewall

Were cuttings collected  Yes  No

DESCRIBE THE CENTRALIZER PLACEMENT USED FOR EACH CASING STRING

Spiral centralizer every 100' from TD back to start of

90 degree.

90 - 70 degree every second joint.

70 degree - KOP every third joint.

KOP - Surface centralizer placed every 500'.

WAS WELL COMPLETED AS SHOT HOLE  Yes  No    DETAILS

WAS WELL COMPLETED OPEN HOLE?  Yes  No    DETAILS

WERE TRACERS USED  Yes  No    TYPE OF TRACER(S) USED

**Office of Oil and Gas**  
**MAR 21 2016**  
**WV Department of Environmental Protection**

API 47- 095 - 02140

Farm name Rodney & Vickie Tippins

Well number Bashful 2

PERFORATION RECORD

Stage No.	Perforation date	Perforated from MD ft.	Perforated to MD ft.	Number of Perforations	Formation(s)
1	11/1/14	14505	14368	96	Marcellus
2	11/18/14	14320	14172	72	Marcellus
3	11/19/14	14138	13980	72	Marcellus
4	11/19/14	13926	13756	72	Marcellus
5	11/19/14	13723	13564	72	Marcellus
6	11/20/14	13520	13360	72	Marcellus
7	11/20/14	13318	13121	72	Marcellus
8	11/21/14	13086	12946	72	Marcellus
9	11/21/14	12905	12720	72	Marcellus
10	11/22/14	12688	12648	72	Marcellus
11	11/22/14	12497	12291	72	Marcellus
12	11/22/14	12258	12104	72	Marcellus
13	11/23/14	12072	11892	72	Marcellus
14	11/23/14	11832	11672	72	Marcellus
15	11/24/14	11631	11478	72	Marcellus
16	11/24/14	11442	11325	72	Marcellus

Please insert additional pages as applicable.

STIMULATION INFORMATION PER STAGE

Complete a separate record for each stimulation stage.

Stage No.	Stimulations Date	Ave Pump Rate (BPM)	Ave Treatment Pressure (PSI)	Max Breakdown Pressure (PSI)	ISIP (PSI)	Amount of Proppant (lbs)	Amount of Water (bbls)	Amount of Nitrogen/other (units)
1	11/17/14	67.3	7125	7998	4887	178132	10547	N/A
2	11/18/14	70.9	6982	7896	4772	182915	9199	N/A
3	11/19/14	70.6	7225	8050	4686	179715	11431	N/A
4	11/19/14	70.1	6792	7281	4954	182731	6688	N/A
5	11/19/14	71.7	6885	7822	4363	180486	6751	N/A
6	11/20/14	70.7	6992	8122	4510	180296	6582	N/A
7	11/20/14	71.8	6763	7929	4636	180467	6680	N/A
8	11/21/14	71.4	6373	7807	4571	180522	6373	N/A
9	11/21/14	70.6	7079	7730	5034	170998	6699	N/A
10	11/22/14	67.2	7071	7908	4310	181218	7023	N/A
11	11/22/14	70.3	6934	7863	4985	181207	6522	N/A
12	11/22/14	70.1	6776	7237	4506	181462	6865	N/A
13	11/23/14	70.1	6945	7455	3873	181780	6445	N/A
14	11/23/14	70.2	6711	7361	4185	180556	6699	N/A
15	11/24/14	70.6	6703	7641	4659	180348	6040	N/A
16	11/24/14	70.1	6898	7483	4701	181084	6206	N/A

Please insert additional pages as applicable.

10/28/2016

API 47- 095 - 02140 Farm name Rodney & Vickie Tippins Well number Bashful 2

PERFORATION RECORD

Stage No.	Perforation date	Perforated from MD ft.	Perforated to MD ft.	Number of Perforations	Formation(s)
17	11/24/14	11262	11103	72	Marcellus
18	11/25/14	11059	10916	72	Marcellus
19	12/1/14	10874	10727	72	Marcellus
20	12/1/14	10665	10484	72	Marcellus
21	12/1/14	10424	10248	72	Marcellus
22	12/2/14	10196	10072	72	Marcellus
23	12/4/14	10020	9841	72	Marcellus
24	12/4/14	9804	9638	72	Marcellus
25	12/5/14	9574	9416	72	Marcellus
26	12/5/14	9364	9208	72	Marcellus
27	12/5/14	9160	9011	72	Marcellus
28	12/6/14	8968	8812	72	Marcellus
29	12/6/14	8774	8596	72	Marcellus
30	12/6/14	8536	8372	72	Marcellus
31	12/7/14	8313	8164	72	Marcellus
32	12/7/14	8124	7972	72	Marcellus

Please insert additional pages as applicable.

STIMULATION INFORMATION PER STAGE

Complete a separate record for each stimulation stage.

Stage No.	Stimulations Date	Ave Pump Rate (BPM)	Ave Treatment Pressure (PSI)	Max Breakdown Pressure (PSI)	ISIP (PSI)	Amount of Proppant (lbs)	Amount of Water (bbls)	Amount of Nitrogen/other (units)
17	11/24/14	70.5	6789	7859	4789	181959	6051	N/A
18	11/25/14	70.1	6672	8095	4502	170813	5905	N/A
19	12/1/14	69.8	8001	8217	5225	180000	6504	N/A
20	12/1/14	70.1	6525	7750	4116	180679	6174	N/A
21	12/1/14	69.9	6611	7409	4748	172469	7095	N/A
22	12/2/14	69.5	6653	7707	5130	180708	7242	N/A
23	12/4/14	69.7	7062	7962	4530	174079	7946	N/A
24	12/4/14	69.4	6491	7249	4275	181263	7501	N/A
25	12/5/14	69.4	6616	7242	4436	178842	8422	N/A
26	12/5/14	68.2	6446	6693	5160	181056	6748	N/A
27	12/5/14	68.8	6388	6851	5332	181255	7685	N/A
28	12/6/14	68.2	6426	6769	5275	179883	6515	N/A
29	12/6/14	69.8	6309	6679	4741	180616	7523	N/A
30	12/6/14	66.9	6385	7150	4632	180301	6561	N/A
31	12/7/14	66.7	6409	7300	4277	180087	6335	N/A
32	12/7/14	69.8	6457	6962	4589	179978	6457	N/A

Please insert additional pages as applicable.

10/28/2016

RECEIVED  
Office of Oil and Gas  
MAR 27 2016  
WV Department of Environmental Protection

API 47- 095 - 02140

Farm name Tippins

Well number Bashful 2

PERFORATION RECORD

Stage No.	Perforation date	Perforated from MD ft.	Perforated to MD ft.	Number of Perforations	Formation(s)
33	12/7/14	7933	7753	72	Marcellus
34	12/7/14	7710	7566	72	Marcellus

Please insert additional pages as applicable.

STIMULATION INFORMATION PER STAGE

Complete a separate record for each stimulation stage.

Stage No.	Stimulations Date	Ave Pump Rate (BPM)	Ave Treatment Pressure (PSI)	Max Breakdown Pressure (PSI)	ISIP (PSI)	Amount of Proppant (lbs)	Amount of Water (bbls)	Amount of Nitrogen/other (units)
33	12/7/14	70.6	6605	7482	4688	179945	6277	N/A
34	12/7/14	68.6	6390	7393	4506	180683	6227	N/A

RECEIVED  
Office of Oil and Gas  
MAR 21 2016  
WV Department of Environmental Protection

Please insert additional pages as applicable.

API 47- 095 - 02140 Farm name Rodney & Vickie Tippins Well number Bashful 2

<u>PRODUCING FORMATION(S)</u>	<u>DEPTHS</u>			
Marcellus	<u>7,065'</u>	TVD	<u>14,517'</u>	MD

Please insert additional pages as applicable.

GAS TEST  Build up  Drawdown  Open Flow OIL TEST  Flow  Pump

SHUT-IN PRESSURE Surface 2055 psi Bottom Hole \_\_\_\_\_ psi DURATION OF TEST 24 hrs

OPEN FLOW Gas 7,500 mcfpd Oil \_\_\_\_\_ bpd NGL 5 bpd Water 200 bpd GAS MEASURED BY  Estimated  Orifice  Pilot

LITHOLOGY/ FORMATION	TOP DEPTH IN FT NAME TVD	BOTTOM DEPTH IN FT TVD	TOP DEPTH IN FT MD	BOTTOM DEPTH IN FT MD	DESCRIBE ROCK TYPE AND RECORD QUANTITY AND TYPE OF FLUID (FRESHWATER, BRINE, OIL, GAS, H <sub>2</sub> S, ETC)
See Attached.	0		0		

Please insert additional pages as applicable.

Drilling Contractor Horizontal Well Drillers  
Address 2915 SH 74 South City Purcell State OK Zip 73080

Logging Company Precise Well Analysis  
Address PO Box 542 City Belpre State OH Zip 45714

Cementing Company Nabors Completion & Production  
Address 1650 Hackers Creek Rd. City Jane Lew State WV Zip 26378

Stimulating Company Go-Frac  
Address 62787 Phillips Rd. City Cambridge State OH Zip 43725

Please insert additional pages as applicable.

Completed by Randy Broda Telephone 304-628-3111  
Signature \_\_\_\_\_ Date 3-17-2016

Submittal of Hydraulic Fracturing Chemical Disclosure Information as a copy of FRACFOCUS Registry

**RECEIVED**  
Office of Oil and Gas

**MAR 28 2016**

**RECEIVED**  
Office of Oil and Gas

**MAR 28 2016**

**WV Department of Environmental Protection**

API 47- 095 - 02140 Farm name Rodney & Vickie Tippins Well number Bashful 2

<u>PRODUCING FORMATION(S)</u>	<u>DEPTHS</u>		
<u>Marcellus</u>	<u>7,065'</u>	<u>TVD</u>	<u>14,517'</u> <u>MD</u>
<u> </u>	<u> </u>	<u> </u>	<u> </u>
<u> </u>	<u> </u>	<u> </u>	<u> </u>

Please insert additional pages as applicable.

GAS TEST  Build up  Drawdown  Open Flow OIL TEST  Flow  Pump

SHUT-IN PRESSURE Surface 2055 psi Bottom Hole   psi DURATION OF TEST 24 hrs

OPEN FLOW Gas 7,500 mcfpd Oil   bpd NGL 5 bpd Water 200 bpd GAS MEASURED BY  Estimated  Orifice  Pilot

LITHOLOGY/ FORMATION	TOP DEPTH IN FT NAME TVD	BOTTOM DEPTH IN FT TVD	TOP DEPTH IN FT MD	BOTTOM DEPTH IN FT MD	DESCRIBE ROCK TYPE AND RECORD QUANTITY AND TYPE OF FLUID (FRESHWATER, BRINE, OIL, GAS, H <sub>2</sub> S, ETC)
<u>See Attached.</u>	<u>0</u>	<u> </u>	<u>0</u>	<u> </u>	<u> </u>

Please insert additional pages as applicable.

Drilling Contractor Horizontal Well Drillers  
Address 2915 SH 74 South City Purcell State OK Zip 73080

Logging Company Precise Well Analysis  
Address PO Box 542 City Belpre State OH Zip 45714

Cementing Company Nabors Completion & Production  
Address 1650 Hackers Creek Rd. City Jane Lew State WV Zip 26378

Stimulating Company Go-Frac  
Address 62787 Philips Rd. City Cambridge State OH Zip 43725

Please insert additional pages as applicable.

Completed by Randy Broda Telephone 304-628-3111  
Signature   Title President Date  

Submittal of Hydraulic Fracturing Chemical Disclosure Information Attach copy of FRACFOCUS Registry

**RECEIVED**  
**Office of Oil and Gas**  
Zip 26378  
**MAR 21 2016**  
**WV Department of Environmental Protection**



**Lithology**

Bashful 2

47-095-02140

<b>FORMATION</b>	<b>TOP</b>	<b>BOTTOM</b>
MISC. RED ROCK & SHALES	0	2297
LIME	2297	2397
INJUN	2397	2514
SHALE	2514	2861
GORDON STRAY	2861	2881
SHALE	2881	3077
GORDON	3077	3107
SHALE	3107	3386
BAYARD	3386	3395
SHALE	3395	3724
WARREN	3724	3822
SHALE	3822	4058
BALLTOWN	4058	4221
SHALE	4221	4659
2ND RILEY	4659	4767
SHALE	4767	4918
3RD RILEY	4918	4959
SHALE	4959	5016
BENSON	5016	5019
SHALE	5019	5261
ALEXANDER	5261	5432
SHALE	5432	5677
ELK	5677	5725
SHALE	5725	6089
HAMILTON	6089	6263
SHALE	6263	6919
UPPER Marcellus	6919	6925
PARCELL LIME	6925	6960
SHALE	6960	7043
LOWER MARCELLUS	7043	

RECEIVED  
Office of Oil and Gas

MAR 21 2016

WV Department of  
Environmental Protection

10/28/2016



State of West Virginia  
Department of Environmental Protection - Office of Oil and Gas  
Discharge Monitoring Report  
Oil and Gas General Permit

Company Name: Jay-Bee Oil & Gas, Inc.  
API No: 47-095-02140 County: Tyler  
District: McElroy Well No: Bashful 2  
Farm Name: Rodney & Vickie Tippins

Discharge Date/s From:(MMDDYY) 1/19/2015 To: (MMDDYY) 02/19/2015  
Discharge Times. From: n/a To: n/a

Total Volume to be Disposed from this facility (gallons): NO DISCHARGE  
Disposal Option(s) Utilized (write volumes in gallons):

- (1) Land Application: \_\_\_\_\_ (Include a topographical map of the Area.)
- (2) UIC: \_\_\_\_\_ Permit No. \_\_\_\_\_
- (3) Offsite Disposal: \_\_\_\_\_ Site Location: \_\_\_\_\_
- (4) Reuse: \_\_\_\_\_ Alternate Permit Number: \_\_\_\_\_
- (5) Centralized Facility: \_\_\_\_\_ Permit No. \_\_\_\_\_
- (6) Other method: \_\_\_\_\_ (Include an explanation)

Follow Instructions below to determine your treatment category:

Optional Pretreatment test: n/a Cl- mg/l n/a DO mg/l

1. Do you have permission to use expedited treatment from the Director or his representative?  
(Y/N) N If yes, who? n/a and place a four (4) on line 7.  
If not go to line 2
2. Was Frac Fluid or flowback put into the pit? (Y/N) N If yes, go to line 5. If not, go to line 3.
3. Do you have a chloride value pretreatment (see above)? (Y/N) n/a If yes, go to line 4  
If not, go to line 5.
4. Is the Chloride level less than 5000 mg/l? (Y/N) n/a If yes, then enter a one (1) on line 7.
5. Do you have a pretreatment value for DO? (See above) (Y/N) n/a If yes, go to line 6  
If not, enter a three (3) in line 7.
6. Is the DO level greater than 2.5 mg/l?(Y/N) n/a If yes, enter a two (2) on line 7. If not, enter a three (3) on line 7.
7. n/a is the category of your pit. Use the Appropriate section.
8. Comments on Pit condition: n/a

Name of Principal Exec. Officer: Shane Dowell  
Title of Officer: Office Manager  
Date Completed: 3-17-2016

RECEIVED  
Office of Oil and Gas

I certify under penalty of law that I have personally examined and am familiar with the information submitted on this document and all the attachments and that, based on my inquiry of those individuals immediately responsible for obtaining the information I believe that the information is true, accurate, and complete. I am aware that there are significant penalties for submitting false information, including the possibility of fine and imprisonment.

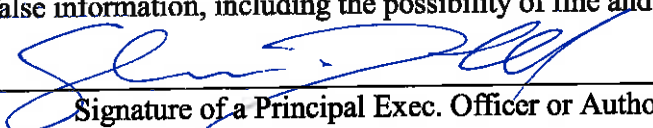
  
Signature of a Principal Exec. Officer or Authorized agent.

MAR 21 2016  
WV Department of Environmental Protection  
10/28/2016

# Hydraulic Fracturing Fluid Product Component Information Disclosure

Job Start Date:	11/17/2014
Job End Date:	12/7/2014
State:	West Virginia
County:	Tyler
API Number:	47-095-02140-00-00
Operator Name:	Jay-Bee Oil & Gas, Inc.
Well Name and Number:	Bashful 2
Longitude:	-80.72107900
Latitude:	39.47304100
Datum:	NAD27
Federal/Tribal Well:	NO
True Vertical Depth:	7,065
Total Base Water Volume (gal):	10,411,800
Total Base Non Water Volume:	



## Hydraulic Fracturing Fluid Composition:

Trade Name	Supplier	Purpose	Ingredients	Chemical Service Abstract Number (CAS #)	Maximum Ingredient Concentration in Additive (% by mass)**	Maximum Ingredient Concentration in HF Fluid (% by mass)**	Comments
Water	Jay-Bee Oil & Gas, Inc.	Water	Water	7732-18-5	100.00000	92.28741	
100 Mesh	GoFrac, LLC	Frac Sand	Crystalline Silica	14808-60-7	99.90000	3.12205	
			Aluminum Oxide	1344-28-1	1.10000	0.03469	
			Iron Oxide	1309-37-1	0.10000	0.00315	
			Titanium Oxide	13463-67-7	0.10000	0.00315	
30/50 Mesh	GoFrac, LLC	Frac Sand	Crystalline Silica	14808-60-7	99.00000	3.10111	
			Aluminum Oxide	1344-28-1	1.10000	0.03446	
			Titanium Oxide	13463-67-7	0.10000	0.00313	
			Iron Oxide	1309-37-1	0.10000	0.00313	
20/40 Mesh	GoFrac, LLC	Frac Sand	Crystalline Silica	14808-60-7	99.90000	0.76035	
			Aluminum Oxide	1344-28-1	1.10000	0.00845	
			Iron Oxide	1309-37-1	0.10000	0.00077	
			Titanium Oxide	13463-67-7	0.10000	0.00077	
10.1-15% HCL	GoFrac, LLC - Reagent Gas	Acid					

WV Department of Environmental Protection  
 MAR 21 2015  
 Oil & Gas

Sodium persulfate	GoFrac, LLC - Chemplex	Breaker	Hydrochloric Acid	7547-01-0	15.00000	0.04919
Plexsurf 215E	GoFrac, LLC - Chemplex	Surfactant	Sodium persulfate	7775-27-1	100.00000	0.03706
Plexhib 256	GoFrac, LLC - Chemplex	Corrosion Inhibitor	Methyl Alcohol	67-56-1	28.00000	0.03251
Plexbreak 145	GoFrac, LLC - Chemplex	Non-Emulsifier	Methyl Alcohol	67-56-1	70.00000	0.02191
Plexaid 673	GoFrac, LLC - Chemplex	Scale Inhibitor	Propargyl Alcohol	107-19-7	8.00000	0.00249
Ferriplex 66	GoFrac, LLC - Chemplex	Iron Control	Methyl Alcohol	67-56-1	15.00000	0.00433
Plexsick 957	GoFrac, LLC - Chemplex	Polymer Emulsifier	Diethanolamine	111-42-2	5.00000	0.00144
			Methyl Alcohol	67-56-1	25.00000	0.00057
			Acetic Acid	64-19-7	50.00000	0.00016
			Ammonium Chloride	12125-02-9	5.00000	0.00005
Ingredients shown above are subject to 29 CFR 1910.1200(i) and appear on Material Safety Data Sheets (MSDS). Ingredients shown below are Non-MSDS.						
	GoFrac, LLC - Reagent Chemicals	Acid				
			Water	7732-18-5	85.00000	0.27876
Plexsurf 215E	GoFrac, LLC - Chemplex	Surfactant				
			Water	7732-18-5	80.00000	0.07779
			Alcohol Enoxyate Surfactants	proprietary	5.00000	0.00580
SOS 1545	GoFrac, LLC - Chemplex	Gel				
			Hydrocarbons	64741-85-1	70.00000	0.05051
			Water	7732-18-5	30.00000	0.02165
Plexicide 15G	GoFrac, LLC - Chemplex	Bicide				
			Water	7732-18-5	90.00000	0.03207
			Glutaraldehyde	111-30-8	14.00000	0.00583
			Alkyl dimethyl benzyl ammonium chloride	68424-85-1	3.00000	0.00125
			Ethanol	64-17-5	3.00000	0.00125
			Didecyl dimethyl ammonium chloride	7173-51-5	3.00000	0.00125
Plexbreak 145	GoFrac, LLC - Chemplex	Non-Emulsifier				
			Water	7732-18-5	66.00000	0.01587
			Ethyl Glycol	111-76-2	15.00000	0.00433
			Cocamide Diethanolamine Salt	88603-42-9	10.00000	0.00289
Plexhib 256	GoFrac, LLC - Chemplex	Corrosion Inhibitor				

Office of  
 MAR 21 2016  
 Department of  
 and G  
 of



				Thiourea-formaldehyde copolymer	68527-49-1	30.00000	0.00935
				Alcohol Ethoxyate Surfactants	proprietary	30.00000	0.00935
				n-olefins	proprietary	10.00000	0.00312
Plexaid 673	GoFrac, LLC - Chemplex	Scale Inhibitor		Water	7732-18-5	85.00000	0.00161
				proprietary	proprietary	5.00000	0.00011
Plexislick 957	GoFrac, LLC - Chemplex	Polymer Emulsifier		Poly Acid	62649-23-4	35.00000	0.00034
				Parraffinic	64742-47-8	30.00000	0.00030
				Water	7732-18-5	40.00000	0.00015
				Nonionic Surfactants	proprietary	10.00000	0.00010
				Sodium Chloride	7647-14-5	5.00000	0.00005
Ferriplex 66	GoFrac, LLC - Chemplex	Iron Control		Citric Acid	77-92-9	30.00000	0.00010
				Water	7732-18-5	20.00000	0.00007

\* Total Water Volume sources may include fresh water, produced water, and/or recycled water  
\*\* Information is based on the maximum potential for concentration and thus the total may be over 100%

Note: For Field Development Products (products that begin with FDP), MSDS level only information has been provided.  
Ingredient information for chemicals subject to 29 CFR 1910.1200(i) and Appendix D are obtained from suppliers Material Safety Data Sheets (MSDS)

RECEIVED  
Office of Oil and Gas  
MAR 21 2016  
WV Department of  
Environmental Protection

10/28/2016

Top Hole Latitude: 39°30'00"

3542'

Bottom Hole Latitude: 39°30'00"

5915'



THE THRASHER GROUP, INC.  
609 WHITE OAKS BLVD.  
ROCKFORD, IL 61080  
PHONE: 815-994-4100

NOTES ON SURVEY

- COORDINATES SYSTEM IS UTM, NAD 83 DATUM, ZONE 17, U.S. FOOT AND WELL COORDINATES ESTABLISHED USING SURVEY GRADE GPS.
- SURFACE AND ROYALTY OWNER INFORMATION AND THEIR BOUNDARIES SHOWN HEREON WERE PLOTTED FROM DEEDS AND/OR TAX PARCEL MAPS PROVIDED BY CLIENT AND FIELD LOCATIONS.
- THIS PLAT DOES NOT REPRESENT A BOUNDARY SURVEY OF THE PARCELS SHOWN HEREON.
- NO DWELLINGS AND BUILDINGS WITHIN 625 FEET OF PROPOSED CENTER OF PAD.
- NO WATER WELLS OR DEVELOPED SPRINGS WITHIN 250 FEET OF PROPOSED WELL.
- NO PERENNIAL STREAMS, LAKES, PONDS, RESERVOIRS OR WETLANDS WITHIN 100 FEET OF THE LIMITS OF DISTURBANCE.
- NO NATURALLY PRODUCING TROUT STREAM WITHIN 300 FEET OF LIMITS OF DISTURBANCE.

AS-DRILLED

TRACT	SURFACE OWNER	TAX PARCEL	ACRES
A	RODNEY & VICKIE TIPPINS	2-7-17	42.25
B	THU WYNN	2-7-17	42.25
C	LEO & RUBY WERNERSON	2-3-38	134.48
D	RODNEY & VICKIE TIPPINS	2-3-14	42.25
E	GRAY OWENS	2-3-2	42.25
F	RODNEY & VICKIE TIPPINS	2-3-11	102.50
G	RODNEY & VICKIE TIPPINS	2-3-10	42.25
H	RODNEY & VICKIE TIPPINS	2-29-1	42.25

2246'  
Bottom Hole Longitude: 80°42'30"

Top Hole Longitude: 80°42'30"

9786'

GRID NORTH  
UTM, NAD83 DATUM, ZONE 17, US FT

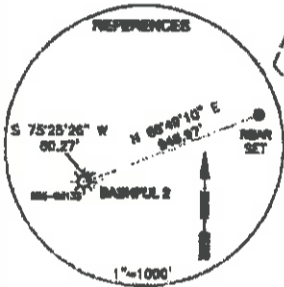
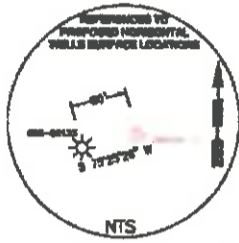

**SURFACE HOLE LOCATION (SHL):**  
UTM (NAD83, ZONE 17, METERS):  
NORTHING: 4,369,319.265  
EASTING: 524,005.638

**BOTTOM HOLE LOCATION (BHL):**  
UTM (NAD83, ZONE 17, METERS):  
NORTHING: 4,371,814.919  
EASTING: 523,274.301

I, THE UNDERSIGNED, HEREBY CERTIFY THAT THIS PLAT IS CORRECT TO THE BEST OF MY KNOWLEDGE AND BELIEF AND SHOWS ALL THE INFORMATION REQUIRED BY LAW AND REGULATIONS ISSUED AND PRESCRIBED BY THE DEPARTMENT OF ENVIRONMENTAL PROTECTION.



2000 0 2000  
GRAPHIC SCALE IN FEET

P.S. 2270 *Michael S. Wolf* 3/6/16



(+) DENOTES LOCATION OF WELL ON UNITED STATES TOPOGRAPHIC MAPS  
WVDEP  
OFFICE OF OIL & GAS  
601 57TH STREET  
CHARLESTON, WV 25034

MINIMUM DEGREE OF ACCURACY: 1/200  
PROVEN SURVEY SOURCE OF GRADE GPS ELEVATION: (NAD83, US FT)

Office of Oil and Gas  
OPERATOR'S WELL #: BASHFUL 2  
MAR 21 2016  
API WELL #: 470950240-H6A  
STATE COUNTY PERMIT

WELL TYPE: OIL WASTE DISPOSAL PRODUCTION DEEP GAS  LIQUID INJECTION STORAGE SHALLOW

WATERSHED: BONELICK RUN  
DISTRICT: MCELROY COUNTY: TYLER  
SURFACE OWNER: RODNEY L. & VICKIE L. TIPPINS & THOMAS HEADLEY, EST.  
OIL & GAS ROYALTY OWNER: SOUTH PENN OIL COMPANY

DRILL  DRILL DEEPER REDRILL FRACTURE OR STIMULATE  PLUG OFF OLD FORMATION PERFORATE NEW FORMATION  
CONVERT PLUG & ABANDON CLEAN OUT & REPLUG OTHER CHANGE (SPECIFY)

TARGET FORMATION: MARCELLUS ESTIMATED DEPTH: TMD 14,517' TMD 7,065'

WELL OPERATOR: JAY BEE OIL & GAS, INC. ADDRESS: 1720 RT. 22, EAST CITY: UNION STATE: NJ ZIP CODE: 07083

DESIGNATED AGENT: RANDY BRODA ADDRESS: RT. 1 BOX 5 CITY: CARO STATE: WV ZIP CODE: 26337

LEGEND:  
 \* PROPOSED SURFACE HOLE / BOTTOM HOLE  
 \* EXISTING / PRODUCING WELLHEAD  
 \* ABANDONED WELL  
 \* PLUGGED & ABANDONED WELL  
 \* CUT CONDUCTOR  
 - - - - - LEASE BOUNDARY  
 - - - - - 500' DHP BUFFER  
 - - - - - AS-DRILLED DHP  
 - - - - - PLANNED DHP

REVISIONS:  
 DATE: 03-16-2016  
 DRAWN BY: E. LYLE  
 SCALE: 1" = 200'  
 DRAWING NO: 050-5805  
 (AS-DRILLED PLAT)