

Top Hole Latitude: 39°39'30" 1602'

Bottom Hole Latitude: 39°27'30" 10887'

THRASHER

THE THRASHER GROUP, INC.
600 WHITE OAKS BLVD.
BRIDGEPORT, WV 26330
PHONE 304-624-4108

LINE	BEARING	DISTANCE
L1	N 05°48'35" W	997.71'
L2	S 84°39'10" E	900.30'

NOTES ON SURVEY

- COORDINATES SYSTEM IS UTM, NAD 83 DATUM, ZONE 17, U.S. FOOT AND WELL COORDINATES ESTABLISHED USING SURVEY GRADE GPS.
- SURFACE AND ROYALTY OWNER INFORMATION AND THEIR BOUNDARIES SHOWN HEREON WERE PLOTTED FROM DEEDS AND/OR TAX PARCEL MAPS PROVIDED BY CLIENT AND FIELD LOCATIONS.
- THIS PLAT DOES NOT REPRESENT A BOUNDARY SURVEY OF THE PARCELS SHOWN HEREON.
- NO DWELLINGS AND BUILDINGS WITHIN 625 FEET OF PROPOSED OF CENTER OF PAD.
- NO WATER WELLS OR DEVELOPED SPRINGS WITHIN 250 FEET OF PROPOSED WELL.
- NO PERENNIAL STREAMS, LAKES, PONDS, RESERVOIRS OR WETLANDS WITHIN 100 FEET OF THE LIMITS OF DISTURBANCE.
- NO NATURALLY PRODUCING TROUT STREAM WITHIN 300 FEET OF LIMITS OF DISTURBANCE.

AS-DRILLED

ADJOINER	SURFACE OWNER	TAX PARCEL
1	F.M. & ESTELLA MCINTYRE, ET AL.	5-6-49
2	JAMES I. & PAULETTE M. GORBY	5-6-45
3	JAMES IRA & PAULETTE M. GORBY	5-6-46.1
4	RICHARD C. WARNER	5-6-42.3
5	RICHARD C. WARNER	5-6-42.2
6	RICHARD C. WARNER	5-6-42.4
7	BRIAN K. & KATHRYN A. HAYDEN	5-6-42.1
8	JAMES D. DOTSON	5-6-43
9	MICHELLE D. HADLEY	5-6-54

REFERENCES

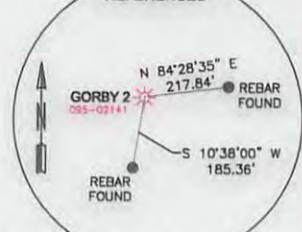

GRID NORTH
UTM, NAD83 DATUM, ZONE 17, US FT

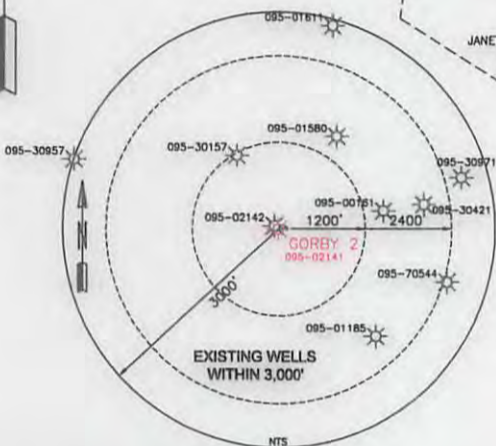

TRACT	SURFACE OWNER	TAX PARCEL	ACRES	LEASE NO.
A	JAMES IRA & PAULETTE M. GORBY	5-6-44	105.5	T-312912
B	JAMES IRA & PAULETTE M. GORBY	5-6-46	18.74	T-3104E-1
C	JIMMIE & RHAEE HADLEY	5-5-18	87.10	T-3127B
D	JIMMIE & RHAEE HADLEY	5-6-42	35.07	T-34
E	COASTAL FOREST RESOURCES CO	5-6-39	23.00	RPT-3
	RONALD HOOVER	5-6-37	108.0	T-3133
	ANTHONY ANDREW HAUGHT & AMY JO HAUGHT	5-6-40	93.0	TI-03

SURFACE HOLE LOCATION (SHL):
UTM (NAD83, ZONE 17, METERS):
NORTHING: 4,368,667.702
EASTING: 517,431.072
GEOGRAPHIC (NAD83):
LATITUDE: 39.467414°
LONGITUDE: -80.797358°
BOTTOM HOLE LOCATION (BHL):
UTM (NAD83, ZONE 17, METERS):
NORTHING: 4,366,775.473
EASTING: 518,192.175
GEOGRAPHIC (NAD83):
LATITUDE: 39.450348°
LONGITUDE: -80.788562°

I, THE UNDERSIGNED, HEREBY CERTIFY THAT THIS PLAT IS CORRECT TO THE BEST OF MY KNOWLEDGE AND BELIEF AND SHOWS ALL THE INFORMATION REQUIRED BY LAW AND REGULATIONS ISSUED AND PRESCRIBED BY THE DEPARTMENT OF ENVIRONMENTAL PROTECTION.

P.S. 2270

M.S. Wolf 3/31/16

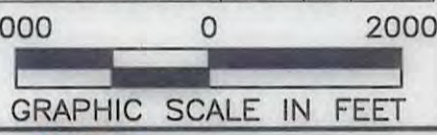

(+) DENOTES LOCATION OF WELL ON UNITED STATES TOPOGRAPHIC MAPS

WVDEP
OFFICE OF OIL & GAS
601 57TH STREET
CHARLESTON, WV 25034

MINIMUM DEGREE OF ACCURACY: 1/200

PROVEN SURVEY SOURCE OF GRADE GPS ELEVATION: (NAVD 88, US FT)

OPERATOR'S WELL #: GORBY 2

API WELL #: 47 STATE 095 PERMIT 02141H6A

WELL TYPE: OIL WASTE DISPOSAL PRODUCTION DEEP GAS LIQUID INJECTION STORAGE SHALLOW

WATERSHED: BIG RUN ELEVATION: 1276'

DISTRICT: MCELROY COUNTY: TYLER QUADRANGLE: SHIRLEY

SURFACE OWNER: JAMES I. GORBY & PAULETTE GORBY ACREAGE: 105.50±

OIL & GAS ROYALTY OWNER: BARBARA CAINE, ET AL.; ENLOE GATTELL, ET AL.; RONALD L. HOOVER, ET AL.; JACK T. WATSON, ET AL.; WYNIC FOUT, LLC, ET AL.; JAMES IRA GORBY, ET AL.; J.E. SPENCER ACREAGE: 470.41±

DRILL DRILL DEEPER REDRILL FRACTURE OR STIMULATE PLUG OFF OLD FORMATION PERFORATE NEW FORMATION

CONVERT PLUG & ABANDON CLEAN OUT & REPLUG OTHER CHANGE (SPECIFY) **06/17/2016**

TARGET FORMATION: MARCELLUS ESTIMATED DEPTH: TMD 13,192' TVD 6,986'

WELL OPERATOR: JAY BEE OIL & GAS, INC. DESIGNATED AGENT: RANDY BRODA

ADDRESS: 1720 RT. 22, EAST ADDRESS: RT. 1 BOX 5

CITY: UNION STATE: NJ ZIP CODE: 07083 CITY: CAIRO STATE: WV ZIP CODE: 26337

LEGEND:	REVISIONS:	DATE: 03-31-2016
● PROPOSED SURFACE HOLE / BOTTOM HOLE		
⊙ EXISTING / PRODUCING WELLHEAD	----- LEASE BOUNDARY	
⊗ ABANDONED WELL	----- 500' DHP BUFFER	
⊗ PLUGGED & ABANDONED WELL	----- AS-DRILLED DHP	
△ CUT CONDUCTOR	----- PLANNED DHP	
		DRAWN BY: E. LYTLE
		SCALE: 1" = 2000'
		DRAWING NO: 050-5824
		ASDRILLED PLAT