

TOP HOLE (UTM NAD 83)
N) 4368678.3
E) 520297.3

BOTTOM HOLE (UTM NAD 83)
N) 4366255.1
E) 521176.8

NO DWELLINGS FOUND WITHIN 650' OF THE CENTER OF THE WELL PAD
NO WATER WELLS FOUND WITHIN 250' OF THE CENTER OF WELL PAD

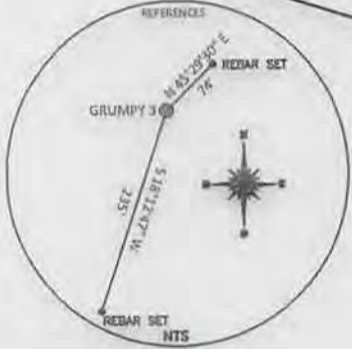
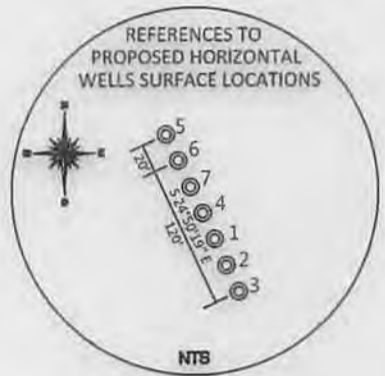

REFERENCE NOTES
Boundaries as shown taken from deeds, tax maps and field locations. A full boundary survey is not expressed nor implied. All bearings are based on true north. Ownership taken from public records Tyler County, West Virginia OCTOBER 2013
State Plane Coordinates & NAD 83 Lat/Long by differential submeter mapping grade GPS Drafted by: EAM

RECEIVED
Office of Oil and Gas



FILE #: 201368

DRAWING #: 1

SCALE: PLAT - 1" = 1200'
TICK MARK - 1" = 2000'

MINIMUM DEGREE OF ACCURACY: 1/200

PROVEN SOURCE OF ELEVATION: SUBMETER MAPPING GRADE GPS

I, THE UNDERSIGNED, HEREBY CERTIFY THAT THIS PLAT IS CORRECT TO THE BEST OF MY KNOWLEDGE AND BELIEF AND SHOWS ALL THE INFORMATION REQUIRED BY LAW AND THE REGULATIONS ISSUED AND PRESCRIBED BY THE DEPARTMENT OF ENVIRONMENTAL PROTECTION.

Signed: *[Signature]*

L.L.S. #2124: Ernest J. Benchek III



(+) DENOTES LOCATION OF WELL ON UNITED STATES TOPOGRAPHIC MAPS WYDEP

OFFICE OF OIL & GAS
601 57TH STREET
CHARLESTON, WV 25304

Well Type: Oil Waste Diposal Production Deep
 Gas Liquid Injection Storage Shallow

WATERSHED: OUTLET MIDDLE ISLAND CREEK ELEVATION: 1298.01'

COUNTY/DISTRICT: TYLER/McELROY QUADRANGLE: SHIRLEY, WV

SURFACE OWNER: GEORGE & JOANN WOODBURN ACREAGE: 42.00 +/-

OIL & GAS ROYALTY OWNER: JUSTUS SPENCER (TM6/19, TM6/22), GEORGE & JOANN WOODBURN (TM6/20), BLACKROCK ENTERPRISES, LLC (TM6/25, TM6/25.2, TM6/25.3), JANET BURNS (TM6/21), FRED & DEBRA REAL (TM6/23) DON RITZ (TM11/8) ACREAGE: 482.24 +/-

LEASE NUMBERS: 1. T1-18, 2. T3039, 3. 3045A, 4. T3045B, 5. T3045B, 6. T3045B, 7. T1-09, 8. T3047, 9. T3049

DRILL CONVERT DRILL DEEPER REDRILL FRACTURE OR STIMULATE
PLUG OFF FORMATION PERFORATE NEW FORMATION PLUG & ABANDON
CLEAN OUT & REPLUG OTHER CHANGE (SPECIFY):

TARGET FORMATION: MARCELLUS ESTIMATED DEPTH: TMD: 15,280' TVD: 7,300'

WELL OPERATOR: JAY BEE OIL & GAS, LLC. DESIGNATED AGENT: SHANE DOWELL

ADDRESS: 3570 SHIELDS HILL ROAD ADDRESS: 3570 SHIELDS HILL ROAD

CITY: CAIRO STATE: WV ZIP CODE: 26337 CITY: CAIRO STATE: WV ZIP CODE: 26337

05/06/2014

WELL NAME: GRUMPY 3
QUAD: SHIRLEY, WV

