

LATITUDE 39°27'30"

8,296'

199' TO BOTTOM HOLE
LATITUDE 39°27'30"

LONGITUDE 80°52'30"

9,603'

LONGITUDE 80°50'00"

Antero Resources Corporation
Well No. Jug Unit 2H

DAVID L. MAPLE LEASE

STATE OF WV DNR
D.B. 307 PG. 217
T.M. 27 PAR. 25
100 AC. ±

WELL 2H
BOTTOM HOLE

STATE OF WV DNR
D.B. 227 PG. 141
T.M. 27 PAR. 28
88.75 AC. ±

MARK D. FLETCHER
D.B. 230 PG. 627
T.M. 27 PAR. 27
34.94 AC. ±

MARK DOUGLAS FLETCHER LEASE
MARK D. FLETCHER
D.B. 230 PG. 627
T.M. 27 PAR. 29
52 AC. ±

JOHN R. SPENCE ET AL
D.B. 273 PG. 720
T.M. 27 PAR. 26
21.71 AC. ±

STATE OF WV DNR
D.B. 256 PG. 17
T.M. 04 PAR. 01
222.85 AC. ±

STATE OF WV DNR
D.B. 285 PG. 248
T.M. 04 PAR. 01.2
10 AC. ±

STATE OF WV DNR
D.B. 285 PG. 254
T.M. 04 PAR. 01.3
10.4 AC. ±

STATE OF WV DNR
D.B. 255 PG. 245
T.M. 04 PAR. 01.4
10 AC. ±

SCOTT C. BLAIR ET AL
D.B. 296 PG. 589
T.M. 04 PAR. 08.4
64.17 AC. ±

STAR FURNITURE CO.
D.B. 248 PG. 486
T.M. 04 PAR. 08.2
2.79 AC. ±

REGINA H. BERTOZZI ET AL
D.B. 334 PG. 420
T.M. 04 PAR. 08.3
41.86 AC. ±

CATHY JO ASH ET AL LEASE

ROBERT L. RIPLEY ET AL
D.B. 327 PG. 77
T.M. 04 PAR. 06
53.5 AC. ±

ROBERT L. RIPLEY ET AL
D.B. 327 PG. 77
T.M. 04 PAR. 06.1
9.29 AC. ±

ROBERT L. BROWN ET UX LEASE
WILLIE R. LESTER
D.B. 326 PG. 402
T.M. 04 PAR. 07
97.75 AC. ±

RAYMOND UNDERWOOD
W.B. 28 PG. 70
T.M. 04 PAR. 12.2
16 AC. ±

ROBERT L. RIPLEY ET AL
D.B. 327 PG. 77
T.M. 04 PAR. 06.2
18.75 AC. ±

RAYMOND UNDERWOOD
W.B. 28 PG. 70
T.M. 04 PAR. 12
76.5 AC. ±

LANDING POINT
N:342333
E:1614549

RAYMOND UNDERWOOD
D.B. 13 PG. 12
T.M. 04 PAR. 13.1
23 AC. ±

STATE OF WV DNR
D.B. 156 PG. 54
T.M. 04 PAR. 14
244.25 AC. ±

NO OCCUPIED DWELLINGS OR BUILDINGS TWO THOUSAND FIVE HUNDRED (2,000) SQUARE FEET OR LARGER USED TO HOUSE OR SHELTER DAIRY CATTLE OR POULTRY HUSBANDRY ARE LOCATED WITHIN SIX HUNDRED TWENTY-FIVE (625) FEET OF THE CENTER OF THE WELL PAD.

NOTES:
WELL 2H TOP HOLE INFORMATION:
N: 342,363ft E: 1,615,102ft
LAT: 39°25'55.11" LON: 80°51'45.73"
BOTTOM HOLE INFORMATION:
N: 351,142ft E: 1,611,563ft
LAT: 39°27'21.34" LON: 80°52'32.54"
WEST VIRGINIA COORDINATE SYSTEM OF 1927 NORTH ZONE. ZONE WAS DERIVED FROM MEASUREMENTS TAKEN WITH TRIMBLE GEOXT SUBMETER MAPPING GRADE GPS UNIT. PLAT ORIENTATION, CORNER, AND WELL REFERENCE TIE LINES ARE BASED ON GRID NORTH.

(NAD) 83 (UTM) ZONE 17 COORDS:
WELL 2H TOP HOLE INFORMATION:
N: 4,364,733m E: 511,831m
BOTTOM HOLE INFORMATION:
N: 4,367,389m E: 510,708m

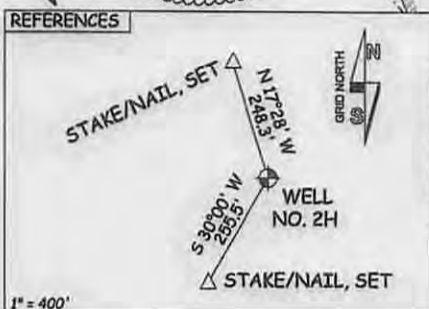
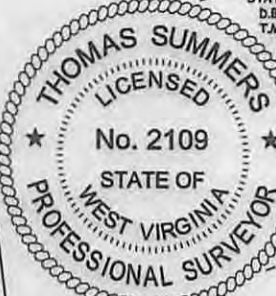
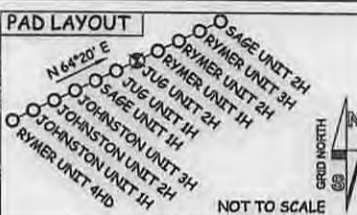

I THE UNDERSIGNED, HEREBY CERTIFY THAT THIS PLAT IS CORRECT TO THE BEST OF MY KNOWLEDGE AND BELIEF AND SHOWS ALL THE INFORMATION REQUIRED BY LAW AND THE RULES ISSUED AND PERSCRIBED BY THE DEPARTMENT OF ENVIRONMENTAL PROTECTION.



STATE OF WEST VIRGINIA, DIVISION OF ENVIRONMENTAL PROTECTION, OFFICE OF OIL AND GAS
WILLOW LAND SURVEYING PLLC
220 MASONIC AVE. PENNSBORO WEST VIRGINIA 26415

JOB # 13-102WA
DRAWING # JUG2HR1
SCALE 1" = 1000'
MINIMUM DEGREE OF ACCURACY SUBMETER
PROVEN SOURCE OF ELEV. SUBMETER MAPPING GRADE GPS
STATE OF WEST VIRGINIA DEPARTMENT OF ENERGY DIVISION OF OIL AND GAS

LEGEND
--- Surface Owner Boundary Lines +/-
--- Interior Surface Tracts +/-
X Existing Fence
⊕ Found monument, as noted
THOMAS SUMMERS P.S. 2109
DATE 06/16/15
OPERATOR'S WELL# JUG UNIT#2H

WELL TYPE: OIL ___ GAS LIQUID INJECTION ___ WASTE DISPOSAL ___ 47 - 095 - 12171
(IF "GAS") PRODUCTION STORAGE ___ DEEP ___ SHALLOW STATE COUNTY PERMIT
LOCATION: ELEVATION 1,036' ORIGINAL - 1,017' PROPOSED WATERSHED HEADWATERS MIDDLE ISLAND CREEK
QUADRANGLE SHIRLEY 7.5' - SHL MIDDLEBOURNE 7.5' - BHL DISTRICT CENTERVILLE COUNTY TYLER
SURFACE OWNER RAYMOND UNDERWOOD ACREAGE 23 ACRES +/-
OIL & GAS ROYALTY OWNER RAYMOND V. UNDERWOOD ET UX; ROBERT L. BROWN ET UX; LEASE ACREAGE 96 ACRES±; 97.75 ACRES±; CATHY JO ASH ET AL; MARK DOUGLAS FLETCHER; DAVID L. MAPLE 315.25 ACRES±; 86 AC±; 88.75 AC±
PROPOSED WORK: DRILL CONVERT ___ DRILL DEEPER ___ REDRILL ___ FRACTURE OR STIMULATE
PLUG OFF OLD FORMATION ___ PERFORATE NEW FORMATION OTHER PHYSICAL CHANGE IN WELL (SPECIFY) MOD - BHL PLUG & ABANDON CLEAN OUT & REPLUG
TARGET FORMATION MARCELLUS ESTIMATED DEPTH 6,700' TVD 16,500' MD
WELL OPERATOR ANTERO RESOURCES CORP. DESIGNATED AGENT DIANNA STAMPER - CT CORPORATION SYSTEM
ADDRESS 1615 WYNKOOP STREET ADDRESS 5400 D BIG TYLER ROAD
FORM WW-6 DENVER, CO 80202 CHARLESTON, WV 25313

08/14/2015

COUNTY NAME PERMIT