

LATITUDE 39°27'30"

7,352'

3,683' TO BOTTOM HOLE

LATITUDE 39°25'00"

LONGITUDE 80°42'30"

12,706'

6,807' TO BOTTOM HOLE

LONGITUDE 80°42'30"

Antero Resources Corporation
Well No. Owo Unit 2H
47-095-02180 (AS DRILLED)

NOTE:
NO WATER WELLS WERE
LOCATED WITHIN 2000'
OF CENTER OF PAD

AS DRILLED DATA:
WELL 2H TOP HOLE INFORMATION:
N: 338,735ft E: 1,651,309ft
LAT: 39°25'24.42" LON: 80°44'03.68"
BOTTOM HOLE INFORMATION:
N: 329,408ft E: 1,654,852ft
LAT: 39°23'52.72" LON: 80°43'16.92"
WEST VIRGINIA COORDINATE
SYSTEM OF 1927-NORTH ZONE.
ZONE WAS DERIVED FROM
MEASUREMENTS TAKEN WITH
TRIMBLE GEOXT SUBMETER
MAPPING GRADE GPS UNIT.
PLAT ORIENTATION, CORNER,
AND WELL REFERENCE TIE LINES
ARE BASED ON GRID NORTH.

(NAD) 83 (UTM) ZONE 17 COORDS:
WELL 2H TOP HOLE INFORMATION:
N: 4,363,812m E: 522,880m
BOTTOM HOLE INFORMATION:
N: 4,360,989m E: 524,007m

WV NORTH ZONE
GRID NORTH

PATRICIA C. GUYNN ET AL.
W.S. 34 PG. 323
T.M. 17 PAR. 07
54.5 AC. ±

249A
WELL NO. 2H
47-095-02180

O.W.O. HARDMAN
ET AL LEASE
COASTAL LUMBER COMPANY
D.B. 199 PG. 267
T.M. 17 PAR. 03
766 AC. ±

- NOTE
1. NO OCCUPIED DWELLING AND NO BUILDINGS TWO THOUSAND FIVE HUNDRED (2,500) SQUARE FEET OR LARGER USED TO HOUSE OR SHELTER DAIRY CATTLE OR POULTRY HUSBANDRY ARE LOCATED WITHIN SIX HUNDRED TWENTY-FIVE (625) FEET OF THE CENTER OF THE WELL PAD.
 2. TOP HOLE DATA SHOWN HEREON WAS PROVIDED BY ALLEGHENY SURVEYS, INC.
 3. AS DRILLED DATA WAS PROVIDED BY ANTERO RESOURCES CORPORATION.
 4. WLS IS NOT CERTIFYING THE DATA AND INFORMATION PROVIDED LISTED IN NOTES 2 AND 3, ONLY THE RELATIONSHIP TO THE DATA AND INFORMATION PROVIDED TO THE LEASE BOUNDARIES.
 5. WLS IS BY NO MEANS RESPONSIBLE FOR ANY ERRORS OR INACCURACIES WITH THE DATA AND INFORMATION THAT HAS BEEN PROVIDED.
 6. THIS WELL BORE IS SUBJECT TO THAT 80 FOOT STRIP OF GROUND KNOWN AS THE SISTERSVILLE AND SALEM TURNPIKE WHICH MAY OR MAY NOT COINCIDE WITH STATE ROUTE 23 IN THIS AREA.

PAD LAYOUT

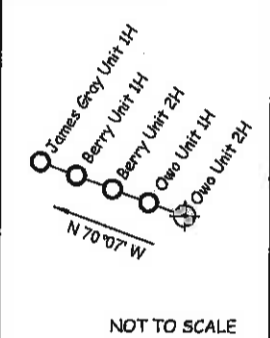

NOT TO SCALE

JOB # 13-115WA
DRAWING # OWOUNIT2HAD
SCALE 1" = 1000'
MINIMUM DEGREE OF ACCURACY SUBMETER
PROVEN SOURCE OF ELEV. SUBMETER MAPPING GRADE GPS

LEGEND

- Surface Owner Boundary Lines +/-
- - - Interior Surface Tracts +/-
- X - Existing Fence
- ⊕ Found monument, as noted
- Proposed Well Path
- ⊗ As Drilled Well Path

DATE 06/23/15
OPERATOR'S WELL# OWO UNIT #2H



STATE OF WEST VIRGINIA, DIVISION
OF ENVIRONMENTAL PROTECTION,
OFFICE OF OIL AND GAS

WILLOW LAND SURVEYING PLLC
220 MASONIC AVE. PENNSBORO
WEST VIRGINIA 26415

STATE OF WEST VIRGINIA DEPARTMENT OF ENERGY
DIVISION OF OIL AND GAS
WELL TYPE: OIL ___ GAS LIQUID INJECTION ___ WASTE DISPOSAL ___
(IF "GAS") PRODUCTION STORAGE ___ DEEP ___ SHALLOW
LOCATION: ELEVATION 1,171' ORIGINAL-1,164' AS DRILLED WATERSHED MCELROY CREEK
QUADRANGLE CENTERPOINT 7 5' DISTRICT MCELROY COUNTY TYLER
SURFACE OWNER COASTAL LUMBER COMPANY ACREAGE 766 ACRES +/-
OIL & GAS ROYALTY OWNER O.W.O. HARDMAN ET AL.; P. NICHOLAS ET AL.; RONALD NOHE ET AL.;
M. FOSTER LIVING TRUST; S.A. SMITH ET AL.; R. SMITH; R. ROBEY

LEASE ACREAGE: 952.3 AC ±; 14.43 AC ±; 50 AC ±; 101,549 AC ±; 443.68 AC ±; 87.75 AC ±; 12,099 AC ±
PROPOSED WORK: DRILL ___ CONVERT ___ DRILL DEEPER ___ REDRILL ___ FRACTURE OR STIMULATE ___
PLUG OFF OLD FORMATION ___ PERFORATE NEW FORMATION ___ OTHER PHYSICAL CHANGE IN WELL ___
(SPECIFY) AS DRILLED ___ PLUG & ABANDON ___ CLEAN OUT & REPLUG ___
TARGET FORMATION MARCELLUS ESTIMATED DEPTH 7,120' TVD 17,118' MD
WELL OPERATOR ANTERO RESOURCES CORP. DESIGNATED AGENT CT CORPORATION SYSTEM-DIANNA STAMPER
ADDRESS 1615 WYNKOOP STREET ADDRESS 5400 D BIG TYLER ROAD
FORM WW-6 DENVER, CO 80202 CHARLESTON, WV 25313

API WELL # 47 - 095 - 02180
STATE COUNTY PERMIT
WELL TYPE: OIL ___ GAS LIQUID INJECTION ___ WASTE DISPOSAL ___
(IF "GAS") PRODUCTION STORAGE ___ DEEP ___ SHALLOW
LOCATION: ELEVATION 1,171' ORIGINAL-1,164' AS DRILLED WATERSHED MCELROY CREEK
QUADRANGLE CENTERPOINT 7 5' DISTRICT MCELROY COUNTY TYLER
SURFACE OWNER COASTAL LUMBER COMPANY ACREAGE 766 ACRES +/-
OIL & GAS ROYALTY OWNER O.W.O. HARDMAN ET AL.; P. NICHOLAS ET AL.; RONALD NOHE ET AL.;
M. FOSTER LIVING TRUST; S.A. SMITH ET AL.; R. SMITH; R. ROBEY
LEASE ACREAGE: 952.3 AC ±; 14.43 AC ±; 50 AC ±; 101,549 AC ±; 443.68 AC ±; 87.75 AC ±; 12,099 AC ±
PROPOSED WORK: DRILL ___ CONVERT ___ DRILL DEEPER ___ REDRILL ___ FRACTURE OR STIMULATE ___
PLUG OFF OLD FORMATION ___ PERFORATE NEW FORMATION ___ OTHER PHYSICAL CHANGE IN WELL ___
(SPECIFY) AS DRILLED ___ PLUG & ABANDON ___ CLEAN OUT & REPLUG ___
TARGET FORMATION MARCELLUS ESTIMATED DEPTH 7,120' TVD 17,118' MD
WELL OPERATOR ANTERO RESOURCES CORP. DESIGNATED AGENT CT CORPORATION SYSTEM-DIANNA STAMPER
ADDRESS 1615 WYNKOOP STREET ADDRESS 5400 D BIG TYLER ROAD
FORM WW-6 DENVER, CO 80202 CHARLESTON, WV 25313

FORM WW-6

DENVER, CO 80202

10/28/2016

COUNTY NAME

PERMIT

James Gray Unit 1H
Berry Unit 1H
Berry Unit 2H
Owo Unit 1H
Owo Unit 2H

JOB # 13-115WA
DRAWING # OWOUNIT2HAD
SCALE 1" = 1000'
MINIMUM DEGREE OF ACCURACY SUBMETER
PROVEN SOURCE OF ELEV. SUBMETER MAPPING GRADE GPS

LEGEND

- Surface Owner Boundary Lines +/-
- - - Interior Surface Tracts +/-
- X - Existing Fence
- ⊕ Found monument, as noted
- Proposed Well Path
- ⊗ As Drilled Well Path

DATE 06/23/15
OPERATOR'S WELL# OWO UNIT #2H



STATE OF WEST VIRGINIA, DIVISION
OF ENVIRONMENTAL PROTECTION,
OFFICE OF OIL AND GAS

WILLOW LAND SURVEYING PLLC
220 MASONIC AVE. PENNSBORO
WEST VIRGINIA 26415

STATE OF WEST VIRGINIA DEPARTMENT OF ENERGY
DIVISION OF OIL AND GAS
WELL TYPE: OIL ___ GAS LIQUID INJECTION ___ WASTE DISPOSAL ___
(IF "GAS") PRODUCTION STORAGE ___ DEEP ___ SHALLOW
LOCATION: ELEVATION 1,171' ORIGINAL-1,164' AS DRILLED WATERSHED MCELROY CREEK
QUADRANGLE CENTERPOINT 7 5' DISTRICT MCELROY COUNTY TYLER
SURFACE OWNER COASTAL LUMBER COMPANY ACREAGE 766 ACRES +/-
OIL & GAS ROYALTY OWNER O.W.O. HARDMAN ET AL.; P. NICHOLAS ET AL.; RONALD NOHE ET AL.;
M. FOSTER LIVING TRUST; S.A. SMITH ET AL.; R. SMITH; R. ROBEY

LEASE ACREAGE: 952.3 AC ±; 14.43 AC ±; 50 AC ±; 101,549 AC ±; 443.68 AC ±; 87.75 AC ±; 12,099 AC ±
PROPOSED WORK: DRILL ___ CONVERT ___ DRILL DEEPER ___ REDRILL ___ FRACTURE OR STIMULATE ___
PLUG OFF OLD FORMATION ___ PERFORATE NEW FORMATION ___ OTHER PHYSICAL CHANGE IN WELL ___
(SPECIFY) AS DRILLED ___ PLUG & ABANDON ___ CLEAN OUT & REPLUG ___
TARGET FORMATION MARCELLUS ESTIMATED DEPTH 7,120' TVD 17,118' MD
WELL OPERATOR ANTERO RESOURCES CORP. DESIGNATED AGENT CT CORPORATION SYSTEM-DIANNA STAMPER
ADDRESS 1615 WYNKOOP STREET ADDRESS 5400 D BIG TYLER ROAD
FORM WW-6 DENVER, CO 80202 CHARLESTON, WV 25313

FORM WW-6

DENVER, CO 80202

10/28/2016

COUNTY NAME

PERMIT

James Gray Unit 1H
Berry Unit 1H
Berry Unit 2H
Owo Unit 1H
Owo Unit 2H

JOB # 13-115WA
DRAWING # OWOUNIT2HAD
SCALE 1" = 1000'
MINIMUM DEGREE OF ACCURACY SUBMETER
PROVEN SOURCE OF ELEV. SUBMETER MAPPING GRADE GPS

LEGEND

- Surface Owner Boundary Lines +/-
- - - Interior Surface Tracts +/-
- X - Existing Fence
- ⊕ Found monument, as noted
- Proposed Well Path
- ⊗ As Drilled Well Path

DATE 06/23/15
OPERATOR'S WELL# OWO UNIT #2H



STATE OF WEST VIRGINIA, DIVISION
OF ENVIRONMENTAL PROTECTION,
OFFICE OF OIL AND GAS

WILLOW LAND SURVEYING PLLC
220 MASONIC AVE. PENNSBORO
WEST VIRGINIA 26415

STATE OF WEST VIRGINIA DEPARTMENT OF ENERGY
DIVISION OF OIL AND GAS
WELL TYPE: OIL ___ GAS LIQUID INJECTION ___ WASTE DISPOSAL ___
(IF "GAS") PRODUCTION STORAGE ___ DEEP ___ SHALLOW
LOCATION: ELEVATION 1,171' ORIGINAL-1,164' AS DRILLED WATERSHED MCELROY CREEK
QUADRANGLE CENTERPOINT 7 5' DISTRICT MCELROY COUNTY TYLER
SURFACE OWNER COASTAL LUMBER COMPANY ACREAGE 766 ACRES +/-
OIL & GAS ROYALTY OWNER O.W.O. HARDMAN ET AL.; P. NICHOLAS ET AL.; RONALD NOHE ET AL.;
M. FOSTER LIVING TRUST; S.A. SMITH ET AL.; R. SMITH; R. ROBEY

LEASE ACREAGE: 952.3 AC ±; 14.43 AC ±; 50 AC ±; 101,549 AC ±; 443.68 AC ±; 87.75 AC ±; 12,099 AC ±
PROPOSED WORK: DRILL ___ CONVERT ___ DRILL DEEPER ___ REDRILL ___ FRACTURE OR STIMULATE ___
PLUG OFF OLD FORMATION ___ PERFORATE NEW FORMATION ___ OTHER PHYSICAL CHANGE IN WELL ___
(SPECIFY) AS DRILLED ___ PLUG & ABANDON ___ CLEAN OUT & REPLUG ___
TARGET FORMATION MARCELLUS ESTIMATED DEPTH 7,120' TVD 17,118' MD
WELL OPERATOR ANTERO RESOURCES CORP. DESIGNATED AGENT CT CORPORATION SYSTEM-DIANNA STAMPER
ADDRESS 1615 WYNKOOP STREET ADDRESS 5400 D BIG TYLER ROAD
FORM WW-6 DENVER, CO 80202 CHARLESTON, WV 25313

FORM WW-6

DENVER, CO 80202

10/28/2016

COUNTY NAME

PERMIT