

Well is located on topo map 11.727 feet west of Longitude: 80° 47' 30"

Blue Mountain Inc.
11023 MASON DIXON HIGHWAY
BURTON, WV 26562
PHONE: (304) 662-6486

FILE #: SHR 3 GHS
DRAWING #: SHR 3 GHS
SCALE: 1" = 2000'
MINIMUM DEGREE OF ACCURACY: 1/2500
PROVEN SOURCE OF ELEVATION: U.S.G.S. MONUMENT THOMAS 1498.81'

I, THE UNDERSIGNED, HEREBY CERTIFY THAT THIS PLAT IS CORRECT TO THE BEST OF MY KNOWLEDGE AND BELIEF AND SHOWS ALL THE INFORMATION REQUIRED BY LAW AND THE REGULATIONS ISSUED AND PRESCRIBED BY THE DEPARTMENT OF ENVIRONMENTAL PROTECTION.

Signed: *George D. Six*
R.P.E.: _____ L.L.S.: P.S. No. 2000

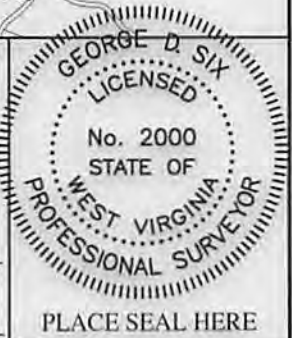

(+) DENOTES LOCATION OF WELL ON UNITED STATES TOPOGRAPHIC MAPS WVDEP
OFFICE OF OIL & GAS
601 57TH STREET
CHARLESTON, WV 25304

DATE: JUNE 12, 2014
OPERATOR'S WELL #: SHR 3 GHS
API WELL #: 47 95 02198 H6A
STATE COUNTY PERMIT

Well Type: Oil Waste Disposal Production Deep
 Gas Liquid Injection Storage Shallow

WATERSHED: HEADWATERS MIDDLE ISLAND CREEK ELEVATION: 751'±
COUNTY/DISTRICT: TYLER / CENTERVILLE QUADRANGLE: SHIRLEY, WV 7.5'
SURFACE OWNER: NOBLE ENERGY INC. ACREAGE: 542.81±
OIL & GAS ROYALTY OWNER: SEE ATTACHED WW-6A1 ACREAGE: 1113.268±

DRILL CONVERT DRILL DEEPER REDRILL FRACTURE OR STIMULATE
PLUG OFF OLD FORMATION PERFORATE NEW FORMATION PLUG & ABANDON
CLEAN OUT & REPLUG OTHER CHANGE (SPECIFY): _____

TARGET FORMATION: MARCELLUS ESTIMATED DEPTH: TVD: 6,359'± TMD: 16,135'±
WELL OPERATOR: NOBLE ENERGY, INC. DESIGNATED AGENT: STEVEN M. GREEN
Address: 333 TECHNOLOGY DRIVE, SUITE 116 Address: 500 VIRGINIA STREET EAST, UNITED CENTER SUITE 590
City: CANONSBURG State: PA Zip Code: 15317 City: CHARLESTON State: WV Zip Code: 25301

08/29/2014

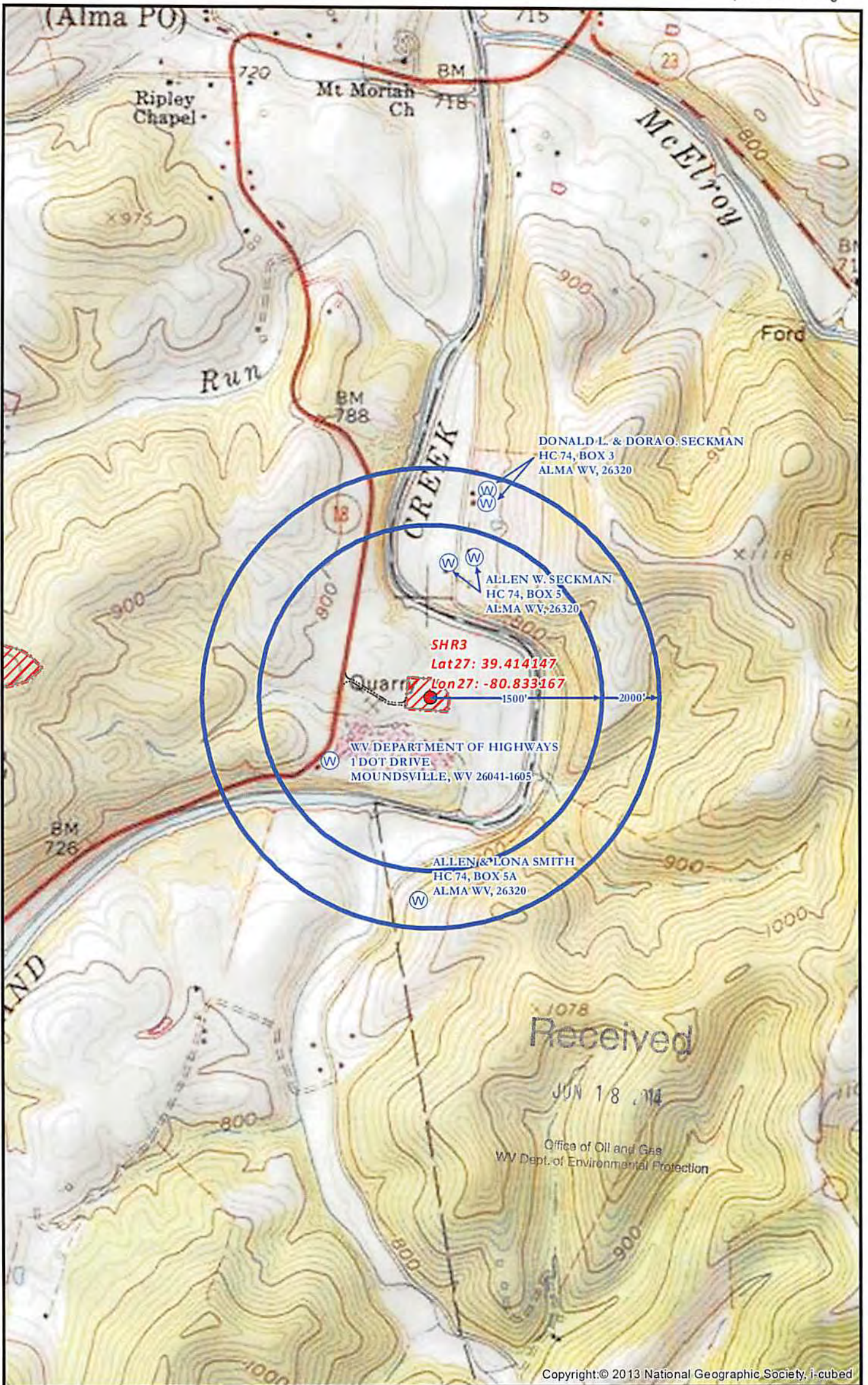

Received
 JUN 18 2014
 Office of Oil and Gas
 WV Dept. of Environmental Protection

Copyright:© 2013 National Geographic Society, i-cubed

SHR3 SITE SAFETY PLAN - WATER WELLS PROXIMITY -		0 500 1000 2000 Feet 1 Inch = 1,000 Feet		*SHR3 911 Address* 9777 Middle Island Rd, Alma, WV 26320		Date: 6/10/2014	
Projection: NAD 1927 StatePlane West Virginia North FIPS 4701 Units: Foot US		noble energy		Author: Tim Husson		6/6	
Disclaimer: All data is licensed for use by Noble Energy Inc. use only.							