

LATITUDE 39°27'30"

8,305'

523' TO BOTTOM HOLE
LATITUDE 39°27'30"

1,906' TO BOTTOM HOLE

LONGITUDE 80°52'30"

9,606'

LONGITUDE 80°50'00"

Antero Resources Corporation
Well No. Jug Unit 1H
47-095-02265 (AS DRILLED)

STATE OF WV DNR
D.B. 215 PG. 520
T.M. 27 PAR. 02
405.81 AC. ±

DAVID L. MAPLE LEASE
STATE OF WV DNR
D.B. 227 PG. 141
T.M. 27 PAR. 28
88.75 AC. ±

STATE OF WV DNR
D.B. 307 PG. 217
T.M. 27 PAR. 25
100 AC. ±

AS DRILLED DATA:
WELL 1H TOP HOLE INFORMATION:
N: 342,359ft E: 1,615,093ft
LAT: 39°25'55.06" LON: 80°51'45.85"
BOTTOM HOLE INFORMATION:
N: 350,118ft E: 1,611,224ft
LAT: 39°27'11.16" LON: 80°52'36.66"
WEST VIRGINIA COORDINATE SYSTEM OF 1927 NORTH ZONE. ZONE WAS DERIVED FROM MEASUREMENTS TAKEN WITH TRIMBLE GEOXT SUBMETER MAPPING GRADE GPS UNIT. PLAT ORIENTATION, CORNER, AND WELL REFERENCE TIE LINES ARE BASED ON GRID NORTH.

(NAD) 83 (UTM) ZONE 17 COORDS:
WELL 1H TOP HOLE INFORMATION:
N: 4,364,731m E: 511,828m
BOTTOM HOLE INFORMATION:
N: 4,367,076m E: 510,610m

PAD LAYOUT

NOT TO SCALE

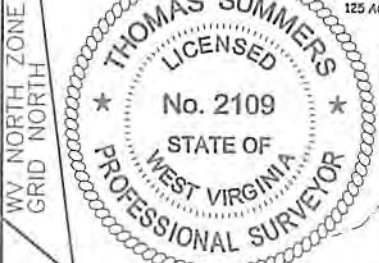
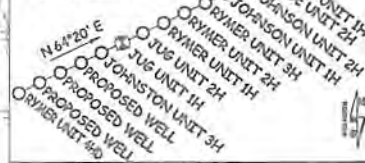

- NOTE:
1. NO OCCUPIED DWELLINGS OR BUILDINGS TWO THOUSAND FIVE HUNDRED (2,500) SQUARE FEET OR LARGER USED TO HOUSE OR SHELTER DAIRY CATTLE OR POULTRY HUSBANDRY ARE LOCATED WITHIN SIX HUNDRED TWENTY-FIVE (625) FEET OF THE CENTER OF THE WELL PAD.
2. TOP HOLE DATA SHOWN HEREON WAS PROVIDED BY ALLEGHENY SURVEYS, INC.
3. AS DRILLED DATA WAS PROVIDED BY ANTERO RESOURCES CORPORATION.
4. WLS IS NOT CERTIFYING THE DATA AND INFORMATION PROVIDED LISTED IN NOTES 2 AND 3, ONLY THE RELATIONSHIP TO THE DATA AND INFORMATION PROVIDED TO THE LEASE BOUNDARIES.
5. WLS IS BY NO MEANS RESPONSIBLE FOR ANY ERRORS OR INACCURACIES WITH THE DATA AND INFORMATION THAT HAS BEEN PROVIDED.
6. UNIT BOUNDARY SHOWN HEREON IS GREATER THAN 400' FROM THE AS-DRILLED WELLBORE. AS-DRILLED WELLBORE CONFORMS TO THE 400' UNIT BOUNDARY SETBACK REQUIREMENTS.

NOTE: 4 WATER WELLS AND 1 SPRING WERE LOCATED WITHIN 2000' OF CENTER OF PAD

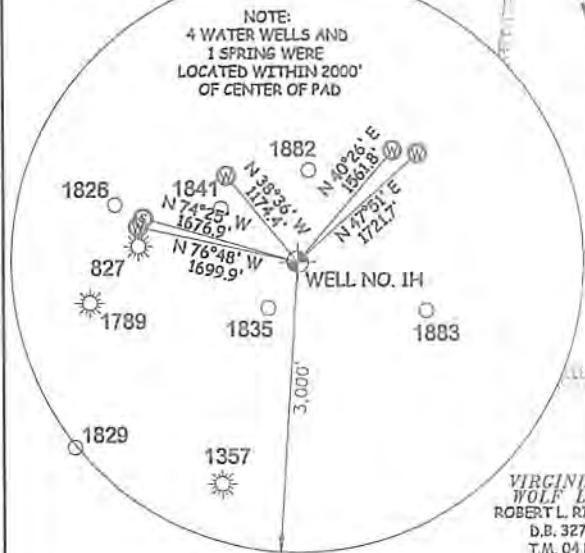

I, THE UNDERSIGNED, HEREBY CERTIFY THAT THIS PLAT IS CORRECT TO THE BEST OF MY KNOWLEDGE AND BELIEF AND SHOWS ALL THE INFORMATION REQUIRED BY LAW AND THE RULES ISSUED AND PERSCRIBED BY THE DEPARTMENT OF ENVIRONMENTAL PROTECTION.



STATE OF WEST VIRGINIA, DIVISION OF ENVIRONMENTAL PROTECTION, OFFICE OF OIL AND GAS

WILLOW LAND SURVEYING PLLC 220 MASONIC AVE. PENNSBORO WEST VIRGINIA 26415

JOB # 13-102WA
DRAWING # JUG1HAD
SCALE 1" = 1000'
MINIMUM DEGREE OF ACCURACY SUBMETER
PROVEN SOURCE OF ELEV. SUBMETER MAPPING GRADE GPS
STATE OF WEST VIRGINIA DEPARTMENT OF ENERGY DIVISION OF OIL AND GAS

Table with 2 columns: Description and Date/Operator. Includes 'LEGEND' for boundary lines and well paths, and 'DATE 09/28/17 OPERATOR'S WELL # JUG UNIT #1H'.

WELL TYPE: OIL GAS X LIQUID INJECTION WASTE DISPOSAL 47 - 095 - 02265
(IF "GAS") PRODUCTION X STORAGE DEEP SHALLOW X STATE COUNTY PERMIT
LOCATION: ELEVATION 1,017' AS DRILLED WATERSHED HEADWATERS MIDDLE ISLAND CREEK
QUADRANGLE SHIRLEY 7.5' - SHL MIDDLEBOURNE 7.5' - BHL DISTRICT CENTERVILLE COUNTY TYLER
SURFACE OWNER RAYMOND UNDERWOOD ACREAGE 23 ACRES +/-
OIL & GAS ROYALTY OWNER RAYMOND V. UNDERWOOD ET UX; W.V. DIVISION OF NATURAL RESOURCES; LEASE ACREAGE 96 ACRES +/-; 244.25 ACRES +/-;
NORMAN FLEMING ET UX; RAYMOND V. UNDERWOOD ET UX; VIRGINIA R. WOLF; CATHY JO ASH ET AL; MARK DOUGLAS FLETCHER 23.69 ACRES +/-; 76.5 AC +/-; 126 AC +/-; 315.25 AC +/-; 88 ACRES +/-
PROPOSED WORK: DRILL CONVERT DRILL DEEPER REDRILL FRACTURE OR STIMULATE
PLUG OFF OLD FORMATION PERFORATE NEW FORMATION OTHER PHYSICAL CHANGE IN WELL
(SPECIFY) AS DRILLED PLUG & ABANDON CLEAN OUT & REPLUG
TARGET FORMATION MARCELLUS ESTIMATED DEPTH 6,472' TVD 15,034' MD
WELL OPERATOR ANTERO RESOURCES CORP. DESIGNATED AGENT DIANNA STAMPER - CT CORPORATION SYSTEM
ADDRESS 1615 WYNKOOP STREET ADDRESS 5400 D BIG TYLER ROAD
DENVER, CO 80202 CHARLESTON, WV 25313

02/16/2018