

LATITUDE 39°25'00" 862'

LATITUDE 39°27'30" 2,140' TO BOTTOM HOLE

LONGITUDE 80°52'30" 930'

LONGITUDE 80°52'30" 9,322' TO BOTTOM HOLE

NOTES:
WELL 3HD TOP HOLE INFORMATION:
 N: 335,925ft E: 1,610,667ft
 LAT: 39°24'50.81" LON: 80°52'40.98"
BOTTOM HOLE INFORMATION:
 N: 342,733ft E: 1,609,493ft
 LAT: 39°25'57.91" LON: 80°52'57.28"
 WEST VIRGINIA COORDINATE SYSTEM OF 1927 NORTH ZONE. ZONE WAS DERIVED FROM MEASUREMENTS TAKEN WITH TRIMBLE GEOXT SUBMETER MAPPING GRADE GPS UNIT. PLAT ORIENTATION, CORNER, AND WELL REFERENCE TIE LINES ARE BASED ON GRID NORTH.

(NAD) 83 (UTM) ZONE 17 COORDS:
WELL 3HD TOP HOLE INFORMATION:
 N: 4,362,749m E: 510,513m
BOTTOM HOLE INFORMATION:
 N: 4,364,817m E: 510,120m

WV NORTH ZONE GRID NORTH

Antero Resources Corporation
Well No. Lucy Unit 3HD
189.13 Unit Acres

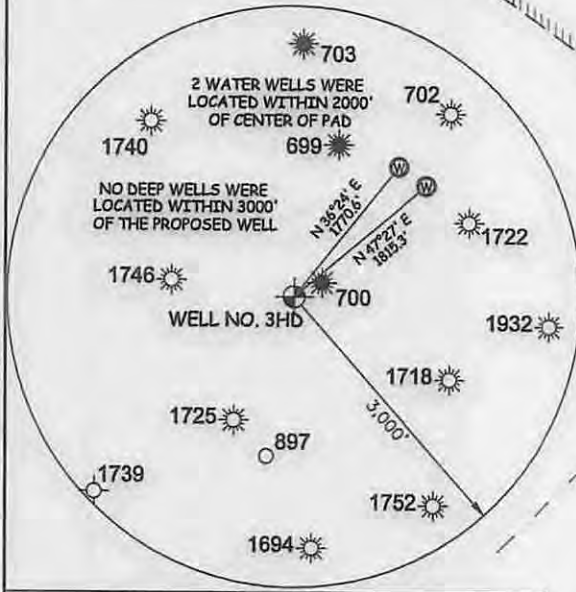

LEGEND

- Unit Boundary Lines +/-
- Interior Surface Tracts +/-
- Existing Fence
- Found monument, as noted

THOMAS SUMMERS P.S. 2109

DATE 05/20/15

OPERATOR'S WELL# LUCY UNIT #3HD

I THE UNDERSIGNED, HEREBY CERTIFY THAT THIS PLAT IS CORRECT TO THE BEST OF MY KNOWLEDGE AND BELIEF AND SHOWS ALL THE INFORMATION REQUIRED BY LAW AND THE RULES ISSUED AND PERSCRIBED BY THE DEPARTMENT OF ENVIRONMENTAL PROTECTION.



STATE OF WEST VIRGINIA, DIVISION OF ENVIRONMENTAL PROTECTION, OFFICE OF OIL AND GAS

WILLOW LAND SURVEYING PLLC
 220 MASONIC AVE. PENNSBORO WEST VIRGINIA 26415

JOB # 15-008WA
 DRAWING # LUCY3HDR2
 SCALE 1" = 1000'
 MINIMUM DEGREE OF ACCURACY SUBMETER
 PROVEN SOURCE OF ELEV. SUBMETER MAPPING GRADE GPS

STATE OF WEST VIRGINIA DEPARTMENT OF ENERGY DIVISION OF OIL AND GAS



WELL TYPE: OIL GAS LIQUID INJECTION WASTE DISPOSAL 47 - 095 - 0227246A

(IF "GAS") PRODUCTION STORAGE DEEP SHALLOW

LOCATION: ELEVATION 1,160' - ORIGINAL 1,141' - PROPOSED WATERSHED HEADWATERS MIDDLE ISLAND CREEK STATE COUNTY PERMIT COUNTY NAME

QUADRANGLE MIDDLEBOURNE 7.5' DISTRICT CENTERVILLE COUNTY TYLER 07/03/2015

SURFACE OWNER EDNA MONROE ACREAGE 110.32 ACRES +/-

OIL & GAS ROYALTY OWNER CARL W. NOLAN; CARL W. NOLAN; CARL BAKER; LEASE ACREAGE 116 AC ±; 170 AC ±; 87 AC ±; WVDNR; MELVIN WILEY ET UX; REGINA M. BUCK 553.16 AC ±; 378 AC ±; 309.55 AC ±

PROPOSED WORK: DRILL CONVERT DRILL DEEPER REDRILL FRACTURE OR STIMULATE PLUG OFF OLD FORMATION PERFORATE NEW FORMATION OTHER PHYSICAL CHANGE IN WELL (SPECIFY) PLUG & ABANDON CLEAN OUT & REPLUG

TARGET FORMATION POINT PLEASANT ESTIMATED DEPTH 12,000' TVD 19,200' MD

WELL OPERATOR ANTERO RESOURCES CORP. DESIGNATED AGENT DIANNA STAMPER - CT CORPORATION SYSTEM PERMIT

ADDRESS 1615 WYNKOOP ST. ADDRESS 5400 D BIG TYLER ROAD CHARLESTON, WV 25313

09 50 2272

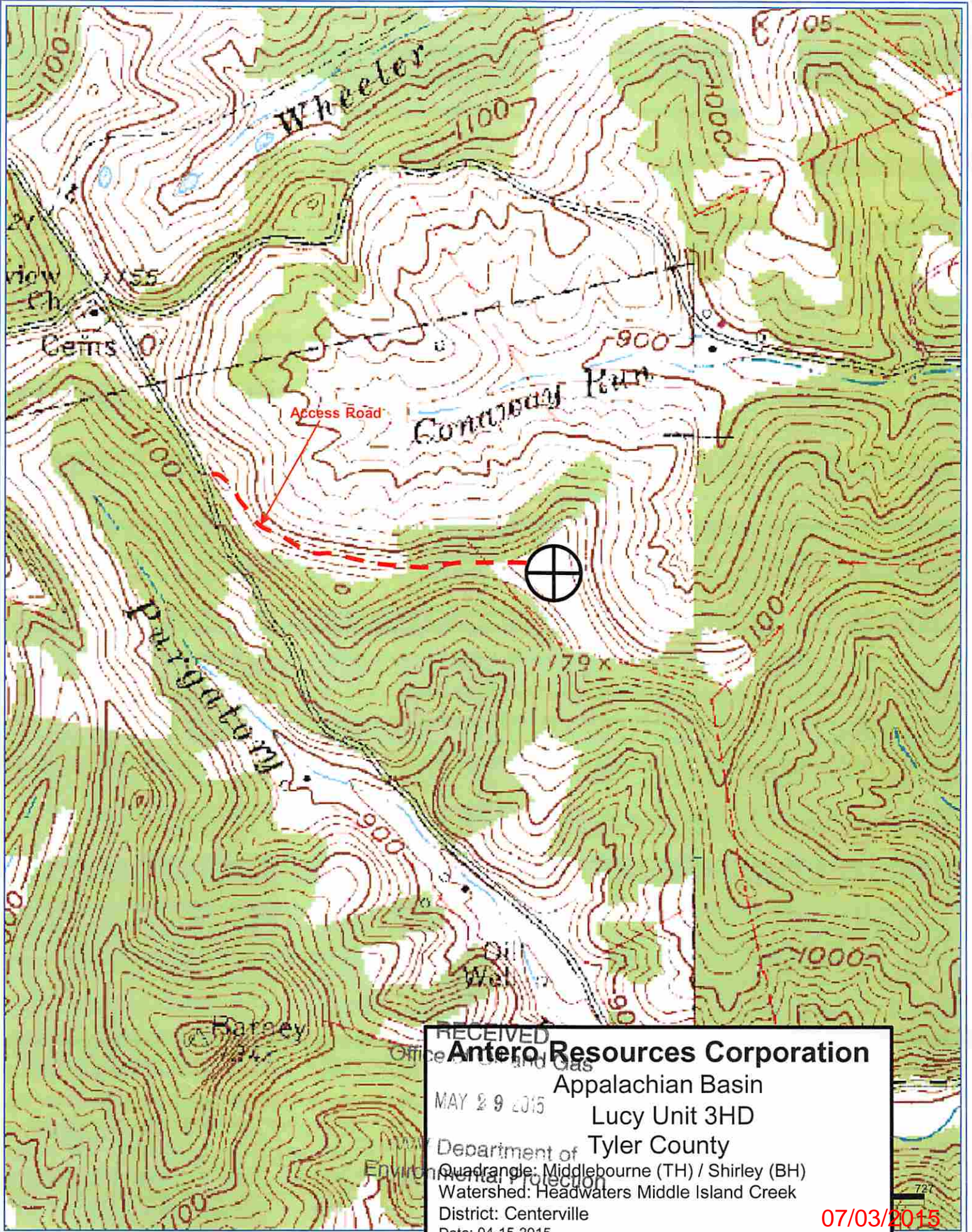

RECEIVED
 Office of Oil and Gas
Antero Resources Corporation
 Appalachian Basin
 Lucy Unit 3HD
 Tyler County
 Department of Environmental Protection
 Quadrangle: Middlebourne (TH) / Shirley (BH)
 Watershed: Headwaters Middle Island Creek
 District: Centerville
 Date: 04-15-2015

07/03/2015