

LATITUDE 39°27'30"

11,310'

1,750' TO BOTTOM HOLE  
LATITUDE 39°27'30"

**Antero Resources Corporation**  
**Well No. Seckman Unit 1H**  
**47-095-02284 (AS DRILLED)**

**AS DRILLED NOTES:**  
**WELL 1H TOP HOLE INFORMATION:**  
N: 339,061ft E: 1,612,038ft  
LAT: 39°25'22.01" LON: 80°52'24.13"  
**BOTTOM HOLE INFORMATION:**  
N: 347,520ft E: 1,609,958ft  
LAT: 39°26'46.28" LON: 80°52'52.31"  
WEST VIRGINIA COORDINATE SYSTEM OF 1927 NORTH ZONE. ZONE WAS DERIVED FROM MEASUREMENTS TAKEN WITH TRIMBLE GEOXT SUBMETER MAPPING GRADE GPS UNIT. PLAT ORIENTATION, CORNER, AND WELL REFERENCE TIE LINES ARE BASED ON GRID NORTH.

**(NAD) 83 (UTM) ZONE 17 COORDS:**  
**WELL 1H TOP HOLE INFORMATION:**  
N: 4,363,711m E: 510,914m  
**BOTTOM HOLE INFORMATION:**  
N: 4,366,308m E: 510,237m

WV NORTH ZONE  
GRID NORTH

81.02/2015.0



I THE UNDERSIGNED, HEREBY CERTIFY THAT THIS PLAT IS CORRECT TO THE BEST OF MY KNOWLEDGE AND BELIEF AND SHOWS ALL THE INFORMATION REQUIRED BY LAW AND THE RULES ISSUED AND PERSCRIBED BY THE DEPARTMENT OF ENVIRONMENTAL PROTECTION.



STATE OF WEST VIRGINIA, DIVISION OF ENVIRONMENTAL PROTECTION, OFFICE OF OIL AND GAS

WILLOW LAND SURVEYING PLLC  
220 MASONIC AVE. PENNSBORO  
WEST VIRGINIA 26415

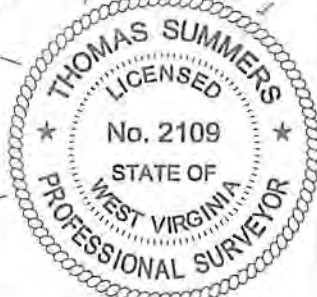
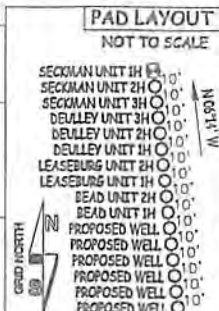

JOB # 14-026WA  
DRAWING # SECKMAN1HAD  
SCALE 1" = 2000'  
MINIMUM DEGREE OF ACCURACY SUBMETER  
PROVEN SOURCE OF ELEV. SUBMETER MAPPING GRADE GPS  
STATE OF WEST VIRGINIA DEPARTMENT OF ENERGY DIVISION OF OIL AND GAS

**LEGEND**  
- - - - - Surface Owner Boundary Lines +/-  
- - - - - Interior Surface Tracts +/-  
⊕ Found monument, as noted  
○ Proposed Well Path  
○ As Drilled Well Path  
THOMAS SUMMERS P.S. 2109  
DATE 12/13/17  
OPERATOR'S WELL# SECKMAN UNIT #1H

**NOTE**  
1. NO OCCUPIED DWELLINGS OR BUILDINGS TWO THOUSAND FIVE HUNDRED (2,500) SQUARE FEET OR LARGER USED TO HOUSE OR SHELTER DAIRY CATTLE OR POULTRY HUSBANDRY ARE LOCATED WITHIN SIX HUNDRED TWENTY-FIVE (625) FEET OF THE CENTER OF THE WELL PAD.  
2. TOP HOLE DATA SHOWN HEREON WAS PROVIDED BY ALLEGHENY SURVEYS, INC.  
3. AS DRILLED DATA WAS PROVIDED BY ANTERO RESOURCES CORPORATION.  
4. WLS IS NOT CERTIFYING THE DATA AND INFORMATION PROVIDED LISTED IN NOTES 2 AND 3, ONLY THE RELATIONSHIP TO THE DATA AND INFORMATION PROVIDED TO THE LEASE BOOKSHEETS.  
5. WLS IS BY NO MEANS RESPONSIBLE FOR ANY ERRORS OR INACCURACIES WITH THE DATA AND INFORMATION THAT HAS BEEN PROVIDED.

WELL TYPE: OIL \_\_\_ GAS  LIQUID INJECTION \_\_\_ WASTE DISPOSAL \_\_\_  
(IF "GAS") PRODUCTION  STORAGE \_\_\_ DEEP \_\_\_ SHALLOW  47 - 095 - 02284  
LOCATION: ELEVATION 1,044' - AS DRILLED WATERSHED HEADWATERS MIDDLE ISLAND CREEK STATE COUNTY TYLER PERMIT  
QUADRANGLE SHIRLEY 7.5' - TOP HOLE MIDDLEBOURNE 7.5' - BOTTOM HOLE DISTRICT CENTERVILLE COUNTY TYLER  
SURFACE OWNER EDNA MONROE ACREAGE 87 ACRES +/-  
OIL & GAS ROYALTY OWNER CARL BAKER; FORREST E. LEASEBURG ET UX; RAYMOND V. UNDERWOOD ET UX; LEASE ACREAGE 126 AC.±; 34.5 AC.±; 315.25 AC.±; 465 AC.±  
PROPOSED WORK: DRILL \_\_\_ CONVERT \_\_\_ DRILL DEEPER \_\_\_ REDRILL \_\_\_ FRACTURE OR STIMULATE \_\_\_  
PLUG OFF OLD FORMATION \_\_\_ PERFORATE NEW FORMATION \_\_\_ OTHER PHYSICAL CHANGE IN WELL (SPECIFY) AS DRILLED  
TARGET FORMATION MARCELLUS ESTIMATED DEPTH 6,503' TVD 15,612' MD  
WELL OPERATOR ANTERO RESOURCES CORP. DESIGNATED AGENT DIANNA STAMPER - CT CORPORATION SYSTEM  
ADDRESS 1615 WYNKOOP ST. ADDRESS 5400 D BIG TYLER ROAD  
DENVER, CO 80202 CHARLESTON, WV 25313

4,423' TO BOTTOM HOLE LONGITUDE 80°52'30"  
LONGITUDE 80°50'00"