

AS DRILLED DATA:
WELL 3H TOP HOLE INFORMATION:
 N: 354,761ft E: 1,618,134ft
 LAT: 39°27'58.09" LON: 80°51'09.47"
BOTTOM HOLE INFORMATION:
 N: 364,141ft E: 1,616,951ft
 LAT: 39°29'30.61" LON: 80°51'26.36"
 WEST VIRGINIA COORDINATE SYSTEM OF 1927 NORTH ZONE. ZONE WAS DERIVED FROM MEASUREMENTS TAKEN WITH TREMBLE GEOXT SUBMETER MAPPING GRADE GPS UNIT. PLAT ORIENTATION, CORNER, AND WELL REFERENCE TIE LINES ARE BASED ON GRID NORTH.

(NAD) 83 (UTM) ZONE 17 COORDS:
WELL 3H TOP HOLE INFORMATION:
 N: 4,368,525m E: 512,692m
BOTTOM HOLE INFORMATION:
 N: 4,371,377m E: 512,283m



- NOTE
1. NO OCCUPIED DWELLINGS OR BUILDINGS TWO THOUSAND FIVE HUNDRED (2,500) SQUARE FEET OR LARGER USED TO HOUSE OR SHELTER DAIRY CATTLE OR POULTRY HUSBANDRY ARE LOCATED WITHIN SIX HUNDRED TWENTY-FIVE (625) FEET OF THE CENTER OF THE WELL PAD.
 2. TOP HOLE DATA SHOWN HEREON WAS PROVIDED BY ALLEGHENY SURVEYS, INC.
 3. AS DRILLED DATA WAS PROVIDED BY ANTERO RESOURCES CORPORATION.
 4. WLS IS NOT CERTIFYING THE DATA AND INFORMATION PROVIDED LISTED IN NOTES 2 AND 3, ONLY THE RELATIONSHIP TO THE DATA AND INFORMATION PROVIDED TO THE LEASE BOUNDARIES.
 5. WLS IS BY NO MEANS RESPONSIBLE FOR ANY ERRORS OR INACCURACIES WITH THE DATA AND INFORMATION THAT HAS BEEN PROVIDED.

- A - GLYDE E. YOST ET AL D.B. 290 PG. 674 T.M. 21 PAR. 51.1 1.812 AC. ±
- B - PATRICIA KELLER D.B. 334 PG. 530 T.M. 21 PAR. 51.4 3.37 AC. ±
- C - THOMAS E. KELLER ET AL D.B. 321 PG. 307 T.M. 21 PAR. 51.3 5.431 AC. ±
- D - RANDY S. WAGGONER D.B. 342 PG. 637 T.M. 21 PAR. 51.2 2.02 AC. ±
- E - BOARD OF EDUCATION D.B. 204 PG. 342 T.M. 21 PAR. 46 12.53 AC. ±
- F - BOARD OF EDUCATION D.B. 323 PG. 362 T.M. 21 PAR. 47.1 0.460 AC. ±
- G - TYLER CO. FAIR ASSOC. D.B. 189 PG. 453 T.M. 21 PAR. 47 26.20 AC. ±

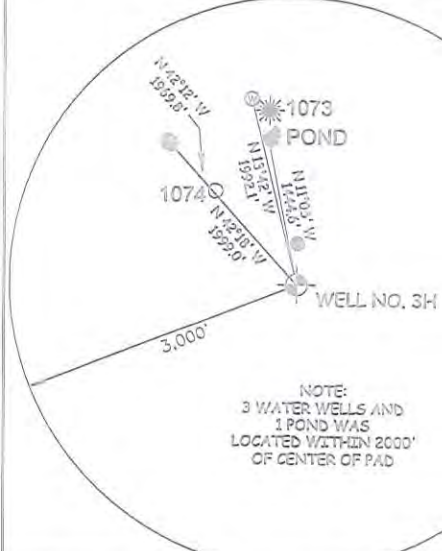

I, THE UNDERSIGNED, HEREBY CERTIFY THAT THIS PLAT IS CORRECT TO THE BEST OF MY KNOWLEDGE AND BELIEF AND SHOWS ALL THE INFORMATION REQUIRED BY LAW AND THE RULES ISSUED AND PERSCRIBED BY THE DEPARTMENT OF ENVIRONMENTAL PROTECTION.



STATE OF WEST VIRGINIA, DIVISION OF ENVIRONMENTAL PROTECTION, OFFICE OF OIL AND GAS
 WILLOW LAND SURVEYING PLLC
 220 MASONIC AVE. PENNSBORO WEST VIRGINIA 26415

JOB # 15-052WA
 DRAWING # OWENS3HAD
 SCALE 1" = 1000'
 MINIMUM DEGREE OF ACCURACY SUBMETER
 PROVEN SOURCE OF ELEV. SUBMETER MAPPING GRADE GPS
 STATE OF WEST VIRGINIA DEPARTMENT OF ENERGY DIVISION OF OIL AND GAS

LEGEND
 - - - - - Surface Owner Boundary Lines +/-
 - - - - - Interior Surface Tracts +/-
 - - - - - Proposed Well Path
 ○ As Drilled Well Path

DOUGLAS R. ROWE P.S. 2202
 DATE 12/27/18
 OPERATOR'S WELL # OWENS UNIT #3H

WELL TYPE: OIL ___ GAS X LIQUID INJECTION ___ WASTE DISPOSAL ___
 (IF "GAS") PRODUCTION X STORAGE ___ DEEP ___ SHALLOW X
 LOCATION: ELEVATION 812' AS-BUILT WATERSHED OUTLET MIDDLE ISLAND CREEK
 QUADRANGLE SHIRLEY 7.5' DISTRICT ELLSWORTH COUNTY TYLER
 SURFACE OWNER EDWIN C. WEIGLE ACREAGE 60.19 ACRES +/-
 OIL & GAS ROYALTY OWNER KATHY ANN SEACO; RICHARD L. SEACO ET UX; LYNDIA SPELLMAN; EDWIN C. WEIGLE HEIRS;
 EDWIN C. WEIGLE HEIRS; EDWIN C. WEIGLE HEIRS; IVYONNE; RONALD RAY JONES, SR. ET UX; EUGENE R. SMITH; CHARLES P. BAKER ET UX; MARK BRADLEY WINN; RIDGETOP CAPITAL, II 35.00 AC. ±; 93 AC. ±; 34 AC. ±; 10.16 AC. ±; 87.37 AC. ±; 81 AC. ±; 60.50 AC. ±; 83.68 AC. ±
 PROPOSED WORK: DRILL ___ CONVERT ___ DRILL DEEPER ___ REDRILL ___ FRACTURE OR STIMULATE ___
 PLUG OFF OLD FORMATION ___ PERFORATE NEW FORMATION ___ OTHER PHYSICAL CHANGE IN WELL (SPECIFY) AS DRILLED
 TARGET FORMATION MARCELLUS PLUG & ABANDON CLEAN OUT & REPLUG
 WELL OPERATOR ANTERO RESOURCES CORP. ESTIMATED DEPTH 6,307' TVD 16,185' MD
 ADDRESS 1615 WYNKOOP STREET ADDRESS DIANNA STAMPER - CT CORPORATION SYSTEM
 FORM WW-6 DENVER, CO 80202 CHARLESTON, WV 25313

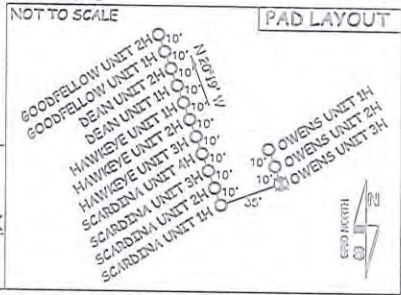

LONGITUDE 80°50'00"
 2,975' TO BOTTOM HOLE
 12,335'
 LONGITUDE 80°50'00"
 COUNTY NAME
 PERMIT