

**Antero Resources Corporation**  
Well No. Owens Unit 3H  
API # 47-095-02326

**AS DRILLED DATA:**  
WELL 3H TOP HOLE INFORMATION:  
N: 354,761ft E: 1,618,134ft  
LAT: 39°27'58.09" LON: 80°51'09.47"  
BOTTOM HOLE INFORMATION:  
N: 364,141ft E: 1,616,951ft  
LAT: 39°29'30.61" LON: 80°51'20.00"  
WEST VIRGINIA COORDINATE SYSTEM OF 1927 NORTH ZONE. ZONE WAS DERIVED FROM MEASUREMENTS TAKEN WITH TRIMBLE GEOXT SUBMETER MAPPING GRADE GPS UNIT. PLAT ORIENTATION, CORNER, AND WELL REFERENCE TIE LINES ARE BASED ON GRID NORTH.

(NAD) 83 (UTM) ZONE 17 COORDS:  
WELL 3H TOP HOLE INFORMATION:  
N: 4,368,525m E: 512,692m  
BOTTOM HOLE INFORMATION:  
N: 4,371,377m E: 512,283m

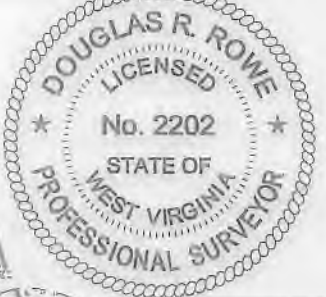

47 - 095 - 02326  
STATE COUNTY PERMIT

- A - CLYDE E. YOST ET AL D.B. 296 PG. 674 T.M. 21 PAR. 51.1 1.812 AC. ±
- B - PATRICIA KELLER D.B. 334 PG. 530 T.M. 21 PAR. 51.4 3.37 AC. ±
- C - THOMAS E. KELLER ET AL D.B. 321 PG. 807 T.M. 21 PAR. 51.3 5.431 AC. ±
- D - RANDY S. WAGGONER D.B. 342 PG. 637 T.M. 21 PAR. 51.2 2.02 AC. ±
- E - BOARD OF EDUCATION D.B. 204 PG. 342 T.M. 21 PAR. 46 12.53 AC. ±
- F - BOARD OF EDUCATION D.B. 323 PG. 362 T.M. 21 PAR. 47.1 0.468 AC. ±
- G - TYLER CO. FAIR ASSOC. D.B. 189 PG. 485 T.M. 21 PAR. 47 26.20 AC. ±

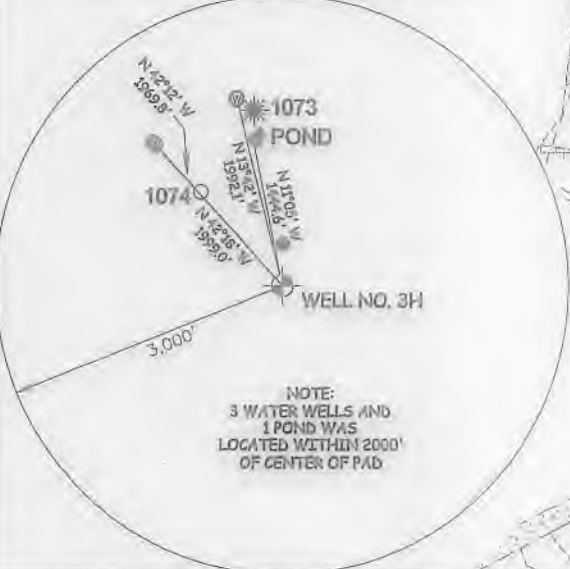

**NOTE**  
1. NO OCCUPIED DWELLINGS OR BUILDINGS TWO THOUSAND FIVE HUNDRED (2,500) SQUARE FEET OR LARGER USED TO HOUSE OR SHELTER DAIRY CATTLE OR POULTRY HUSBANDRY ARE LOCATED WITHIN 500' HUNDRED TWENTY-FIVE (625) FEET OF THE CENTER OF THE WELL PAD.  
2. TOP HOLE DATA SHOWN HEREON WAS PROVIDED BY ALLEGHENY SURVEYS, INC.  
3. AS DRILLED DATA WAS PROVIDED BY ANTERO RESOURCES CORPORATION.  
4. WLS IS NOT CERTIFYING THE DATA AND INFORMATION PROVIDED LISTED IN NOTES 2 AND 3, ONLY THE RELATIONSHIP TO THE DATA AND INFORMATION PROVIDED TO THE LEASE BOUNDARIES.  
5. WLS IS BY NO MEANS RESPONSIBLE FOR ANY ERRORS OR INACCURACIES WITH THE DATA AND INFORMATION THAT HAS BEEN PROVIDED.

I THE UNDERSIGNED, HEREBY CERTIFY THAT THIS PLAT IS CORRECT TO THE BEST OF MY KNOWLEDGE AND BELIEF AND SHOWS ALL THE INFORMATION REQUIRED BY LAW AND THE RULES ISSUED AND PERSCRIBED BY THE DEPARTMENT OF ENVIRONMENTAL PROTECTION.



STATE OF WEST VIRGINIA, DIVISION OF ENVIRONMENTAL PROTECTION, OFFICE OF OIL AND GAS

WILLOW LAND SURVEYING PLLC  
220 MASONIC AVE. PENNSBORO WEST VIRGINIA 26415

**REBAR FOUND**  
LORETTA J. FULK'S  
D.B. 212 PG. 10 T.M. 27 PAR. 8 35 AC. ±  
**RICHARD I. SEAGO ET UX LEASE**  
EDWIN C. WEIGLE ET AL  
A.P. 40 PG. 793 T.M. 27 PAR. 21 85.03 AC. ±

JOB # 15-052WA  
DRAWING # OWENS3HAD  
SCALE 1" = 1000'  
MINIMUM DEGREE OF ACCURACY SUBMETER  
PROVEN SOURCE OF ELEV. SUBMETER MAPPING GRADE GPS  
STATE OF WEST VIRGINIA DEPARTMENT OF ENERGY DIVISION OF OIL AND GAS

**LEGEND**  
--- Surface Owner Boundary Lines +/-  
--- Interior Surface Tracts +/-  
--- Proposed Well Path  
--- As Drilled Well Path  
*D. Rowe*  
DOUGLAS R. ROWE P.S. 2202  
DATE 12/27/18  
OPERATOR'S WELL# OWENS UNIT #3H

WELL TYPE: OIL \_\_\_ GAS  LIQUID INJECTION \_\_\_ WASTE DISPOSAL \_\_\_  
(IF "GAS") PRODUCTION  STORAGE \_\_\_ DEEP \_\_\_ SHALLOW   
LOCATION: ELEVATION 812' AS-BUILT WATERSHED OUTLET MIDDLE ISLAND CREEK  
QUADRANGLE SHIRLEY 7.5' DISTRICT FILLSWORTH COUNTY TYLER  
SURFACE OWNER EDWIN C. WEIGLE ACREAGE 60.10 ACRES +/-  
OIL & GAS ROYALTY OWNER KATHY ANN SEAGO; RICHARD I. SEAGO ET UX; LYNDIA SPELLMAN; EDWIN C. WEIGLE HEIRS;  
EDWIN C. WEIGLE HEIRS; EDWIN C. WEIGLE HEIRS; LYDIA SPELLMAN; ROGER R. JONES, SR. ET UX; EUGENE R. SMITH; CHARLES P. BAKER ET UX; MARK BRADLEY WINN; RIDGETOP CAPITAL, II  
35.08 AC. ±; 03 AC. ±; 34 AC. ±; 10.16 AC. ±; 87.37 AC. ±; 81 AC. ±; 81.53 AC. ±; 83.89 AC. ±  
PROPOSED WORK: DRILL \_\_\_ CONVERT \_\_\_ DRILL DEEPER \_\_\_ REDRILL \_\_\_ FRACTURE OR STIMULATE \_\_\_  
PLUG OFF OLD FORMATION \_\_\_ PERFORATE NEW FORMATION \_\_\_ OTHER PHYSICAL CHANGE IN WELL  
(SPECIFY) AS DRILLED PLUG & ABANDON CLEAN OUT & REPLUG  
TARGET FORMATION MARCELLUS ESTIMATED DEPTH 8,307' TVD 16,185' MD  
WELL OPERATOR ANTERO RESOURCES CORP. DESIGNATED AGENT DIANNA STAMPER - CT CORPORATION SYSTEM  
ADDRESS 1615 WYNKOOP STREET ADDRESS 5400 D BIG TYLER ROAD  
FORM WW-6 DENVER, CO 80202 CHARLESTON, WV 25313



LONGITUDE 80°50'00" COUNTY NAME PERMIT