

LATITUDE 39°27'30"

7,256'

11,592' TO BOTTOM HOLE

LATITUDE 39°30'00"

LONGITUDE 80°50'00"

LONGITUDE 80°50'00"

Antero Resources Corporation
Well No. Klondike Unit 2H
API #47-095-02328

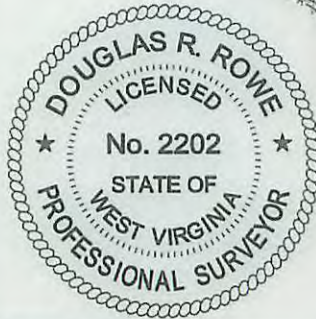

NOTES:
WELL 2H TOP HOLE INFORMATION:
N: 349,658ft E: 1,616,250ft
LAT: 39°27'07.37" LON: 80°51'32.51"
BOTTOM HOLE INFORMATION:
N: 359,890ft E: 1,612,065ft
LAT: 39°28'47.87" LON: 80°52'27.84"
WEST VIRGINIA COORDINATE SYSTEM OF 1927 NORTH ZONE. ZONE WAS DERIVED FROM MEASUREMENTS TAKEN WITH TRIMBLE GEOXT SUBMETER MAPPING GRADE GPS UNIT. PLAT ORIENTATION, CORNER, AND WELL REFERENCE TIE LINES ARE BASED ON GRID NORTH.

(NAD) 83 (UTM) ZONE 17 COORDS:
WELL 2H TOP HOLE INFORMATION:
N: 4,366,961m E: 512,144m
BOTTOM HOLE INFORMATION:
N: 4,370,057m E: 510,817m

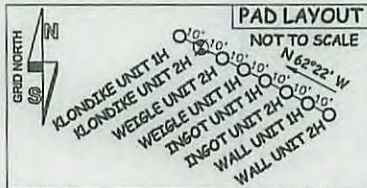

REFERENCES

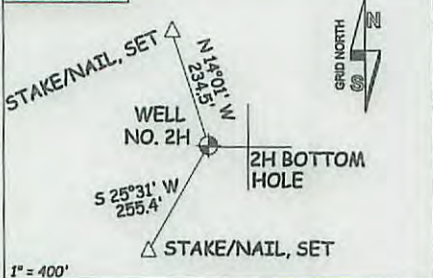

NOTE:
1 WATER WELL AND 1 DEVELOPED SPRING WERE LOCATED WITHIN 2000' OF PROPOSED WELL



47 - 095 - 02328
STATE COUNTY PERMIT

I THE UNDERSIGNED, HEREBY CERTIFY THAT THIS PLAT IS CORRECT TO THE BEST OF MY KNOWLEDGE AND BELIEF AND SHOWS ALL THE INFORMATION REQUIRED BY LAW AND THE RULES ISSUED AND PERSERIBED BY THE DEPARTMENT OF ENVIRONMENTAL PROTECTION.



STATE OF WEST VIRGINIA, DIVISION OF ENVIRONMENTAL PROTECTION, OFFICE OF OIL AND GAS
WILLOW LAND SURVEYING PLLC
220 MASONIC AVE. PENNSBORO WEST VIRGINIA 26415

JOB # 15-055WA
DRAWING # KLONDIKE2HR2
SCALE 1" = 1000'
MINIMUM DEGREE OF ACCURACY SUBMETER
PROVEN SOURCE OF ELEV. SUBMETER MAPPING GRADE GPS
STATE OF WEST VIRGINIA DEPARTMENT OF ENERGY DIVISION OF OIL AND GAS

LEGEND
- - - Surface Owner Boundary Lines +/-
- - - Interior Surface Tracts +/-
- - - Existing Fence
- - - Found monument, as noted
DOUGLAS R. ROWE P.S. 2202
DATE 01/20/16
OPERATOR'S WELL# KLONDIKE UNIT #2H

WELL TYPE: OIL GAS X LIQUID INJECTION WASTE DISPOSAL
(IF "GAS") PRODUCTION X STORAGE DEEP SHALLOW X
LOCATION: ELEVATION 1,216' ORIGINAL - 1,201' AS DRILLED WATERSHED OUTLET MIDDLE ISLAND CREEK
QUADRANGLE SHIRLEY 7.5' DISTRICT ELLSWORTH COUNTY TYLER
SURFACE OWNER LLOYD C. SECKMAN ACREAGE 128.5 ACRES +/-
OIL & GAS ROYALTY OWNER LLOYD C. SECKMAN; THOMAS L. BURKHART; EDWIN C. WEIGLE HEIRS; JOSEPH SAYRE LEASE ACREAGE 128.5 AC +/-; 90 AC +/-; 129.2 AC +/-; 100 AC +/-;
JAMES C. RYMER; RICHARD L. SEAGO ET UX; JAMES E. GREGG ET UX; JOHN H. CRUMRINE ET AL; WVDNR; WVDNR; WVDNR; PATSY FLETCHER 143.89 AC +/-; 74.2 AC +/-; 141 AC +/-; 256 AC +/-; 20 AC +/-; 71.74 AC +/-; 80 AC +/-; 19.8 AC +/-
PROPOSED WORK: DRILL CONVERT DRILL DEEPER X REDRILL FRACTURE OR STIMULATE X
PLUG OFF OLD FORMATION PERFORATE NEW FORMATION X OTHER PHYSICAL CHANGE IN WELL
(SPECIFY) MOD-BHL PLUG & ABANDON CLEAN OUT & REPLUG
TARGET FORMATION MARCELLUS ESTIMATED DEPTH 6,800' TVD 18,700' MD
WELL OPERATOR ANTERO RESOURCES CORP. DESIGNATED AGENT DIANNA STAMPER - CT CORPORATION SYSTEM
ADDRESS 1615 WYNKOOP STREET ADDRESS 5400 D BIG TYLER ROAD
DENVER, CO 80202 CHARLESTON, WV 25313

02/12/2016