

LATITUDE 39°22'30" 1,640'

LATITUDE 39°22'30"

8,580' TO BOTTOM HOLE

LONGITUDE 80°55'00" 2,569'
LONGITUDE 80°57'30" 9,522' TO BOTTOM HOLE

Antero Resources Corporation
Well No. Dillon Unit 3H
A.P.I. 47-095-02353

AS DRILLED DATA:
WELL 3H TOP HOLE INFORMATION:
N: 319,497ft E: 1,586,075ft
LAT: 39°22'04.61" N; 80°57'50.88" W
BOTTOM HOLE INFORMATION:
N: 312,467ft E: 1,590,805ft
LAT: 39°20'55.89" N; 80°56'49.22" W

WEST VIRGINIA COORDINATE SYSTEM OF 1927 NORTH ZONE. ZONE WAS DERIVED FROM MEASUREMENTS TAKEN WITH TRIMBLE GEOXT SUBMETER MAPPING GRADE GPS UNIT. PLAT ORIENTATION, CORNER, AND WELL REFERENCE TIE LINES ARE BASED ON GRID NORTH.

(NAD) 83 (UTM) ZONE 17 COORDS:
WELL 3H TOP HOLE INFORMATION:
N: 4,357,619m E: 503,104m
BOTTOM HOLE INFORMATION:
N: 4,355,501m E: 504,581m

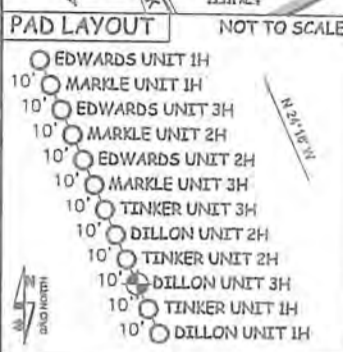

I THE UNDERSIGNED, HEREBY CERTIFY THAT THIS PLAT IS CORRECT TO THE BEST OF MY KNOWLEDGE AND BELIEF AND SHOWS ALL THE INFORMATION REQUIRED BY LAW AND THE RULES ISSUED AND PERSCRIBED BY THE DEPARTMENT OF ENVIRONMENTAL PROTECTION.



STATE OF WEST VIRGINIA, DIVISION OF ENVIRONMENTAL PROTECTION, OFFICE OF OIL AND GAS

WILLOW LAND SURVEYING PLLC
220 MASONRY AVE. PENNSBORO WEST VIRGINIA 26415

JOB # 12-152WA
DRAWING # DILLON3HAD
SCALE 1" = 1000'
MINIMUM DEGREE OF ACCURACY SUBMETER
PROVEN SOURCE OF ELEV. SUBMETER MAPPING GRADE GPS
STATE OF WEST VIRGINIA DEPARTMENT OF ENERGY DIVISION OF OIL AND GAS

LEGEND
--- Surface Owner Boundary Lines +/-
--- Interior Surface Tracts +/-
--- Proposed Well Path
--- As Drilled Well Path

THOMAS SUMMERS P.S. 2109
DATE 08/01/18
OPERATOR'S WELL# DILLON UNIT 3H

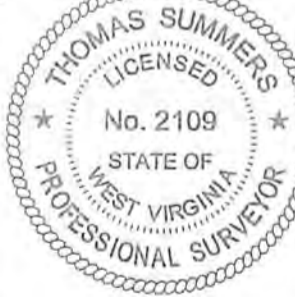

- 1. NO OCCUPIED DWELLINGS OR BUILDINGS TWO THOUSAND FIVE HUNDRED (2,500) SQUARE FEET OR LARGER USED TO HOUSE OR SHELTER DAIRY CATTLE OR POULTRY HUSBANDRY ARE LOCATED WITHIN SIX HUNDRED TWENTY-FIVE (625) FEET OF THE CENTER OF THE WELL PAD.
- 2. TOP HOLE DATA SHOWN HEREON WAS PROVIDED BY ALLEN INDY SURVEYS, INC.
- 3. AS DRILLED DATA WAS PROVIDED BY ANTERO RESOURCES CORPORATION.
- 4. WLS IS NOT CERTIFYING THE DATA AND INFORMATION PROVIDED LISTED IN NOTES 2 AND 3, ONLY THE RELATIONSHIP TO THE DATA AND INFORMATION PROVIDED TO THE LEASE BOUNDARIES.
- 5. WLS IS BY NO MEANS RESPONSIBLE FOR ANY ERRORS OR INACCURACIES WITH THE DATA AND INFORMATION THAT HAS BEEN PROVIDED.

WELL TYPE: OIL ___ GAS X LIQUID INJECTION ___ WASTE DISPOSAL ___ 47 - 095 - 02353
(IF "GAS") PRODUCTION X STORAGE ___ DEEP ___ SHALLOW X STATE COUNTY PERMIT
LOCATION: ELEVATION 1,146.5' AS-BUILT WATERSHED OUTLET MIDDLE ISLAND CREEK
QUADRANGLE PENNSBORO 7.5' DISTRICT MEADE COUNTY TYLER
SURFACE OWNER RITCHIE PETROLEUM INC. ACREAGE 30.92 ACRES +/-
OIL & GAS ROYALTY OWNER ASHFORD BROADWATER; TERRY L. SNIDER; HUNTERS INC.; THEODORE MCCULLOUGH ET UX; LEASE ACREAGE 593.212 ACRES; 67 ACRES; 471.20 ACRES; 188.72 ACRES;
MATTHEW B. HARPER ET UX; JEANETTE MCCULLOUGH; RITCHIE PETROLEUM CORP., INC.; BLANCHE STEWART; VICTOR HOLDREN 182.25 ACRES; 48.05 ACRES; 35 ACRES; 30 ACRES;

PROPOSED WORK: DRILL ___ CONVERT ___ DRILL DEEPER ___ REDRILL ___ FRACTURE OR STIMULATE ___
PLUG OFF OLD FORMATION ___ PERFORATE NEW FORMATION ___ OTHER PHYSICAL CHANGE IN WELL
(SPECIFY) AS DRILLED PLUG & ABANDON CLEAN OUT & REPLUG
TARGET FORMATION MARCELLUS ESTIMATED DEPTH 6,468' TVD 15,064' MD
WELL OPERATOR ANTERO RESOURCES CORP. DESIGNATED AGENT DIANNA STAMPER - CT CORPORATION SYSTEM
ADDRESS 1615 WYNKOOP STREET ADDRESS 5400 D BIG TYLER ROAD
FORM WW-6 DENVER, CO 80202 CHARLESTON, WV 25313