

LATITUDE 39°22'30" 1,657'

10,141' TO BOTTOM HOLE  
LATITUDE 39°22'30"

LONGITUDE 80°55'00" 1,162' TO BOTTOM HOLE  
LONGITUDE 80°57'30"

### Antero Resources Corporation Well No. Markle Unit 3H

**AS DRILLED DATA:**  
**WELL 3H TOP HOLE INFORMATION:**  
 N: 319,534ft E: 1,586,059ft  
 LAT: 39°22'04.97" LON: 80°57'51.10"  
**BOTTOM HOLE INFORMATION:**  
 N: 310,852ft E: 1,589,218ft  
 LAT: 39°20'39.67" LON: 80°57'09.08"

**WEST VIRGINIA COORDINATE SYSTEM OF 1927 NORTH ZONE.**  
 ZONE WAS DERIVED FROM MEASUREMENTS TAKEN WITH TRIMBLE GEOXT SUBMETER MAPPING GRADE GPS UNIT. PLAT ORIENTATION, CORNER, AND WELL REFERENCE TIE LINES ARE BASED ON GRID NORTH.

**(NAD) 83 (UTM) ZONE 17 COORDS:**  
**WELL 3H TOP HOLE INFORMATION:**  
 N: 4,357,630m E: 503,099m  
**BOTTOM HOLE INFORMATION:**  
 N: 4,355,001m E: 504,106m

WV NORTH ZONE GRID NORTH

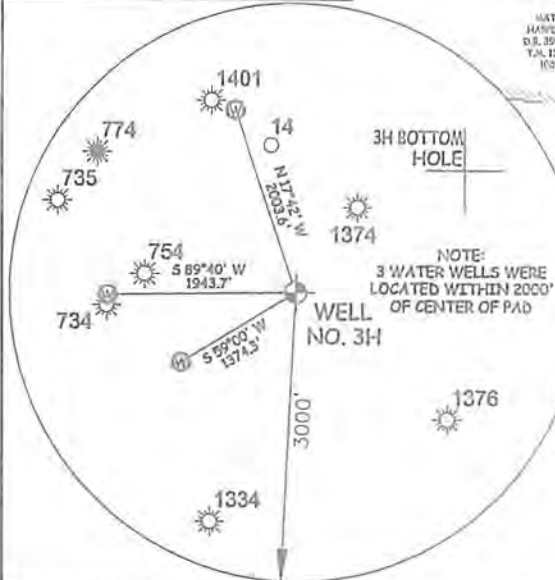
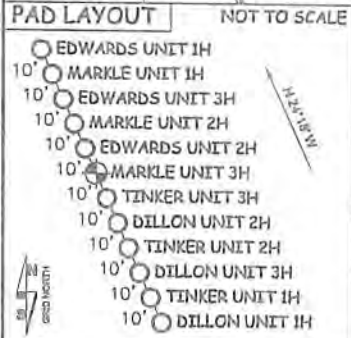

I THE UNDERSIGNED, HEREBY CERTIFY THAT THIS PLAT IS CORRECT TO THE BEST OF MY KNOWLEDGE AND BELIEF AND SHOWS ALL THE INFORMATION REQUIRED BY LAW AND THE RULES ISSUED AND PERSCRIBED BY THE DEPARTMENT OF ENVIRONMENTAL PROTECTION.



STATE OF WEST VIRGINIA, DIVISION OF ENVIRONMENTAL PROTECTION, OFFICE OF OIL AND GAS

WILLOW LAND SURVEYING PLLC  
 220 MASONIC AVE. PENNSBORO WEST VIRGINIA 26415

JOB # 16-008VA  
 DRAWING # MARKLE3HAD  
 SCALE 1" = 1000'  
 MINIMUM DEGREE OF ACCURACY SUBMETER  
 PROVEN SOURCE OF ELEV. SUBMETER MAPPING GRADE GPS

STATE OF WEST VIRGINIA DEPARTMENT OF ENERGY DIVISION OF OIL AND GAS

**LEGEND**  
 - - - Surface Owner Boundary Lines +/-  
 - - - Interior Surface Tracts +/-  
 - - - Proposed Well Path  
 - - - As Drilled Well Path

*Thomas Summers*  
 THOMAS SUMMERS P.S. 2109

DATE 08/01/18  
 OPERATOR'S WELL# MARKLE UNIT #3H

**NOTE**

- NO OCCUPIED DWELLINGS OR BUILDINGS TWO THOUSAND FIVE HUNDRED (2,500) SQUARE FEET OR LARGER USED TO HOUSE OR SHELTER DAIRY CATTLE OR POULTRY HUSBANDRY ARE LOCATED WITHIN SIX HUNDRED TWENTY-FIVE (625) FEET OF THE CENTER OF THE WELL PAD.
- TOP HOLE DATA SHOWN HEREON WAS PROVIDED BY ALLEGHENY SURVEYS, INC.
- AS DRILLED DATA WAS PROVIDED BY ANTERO RESOURCES CORPORATION.
- WLS IS NOT CERTIFYING THE DATA AND INFORMATION PROVIDED LISTED IN NOTES 2 AND 3, ONLY THE RELATIONSHIP TO THE DATA AND INFORMATION PROVIDED TO THE LEASE BOUNDARIES.
- WLS IS BY NO MEANS RESPONSIBLE FOR ANY ERRORS OR INACCURACIES WITH THE DATA AND INFORMATION THAT HAS BEEN PROVIDED.

WELL TYPE: OIL  GAS  LIQUID INJECTION  WASTE DISPOSAL  47 - 095 - 02354  
 (IF "GAS") PRODUCTION  STORAGE  DEEP  SHALLOW   
 LOCATION: ELEVATION 1,146.5 AS-BUILT STATE COUNTY PERMIT  
 QUADRANGLE PENNSBORO 7.5' DISTRICT MEADE COUNTY TYLER  
 SURFACE OWNER RITCHIE PETROLEUM INC. ACREAGE 30.92 ACRES +/-  
 OIL & GAS ROYALTY OWNER ASHFORD BROADWATER, TERRY L. SNIDER, HO, LLC, HI, LLC, MATTHEW B. HARPER ET UX LEASE ACREAGE 63.712 ACRES +/- 67 ACRES +/- 7.85 ACRES +/- 33 AC +/- 109 AC +/-  
 FLOYD C. MARKLE ET AL; RUTH MARKLE; HATTIE JONES; NORMA MARKLE WALKER; HATTIE JONES; THE WINSTON FAMILY TRUST; BRANDON T. EDWARDS ET UX 81 ACRES +/- 44 ACRES +/- 27 ACRES +/- 2.91 AC +/- 43.57 ACRES +/- 21 ACRES +/- 52.5 ACRES +/-  
 PROPOSED WORK: DRILL  CONVERT  DRILL DEEPER  REDRILL  FRACTURE OR STIMULATE   
 PLUG OFF OLD FORMATION  PERFORATE NEW FORMATION  OTHER PHYSICAL CHANGE IN WELL (SPECIFY) AS DRILLED  
 TARGET FORMATION MARCELLUS PLUG & ABANDON CLEAN OUT & REPLUG  
 WELL OPERATOR ANTERO RESOURCES CORP. ESTIMATED DEPTH 6,458' TVD 15,732' MD  
 ADDRESS 1615 WYNKOOP STREET ADDRESS 5400 D BIG TYLER ROAD  
 DENVER, CO 80202 CHARLESTON, WV 25313