

LATITUDE 39°27'30"

8,217'

LATITUDE 39°25'00"

6,556' TO BOTTOM HOLE

LONGITUDE 80°52'30"

5,489' TO BOTTOM HOLE

12,006'

LONGITUDE 80°52'30"



Antero Resources Corporation Well No. Ant Unit 1H

AS DRILLED DATA:
WELL 1H TOP HOLE INFORMATION:
 N: 340,139ft E: 1,603,376ft
 LAT: 39°25'31.34" LON: 80°54'14.72"
BOTTOM HOLE INFORMATION:
 N: 331,455ft E: 1,604,904ft
 LAT: 39°24'05.76" LON: 80°53'53.52"
 WEST VIRGINIA COORDINATE SYSTEM OF 1927 NORTH ZONE
 THIS ZONE WAS DERIVED FROM MEASUREMENTS TAKEN WITH TRIMBLE GEOXT SUBMETER MAPPING GRADE GPS UNIT. PLAT ORIENTATION, CORNER, AND WELL REFERENCE TIE LINES ARE BASED ON GRID NORTH.

(NAD) 83 (UTM) ZONE 17 COORDS:
WELL 1H TOP HOLE INFORMATION:
 N: 4,363,995m E: 508,270m
BOTTOM HOLE INFORMATION:
 N: 4,361,358m E: 508,780m

04/05/2019

- NOTE**
1. NO OCCUPIED DWELLINGS OR BUILDINGS TWO THOUSAND FIVE HUNDRED (2,500) SQUARE FEET OR LARGER USED TO HOUSE OR SHELTER DAIRY CATTLE OR POULTRY HUSBANDRY ARE LOCATED WITHIN SIX HUNDRED TWENTY-FIVE (625) FEET OF THE CENTER OF THE WELL PAD.
 2. TOP HOLE DATA SHOWN HEREON WAS PROVIDED BY ALLEGHENY SURVEYS, INC.
 3. AS DRILLED DATA WAS PROVIDED BY ANTERO RESOURCES CORPORATION.
 4. WLS IS NOT CERTIFYING THE DATA AND INFORMATION PROVIDED LISTED IN NOTES 2 AND 3, ONLY THE RELATIONSHIP TO THE DATA AND INFORMATION PROVIDED TO THE LEASE BOUNDARIES.
 5. WLS IS BY NO MEANS RESPONSIBLE FOR ANY ERRORS OR INACCURACIES WITH THE DATA AND INFORMATION THAT HAS BEEN PROVIDED.

PAD LAYOUT
 NOT TO SCALE

WV N 32° W

- 10' MYSTIS UNIT 1H
- 10' MYSTIS UNIT 2H
- 10' MYSTIS UNIT 3H
- 10' ANT UNIT 1H
- 10' ANT UNIT 2H
- 10' ANT UNIT 3H
- 10' SAN JUAN UNIT 1H
- 10' SAN JUAN UNIT 2H
- 10' SAN JUAN UNIT 3H
- 10' SAN JUAN UNIT 4H
- 10' EMERGER UNIT 1H
- 10' EMERGER UNIT 2H
- 10' EMERGER UNIT 3H
- 10' EMERGER UNIT 4H

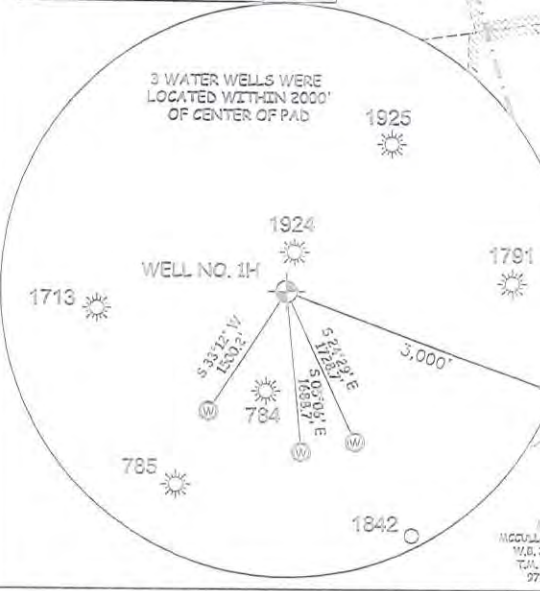

I, THE UNDERSIGNED, HEREBY CERTIFY THAT THIS PLAT IS CORRECT TO THE BEST OF MY KNOWLEDGE AND BELIEF AND SHOWS ALL THE INFORMATION REQUIRED BY LAW AND THE RULES ISSUED AND PERSCRIBED BY THE DEPARTMENT OF ENVIRONMENTAL PROTECTION.



STATE OF WEST VIRGINIA, DIVISION OF ENVIRONMENTAL PROTECTION, OFFICE OF OIL AND GAS
 WILLOW LAND SURVEYING PLLC
 220 MASONIC AVE. PENNSBORO WEST VIRGINIA 26415

JOB # 16-045WA
 DRAWING # ANT1HAD
 SCALE 1" = 1000'
 MINIMUM DEGREE OF ACCURACY SUBMETER
 PROVEN SOURCE OF ELEV. SUBMETER MAPPING GRADE GPS
 STATE OF WEST VIRGINIA DEPARTMENT OF ENERGY DIVISION OF OIL AND GAS

LEGEND
 - - - - - Surface Owner Boundary Lines +/-
 - - - - - Interior Surface Tracts +/-
 O - - - - - Proposed Well Path
 O - - - - - As Drilled Well Path

Thomas Summers
 THOMAS SUMMERS P.S. 2109
 DATE 10/12/18
 OPERATOR'S WELL# ANT UNIT 1H

WELL TYPE: OIL GAS LIQUID INJECTION WASTE DISPOSAL 47 - 095 - 02400
 (IF "GAS") PRODUCTION STORAGE DEEP SHALLOW STATE COUNTY PERMIT
 LOCATION: ELEVATION 1,148.1' - AS BUILT WATERSHED OUTLET MIDDLE ISLAND CREEK
 QUADRANGLE MIDDLEBOURNE 7.5' DISTRICT CENTERVILLE COUNTY TYLER
 SURFACE OWNER VERA O. THOMAS ACREAGE 51.11 ACRES +/-
 OIL & GAS ROYALTY OWNER NORMAN H. THOMAS ET UX; KATHLEEN L. LOUGH; OPAL G. BERRY; LEASE ACREAGE 125 AC.±; 40.27 AC.±; 32 AC.±; GORDON R. HAMILTON; FRANK S. GRASS; GARY L. HALL ET UX; GARY L. HALL; E. G. BEAM 125 AC.±; 38.06 AC.±; 12 AC.±; 80 AC.±; 317 AC.±
 PROPOSED WORK: DRILL CONVERT DRILL DEEPER REDRILL FRACTURE OR STIMULATE
 PLUG OFF OLD FORMATION PERFORATE NEW FORMATION OTHER PHYSICAL CHANGE IN WELL (SPECIFY) AS DRILLED PLUG & ABANDON CLEAN OUT & REPLUG
 TARGET FORMATION MARCELLUS ESTIMATED DEPTH 6,571' TVD 15,869' MD
 WELL OPERATOR ANTERO RESOURCES CORP. DESIGNATED AGENT DIANNA STAMPER - CT CORPORATION SYSTEM
 ADDRESS 1615 WYNKOOP ST. ADDRESS 5400 D BIG TYLER ROAD
 DENVER, CO 80202 CHARLESTON, WV 25313